

SOVEREIGN

EASY GARDENING

18V CORDLESS LAWN MOWER

Item No. 555376

Model No. LM 32H



Technical Support & Parts

01904 727509

Mon-Fri 9am-5pm Sat-Sun 11am-4pm
www.gardenservicecentre.co.uk

INSTRUCTION MANUAL

Please read these instructions fully before starting assembly.

HHGL Limited, MK9 1BA HHGL (ROI) Limited, D02 X576

Oct 19

CONTENTS

General safety warnings	3
Intended use	11
Warning symbols	11
In the box	15
Assemble the lawn mower	16
Operating the lawn mower	19
Maintenance and storage	29
Troubleshooting	32
Technical data	34
Recycling and disposal	35
Getting help	35
Warranty	36

GENERAL SAFETY WARNINGS

Safety Warnings



WARNING! Read all safety warnings and instructions.

Failure to follow the warnings and instructions may result in electric shock, fire and/or serious injury.



WARNING! Read all safety warnings and instructions designated by the  symbol. Save all warnings and instructions for future reference.

- This appliance may be used by children aged 8 years and above, and persons with reduced physical, sensory or mental capabilities or lack of experience and knowledge, only if they have been given supervision or instruction concerning the use of the appliance in a safe way and understand the hazards involved.
- Perform assembly operations as described in this manual. Failure to observe this warning may lead to serious injury, death, or damage to the lawn mower.
- Children should be supervised to ensure that they do not play with the product.

IMPORTANT

READ CAREFULLY BEFORE USE & KEEP FOR FUTURE REFERENCE

GENERAL POWER TOOL SAFETY WARNINGS

Training

- **Read the instructions carefully and make sure you fully understand them.** Make sure you are familiar with the controls and the correct use of the product.
- **Never allow small children or people unfamiliar with these instructions to use the product.** Local regulations can restrict the age of the operator.
- **Never operate the product while people, especially children or pets, are nearby.**
- **Keep in mind that the operator or user is responsible for any accidents or hazards occurring to other people or their property.**

Preparation

- **While operating the product always wear substantial footwear and long trousers.** Do not operate this product when barefoot or wearing open-toed sandals. Avoid wearing clothing that is loose fitting or has hanging cords or ties.
- **Thoroughly inspect the area where the product is to be used and remove all objects which could be thrown by the product.**
- **Before use, always visually inspect to see that the blade, blade bolt and the blade assembly are not worn or damaged.** Replace worn or damaged components in sets to preserve balance. Replace any damaged or unreadable labels.

- **Ensure the switch is in the 'off' position before inserting the battery pack.** Inserting the battery pack into a machine that is switched on can result in injury.

General Operation

- Use the tool only with specifically designated battery packs. Use of any other battery packs will increase the risk of injury and fire.
- Only operate the product in daylight or in good artificial light.
- Do not expose the tool and charger to rain or wet conditions. If a tool or charger is exposed to moisture it will increase the risk of electric shock.
- Avoid operating the product on wet grass.
- Always be sure of your footing on slopes.
- Walk, never run.
- Mow across the face of slopes, never up and down.
- Exercise extreme caution when changing direction on slopes.
- Do not mow excessively steep slopes.
- Use extreme caution when reversing or pulling the product towards you.
- Stop the blades if the product has to be tilted for transportation, when crossing surfaces other than grass, and when transporting the product to and from the area to be mowed.

- Never operate the product with defective guards or shields or without safety devices in place, such as deflectors or grass collector.
- When switching on the motor, keep feet well away from the blades.
- Do not tilt the product when switching on the motor, except if the product has to be tilted for starting. In this case, do not tilt it more than absolutely necessary and lift only the part furthest away from the operator.
- Do not start the product when standing in front of the discharge opening.
- Do not put hands or feet near or under rotating parts.
- Keep clear of the discharge opening at all times.
- Do not transport the product while the cutting blade is running.
- Stop the product and remove the key/battery pack from the machine and make sure that all moving parts have come to a complete stop:
 - Whenever you leave the product unattended.
 - Before clearing blockages or unclogging the chute.
 - Before checking, cleaning or working on the product.
 - After striking a foreign object, be sure to inspect the product for damage and make repairs before restarting and operating the product.

- If the product starts to vibrate abnormally:
 - Inspect for any damages.
 - Replace or repair any damaged parts.
 - Check for and tighten any loose parts.

Chargers

- Recharge only with the charger specified by the manufacturer. Do not use the original charger on other li-ion batteries or on any other type of battery, as this can increase the risk of fire or explosion.
- Check the battery charger, cable and plug before each use. Do not use the battery charger if damaged. Do not open the battery charger yourself; the charger must be repaired by qualified personnel using original spare parts.
- The charger is designed to use a standard household 220-240 V~ 50Hz power source; ensure that the plug matches the outlet.
- Never modify the plug in any way, this will reduce the risk of electric shock.
- Do not abuse the cord of the charger. Never use the cord for carrying, pulling or unplugging the charger. Keep the cord away from heat, oil, sharp edges or moving parts. Damaged or entangled cords increase the risk of electric shock.
- Make sure the charger cord is situated so that it will not be stepped on, tripped over or get damaged.

- Keep the battery charger clean. Contamination can increase the risk of electric shock.
- Protect the battery charger from rain and moisture. If water accesses the battery charger there is an increased risk of electric shock.
- Battery will heat up whilst charging. To reduce the risk of fire, do not operate the battery charger on flammable surfaces, such as paper or textiles.
- The temperature range over which the battery pack can be charged is typically between 5°C-45 °C. Attempts to charge outside of the prescribed temperature range may automatically be blocked by the protection circuitry of the battery pack. Longest life and best performance can be obtained if the battery pack is charged at room temperature.
- Disconnect the charger from the power supply when not in use. This will reduce the risk of electric shock or damage to the charger.

Battery pack

- Fully charge the battery pack before first use.
- Recharge the battery pack immediately when the power output starts to slow. **DO NOT CONTINUE TO USE THE PRODUCT WHEN THE BATTERY LEVEL IS LOW.**
- To prevent serious damage to the battery, charge in temperatures above 5°C or below 45°C. Longest life and best performance can be achieved when the battery is charged at room temperature.
- If the battery temperature is above 45°C it must be

allowed to cool before putting it into the charging station.

- To reduce the risk of explosion, ensure the battery pack is not left in the sun for extended periods of time and that it is kept away from fire.
- Do not carry individual battery packs in your pockets or bag, as they could short circuit against other metal items.
- Should a li-ion battery catch fire, be sure to use the correct fire extinguisher to combat the fire. **DO NOT THROW WATER ON A BURNING LI-ION BATTERY.**
- If the battery pack becomes too hot during charging, disconnect and switch off immediately. Contact the service centre directly.
- Do not attempt to open the battery yourself.
- When the battery pack is not in use keep it away from other metal objects, such as paperclips, coins, keys, nails, screws or other small metal objects that can make a connection from one terminal to another.

Maintenance and storage

- Keep all nuts, bolts and screws tight to be sure the product is in a safe working condition.
- Check the grass collector frequently for wear or deterioration.
- Be careful when adjusting the product to prevent trapping fingers between moving blades or other fixed parts of the product.

- Always allow the product to cool down before storing.
- When servicing the blades, be aware that even though the power source is switched off, the blades can still move.
- Replace worn or damaged parts for safety. Use only genuine replacement parts and accessories.
- DO NOT attempt to open the charger and battery pack. There are no customer-serviceable parts inside. Return to any authorised service centre.
- Store the appliance with the battery pack fully charged at room temperature (around 20°C).
- Every deep discharge cycle decreases the capacity of the battery pack. To prolong battery life, it is recommended that you charge the battery every six months, within extended periods of time when the product is not in use.

Servicing

- Have your tool repaired by an authorised service agent. This tool is manufactured in accordance with the relevant safety regulations. To avoid danger, equipment must only be repaired by qualified technicians.
- Only use parts and accessories made for this machine by the manufacturer. Failure to do so can result in personal injury.

INTENDED USE

This lawn mower has been designed for cutting grass. The machine is to be used only for its prescribed purpose, and any other use is deemed to be a case of misuse.

PLEASE NOTE: Our equipment has not been designed for use in commercial, trade or industrial applications. Our warranty will be voided if the machine is used in commercial, trade or industrial businesses or for equivalent purposes.

WARNING SYMBOLS

Safety symbols

The purpose of safety symbols is to attract your attention to any possible dangers. The safety symbols and their explanations deserve your careful attention and full understanding. The symbol warnings do not, by themselves, eliminate any danger. The instructions and warnings they give are no substitute for proper accident prevention measures.



WARNING: Be sure to read and understand all safety instructions within this operator's manual, including all safety alert symbols such as '**DANGER**', '**WARNING**', and '**CAUTION**' before using this tool. Failure to follow all instructions listed below may result in electric shock, fire and/or serious personal injury.

SAFETY ALERT SYMBOLS: Indicate **DANGER**, **WARNING**, or **CAUTION** and may be used in conjunction with other symbols or pictographs.

Symbol meanings

This page depicts and describes safety symbols that may appear on this product. Read, fully understand and follow all instructions on the machine before attempting to assemble and operate.



To reduce the risk of injury, the user must read this instruction manual carefully.

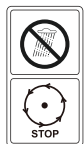

Avoid using the tool in the rain.



Wait until all machine components have completely stopped before touching them.



Keep bystanders away. Objects thrown by the product could hit the user or other bystanders. Always ensure that other people and pets remain at a safe distance from the product when it is in operation.



Beware of sharp blades. Blades continue to rotate after the motor is switched off. Remove the safety key before performing any maintenance tasks.



Guaranteed sound power level value is 96 dB.



Wear ear protection, eye protection and gloves (PPE) when using the product.



WEEE symbol. Waste electrical products should not be disposed of with household waste. Please recycle where facilities exist. Check with your local authority or local store for recycling guidelines.



The product complies with the applicable European Directives, and an evaluation method of conformity for these directives was done.

Warning symbols on the battery pack



To reduce the risk of injury, the user must read this instruction manual carefully.



Do not throw into water.



Do not throw on fire.



Do not subject the battery to strong sunlight over long periods of time. Do not leave on a heater (max. 45°C).



Li-Ion

Batteries contain Li-ion. Do not dispose of waste batteries in domestic waste. Contact your local authority to find out how to dispose of batteries.



The product complies with the applicable European Directives, and an evaluation method of conformity for these directives was done.

Warning symbols on the charger



To reduce the risk of injury, the user must read this instruction manual carefully.



The charger is for indoor use only.



Double insulation.



Protective 3.15A limited.



Pole orientation.



WEEE symbol. Waste electrical products should not be disposed of with household waste. Please recycle where facilities exist. Check with your local authority or local store for recycling advice.

IN THE BOX

Parts

- | | |
|-------------------------------|----------------------|
| 1. Upper handle | 7. Carry handle |
| 2. Switch box | 8. Rotating knob x 2 |
| 3. Lock-off button | 9. Start lever |
| 4. Cable clip x 2 | 10. Battery pack |
| 5. Grass bag | 11. Charger |
| 6. Battery pack locating tank | 12. Charger plug |

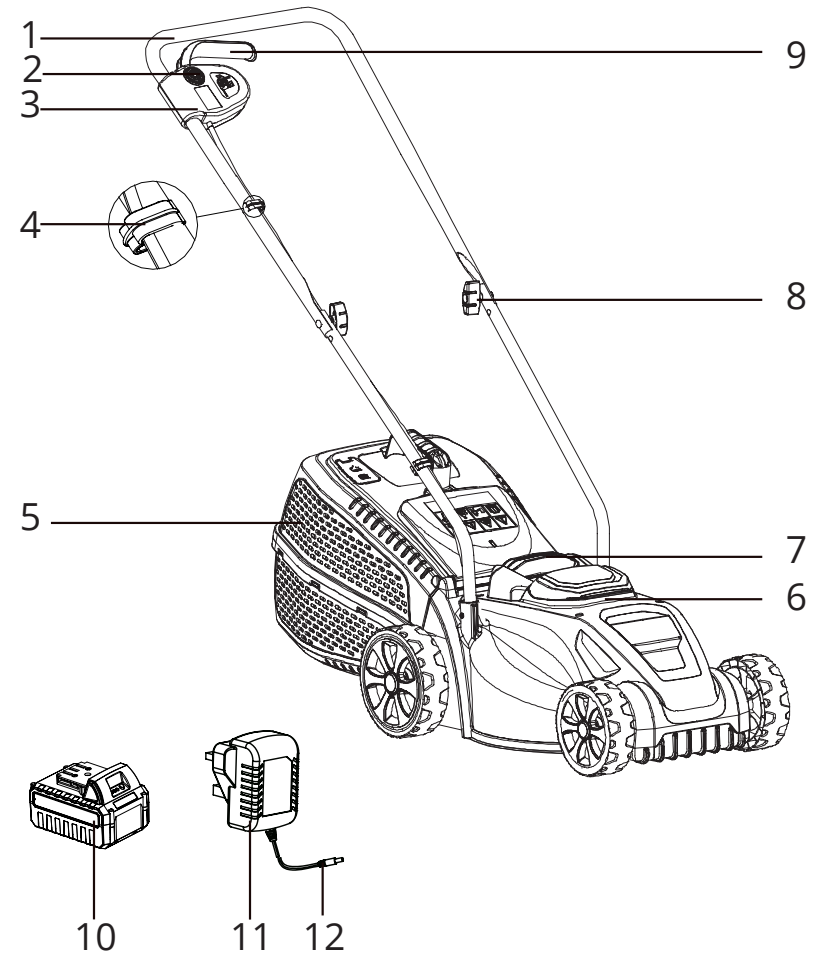

ASSEMBLE THE LAWN MOWER

Assemble the lower brace

1. Attach the lower brace to the deck.
2. Use two installation screws to fix the lower brace.

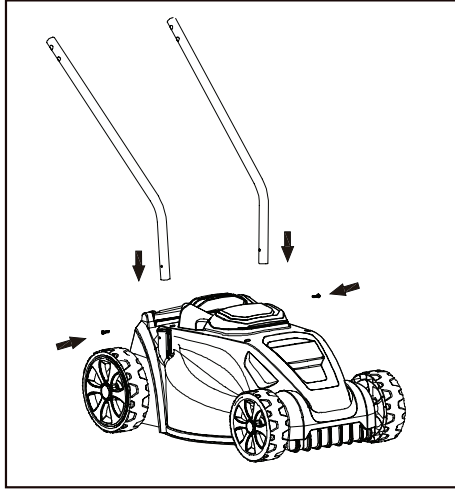

Attach the top handle to lower brace

Mount the top handle to the lower brace using the two rotating knobs.

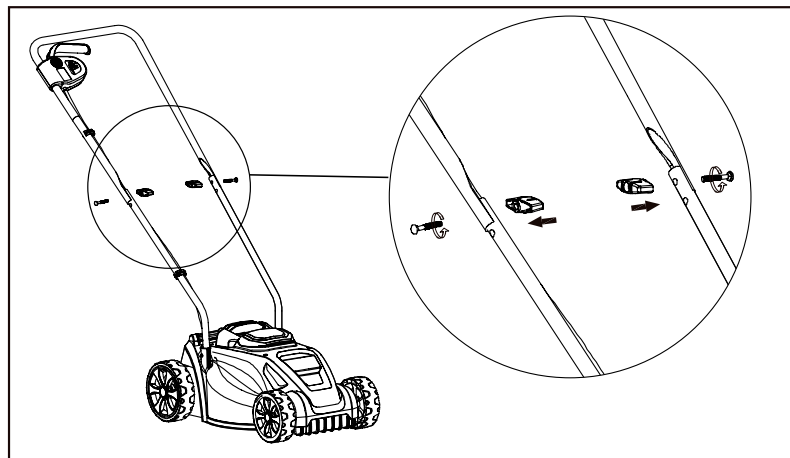

Fitting the cable clip

Ensure that the cable clips supplied are used to fix the cable to the lower brace.

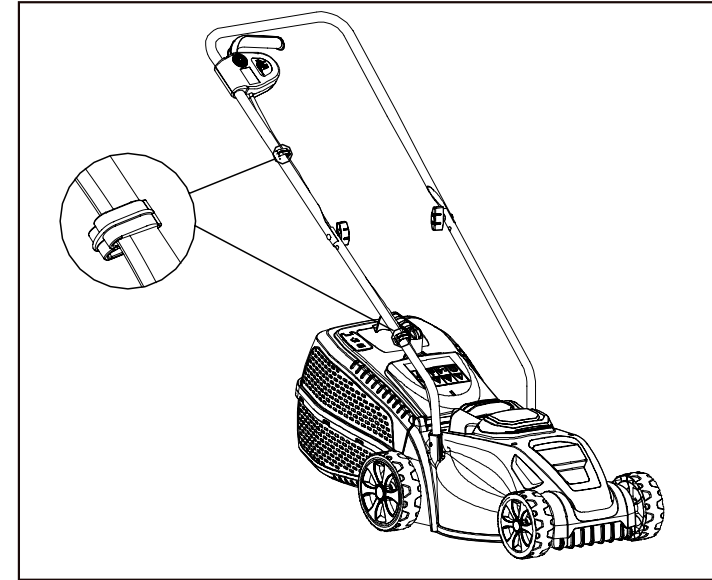

Mounting the grass catcher

1. Fit the upper part onto the lower part by fixing all the outer clips correctly.

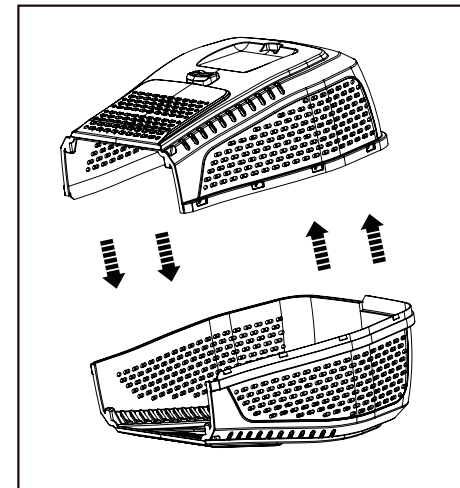

2. Fit the handle onto the top of the grass catcher so that it clicks into place.

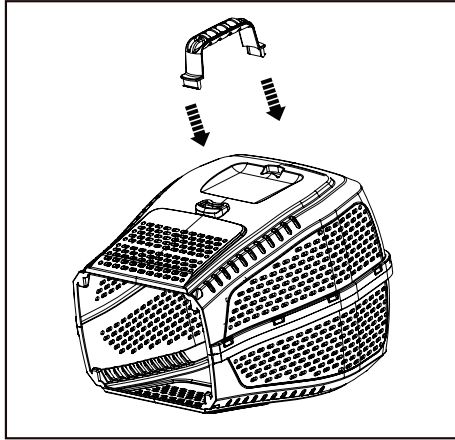

3. Hang the grass box on the hook.

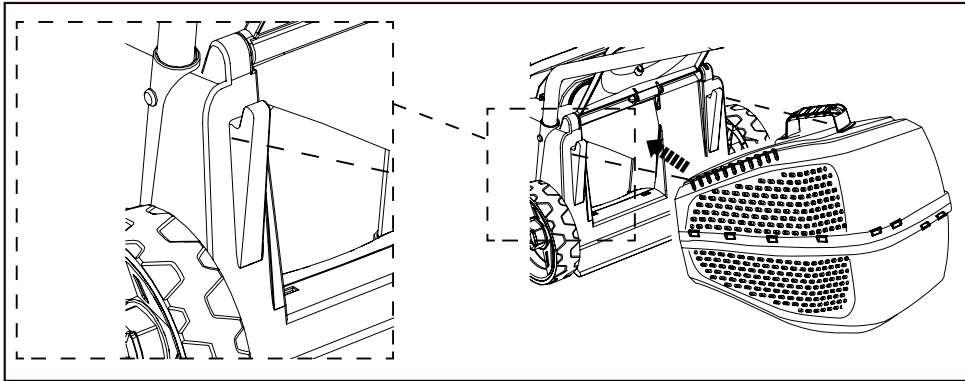

OPERATING THE LAWN MOWER



NOTE: This battery pack has been shipped in a low charge condition. It should be fully charged before first use. Make sure the mains voltage is the same as the rating label, which is located on the charger.



WARNING: The charger and battery pack supplied are designed to work specifically with each other; do not use with any other devices. Keep metallic objects away from the charger and battery pack to prevent electrical hazards. Fully charge the battery pack before first use and after every deep discharge.

This product comes with a li-ion battery pack. The lithium-ion battery will not lose charge when not in use and will not lose charging capacity over time; however, to maintain optimum battery life, it is recommended to charge the battery when empty or running low.

Connecting the charger to the mains

1. Plug the charger into an appropriate power supply. When connected, there will be a green LED light.
2. Insert the charger plug into the charging hole on the top of the battery pack; the light on the charger will turn red and the three green LED lights on the battery pack will flash alternately.
3. The battery pack fully charges in 90mins. When fully charged, the LED light on the charger will turn green and the three LED lights on the battery pack will stop flashing and stay green.

Important charging notes

Longest life and best performance can be obtained when the battery pack is charged at room temperature (between 18-24°C). Do not charge the battery pack in a very low or very high air temperature. This is important in preventing serious damage to the battery pack.

- When using your tool continuously, the batteries in your battery pack will become hot. You should let a hot battery pack cool down for approximately 30 minutes before attempting to recharge.
- The charger and battery pack may become warm to touch while charging. This is normal and does not indicate a problem.
- Where possible, the charger should be used at room temperature. To prevent overheating, do not cover the charger and do not charge battery packs in direct sunlight or near heat sources.
- If the battery pack does not charge properly:
 1. Check the mains socket by plugging in a different appliance.
 2. Move the charger and battery pack to a location where the surrounding air temperature is approximately 18-24°C.
 3. If charging problems persist, contact your local service centre.
- Ensure to always fully charge the battery before storage.
- Under certain conditions, with the charger plugged in to the power supply, the exposed charging contacts inside the charger can be shorted by foreign material. Foreign materials of a conductive nature, such as, but not limited to, steel wool, aluminium foil, or any buildup of metallic particles should be kept away from charger cavities. Always unplug the charger

from the power supply when there is no battery pack in the cavity. Unplug the charger before attempting to clean it.

- Do not immerse the charger in water.



WARNING: Do not allow any liquid to enter the charger, as this will increase the risk of electric shock. Avoid storing the charger and battery pack in areas of high temperature.



CAUTION: Never attempt to open the battery pack for any reason. If the plastic housing of the battery pack breaks or cracks, return to a service centre to be recycled; do not continue to use it.

CHECKING THE BATTERY CAPACITY

Push the power indicator button, and the remaining percentage of battery capacity will show on screen.

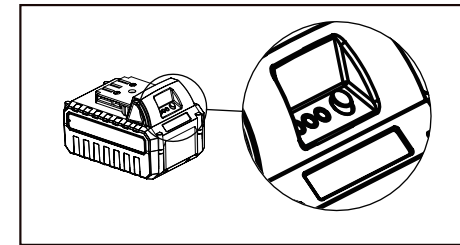

Charging the battery



WARNING!

The charger and battery pack are specifically designed to work together so do not attempt to use any other devices. Never insert or allow metallic objects into your charger or battery pack connections because an electrical failure and hazard will occur.

The battery needs to be charged before first use and whenever it fails to produce sufficient power on jobs that were easily done before.



WARNING! NEVER LEAVE THE BATTERY AND CHARGER UNATTENDED WHEN CHARGING THE BATTERY.

This product comes with a lithium-ion battery pack. Lithium-ion batteries don't lose charge when not in use, and don't lose charging capacity over time. Nevertheless, it is best practice to charge the battery when empty or insufficient to do the job.

CHARGING PROCEDURE



WARNING!

The battery cannot be charged immediately after use, it should cool off for a period of time.

1. Plug the charger into an appropriate AC power outlet.
2. Insert the charger plug (12) into the charging hole (A1) in battery pack (10), make sure the plug is fully in position. The LED (A2) lights on the battery pack flashes to tell you that the battery pack is on charge.
3. The battery pack will be fully charged in 90mins. And the three LED (A2) lights turn green to tell you that the battery pack is fully charged.

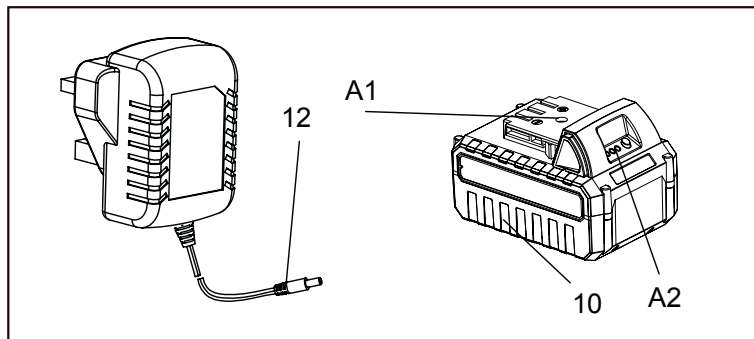

Important charging notes

Longest life and best performance can be obtained if the battery pack is charged when the air temperature is between 18-24°C. Do not charge the battery pack in a very low or very high air temperature. This is important and will prevent serious damage to the battery pack.

1. When using your tool continuously, the batteries in your battery pack will become hot. You should let a hot battery pack cool down for approximately 30 minutes before attempting to recharge.
2. The charger and battery pack may become warm to touch while charging. This is a normal condition and does not indicate a problem.
3. Use the charger in normal room temperatures whenever possible. To prevent overheating, do not cover the charger and do not charge battery packs in direct sunlight or near heat sources.
4. If the battery pack does not charge properly:
 - (1) Check the main socket by plugging in a lamp or other appliance.
 - (2) Move the charger and battery pack to a location where the surrounding air temperature is approximately 18-24°C.
 - (3) If charging problems persist, take or send the tool, battery pack and charger to your local service centre.
5. The battery pack should be recharged when it fails to produce sufficient power on jobs which were easily done previously. **DO NOT CONTINUE** to use under these conditions. Follow the charging procedure. You may also charge a partially used pack whenever you desire with no adverse effect on the battery pack.
6. Under certain conditions, with the charger plugged in to the power supply, the exposed charging contacts inside the charger can be shorted by foreign material. Foreign materials

of a conductive nature, such as, but not limited to, steel wool, aluminium foil, or any buildup of metallic particles, should be kept away from charger cavities. Always unplug the charger from the power supply when there is no battery pack in the cavity. Unplug the charger before attempting to clean it.

7. Do not immerse the charger in water or any other liquid.



WARNING!

Don't allow any liquid to get inside the charger; electric shocks may result. To facilitate the cooling of the battery pack after use, avoid placing the charger or battery pack in a warm environment, such as in a metal shed, or an un-insulated trailer.



WARNING!

Never attempt to open the battery pack for any reason. If the plastic housing of the battery pack breaks or cracks, return to a service centre for recycling; do not put it into further use.

CUTTING HEIGHT ADJUSTMENT

Adjust the cutting height according to the needs of your lawn. The cutting height depends on the kind of lawn and its actual height. When mowing high grass, start with the maximum cutting height and make a second cut with a lower cutting height.

1. Release the start lever and disconnect the product from the power supply.
2. Pull the rear and front shaft out and place them into the correct slot for the desired cutting height.
3. Make sure that the rear and front shaft are at the same level.



NOTE! Always ensure the lever clicks back into the slot.

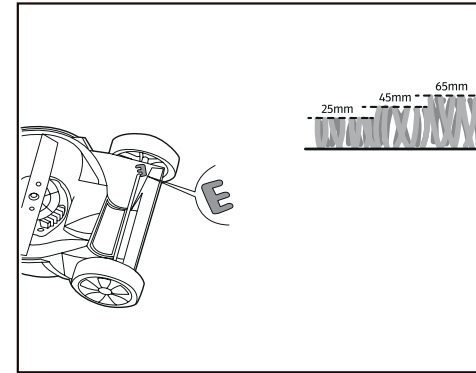

REMOVING AND INSERTING THE BATTERY PACK

Insert the battery pack

Align the battery pack with the corresponding receptacle on the charger. Push the battery pack into the tank until you hear a click. This means the battery pack has been locked in position; close the battery pack tank cover.

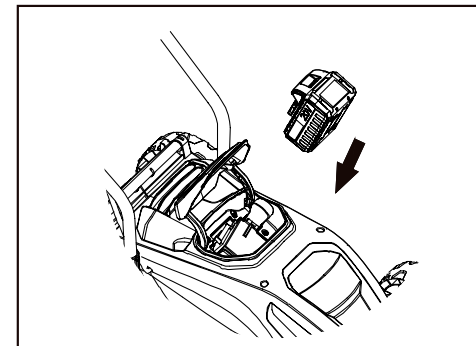

Removing the battery pack from the tool

Open the battery pack tank cover. Push the battery pack release button, and the battery pack will come out automatically.

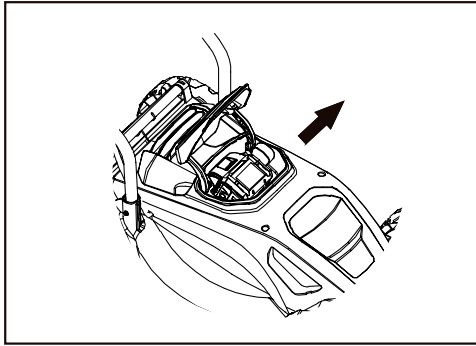

NOTE: Safety key

This lawn mower is fitted with a safety key; this prevents the accidental start up of your cordless lawn mower.

The safety key has been designed to totally disable the lawn mower when it is removed.

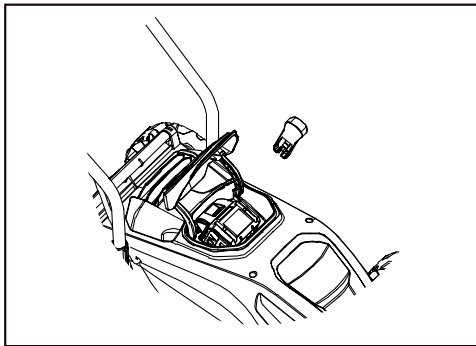

Switching on/off

1. Ensure the start lever is released.
2. Press the lock-off button and hold it in position.
3. Squeeze the start lever towards the handle to switch the product on. Hold the start lever in position during operation.

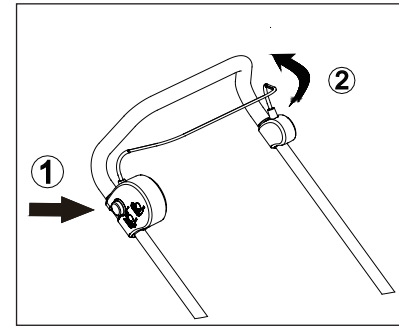

4. Release the lock-off button once the product is running.
5. Release the start lever to switch the product off.



NOTE: Do not continue to press the start button after an automatic shut-off of the machine, as this will result in battery damage.



WARNING: When the motor has been switched off, the blade will continue to run for several seconds. Do not touch the underside of the mower until the cutter has come to a complete standstill!

OPERATING THE LAWNMOWER

Operating on a slope

Slopes increase the risk of slip-and-fall accidents, which can result in severe injury. Always be sure of your footing on slopes. Exercise extreme caution when mowing slopes.

- Always mow across the face of a slope, never up and down. Take care when changing direction on a slope.
- Watch for holes, ruts, rocks, hidden objects or bumps which could cause you to slip or trip. Tall grass can hide obstacles.
- Be aware of footing when mowing near drops, ditches and embankments.
- Do not mow slopes greater than 15°.
- Avoid mowing wet grass. There is a fall risk.

Mower overload protection

To avoid overloading the machine, do not mow an area larger than that recommended by the manufacturer for this machine. This mower has built-in overload circuit protection. When the mower is overloaded, the motor will stop. Switch the mower off and check to see if grass has collected beneath the deck and clear it if necessary, then restart the mower.

Function of full indicator

If the grass bag is empty or it is not filled with grass, the grass full indicator will be open. If the grass bag is filled with grass the grass full indicator will be closed.

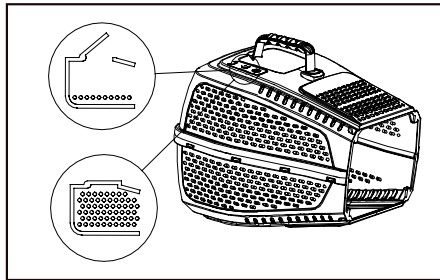

Emptying the grass bag

When the grass bag indicator closes, this is a sign that you should empty the grass bag.



NOTE: Before taking off the grass bag, switch off the engine and wait until the blade has come to a complete stop.

To take off the grass bag, use one hand to lift up the safety flap and the other to grab onto the carry handle. The safety flap automatically falls down after removing the grass bag and closes off the rear chute opening.

Empty out the grass bag then refit to the machine.



NOTE: If any grass residue is caught in the discharge chute, clean it using a brush. Do not remove grass debris from the mower casing or the blade by hand or with your feet. Instead use suitable tools, such as a brush or broom. To ensure that the cut grass can be collected into the grass bag, the discharge opening and inside the mower casing must be cleared of any blockages.

MAINTENANCE AND STORAGE



WARNING!

Before performing any maintenance or cleaning work, always ensure that the battery pack/safety key have been removed. Wait until the blade has stopped completely and the machine has cooled down.

Cleaning the product

- Use a soft brush to remove accumulated dust and debris. Wear safety glasses to protect your eyes whilst cleaning.
- Wipe down the product enclosure with a slightly damp cloth. Do not spray the unit with water. Water may destroy the switch unit and the electric motor.

Maintenance

NOTE: Always wear gardening gloves when working with sharp blades.

1. Keep all nuts, bolts and screws tight to ensure that the machine is in a safe working condition.
2. Check the grass bag frequently for wear or deterioration.
3. Examine the machine and replace worn or damaged parts for safety.

REMOVING/INSTALLING THE BLADE

1. Use the correct size wrench to uninstall the blade bolt nut.
2. Wearing heavy gloves, hold the blade still and turn the wrench anti-clockwise to remove the bolt.
3. Fit the replacement blade correctly with marks facing up and align the pegs, refit the bolt and retighten securely to torque 20N.m.



WARNING: Replace or re-sharpen the mower blade at the end of the season. Always have the mower blade re-sharpened or replaced by a recommended service centre.

Unbalanced blades will cause the lawn mower to vibrate violently, which can increase the risk of accidents occurring.

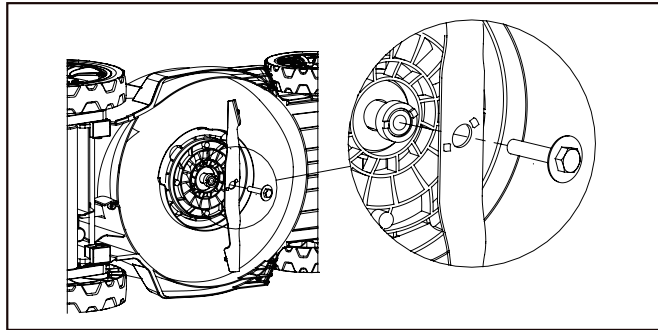

BATTERY MAINTENANCE

Use the following procedures to achieve the best battery life:

1. Protect the battery against moisture and water.
2. Store the battery only within temperature range of 5° to 45°C. Do not leave the battery in direct sunlight for extended periods of time.
3. Clean the battery regularly with a soft, clean and dry brush.
4. If you do not use the product for a long time, remember to charge and discharge the battery pack once every 6 months.

STORAGE AND TRANSPORT

Storage

After cleaning the unit thoroughly, store in a cool dry place out of the reach of children.

NOTE: Remove the safety key and battery packs. Ensure cables are not trapped when folding/unfolding the handle. If stored vertically, make sure the mower is positioned in a corner so that the blade is facing inwards against a wall and the machine is secure, to prevent it falling over.

Transport

Use the original packaging whenever possible.

TROUBLESHOOTING



WARNING: Before performing any repair work, ensure that the battery pack has been removed.



WARNING: Always wear heavy-duty gloves when adjusting or cleaning, especially when handling sharp objects.

Fault/malfunction	Cause	Remedy
Mower fails to start	Safety key is not inserted	Insert safety key
	Battery is not correctly inserted	Remove the battery and reinsert
	Mower standing in high grass	Start motor on shorter grass or already mowed area, change cutting height if necessary
	The mower housing is clogged	Clean housing so that the blade can move freely
	Battery has no power	Check and recharge battery
Mower stops working /loses power	Cutting height is incorrect	Adjust the cutting height
	Cutting blade is worn or damaged	Replace with new blade
	Battery performance decreasing	Check the battery performance and charge if necessary

Grass bag is not filled sufficiently	Cutting height is too low	Adjust cutting height
	The lawn / grass is wet	Allow the lawn to dry
	Underside of the mower deck is clogged	Clean the underside of the mower deck
	Cutting blade is worn or damaged	Replace cutting blade
Mower vibrating at higher speed	Cutting blade is unbalanced	Balance the blade by grinding each cutting edge until equal
	Blade is loosened / incorrectly fitted	Tighten the blade bolt
Mower cuts unevenly	The blade is damaged	Sharpen the blade or replace
	Blade is assembled incorrectly	Re-assemble blade correctly

TECHNICAL DATA

Model no.	LM 32H
Voltage	18V DC
Battery type	Lithium-ion
No-load speed	3500/min
Cutting width	32cm
Cutting height	25-65mm
Capacity of grass bag	30 litres
Weight	9.5kg
Battery pack Model	ZDBP18014001
Battery capacity	4Ah
Charging time	1.5hr
Battery charger Model	B0Q-SP02-36
Input of charger	220-240V AC, 50/60Hz 100W
Output of charger	DC 18V 1.5A
Protection class	II

Measured sound pressure level (L_{pA}): 87.78dB(A), K=3 dB(A)

Guaranteed sound power level: 90 dB(A)

Vibrations: 1.68 m/s² K=1.5 m/s²

The sound values have been determined according to noise test code given in EN 60335-2- 77, using the basic standards EN ISO 11201 and EN ISO 3744.

The sound intensity level for the operator may exceed 80 dB(A) and ear protection measures are necessary.

The declared vibration value has been measured in accordance with a standard test method (according to EN 60335-2-77) and may be used for comparing one product with another. The declared vibration value may also be used in a preliminary assessment of exposure.

RECYCLING AND DISPOSAL

Waste electrical products should not be disposed with household waste. Please recycle where facilities exist.

Check with your local authority or retailer for recycling advices.

GETTING HELP

Our dedicated UK-based customer helpline is open 7 days a week to assist you with assembly, parts queries and technical support. We are open during office hours but you can always send an email via support@gardenservicecentre.co.uk. Our experts are here to get you back enjoying your garden in no time.

For useful assembly, starting and maintenance videos, and for ordering spares, please visit www.gardenservicecentre.co.uk

Calling our service does not affect your statutory rights.

WARRANTY

Any claim under this warranty must be made within 12 months of the date of purchase. To make a claim under the warranty, take the product (with proof of purchase) to your local store.

HHGL Limited bears reasonable, direct expenses of claiming under the warranty.

You may submit details and proof to our store for consideration. The warranty covers manufacturer defects in materials, workmanship and finish under normal use.

This warranty is provided in addition to other rights and remedies you may have under law: our goods come with guarantees which cannot be excluded under the UK Consumer Rights Act 2015.

You are entitled to a replacement or refund for a major failure and to compensation for other reasonably foreseeable loss or damage. You are also entitled to have the goods repaired or replaced if the goods fail to be of acceptable quality and the failure does not amount to a major failure.

The warranty excludes damage resulting from product misuse or product neglect. The warranty covers domestic use only and does not apply to commercial applications.

This warranty is given by:

HHGL Limited, MK9 1BA

HHGL (ROI) Limited, D02 X576