

ORIGINAL INSTRUCTION MANUAL



McGregor 2400W IMPACT SHREDDER

7276820(Model: MCEIS24)

V:11/24



CAUTION Read the instructions before using the machine

These instructions contain important information that will help you get the best from your shredder, ensuring it is assembled correctly and safely. If you need help or have damaged or missing parts, call the Customer Helpline on **0345 605 2062**

AFTER SALES SUPPORT
0345 605 2062
SAN NO.: 03218AAAJO71

Contents

Introduction.....	2
Safety information	2
Parts list	12
Assembly	14
Preparation.....	17
Operation	18
Maintenance	22
Technical data	24
Trouble shooting	26
Guarantee	28

Produced in China for Argos Limited, London, EC1N 2HT, UK.

Argos (N.I.) Ltd, Forestside Shopping Centre, Upper Galwally, Belfast, BT8 6FX, UK.

<https://bit.ly/Coreservice-McGregor>

Introduction

Intended Use

This electric shredder is designated with a rated power input of 2400 Watts. This machine is designed for cutting of fibrous and woody garden waste for composting.

This machine is not intended for shredding pieces of metal, rocks, bottles, cans, etc. or soft waste such as kitchen rubbish.

For safety reasons it is essential to read the entire instruction manual before first operation and to observe all the instructions therein.

This machine is intended for private domestic use only, not for any commercial trade use. It must not be used for any purposes other than those described.



Safety Information

Important - Please read these instructions fully before operating or maintaining



WARNING: Read the instructions carefully before using the shredder and familiarize yourself with the controls and proper use of the equipment.



WARNING: Danger – Rotating blades. Keep hands, feet, hair and clothing away from the moving parts of the shredder. Do not reach into the feed opening or the discharge chute.



There is a risk that some objects could be thrown out by the shredder. Keep bystanders away.



WARNING: If the cord becomes damaged or entangled during use, do not touch. Immediately disconnecting the plug from the supply or disconnect the shredder from the mains supply also when not in use or during work on the machine itself (e.g., changing parts, repairs, cleaning and adjustment).



Safety Information

Important - Please read these instructions fully before starting assembly

Warning Symbols



WARNING: Always wear safety glasses, ear muffs.



WARNING: Do not use the shredder in the rain or damp conditions. Protect it from moisture.



WARNING: Wear protective gloves



WARNING: Take great care that no metal parts, stones, bottles, cans or other debris are included when you introduce material into the device.



WARNING: Take great care that no metal parts, stones, bottles, cans or other debris are included when you introduce material into the device.



WARNING: Always disconnect from the mains before manipulating the machine



Always wait until all the moving parts of the product have come to a complete stop before touching them. The blades will continue to rotate for approx 5 seconds after it has been switched off.



Do not use as a step.



Guaranteed sound power level 112 dB (A)



Safety Information

Important - Please read these instructions fully before starting assembly

Warning Symbols



The product complies with the applicable European directives and an evaluation method of conformity for these directives was done.



The product complies with the applicable UK Directives, and an evaluation method of conformity for these directives was done.

IPX4 Protection degree against water

P40 Intermittently operation mode, each cycle includes 40s at rated power input and 60s at no load.



Safety Information

Important - Please read these instructions fully before starting assembly

Safety warning for shredder

**IMPORTANT
READ CAREFULLY BEFORE USE
KEEP FOR FUTURE REFERENCE**

Safe operating practices

Training

- **Read the instructions carefully.** Be familiar with the controls and the correct use of the machine.
- **Never allow children or people unfamiliar with these instructions to use the machine.** Local regulations can restrict the age of the operator.
- **Keep in mind, that the operator or user is responsible for accidents or hazards occurring to other people or their property.**

Preparation

Obtain ear protection and safety glasses. Wear them at all times while operating the machine.

While operating the machine always wear substantial footwear and long trousers. Do not operate the machine when barefoot or wearing open sandals. Avoid wearing clothing that is loose fitting or that has hanging cords or ties.

Operate the machine in a recommended position and only on a firm, level surface.

Do not operate the machine on a paved or gravel surface where ejected material could cause injury.

Before using, always visually inspect to see, that the shredding means, shredding means bolts and other fasteners are secure, the housing is



Safety Information

Important - Please read these instructions fully before starting assembly

Safety warning for shredder

undamaged and that guards and screens are in place. Replace worn or damaged components in sets to preserve balance. Replace damaged or unreadable labels.

Before use check the supply and extension cord for signs of damage or aging. If the cord becomes damaged during use, disconnect the cord from the supply immediately. DO NOT TOUCH THE CORD BEFORE DISCONNECTING THE SUPPLY. Do not use the machine if the cord is damaged or worn.

Never operate the machine while people, especially children, or pets are nearby.

Operation

- Before starting the machine, make certain that the feeding chamber is empty.
- Keep your face and body away from the feed intake opening.
- Do not allow hands or any other part of the body or clothing inside the feeding chamber, discharge chute, or near any moving part.
- Keep proper balance and footing at all times. Do not overreach. Never stand at a higher level than the base of the machine when feeding material into it.
- Always stand clear of the discharge zone when operating this machine.
- When feeding material into the machine be extremely careful that pieces of metal, rocks, bottles, cans or other foreign objects are not included.
- If the cutting mechanism strikes any foreign objects or if the machine should start making any unusual noise or vibration, immediately shut off the power



Safety Information

Important - Please read these instructions fully before starting assembly

Safety warning for shredder

source and allow the machine to stop. Disconnect the machine from the supply and take the following steps before restarting and operating the machine:

- i) inspect for damage;
 - ii) replace or repair any damaged parts;
 - iii) check for and tighten any loose parts.
- Do not allow processed material to build up in the discharge zone; this may prevent proper discharge and can result in kickback of material through the feed intake opening.
 - If the machine becomes clogged, shut-off the power source and disconnect the machine from supply before cleaning debris.
 - Never operate the machine with defective guards or shields, or without safety devices, for example debris collector in place.
 - Keep the power source clean of debris and other accumulations to prevent damage to the power source or possible fire.
 - Do not transport this machine while the power source is running.
 - Stop the machine, and remove plug from the socket. Make sure that all moving parts have come to a complete stop
 - whenever you leave the machine,
 - before clearing blockages or unclogging chute,
 - before checking, cleaning or working on the machine.
 - Do not tilt the machine while the power source is running.



Safety Information

Important - Please read these instructions fully before starting assembly

Maintenance and storage

- When the machine is stopped for servicing, inspection, or storage, or to change an accessory, shut off the power source, disconnect the machine from the supply and make sure that all moving parts are come to a complete stop. Allow the machine to cool before making any inspections, adjustments, etc. Maintain the machine with care and keep it clean.
- Store the machine in a dry place out of the reach of children.
- Always allow the machine to cool before storing.
- When servicing the shredding means be aware that, even though the power source is switched off due to the interlock feature of the guard, the shredding means can still be moved.
- Replace worn or damaged parts for safety. Use only genuine replacement parts and accessories.
- Never attempt to override the interlocked feature of the guard.

Additional safety instructions for units with bagging attachments

Switch-off the machine before attaching or removing the bag.

Recommendation

The machine should be supplied via a residual current device (RCD) with a tripping current of not more than 30 mA.



Safety Information

Important - Please read these instructions fully before starting assembly

Additional Safety Instructions



WARNING

Never allow children, persons with reduced physical, sensory or mental capabilities or lack of experience and knowledge or people unfamiliar with these instructions to use the machine, local regulations may restrict the age of the operator



WARNING

Never operate the machine with defective guards or shields, or without safety devices, or if the cord is damaged or worn



WARNING

Do not overreach and keep the balance at all times, always be sure of the footing on slopes and walk, never run



WARNING

Do not touch moving hazardous parts before the machine is disconnected from the mains and the moving hazardous parts have come to a complete stop

- Do not connect a damaged cord to the supply or touch a damaged cord before it is disconnected from supply. A damaged cord can lead to contact with live parts.
- Keep extension cords away from moving hazardous parts to avoid damages to the cords which can lead



Safety Information

Important - Please read these instructions fully before starting assembly

Additional Safety Instructions

to contact with live parts

- If the supply cord is damaged, it must be replaced by the manufacturer, its service agent or similarly qualified persons in order to avoid a hazard.
- Avoid using the machine in bad weather conditions especially when there is a risk of lightning

Special Safety Instructions

- Only operate the machine in open space (e.g. not close to a wall or other fixed object) and on a firm, level surface.
- Remember that operating the starting mechanism on engine powered machines will still cause the cutting means to move
- Keep all guards and deflectors in place and in good working condition
- Shut off the power source and disconnect from supply whenever you leave the work area
- When the machine is stopped for servicing, inspection, or storage, or to change an accessory, shut off the power source, disconnect from supply, make sure that all moving parts have come to a complete stop and, where a key is fitted remove the key. Allow the machine to cool before making any inspections, adjustments, etc.
- Keep the motor cooling vents clean of debris and other accumulations to prevent damage to the motor or possible fire.
- Children should be supervised to ensure that they do not play with the appliance.



Safety Information

Additional safety instructions

Residual risks

Even if you are operating this product in accordance with all the safety requirements, potential risks of injury and damage remain. The following dangers can arise in connection with the structure and design of this product:

- Health defects resulting from vibration emission if the product is being used over long periods of time or not adequately managed and properly maintained.
- Injuries and damage to property due to broken cutting attachments or the sudden impact of hidden objects during use.
- Danger of injury and property damage caused by flying objects.



WARNING!

This product produces an electromagnetic field during operation! This field may under some circumstances interfere with active or passive medical implants! To reduce the risk of serious or fatal injury, we recommend persons with medical implants to consult their doctor and the medical implant manufacturer before operating this product!

Part List

Parts in the package

- A. Shredder housing
- B. Stand x2
- C. Debris bag
- D. Wheel capsx2
- E. Wheels x2
- F. Plunger
- G. Screws (short x 2, long x 2)
- H. Hex wrench
- I. Axe (includes 6 x washers, 4 x split pins and 2 x axle sleeves)
- J. Stand supporting

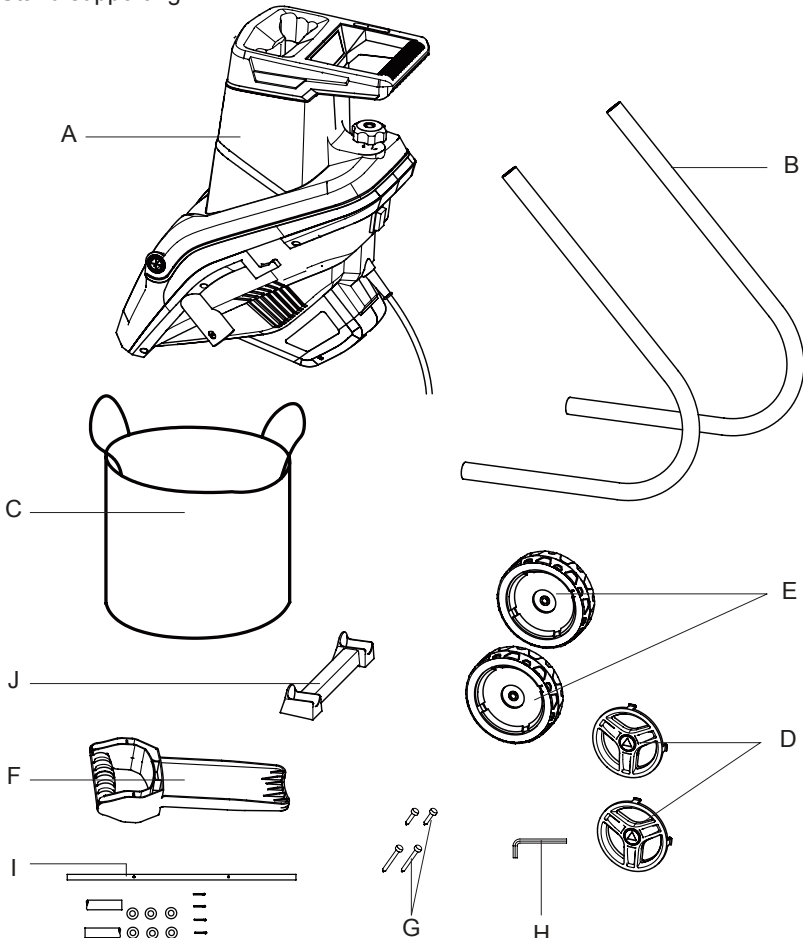

Part List

Parts of the shredder

- | | |
|---------------------|--------------------------|
| 1. Transport handle | 7. Motor housing |
| 2. Hopper | 8. Discharge chute stand |
| 3. Locking knob | 9. Stand |
| 4. On/Off switch | 10. Wheel |
| 5. Power cord | 11. Plunger |
| 6. Debris bag hook | 12. Feeding tunnel |

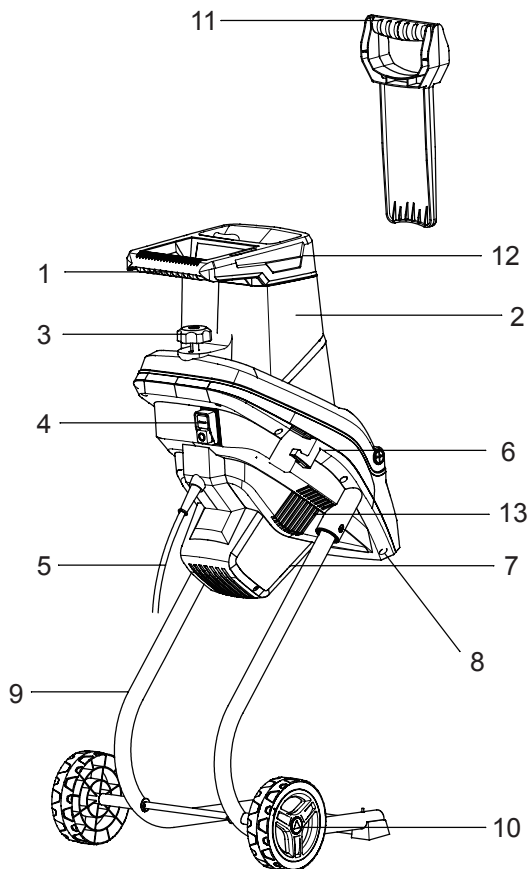

Assembly

Preparing to assemble

Caution! Before starting the machine, check the protective devices and fastening elements to avoid damage.

Assemble the stand

Please follow assembly instructions as below:

1. Open the packaging and remove the machine from package.
2. Assemble the axle through the hole of the stand and fix it with a washer and a split pin.

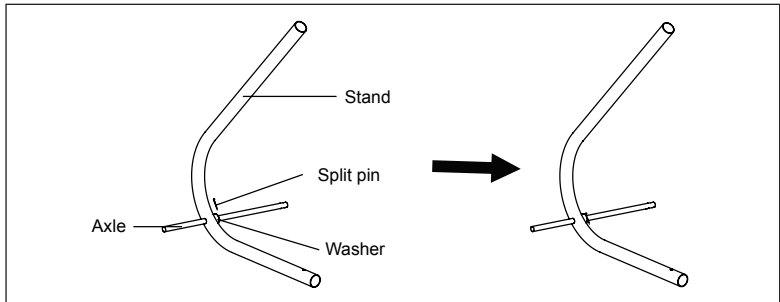

WARNING! Do not open the split pin with bare hands. Please wear protective gloves and use a tool to open the split pin. The tip of the split pin could cause injury.

3. Fix the split pin by splitting it as shown on the left and then assemble the other stand.

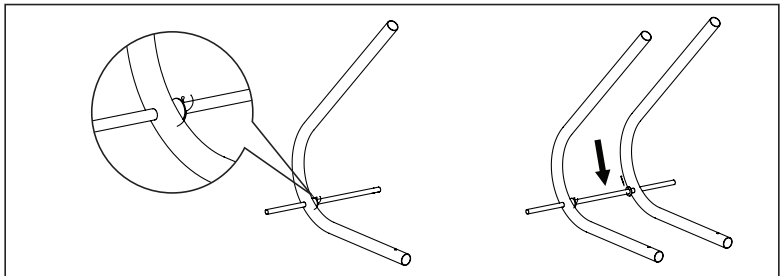

Assembly

Assemble the wheel

4. After finishing the stand assembly, the next step is to put the axle sleeve on the axle and fix it with a washer and a split pin. Assemble the wheel cap after fix the split pin by opening it.

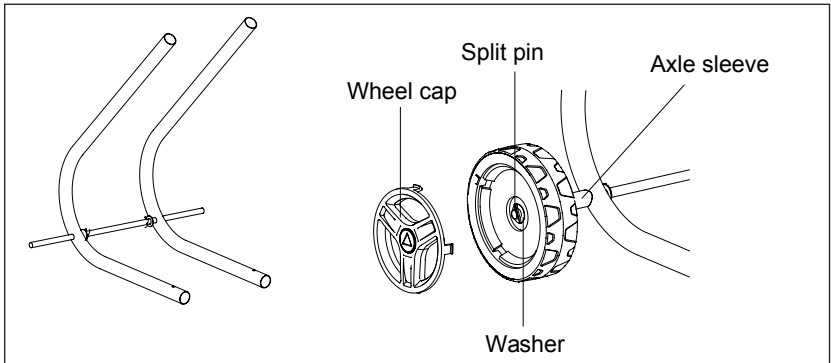

Note: The split pin needs being fixed as shown as below or it cannot fix the axle and wheel.

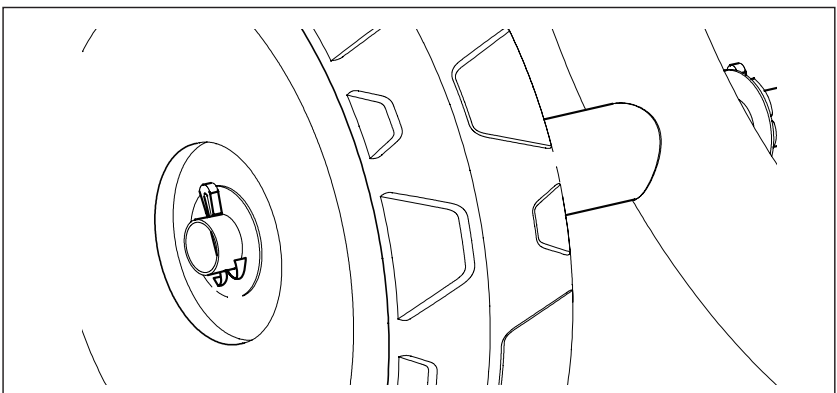

Assembly

Attach the stand and motor housing

5. Assemble another wheel and then fix the stand supporting to stand with 2 long screws.

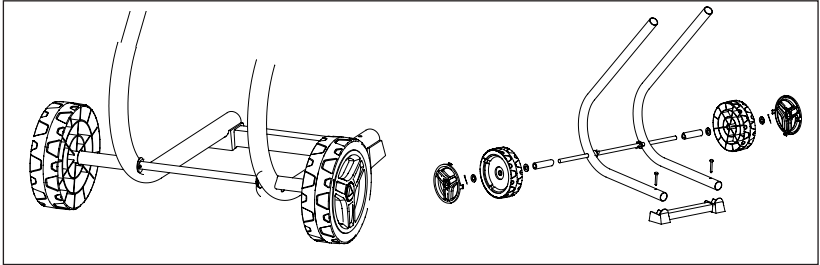

6. Insert the stand to the motor housing, align the holes on the housing and stand, and fix with the 2 short screws using suitable screwdriver.

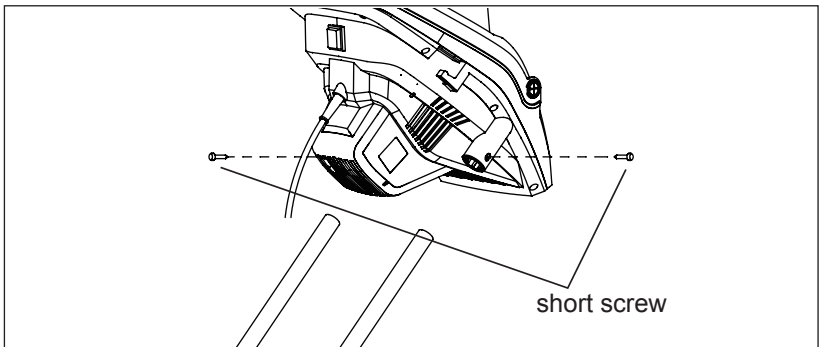

Assemble the collection bag

7. Hang the debris bag onto the debris bag hook as shown below.

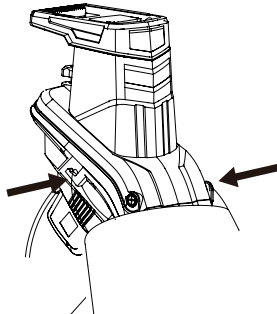

Preparation

Check machine status before using

1. Inspect the material to be shredded before starting. Remove any objects that are not suitable for shredding or could entangle the blades metal parts, stones, bottles, cans, etc.
2. Place the appliance on a firm level ground and do not move it during operation. Make sure the locking knob (3) is securely tightened.

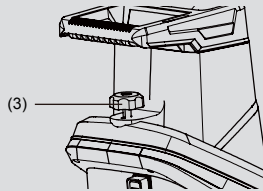

3. Connect the plug to the mains socket.

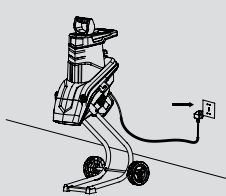

4. Check the plunger (11) status and do not use it if it is broken.

Operation

Starting

NOTE! Before using the machine, read the instructions thoroughly and acquaint yourself with the features of the machine.

Before inspecting or servicing any part of the machine, switch off, pull the plug from the mains and make sure that all moving parts have come to a complete stop.

- Allow the cutting blades to reach full speed before feeding the material into the feeding funnel.
- Use the machine to shred the following materials only:
Owing to the different shapes of branches, it is recommended to shred branches up to 40mm in diameter.
 - Waste from pruning bushes
 - Waste from trimming hedges
 - Plant material and other garden waste
 - Leaves and plant roots (remove soil from roots before shredding)
- Do not put soft waste such as kitchen rubbish into the shredder.
- Feed the material to be shredded into the corner of the hopper, if it is not too bulky, the material will be drawn in by the blades.



WARNING! Long material extending out from the machine could whip when being drawn in by the blades, therefore please keep a safe distance from the shredder.

- Ensure the shredded material can fall freely from the discharge chute.
- To make finer chippings the shredded material can be shredded for a second time.
- Do not allow the shredded material to build up to a level where it blocks the discharge chute. If the material builds up too far it could reach the cutting blades and be thrown out of the hopper.
- Fresh branches contains a large amount of water and sap that can stick to the shredder. To avoid this the material should be left for a few days to dry out.
- If during cutting the blade stalls, stop the shredder immediately and disconnect it from the mains supply before investigating the cause.
- Remove any jammed debris from the blades and examine them for any damage before re-commencing shredding.
- If the blade has stalled for more than 5 seconds the safety overload switch will automatically switch the machine off. Allow the machine to

Operation

Starting

cool down for at least 1 minute before re-starting.

- If the cutting mechanism strikes any foreign object or if the shredder starts to make any unusual noise or vibration, immediately switch off and allow the cutting blades to stop. Pull the plug from the mains supply and take the following steps:
 - i) Inspect for damage.
 - ii) Replace or repair any damaged parts.
 - iii) Check for and tighten any loose parts.
- If the shredder becomes clogged, switch off and allow the cutting means to stop. Pull the plug from the mains supply before cleaning debris.
- Keep the motor cooling vents clear of debris and other accumulations to prevent damage to the motor or possible fire.
- Switch off, allow the cutting blades to stop and pull the plug from the mains supply whenever you leave the work area.
- Do not allow processed material to build up in the discharge zone; this may prevent proper discharge and can result in kickback of material through the feed intake opening.

Starting and Stopping the shredder

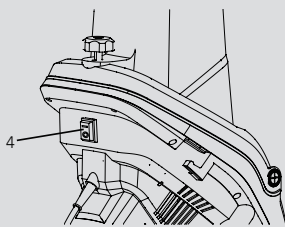

Make sure that the mains voltage matches the details on the type plate.

1. Connect the extension cable if needed (2x1.5mm² extension cable).
2. Turn the machine on to “I” using the on/off switch (4).
3. To switch off, turn the on/off switch back to position “0”.

Overload protection

If overloaded, e.g.. branches which are too thick, the machine switches off automatically. Please operate switch into 0 immediately, and allow the machine to cool down for a few minutes.

To restart, allow the machine to cool and switch back on.

Operation

Restart

If the power supply is lost due to overload the machine does not switch itself back on. To switch the machine back on, turn the on/off switch back to “I”.

Removing blockages

Before any maintenance or cleaning work, turn the machine off, pull out the mains plug and wait for the blades to stop. There is a risk to life and limb through electric shock, fire and rotating blades.

- Ensure that the power cable is disconnected from the mains supply.

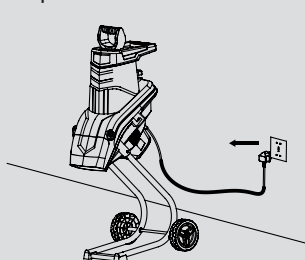

- Release the locking knob (3).

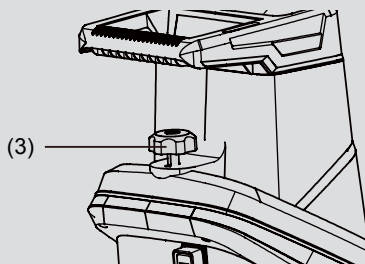

- Tilt the front section of the shredder's housing forwards.
- You can now remove the blockage in the machine.

Note: The machine features a locking knob (3)

The housing lock has to be tightened again by hand as otherwise the machine will not be able to be started later.



WARNING! NEVER slacken off the tightening knob without having turned off the On/Off switch and pulled the plug out of the socket.



WARNING! The shredder will stop within 5 seconds after switching off.

Operation

Using the Plunger

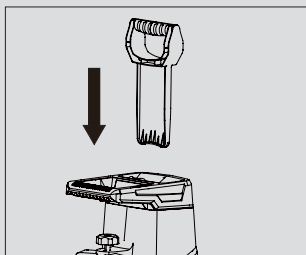

A plunger (11) is provided to aid feeding less bulky material such as small twigs, leaves and other garden waste into the feed funnel.

1. Load the material into the feed funnel.
2. Insert the plunger into the feed funnel pushing the material onto the blade disc.
3. Wait until all the material has been shredded before adding more material.

NOTE: Your fingers must never enter the feed funnel.

NOTE: Never use the tool if the hopper is not fitted.

NOTE: Do not overreach.

Collect the shredded material

Shut-off the power unit before attaching or removing the bag.

You can use either the collection bag supplied or place the shredder on a tarpaulin sheet to catch the shredded material.

When using the collection bag, you need to fit the collection bag hooks onto the sides of the discharge chute.



WARNING! The ventilation slots on the machine body must never be covered by the collection bag or shredded material.

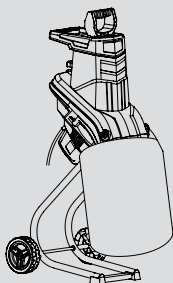

Maintenance and Storage

Replace the blades

1. Ensure that the shredder is switched off and disconnected from the mains supply.
2. Remove the top feed assembly by unscrewing the locking knob (3) securing it to the body of the machine.

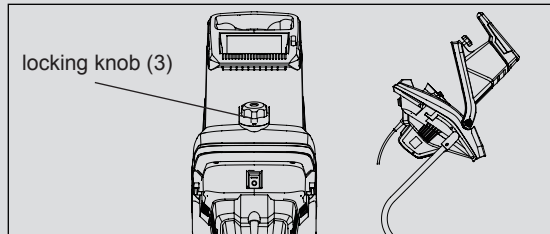

3. The blades have two cutting edges. When the blades become worn, they can be reversed to use the second cutting edge.
4. It is recommended that work gloves be used when replacing the blades.
5. Lock the blade disc using screwdriver (not supplied). Unscrew the two inner hexagonal headed screws using hex wrench (H) and note the position of the cutting angle of the blade.
6. Remove the blade and rotate it through 180 degrees and fit the blade to the blade disc.
7. Repeat this for the other blade.

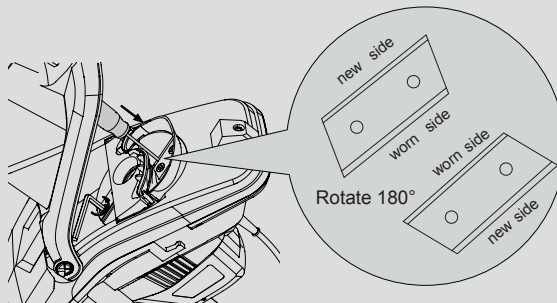

When both cutting edges of the blade become worn, they must be replaced as a pair. The blades can be re-sharpened, but this must be done by an experienced person using an oil stone. We do not recommend this be done as the weight of each blade is critical to maintain the balance of the cutting disc. Any imbalance could cause damage to the machine and possible injury to the operator.

Maintenance

Maintenance and Cleaning



Leave all work not described in this manual to an authorised customer service centre. Only use original parts.

Wear hand protection when working on the blade.

Before starting to service or clean the unit, turn off the unit, pull the power plug, and wait until the blade stands still. Risk of injury from electric shock, fire and rotating blades.

General Cleaning and Servicing

Do not spray water onto the shredder. Electric shock hazard.

- Always keep the shredder, wheels and air vents clean. Use a brush or cloth to clean it, avoid cleaners and solvents.
- Always check that the shredder and especially the guards are not worn down or damaged but firmly attached before use.
- Check that the nuts, bolts and screws are tight.
- Keep the shredder in a dry place out of children's reach. Do not cover the shredder in nylon bags, as moisture may develop.

Consumable parts

Part number	Part Name
AAAJ071018	Collection bag
AAAJ071008	Blade

Technical Data

Technical Data Table

Model No.	MCEIS24
Rated voltage	230-240V~ 50Hz
Rated power	2400W(P40)
Collection bag	50L
Max. cutting dia.*	45mm
No-load speed	3800/min
Moisture resistance protection degree	IPX4
Sound pressure level(LpA)	97.5 dB(A),K=3.0 dB(A)
Measured sound power level (LwA)	110.97 dB(A),K=0.35 dB(A)
Guaranteed sound power level (LwA)	112dB(A)
Weight	8.5 kg
Insulation protection class	II

* The max. branch thickness that can be shredded is dependent on the type of wood and the quality of the material being cut.

For hard wood (e.g. oak/beech branches), the max. branch thickness that can be shredded is less than for soft wood (e.g. pine/spruce wood). For dry or knotted wood, the cutting thickness may also be less.

The equipment is intended only for use in premises in which the current bearing capacity of the network is ≥ 100 A per phase and which are supplied by a distribution grid with a nominal voltage of 230/240V. You may need to check with your electricity provider if in any doubt.

If in doubt, check with your local electricity provider to verify that your mains socket has enough continuous current carrying capacity for this unit.

Noise and vibration values were determined according to the standards and stipulations mentioned in the declaration of conformity.

Technical or visual modifications may be carried out during our continuous product improvement programmes. All dimensions, references and information of this instruction manual are therefore subject to change without prior notice. Legal claims, which are made on the basis of the instruction manual, cannot thus be considered as valid.

The sound value(s) have been determined according to noise test code given in EN 60335-1 and EN 50434. The sound intensity level for the operator may exceed 80dB(A) and ear protection measures are necessary

Technical Data

- The declared vibration value has been measured in accordance with EN50434 test method and may be used for comparing one product with another. The declared vibration value may also be used in a preliminary assessment of exposure.



WARNING! The vibration and noise emission during actual use of the machine can differ from the declared total value depending on the ways in which the tool is used especially what kind of workpiece is processed;

The need to identify safety measures to protect the operator that are based on an estimation of exposure in the actual conditions of use (taking account of all parts of the operating cycle such as the times when the tool is switched off and when it is running idle in addition to the trigger time).

Troubleshooting

Troubleshooting

The following table provides solutions to common problems encountered with the shredder.

Fault	Possible Cause	Solution
Motor will not start	No mains power supply	Check the socket, cable, lead and plug for damage, and if necessary, have any damage repaired by qualified repair personnel.
	Overload protection tripped	Allow the machine to cool down for at least 1 minute before re-starting. To switch the machine back on, turn the on/off switch back to "I"
	Lid of housing not closed properly	Tightly screw in the housing interlock
Garden waste is not drawn in	Shredding material is too soft	Use the pusher or add dry twigs/ branches
	Unit blocked	See section "Removing Blockage"
	Shredding material in discharge duct	Remove shredding material from discharge duct
	Blades are blunt	Check and turn, sharpen or replace blades as necessary (see section

Recycling and Disposal

Recycling and disposal



The product comes in a package that protects it against damage during shipping. Keep the packaging until you are sure that all parts have been delivered and the product is functioning properly. Recycle the packaging afterwards.

Old products are potentially recyclable and do not, therefore, belong in your household waste. You are requested to assist us and our contribution to saving resources and protecting the environment by handing this product at an equipped collection centre.

Getting Help

Customer Helpline 0345 605 2062

Our dedicated UK based customer service centre is open 7 days a week to assist you with assembly, parts queries and technical support. We are open during office hours. Our experts are here to get you back enjoying your garden in no time.

Calling our service does not affect your statutory rights.
UK/N.I. 0345 605 2062

Guarantee

Dear Customer,

In the unlikely event that your device develops a fault, please contact our customer service department on the following telephone number shown below (0345 605 2062).

1. These guarantee terms cover additional guarantee rights and do not affect your statutory warranty rights.
Claims must be accompanied by Proof of Purchase. This must be in the form of a sales receipt or bank statement and must show that the product has been purchased within 2 years prior to the claim, from the retailer that it was originally sold to.
2. Our guarantee covers problems caused by material or manufacturing defects, and will result in the repair of these defects or replacement of the device with a like for like or similar article. Please note that our devices have not been designed for use in commercial, trade or industrial applications. Consequently, the guarantee is invalidated if the equipment is used in commercial, trade or industrial applications or for other equivalent activities.
3. The guarantee is valid for a period of 2 years starting from the purchase date of the device. Guarantee claims should be submitted before the end of the guarantee period within two weeks of the defect being noticed. No guarantee claims will be accepted after the end of the guarantee period. The original guarantee period remains applicable to the device even if repairs are carried out or parts are replaced. In such cases, the work performed or parts fitted will not result in an extension of the guarantee period, and no new guarantee will become active for the work performed or parts fitted. This also applies when an on-site Service is used.
4. Please keep your sales receipt in a safe place. If the defect is covered by our guarantee your device will either be repaired under the terms of guarantee or we will send you a replacement device. This device may be re-conditioned or Like for like replacement.