

GB

42.7cc Brushcutter/ Line Trimmer

Original Instructions

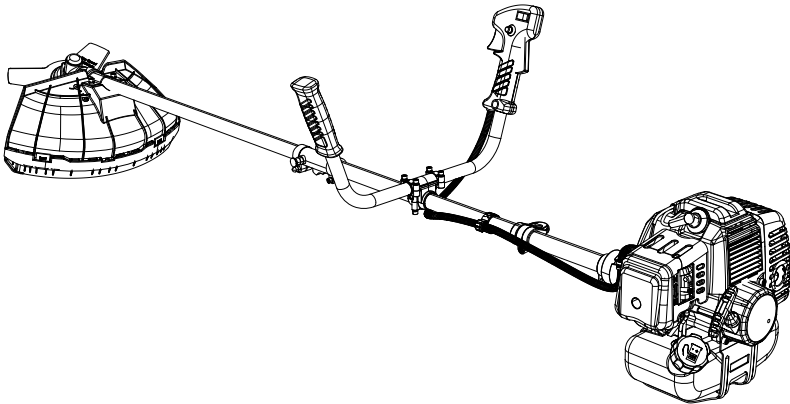

ASSEMBLY & STARTING
GUIDANCE VIDEO



**READ & UNDERSTAND
INSTRUCTION MANUAL**



Save all warnings and instructions for future reference.

YARD FORCE

BC415 Original Instruction

CONTENT

Intended use	03
Important safety warnings	03
Symbols	09
Technical data	12
Description of product	13
Installation	15
Operation	20
Maintenance and storage	28
Troubleshooting	35
Declaration of conformity	36
Disposal	37

INTENDED USE

This machine may only be used outdoors for cutting brush or grass and in combination with the original cutting blade and spool. This machine is not designed for heavy-duty or commercial use. Any use of the machine that deviates from its intended use, and is not included in these instructions, is considered unauthorised use and relieves the manufacturer from his or her legal liability.

IMPORTANT SAFETY WARNINGS



WARNING! Read all safety warnings and instructions.

Failure to follow the warnings and instructions may result in serious injury. Save all warnings and instructions for future reference.

- Always ensure anyone intending to operate this machine is fully conversant with the contents of this instruction manual prior to assembling, maintaining or operating the machine.
- Perform assembly operations exactly as described in this manual. Failure to observe this warning may lead to serious injury, death, or damage to the machine.
- Always take care when removing the packaging, to prevent damage to you or to the machine.

IMPORTANT! Before assembling the machine, check all the parts indicated in the manual are in the box. Inspect all the parts for signs of damage. Do not assemble the machine if you observe any damaged components.

NOTE! This machine complies with the Noise Emission Directive 2000/14/EC.

General safety

- Keep this operating and maintenance manual in a safe place for reference at a later date.
- Read the instructions carefully. Be familiar with the

IMPORTANT SAFETY WARNINGS

controls and the proper use of the brushcutter.

- Never allow children or people unfamiliar with the instructions to use the machine. Local regulations can restrict the age of the operator.
- Never trim while people, especially children or pets, are nearby. Keep in mind that the operator or user is responsible for accidents or hazards occurring to other people or their property.
- This brushcutter is not intended for use by people (including children) with reduced physical, sensory or mental capabilities, or lack of experience and knowledge, unless they have been given supervision or instruction concerning the use of the brushcutter by a person responsible for their safety.
- Do not touch the rotating spool.

Personal safety

- Do not allow children or untrained individuals to use this cutter.
- Never start or run the engine in an enclosed or poorly-ventilated area; breathing exhaust fumes can kill.
- Clear the work area before each use. Remove all objects, such as rocks, broken glass, nails, wire, or other such debris, which can be thrown or become entangled in the cutting line.
- Wear safety glasses or goggles when operating this machine.
- Wear suitable, long trousers, boots, and gloves. Do not wear loose fitting clothing, shorts, or go barefoot. Do not wear jewellery of any kind.

IMPORTANT SAFETY WARNINGS

Operation safety

- Never operate this unit on the operator's left side.
- Long hair below shoulder level should be secured, to prevent entanglement in moving parts.
- Keep all bystanders, children and pets at least 15m (50ft.) away.
- Do not operate the brushcutter when you are tired, ill, or under the influence of alcohol, drugs, or medication.
- Do not operate the brushcutter in poor lighting.
- Keep firm footing. Do not overreach. Overreaching can result in loss of balance or exposure to hot surfaces.
- Keep your body away from any moving parts.
- To avoid hot surfaces, never operate the unit with the bottom of the engine above waist level.
- Do not touch the area around the exhaust or cylinder of the unit; these parts get hot during operation.
- Always stop the engine and remove the spark plug connector lead before making any adjustments or repairs, except for carburettor adjustments.
- Inspect the unit for loose fasteners, fuel leaks, etc., before each use. Replace any parts found to be worn or damaged.
- The string head will rotate during carburettor adjustments and engine starting.
- It has been reported that vibrations from hand-held tools may, in certain individuals, contribute to a condition called Raynaud's Syndrome. Symptoms may include: tingling, numbness and blanching of the fingers, usually apparent upon exposure to cold. Hereditary factors, exposure to cold and dampness,

IMPORTANT SAFETY WARNINGS

diet, smoking and work practices are all thought to contribute to the development of these symptoms. It is currently unknown what level of vibration, if any, or duration of exposure may contribute to this condition. Measures can be taken by the operator to possibly reduce the effects of vibration:

- a. Keep your body warm in cold weather. When operating the unit, wear gloves to keep the hands and wrists warm. It is reported that cold weather is a major factor contributing to Raynaud's Syndrome.
 - b. After each period of operation, exercise to increase blood circulation.
 - c. Take frequent work breaks. Limit the amount of exposure per day.
 - d. Keep the brushcutter well maintained, fasteners tightened and worn parts replaced.
- If you experience any of the symptoms of this condition, immediately discontinue use and see your doctor.
 - Mix and store fuel in an approved petrol container, clearly marked for 2-stroke fuel use.
 - Mix fuel outdoors where there are no sparks or flames. Wipe up any fuel spillage. Move 10m (30ft.) away from the refuelling site before starting the engine.
 - Stop the engine and allow it to cool before refuelling or storing the unit.
 - Before transporting in a vehicle, allow the engine to cool, empty the fuel tank and secure the cutter from moving.
 - Replace the cutting head if cracked, chipped, or

IMPORTANT SAFETY WARNINGS

damaged in any way. Be sure the cutting head is properly installed and securely fastened. Failure to do so can cause serious injury.

- Make sure all guards, straps, and handles are properly and securely attached.
- Use only the manufacturer's replacement cutting line in the cutting head. Do not use any other cutting attachment. To install any other brand of cutting head on this machine may result in serious personal injury.
- Never operate the unit without the safety guard in place and in good condition.
- Maintain a firm grip on both handles while trimming. Keep the cutting line below waist level. Never cut with the cutting line located over 76cm (30in.) above the ground.

Using brushcutter attachment safely



WARNING! Danger of injury! The machine must not be used to cut hedges, hard branches and wood, or to crush material for compost. Do not use it to cut grass that is not on the ground, e.g. grass growing on walls, rocks, etc.



WARNING! Danger of injury! Rotating blades may lead to serious injuries by cutting or amputating parts of the body.

- Always have your arms and legs at a safe distance from the cutting mechanism, in particular after turning the engine on.
- Never touch under the housing body when the engine is running. Safety gloves must be used at all times.

IMPORTANT SAFETY WARNINGS

- Never use the brushcutter without the protective guard cover.
- After the brushcutter is turned off, the cutting head keeps rotating for several seconds. Keep your arms and legs at a safe distance.
- Always carry the machine by its handle, keeping a safe distance from the blade to avoid the risk of injury.



WARNING! Sharp blades! Take extra care to avoid injury by the rotating blades. Always wear protective gloves.

- Never cross any gravel roads or paths whilst the machine is running.

Maintenance



WARNING! Switch off the engine before carrying out any work. Wait until all rotating parts have stopped and the cutter has cooled down.

1. Repairs and works specified in these Instructions may only be performed by qualified authorised staff. Use only original accessories and spare parts.
2. Keep the cutter clean at all times, in particular the air vents. Never spray water on the cutter body! Never clean the brushcutter and its components with solvents, or flammable or toxic liquids. Use only a damp cloth.
3. Check the cutting equipment function.
4. Only a regularly maintained and well treated brushcutter can serve as a satisfactory aid. Insufficient maintenance and care can lead to unforeseen accidents and injuries.

Safety symbols

The purpose of safety symbols is to attract your attention to any possible dangers. The safety symbols and their explanations deserve your careful attention and full understanding. The symbol warnings do not, by themselves, eliminate any danger. The instructions and warnings they give are no substitute for proper accident prevention measures.



WARNING: Be sure to read and understand all safety instructions within this operator's manual, including all safety alert symbols such as "**DANGER**", "**WARNING**", and "**CAUTION**" before using this tool. Failure to follow all instructions listed below may result in fire, severe personal injury or death.

SAFETY ALERT SYMBOLS: Indicate **DANGER**, **WARNING**, or **CAUTION**. May be used in conjunction with other symbols or pictographs.

Symbol meanings

This page depicts and describes safety symbols that may appear on this product. Read, fully understand and follow all instructions on the machine before attempting to assemble and operate.

SYMBOLS



Read the instructions and following warnings and safety instructions.



Wear eye and hearing protection (PPE). Where this is a risk of falling objects, wear head protection.



Wear protective gloves.



Wear slip-resistant footwear.



When working, the distance between the machine and bystanders shall be at least 15m.



Warning! Hot surface - Burns to fingers or hands.



The product complies with the applicable European directives and an evaluation method of conformity for these directives was done.



UK Conformity Assessed



Guaranteed sound power level data (114dB), in accordance with Directive 2000/14/EC.



Beware of thrown objects.



Beware of blade thrust!

SYMBOLS



Choke. Move choke lever to 'RUN' position. See Starting and Stopping Engine Section.



Choke. Move choke lever to 'CLOSED' position. See Starting and Stopping Engine Section.



Caution! Risk of injury due to running blades!



Wear respiratory protection.



Caution! Risk of suffocation!



No naked flame

TECHNICAL DATA

Model	BC415
Engine type	RY1E40F-5 (air cooled 2-stroke petrol engine)
Displacement (cc)	42,7cm ³
Engine power	1,25kW
Fuel Tank Volume	1200ml
Idle speed	3100±400 rpm
Clutch engaged speed	4500 rpm
Cutting width - grass trimmer	480mm
Cutting width - brushcutter	255mm
Diameter of cutting line	Ø2.4mm
Net weight approx.	6.8kg
Sound pressure level L _{PA} (dB)	99 dB(A) K=3 dB(A)
Sound power level L _{WA} (dB)	114 dB(A) K=3 dB(A)
Guaranteed sound power level L _{WA} (dB)	114 dB(A)
Vibration (m/s ²)	8.3m/s ² K=1.5m/s ²
Spark plug	L8RTF
Maximum rotational frequency of the spindle	6800 rpm (brushcutter) 6000 rpm (grass trimmer)

DESCRIPTION OF PRODUCT

Parts description

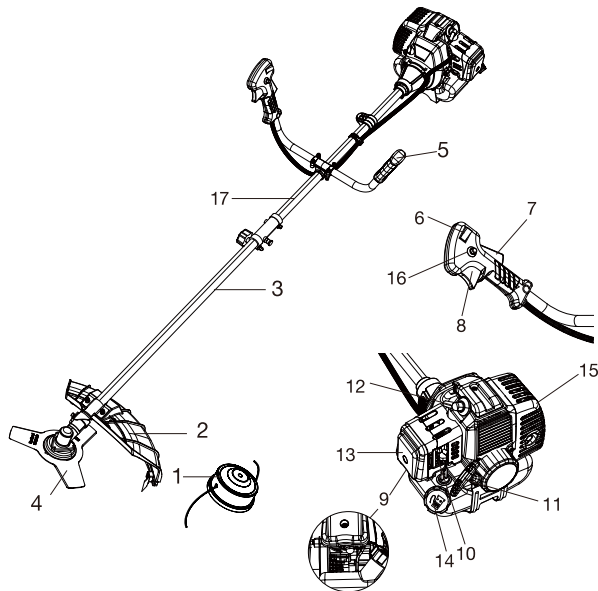

1. Bump feed line spool
2. Safety guard
3. Lower shaft
4. Cutting blade
5. Handle
6. On/Off switch
7. Throttle interlock
8. Throttle lever
9. Primer bulb
10. Choke lever
11. Recoil starter
12. Spark plug connector
13. Air filter housing cover
14. Fuel tank cap
15. Housing for engine cooler strap
16. Throttle lock
17. Upper shaft

DESCRIPTION OF PRODUCT

Check the delivery parts

Remove the machine from its packaging carefully and make sure that all of the following parts are present:

- a. Main unit
- b. Shaft
- c. Guard
- d. Spool
- e. Blade
- f. Double shoulder harness
- g. Fuel mixing bottle
- h. Hex key 5mm
- i. Hex key 4mm
- j. Spark plug wrench
- k. Wrench

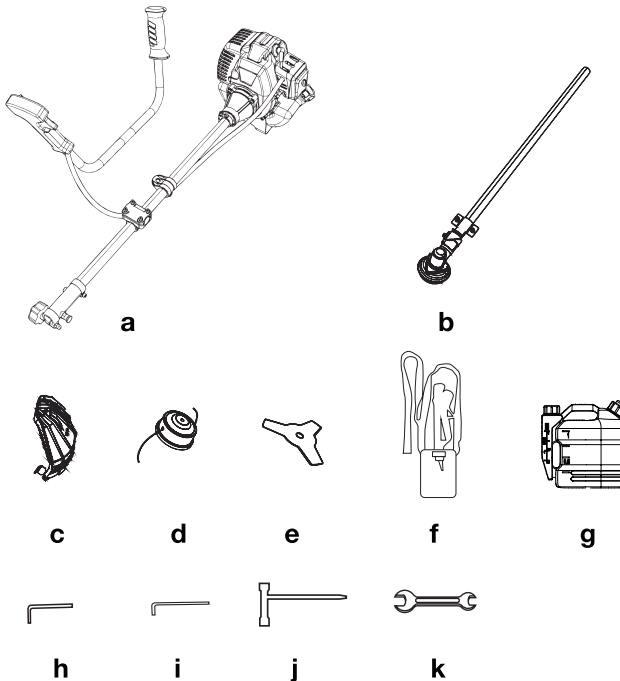

WARNING: If any parts are damaged or missing, do not operate this tool until these parts have been replaced. Failure to heed this warning could result in serious personal injury.



NOTE: Always recycle the packaging in accordance with local recycling guidelines.

INSTALLATION



WARNING: Take care when removing the packaging to prevent damage to the machine. Make sure that you have sufficient space to put the machine down. Keep your feet apart so that you have a stable position; bend at the knees and keep your back straight.

Always recycle the packaging in accordance with local recycling schemes.

When assembling this machine, please follow these instructions.

Assemble the bike handle on the machine

1. Assemble the handle

Assemble the handle on the machine:

- Using the hex key, loosen the four screws on the handlebar clamp.
- Place the middle of the handlebar on the handlebar clamp.
- Gently tighten the clamp screws. Adjust the position of the handles to be comfortable for operation.

Firmly tighten all the handlebar clamp screws.

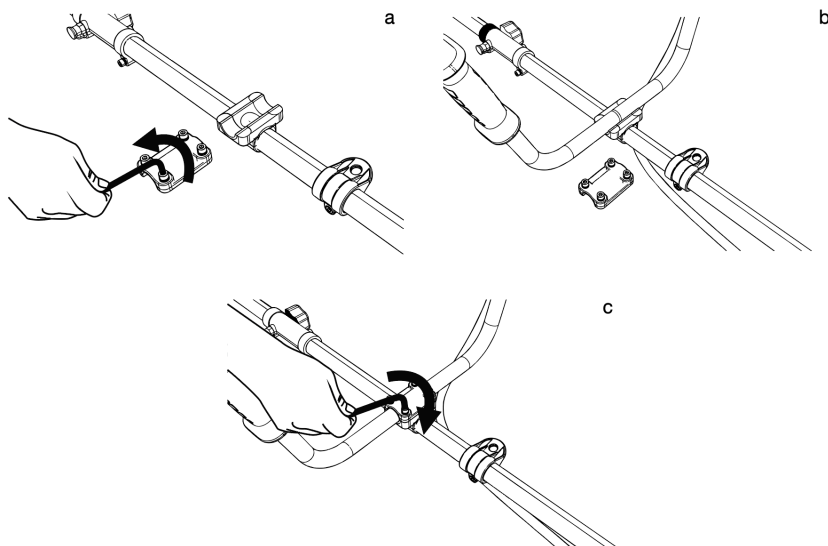

2. Remove the sleeve on the lower shaft



INSTALLATION

3. Join the upper and lower shafts

Loosen the knob(d). Pull the stop pin(a) and slightly rotate it to stop on the depth limit step. Insert the lower shaft(b) into the clamp(b). Pull the stop pin and slightly rotate it to be off the depth limit step. Rotate the lower shaft until the stop pin clicks into the hole(c) in the inserted lower shaft.

Make sure that the lower shaft is securely fixed.

Firmly tighten the knob on the clamp(d).

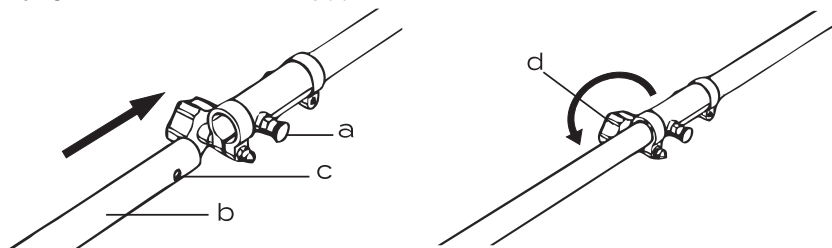

Assemble the safety guard

Remove the two screws from the top of the guard with the hex key.

Hold the guard underneath the bracket, insert the two screws through the bracket into the holes in the guard and retighten firmly. See pictures below.

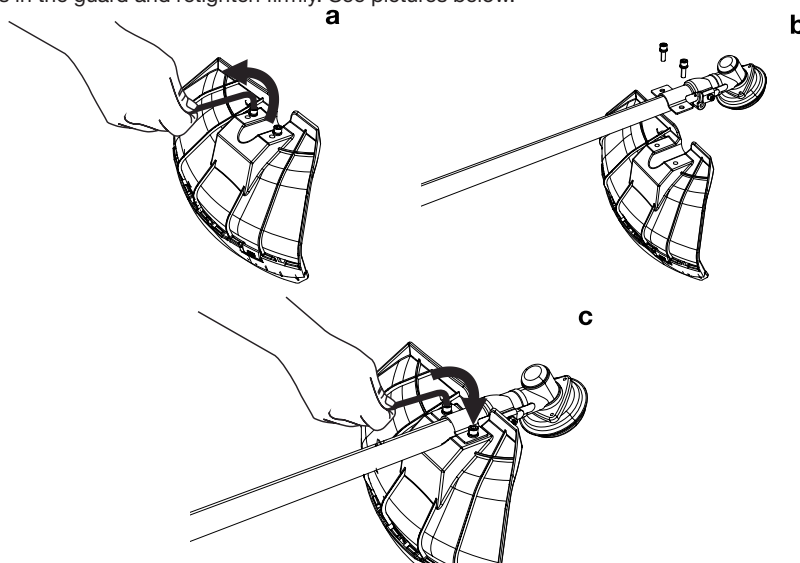

WARNING! Use only original manufacturer's replacement parts, accessories and attachments. Failure to do so can cause poor performance, possible injury and may void your warranty. Never use the machine without the guard assembled!

INSTALLATION

Assemble the cutting blade

Line up the two holes of the flange and shield (black one). Lock the spindle by inserting the 5mm hex key through the holes as shown in the picture below. Turn the wrench clockwise until the nut is released. Take out inner flange (a), outer flange (b), protect cover plate (c), nut (d).

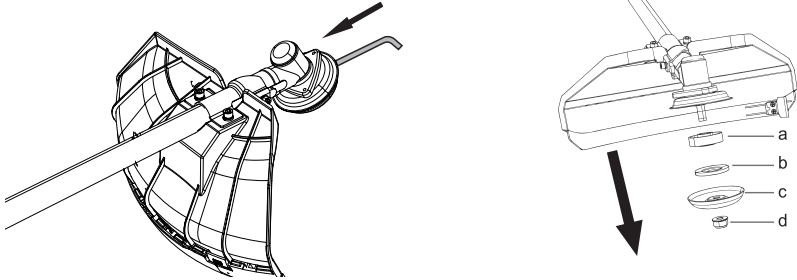

WARNING!

Make sure the cutting blade has been assembled correctly before use!

NOTE: Surface with printed specification on blade need to be on the upside. Use the screwdriver to hold the spindle and tighten the nut counter-clockwise. Use the wrench to tighten the nut and ensure the nut is tightened securely.

Assemble the line spool

Line up the two holes of the flange and shield (black one). Lock the spindle by inserting the 5mm hex key through the holes. Mount the inner flange (a) and line spool into the spindle and rotate counter-clockwise until the line spool is fitted securely. Remove the hex key to unlock the spindle.

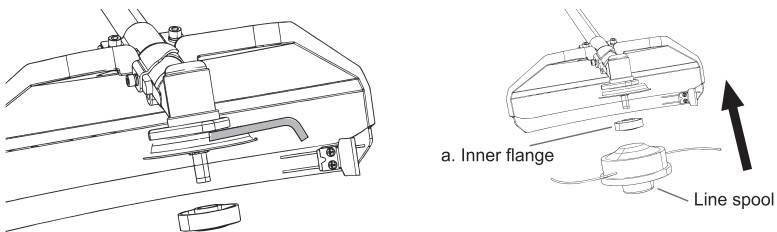

INSTALLATION

Fit the strap

The brushcutter must always be used with the double shoulder harness provided.

1. Put the left and right straps over the shoulders and secure with the quick-connect function of the harness. The finished set-up shall resemble the picture below.

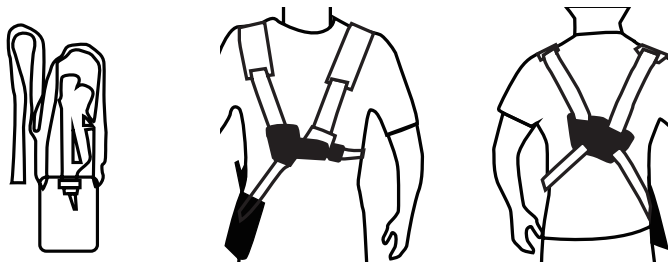

Note: At the front of the harness there is an easily accessible quick-release function. Use the quick release in any emergency situation that requires you to free yourself from the machine and harness.

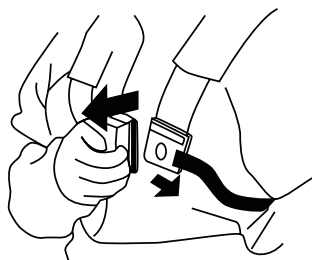

2. Hook the double belt harness into the strap support ring on the shaft tube.

INSTALLATION

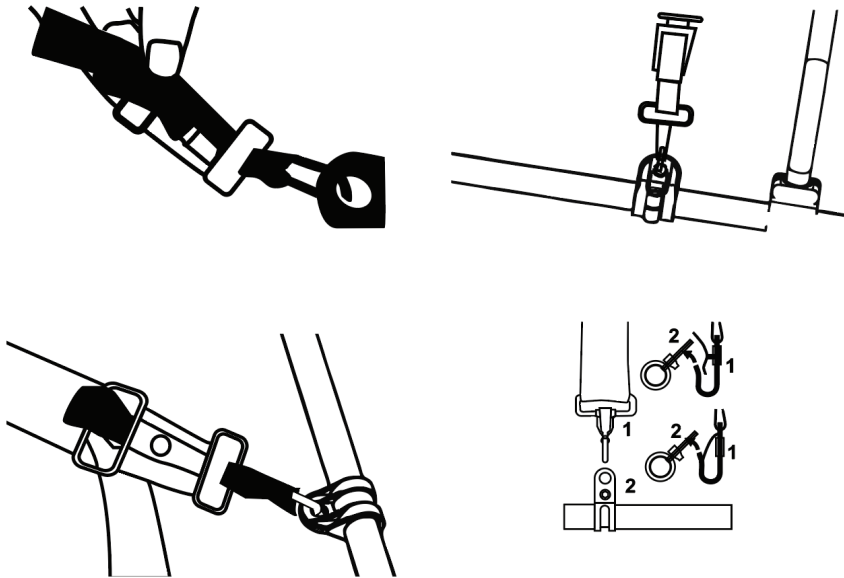

3. Adjust the length of the harness so that the hook is approximately 15 cm below your waist. In case of emergency, pull the rope of the quick release mechanism. The metal locking bar will be released automatically because of the weight of the machine, and the machine will drop away from you.

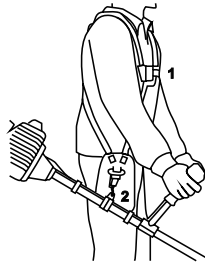

NOTE: Let the cutting attachment rest lightly on the ground. When using the brushcutter blade, it should balance about 10cm above the ground to prevent contact with stones and the like. Adjust the position of the harness clamp to balance the unit correctly.

OPERATION



WARNING: The product and the packaging are not children's toys! Children must not play with small plastic parts! There is a danger of choking and suffocation!



WARNING: Risk of cuts! Always switch the engine off before fuelling.

Filling the fuel tank



WARNING: No petrol has been added to the new machine due to transportation requirements. Be sure to fill it with mixed fuel before operation.



WARNING: When filling the tank:

The machine must always be stopped and cooled.

Never smoke during refueling. It must not have flames or sparks near the fuel. Before refueling, allow the machine to cool completely. Do not attempt to refuel when the engine is hot.

If fuel has been spilled, immediately stop refueling and do not start the engine. Clean up the spill and fill the machine in another location.

Never fill the fuel tank to the top of the bottle there is a risk of overflow.

Do not refuel in a closed and unventilated area.

The fuel used for this machine is a mixture of unleaded petrol and registered engine lubricant. Unleaded petrol is a quality petrol type. This will help to avoid damaging the fuel lines of the engine and other engine parts.

The recommended mixing ratio is **40:1** (make sure the mixing ratio is correct before filling the product).

1. Mixing (40:1)

- Mix in a clean, empty container (supplied).
- Open the left cover of the bottle as shown below, and fill it with 2-stroke oil as required up to the 0.5 or 1 scale mark indicated by the arrow.

Mixing (40 : 1)

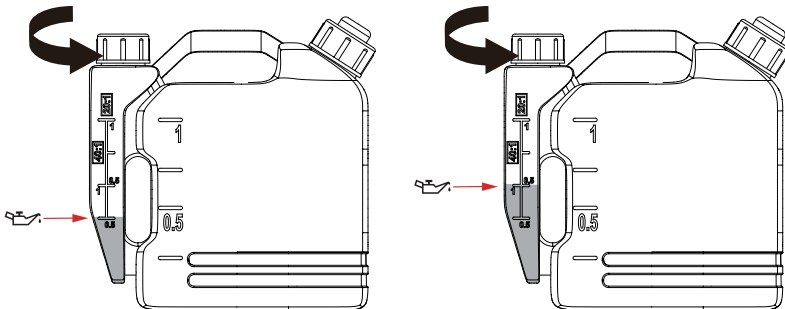

OPERATION

- c) Open the right cover of the bottle and take out included extension tube, and accordingly add unleaded petrol up to the 0.5 or 1 scale mark indicated by the arrow, in accordance with the amount of 2-stroke oil added previously (0.5 or 1).

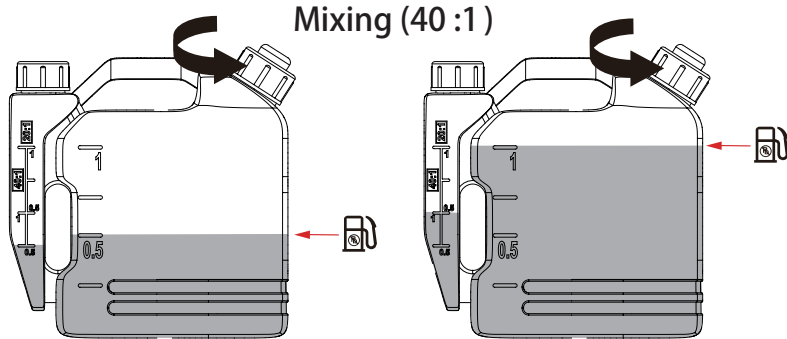

- d) Replace the fuel caps and make sure they are firmly secured and then grip the bottle with both hands, invert it and shake vigorously up and down to mix the engine oil and petrol thoroughly and evenly.
- e) You may use the included extension tube for the mixing bottle to facilitate refilling the mixed fuel into the machine.

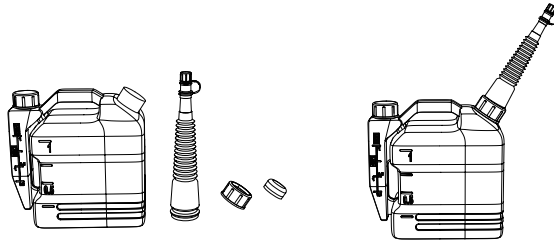

Note: The fuel must be kept in a clean and safe container and always closed.

If you are not using the product for a long time, remove the fuel mixture and add it to a container. Do not leave the fuel for a long time in the product. The fuel may clog the carburetor and the engine will not operate properly.

Note: Fuel becomes stale after 30 days and is no longer fit for use. Discard any fuel older than 30 days and use only fresh fuel.

When the fuel is no longer used or worn, please dispose of it in an authorised location. Check local laws regarding disposal of fuels.

When the fuel is no longer used or worn, dispose of it at an authorised waste disposal facility. Check local laws regarding disposal of fuels.



WARNING: Fuel stabilisers / enhancers are required for use with E10 fuel to prolong the life of the fuel, for easier starting, and performance.

OPERATION

2. Filling the fuel tank (40:1)



WARNING: Do not attempt to start engine if not following the instruction with wrong liquid or low quality oil filled in. This may cause engine failure. Contact an authorised service centre.

- Rotate it anti-clockwise and open the fuel tank cap.
- Fill the tank slowly with the mixture. Do not exceed the maximum capacity.
- Replace the cap on the fuel tank and tighten it.

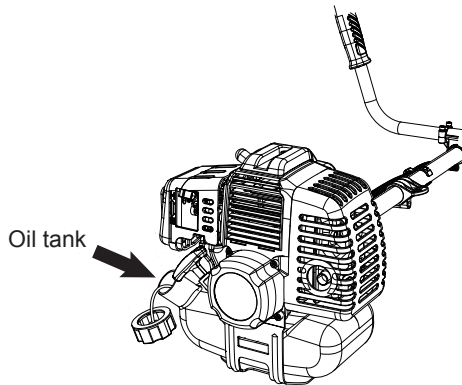

Starting the engine

When working with the machine, the appropriate safety guard must be fitted to prevent objects from being thrown out.

The integrated blade fixed on the safety guard automatically cuts the line to the optimum length.



ATTENTION! Before operating, you must fill the machine with fuel.

Starting the unit

Do not start the brushcutter until it has been completely assembled.

Danger of injury!

Do not operate the machine if you find any fault. If a part has become defective, be sure to replace it before you use the device again.

Check before use!

Check the safe condition of the machine.

Check the machine for leaks.

Check the machine for visual defects.

OPERATION

Check that all parts of the machine have been securely fitted.

Check that all safety devices are in proper condition.

Danger of injury!

Before starting work, always check the ground and remove all objects that could be thrown by the machine.

Start the cold engine

- a) Set the machine down on a hard, level surface. Keep the switch in the ON position.

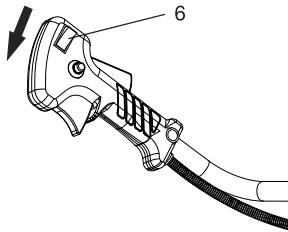

Note: The machine is equipped with an automatic switch reset function; pressing OFF will return the switch to the ON position.

- b) Put the choke lever (10) in  closed position.

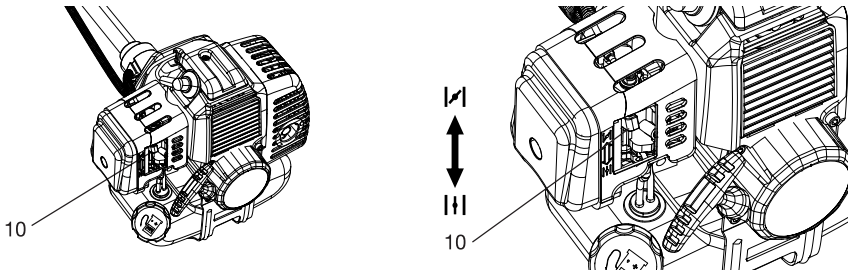

- c) Press the prime bulb (9) for 10 times.

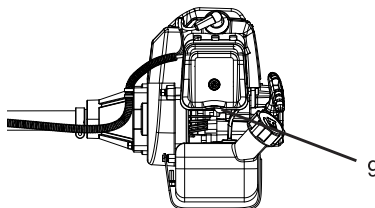

OPERATION

- d) Hold the machine then pull the recoil starter handle (11) 2-3 times to start engine. Once the engine is running smoothly (around 5 seconds) then the engine will be stopped. Then adjust the choke lever to  open position.

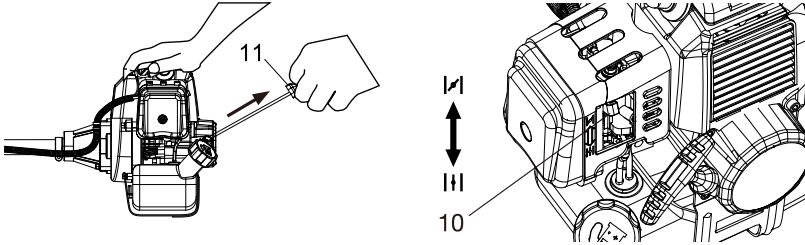

WARNING: Friction around the eyelet will be created and the cord will become frayed if pulled at an angle. This may result in premature breakage of the cord. The recoil starter handle should be allowed to slowly return back to its starting position and never be allowed to 'snap back'.

- e) Hold the machine then pull the recoil starter handle to start engine.

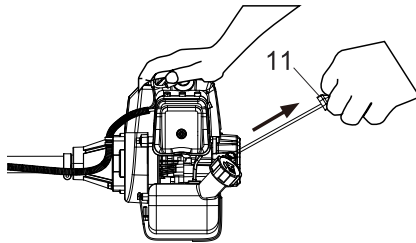

NOTE: Hold the machine firmly against the ground.

- f) Run the machine for 30 seconds at at idle speed, press the the throttle interlock (7), then hold throttle lever(8) to increase the speed.

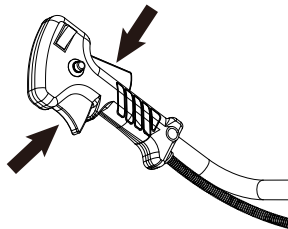

WARNING: If the engine won't start, do not keep pulling the starter which may leads the engine faulty. Repeat the procedures from step a. Or contact us for troubleshooting report.

OPERATION

Start the hot engine

- a) Keep the switch (6) in the ON position
- b) Keep the choke lever (10) in  open position.
- c) Hold the machine then pull the recoil starter handle to start engine.



WARNING: If the engine won't start, do not keep pulling the starter which may leads the engine faulty. Repeat the procedures from step a.

NOTE: Do not start the motor in long grass.

Stopping the engine

Turn the switch to the OFF position to stop the machine.



ATTENTION: When the engine has been switched off, the cutter continues running for several seconds; therefore, do not touch the cutter head until it has come to a complete standstill.

NOTE: The machine is equipped with an automatic switch reset function; pressing OFF will return the switch to the ON position.



WARNING: If the brushcutter vibrates excessively. STOP the engine immediately and investigate the assembly of blade.

Main settings

a) Adjusting line length while working

This machine is fitted with a Bump to Feed Line. To release more line, tap the cutting line head against the ground with the engine at top speed; the line will be released automatically and the blade fixed on the safety guard will cut off the excess length.

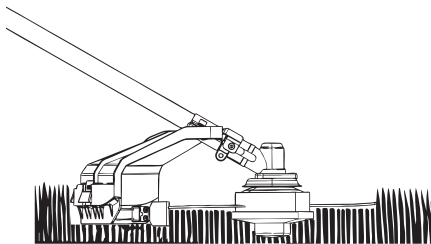

CAUTION! Do not use any kind of metal wire or metal wire encased in plastic in the line spool. This may cause serious injuries to the user. To extend the cutting line, run the engine at full speed and tap the line spool on the ground. This will automatically extend the line.

OPERATION

b) Quick release harness

If any problem occurs, pull the rope of the quick release mechanism. The metal locking bar will be released automatically because of the weight of the machine, and the machine will drop away from you.

c) Different cutting methods

When the machine is correctly assembled it will cut weeds and long grass in places that are difficult to access, e.g. along fences, walls, foundations, and trees. It can also be used for 'mowing' down vegetation to prepare a garden for other applications.

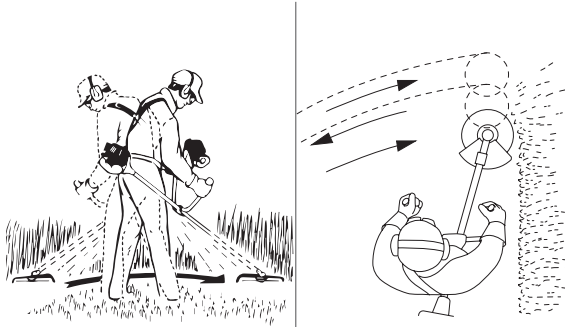

d) Trimming/mowing

Swing the trimmer from side to side in a scything motion. Always keep the line spool parallel to the ground. Check the site and decide which cutting height you require. Guide and hold the line spool at the required height to obtain an even cut.

e) Low trimming

Hold the trimmer right in front of you at a slight angle so that the underside of the line spool is above the ground and the line is at the required height. Always cut away from yourself and never draw the machine towards you.

f) Cutting along fences/foundations

Approach wire mesh fences, lath fences, natural stone walls and foundations slowly so that you can cut close to them without striking the obstacle with the line. If, for example, the line strikes stones, stone walls or foundations, it will wear or fray. If the line strikes wire fencing, it will break.

g) Trimming around trees

When trimming around tree trunks, approach slowly so that the line does not strike the bark. Walk around the tree, cutting from left to right. Approach grass or weeds with the tip of the line and tilt the line spool forwards slightly.

OPERATION



WARNING: Take extreme care during trimming work. When doing such work, keep a distance of 15 metres between yourself and other people or animals.

h) Trimming

When mowing, you want to cut all the vegetation down to the ground. To do this, set the line spool at an angle of 30° to the right.

Place the handle in the required position.

Remember the increased risk of injury to the user, bystanders and animals, and the danger of damaging property due to objects (for example stones) being thrown.



WARNING! Do not use the machine to remove objects from footpaths, etc. The machine is a powerful tool and can throw small stones and other objects a distance of 15 metres or more, causing injuries and damage to cars, houses and windows.

i) Jamming

If the cutting blade jams as a result of attempting to cut vegetation that is too dense, switch off the engine immediately. Remove the grass and scrub from the machine before restarting.

NOTE: Remove all grass and weed remnants at regular intervals to prevent the shaft tube from overheating. Lawn, grass and weed remnants become trapped under the safety guard, preventing the shaft tube from receiving adequate ventilation. Remove the remnants carefully using a suitable tool. Do not use bare hands.

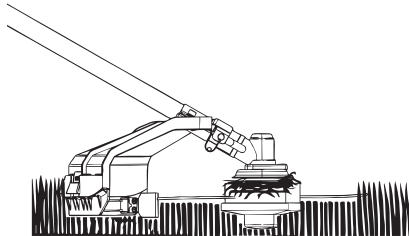

j) Preventing recoil

When working with the blade, there is a risk of recoil if it strikes solid objects, such as tree trunks, branches, tree stumps or stones. This will throw the cutter backwards in the direction opposite to the rotation of the tool. This can cause you to lose control of the cutter. Do not use the blade near fences, metal posts, boundary stones or foundations.

MAINTENANCE AND STORAGE



INJURY WARNING: Always wear protective gloves when working on or around cutting equipment.

BEFORE EACH USE

- Remove dirt and debris from the tool exterior.
- Check all screws for tightness and tighten if necessary.
- Check blade flange nut is tight and tighten if necessary.
- Check the blade for damage. Replace if damaged or cracked.
- Inspect the engine, tank and hoses for possible fuel leaks, and repair as necessary.
- Inspect the engine cooling fins for accumulations of dirt or debris, and clean as necessary.

EVERY 12 HOURS OF USE

- Loosen and remove the air filter cover and filter element.
- Inspect the element. If the filter element is distorted or damaged, replace it with a new one.
- Clean the Air filter with an airline.
- Reinstall the filter element and air filter cover to the tool.
- Use the spark plug wrench to remove the spark plug (turn anticlockwise to remove).
- Clean and adjust the spark plug gap to 0.5-0.7 mm. Replace any damaged or visibly worn plug with a L8RTF spark plug or equivalent.
- Reinstall the spark plug by hand, then tighten it firmly with the spark plug wrench.

EVERY 24 HOURS OF USE

- Loosen and remove the air filter cover and filter element.
- Inspect the element. If the filter element is distorted or damaged, replace it with a new one.
- Clean the Air filter with an airline.
- Reinstall the filter element and air filter cover to the tool.
- Use the spark plug wrench to remove the spark plug (turn anticlockwise to remove).
- Clean and adjust the spark plug gap to 0.5-0.7 mm. Replace any damaged or visibly worn plug with a L8RTF spark plug or equivalent.
- Reinstall the spark plug by hand, then tighten it firmly with the spark plug wrench.

EVERY 36 HOURS OF USE

- **CLEANING** - Thoroughly clean the tool exterior.
- **INSPECTION** - Inspect the entire tool for damage, including loose or missing components and repair as necessary.
- **FUEL** - Drain the fuel tank and then clear the carburetor and lines by running the tool until it stops from lack of fuel.

MAINTENANCE AND STORAGE

- LUBRICATION - Remove the spark plug and then pour approximately a teaspoon of 2 stroke oil into the cylinder through the spark plug hole. Before reinstalling the spark plug, pull the starter 2 or 3 times to distribute the oil over the cylinder walls.
- AIR FILTER - Replace.
- Use the spark plug wrench to remove the spark plug (turn anticlockwise to remove).
- Spark plug – Replace

STORAGE (30 DAYS OR LONGER)

- CLEANING - Thoroughly clean the tool exterior.
- INSPECTION - Inspect the entire tool for damage, including loose or missing components and repair as necessary.
- FUEL - Drain the fuel tank and then clear the carburetor and lines by running the tool until it stops from lack of fuel.
- LUBRICATION - Remove the spark plug and then pour approximately a teaspoon of 2 stroke oil into the cylinder through the spark plug hole. Before reinstalling the spark plug, pull the starter 2 or 3 times to distribute the oil over the cylinder walls.
- AIR FILTER - Remove, clean and reinstall the filter element.
- STORAGE - Store the tool in a clean, dry, dust-free environment. Fuel becomes stale after 30days and is no longer fit for use. Discard any fuel older than 30 days and use only fresh fuel.

If necessary:

Retighten accessible fastening screws and nuts. You will avoid excessive wear and tear and damage to the machine when you follow the instructions in this manual.

Replacing the line spool/cutting line

1. Dismantle the line spool as described in the 'Assembly' section. Press the spool together and remove one half of the housing.

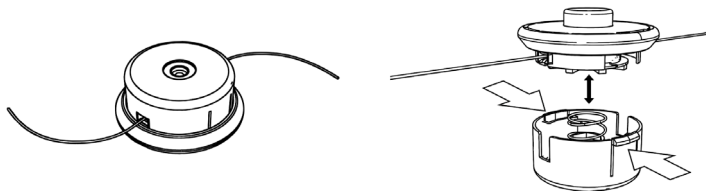

2. Take the spool plate out of the line spool housing.

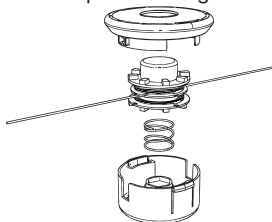

MAINTENANCE AND STORAGE

3. Remove any remaining cutting line.
4. Place the new cutting line in the centre and hang the loop which has formed into the recess in the spool splitter.

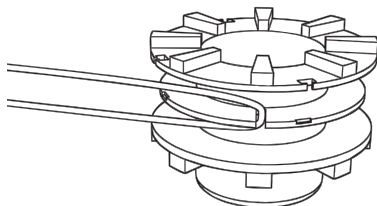

5. Under tension, wind the line onto the spool counter clockwise. The spool splitter will separate the two halves of the line.

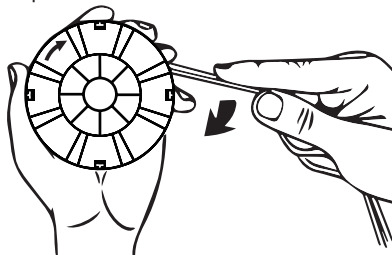

6. Hook the last 15cm of the two ends of the line onto the opposite lying line holders of the spool plate.

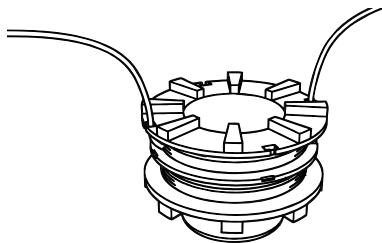

7. Thread the two ends of the line through the metal eyelets in the line spool housing.
8. Press the spool plate into the line spool housing.
9. Pull the two line ends sharply to release them from the line holders.
10. Join the housing parts together again.
11. Cut the excess line to a length of approximately 13cm. This will reduce the load on the engine when starting and warming up.
12. Remount the line spool. If you are replacing the complete line spool, skip '**Assembly**'.

MAINTENANCE AND STORAGE

Sharpening the cutting blade

The cutting blade can become blunt over time. When you notice this, undo the screw holding the cutting blade on the safety guard.

Clamp the blade in a vice.

Sharpen the blade with a flat file and make sure that the angle of the cutting edge is not altered in the process. File in one direction only.

An unbalanced blade will cause the brushcutter to vibrate violently and may result in an accident or injury to the operator.

Change and clean the spark plug

1. Once the engine has cooled, remove the spark plug using the socket spanner supplied.

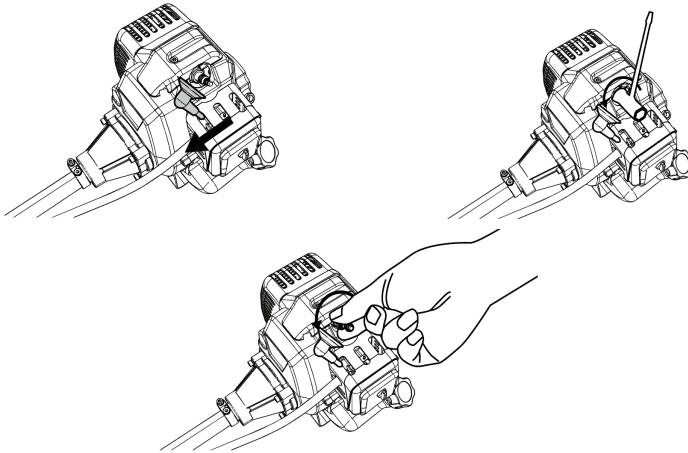

2. Clean the plug with a wire brush.
3. Using a feeler gauge, set the gap to 0.5-0.7mm.

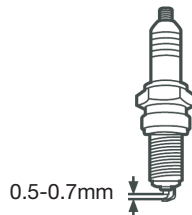

MAINTENANCE AND STORAGE

4. Install the spark plug carefully by hand to avoid cross-threading.

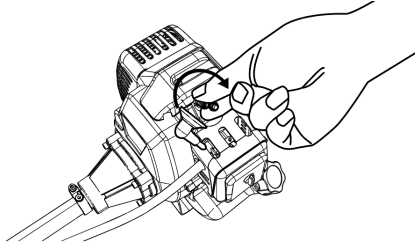

5. After the spark plug is seated, tighten with a spanner to compress the washer.

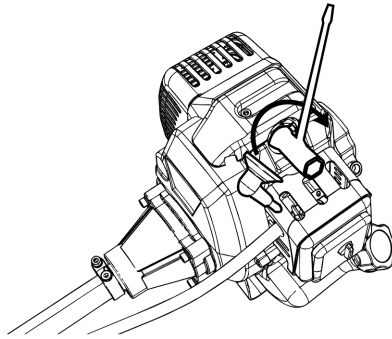

MAINTENANCE AND STORAGE

Change and clean the air filter

Soiled air filters reduce the engine power by supplying too little air to the carburettor. Regular checks are therefore essential.

1. Unclip the air filter cover and remove the sponge filter element.
2. To avoid objects falling into the air tank, remount the air filter cover.
3. Clean the filter using an airline OR replace with a new filter.

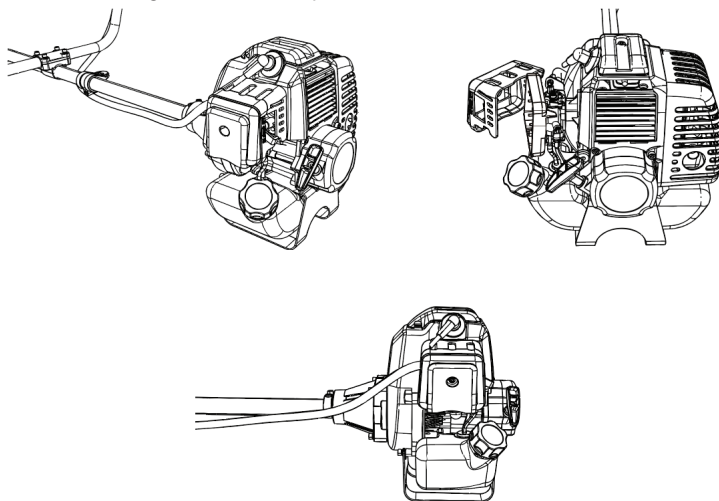

IMPORTANT: Never clean the air filter with petrol or flammable solvents.

WARNING! Never run the engine without the air filter element installed.

Transport

Due to safety reasons, please ensure that the cutter is transported free of oil and petrol!

Worn parts

Even when used in the intended way, some components are subject to normal wear. They will have to be replaced depending on the duration of usage. These parts include, among others, the cutting tool and the retaining disk.



WARNING! Use only the original manufacturer's replacement parts, accessories and attachments. Failure to do so can cause poor performance, possible injury and may invalidate your warranty.

MAINTENANCE AND STORAGE

Storing the brushcutter

If you intend to store the cutter for longer than 30 days, it must be prepared accordingly; otherwise, the fuel still remaining in the carburettor will evaporate and leave a rubbery sediment. This can cause problems when starting up the machine and may require expensive repairs.

Slowly remove the fuel tank cap to release any pressure that may have in the tank. Carefully empty the tank.

To remove the fuel from the carburettor, start the engine and let it run until the cutter stops. Leave the engine to cool (approx. 5 minutes).

Remove the spark plug (see section Change and clean the spark plug).

Add one teaspoon of 2-stroke engine oil into the combustion chamber. Slowly pull the starter cord several times to apply a layer of oil to all internal components. Fit the spark plug again.

NOTE: Store the cutter in a dry place and far away from possible ignition sources.



WARNING: Fuel becomes stale after 30days and is no longer fit for use!

Putting the brushcutter back into operation

Remove the spark plug (see section Change and clean the spark plug).

Quickly tug on the starter cord to remove excess oil from the combustion chamber.

Clean the spark plug and check that the electrode gap is correct, or insert a new spark plug with the correct electrode gap.

Prepare the equipment for operation.

Fill the tank with the relevant mixture of new clean fuel and oil (see the section **Fuel and oil mixture**).

TROUBLESHOOTING

PROBLEM	POSSIBLE CAUSES	REMEDIES
The brushcutter does not start	<ol style="list-style-type: none"> 1. Correct starting procedure not followed 2. Sooted or damp spark plug 3. Incorrect carburettor setting 4. Blade or nylon cutter mounted incorrectly 5. No fuel in the tank 	<ol style="list-style-type: none"> 1. Follow the instructions for starting 2. Clean the spark plug or replace it with a new one 3. Contact an authorised customer service outlet 4. Reassemble the blade or nylon cutter 5. Check the fuel level
The brushcutter starts but does not develop its full power	<ol style="list-style-type: none"> 1. Incorrect choke lever setting 2. Soiled air filter 3. Incorrect carburettor setting 4. Blunt cutting blade 	<ol style="list-style-type: none"> 1. Set the choke lever on the position 2. Clean the air filter 3. Contact an authorised customer service outlet 4. Have cutting blade resharpened/ replaced
The engine does not run smoothly	<ol style="list-style-type: none"> 1. Incorrect electrode gap on the spark plug 2. Incorrect carburettor setting 	<ol style="list-style-type: none"> 1. Clean the spark plug and adjust the electrode gap, or fit a new spark plug 2. Contact an authorised customer service outlet
Engine smokes excessively	<ol style="list-style-type: none"> 1. Incorrect fuel mix 2. Incorrect carburettor setting 	<ol style="list-style-type: none"> 1. Use the correct fuel mix (see fuel mixing table) 2. Contact an authorised customer service outlet
If the temperature of machine is too high	Engine is overloaded	Ensure the machine has a rest period

DECLARATION OF CONFORMITY

To the provisions of Council Directives

We
SUMEC UK Co.,Ltd.
Unit A&B, Escrick Business Park
Escrick, York YO19 6FD

Declare that the product:
Machine Description: Petrol Brushcutter
BC415

Complies with the essential health and safety requirements of the following directives:

The object of the declaration described above is in conformity with the relevant Community harmonisation legislation:

Supply of Machinery (Safety) Regulations 2008
2006/42/EC
Electromagnetic Compatibility Regulations 2016
2014/30/EU

Noise Emission in the Environment by Equipment for use Outdoors Regulations 2001 2000/14/EC amended by 2005/88/EC:

- Conformity Assessment Procedure as per	Annex VI
- Measured Sound Power Level	99 dB(A)
- Declared Guaranteed Sound Power Level	114 dB(A)

Standards and technical specification referred to :

BS EN ISO 11806-1: 2022
BS EN ISO 14982: 2009

Authorised Signatory
Date: 18.11.2024



Signature: _____
Place: York
Name: Mariana Hall
General Manager

SUMEC UK
Unit A&B Escrick Business Park
Escrick, York
YO19 6FD



DISPOSAL

DISPOSING OF THE PACKAGING

Dispose of the packaging separated into single type materials. Dispose of cardboard and carton as waste paper and film via the recyclable material collection service.

DISPOSING OF THE BRUSHCUTTER

Dispose of the brushcutter in accordance with the applicable disposal regulations for your country.

OLD DEVICES MUST NOT BE DISPOSED OF WITH HOUSEHOLD WASTE!



This symbol indicates that this product must not be disposed of together with domestic waste in compliance with the Directive

(2012/19/EU) pertaining to waste electrical and electronic equipment (WEEE).

This product must be disposed of at a designated collection point. This can occur, for example, by handing it in at an authorised collecting point for the recycling of waste electrical and electronic equipment. Improper handling of waste equipment may have negative consequences for the environment and human health due to potentially hazardous substances that are often contained in electrical and electronic equipment. By properly disposing of this product, you are also contributing to the effective use of natural resources. You can obtain information on collection points for waste equipment from your municipal administration, public waste disposal authority, an authorised body for the disposal of waste electrical and electronic equipment or your waste disposal company.