

GB

## 41cc 40.6cm Petrol Chainsaw

### Original Instructions

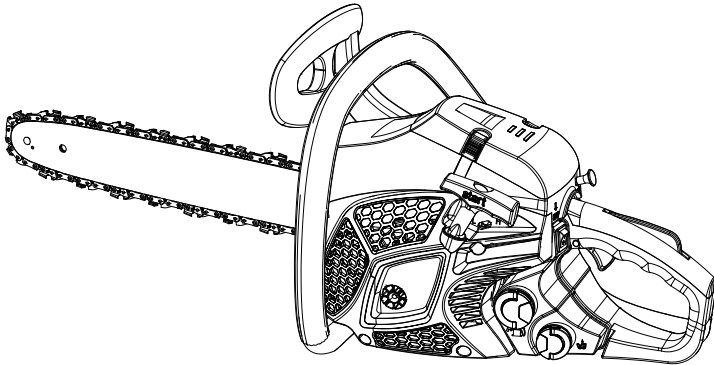

ASSEMBLY & STARTING  
GUIDANCE VIDEO



**READ & UNDERSTAND  
INSTRUCTION MANUAL**



**Save all warnings and instructions for future reference.**

# YARD FORCE

## CS4100A-5 Original Instruction

### CONTENT

Intended use	03
Important safety warnings	03
Symbols	16
Technical data	19
Description of product	20
Operation	22
Maintenance and storage	39
Troubleshooting	43
Declaration of conformity	44
Disposal	45

## INTENDED USE

This machine may only be used outdoors for cutting wood and in combination with the original cutting chains. This machine is not designed for heavy-duty or commercial use. Any use of the machine that deviates from its intended use, and is not included in these instructions, is considered unauthorised use and relieves the manufacturer from his or her legal liability.

Respect of these tips and regular maintenance will ensure good functioning.

## IMPORTANT SAFETY WARNINGS

### Safety warnings

This product is not intended for use by children and persons with reduced physical, sensory or mental capabilities, or lack of experience and knowledge. Children should be supervised to ensure that they do not play with the product.



**WARNING! Your safety and the safety of others is very important. Of course, it is not practical or possible to warn you about all the hazards associated with operating or maintaining this product. At all times you must use your own good judgment.**

### Petrol powered chainsaw safety warnings

- This product is dangerous if used carelessly or incorrectly and can cause serious or even fatal injuries.
- Read all instructions carefully. When using petrol powered products, always follow stated safety precautions to reduce the risk of serious personal injury and/or damage to the product.
- The product should only be operated by those who have read and understood all safety and operating instructions in this manual. Local regulations can restrict the age of the operator.

## IMPORTANT SAFETY WARNINGS

- Keep the work area free from pets, animals, children and bystanders.
- Follow instructions for lubricating, chain tensioning and changing accessories. Improperly tensioned or lubricated chain may either break or increase the chance for kickback. It may cause the chain to snap, which could lead to serious or even fatal injuries.
- Running this product in a confined or badly ventilated area can result in death due to asphyxiation or carbon monoxide poisoning. The product is for outdoor use only.
- Take extreme care in wet and freezing weather conditions. Do not work in rain, windy or stormy weather.
- Wear a face and breathing mask. The use of this product can generate exhaust gases, lubrication oil mist and saw dust containing chemicals known to cause respiratory damage.
- Wear safety steel toe capped footwear, sturdy cut retardant snug-fitting protective clothing, protective gloves, eye, hearing and head personal protective equipment (PPE).
- Always visually check the product before use.
- Do not attempt to tackle any job that you are not adequately trained for.
- Do not allow other persons to be near when starting or cutting with the product.
- Keep bystanders and animals at least 10 metres out of the work area.
- Do not operate the product if it has faulty safety

## IMPORTANT SAFETY WARNINGS

- equipment or damaged parts.
- Do not under any circumstances modify the product. Modifications can result in serious personal injury or death.
- Do not start cutting until you have a clear work area and secure footing.
- All product servicing and maintenance, other than the items listed in this manual, should be performed by an authorised service centre.
- First time operators should receive practical use instructions of the product and protective equipment from an experienced operator.
- National regulation can restrict the use of the product.

### **Clothing and personal protective equipment (PPE)**

- Secure long hair so that it is tied up, above shoulder level.
- Do not wear loose fitting clothing or jewellery as those could be drawn into the engine or catch a moving part of the product.
- Use the following safety clothing and personal protective equipment (PPE) when operating the product:
  - Wear head protection.
  - Wear hearing/ear protection.
  - Wear eye protection.
  - Wear protective gloves.
  - Wear safety steel toe capped footwear.
  - Wear sturdy cut retardant snug-fitting protective clothing

## IMPORTANT SAFETY WARNINGS

Wear a dust mask

First Aid Kit in case of injury

Dry powder fire extinguisher readily available.

### Fuel handling

- Always switch the product off, disconnect the spark plug connector and let the product cool down before refuelling it.
- Take care when handling fuel. Fuel and fuel vapour are highly flammable.
- Do not smoke while operating the product, handling fuel or near fuel.
- Always use suitable aids such as funnels and filler necks. Do not spill any fuel on the product or its exhaust system. There is a risk of ignition. Remove spilled fuel carefully from all parts of the product.
- Any residue which may be present must have completely volatilised, before the product is put into operation!
- Never refuel indoors.
- Never use the product in environments where there is a risk of explosion. Exhaust gases and fuel fumes are noxious. Fuel fumes can ignite.
- Avoid skin contact with petrol.
- Do not eat or drink, while you are refueling the product. If you have swallowed petrol or oil, or if petrol or oil has got into your eyes, then seek the advice of a doctor immediately.
- Tighten the fuel tank cap thoroughly after refilling the fuel tank.

## IMPORTANT SAFETY WARNINGS

- Fuel vapour pressure may build up inside the fuel tank depending on the fuel used, weather conditions and the tank venting system. To reduce the risk of burns and other personal injuries, remove the fuel tank cap carefully to allow any pressure build up to release slowly.
- Ensure the spark plug connector is secure after refilling the fuel tank. A loose connector may cause electrical arcing that could ignite combustible fumes and cause a fire or explosion.
- Use caution when handling fuel. To avoid any accidental fires, move the product at least 3 metres from the fueling point before starting the engine.
- Do not operate the product if it is leaking fuel.
- Do not remove the fuel tank cap while the engine is running.
- Do not store cans of fuel or refill the fuel tank in any place where there is a boiler, stove, wood fire, electrical sparks, welding sparks, or other sources of heat or fire which might ignite the fuel.
- If any fuel spillage occurs during refueling, use a dry rag to wipe up spills and allow remaining fuel to evaporate before starting the engine on again.
- If you have spilt fuel on yourself or on your clothes, change your clothes and wash any part of your body that has come in contact with fuel before turning the engine on again.
- If fuel has ignited, put out the fire with a dry powder fire extinguisher.
- Never breathe in any fuel fumes, when you are

## IMPORTANT SAFETY WARNINGS

refueling the product.

- Keep fuel fresh (less than 30 days) or add fuel stabiliser.

### Operation

- Do not operate the product indoors. The product produces poisonous exhaust fumes whilst the engine is running which may be colourless and odourless.
- Do not wrap the recoil starter rope around your hand whilst starting the product. This may result in injuries to your hand or fingers.
- Keep handles dry, clean and free from oil and grease. Greasy, oily handles are slippery and may cause loss of control.
- Do not operate the product with a slack chain. A slack chain may jump off the guide bar and cause serious or even fatal injuries.
- Do not operate the product with one hand! Serious injury to the operator or bystanders may result from one handed operation.
- Keep all parts of the body away from the saw chain when the chainsaw is operating. Before starting the engine, make sure the saw chain is not contacting any objects and is free from obstructions. A moment of inattention while operating the chain saw may result in entanglement of your clothing or body with the saw chain.
- Engage chain brake and stop engine before placing product down.

## IMPORTANT SAFETY WARNINGS

- Check that the saw chain is properly tensioned and adjusted before any impact of the product is placed down.
- When sawing ensures the product does not touch any foreign materials such as rocks, fences, nails etc. Such objects may be flung out and could result in damage to the product, serious or even fatal injuries.
- Never operate the product on a ladder or other insecure support. If the chain jams in the cut: Engage chain brake and stop the engine. Do not try to pull the product free. Use a lever to open the cut and free the chain. Failure to do so could result in serious or even fatal injuries.
- Only cut with the engine at full speed for optimal performance.
- Use extreme caution when cutting small size bushes and saplings. Slender material may catch the saw chain and whip toward the operator or put the operator off balance.
- Operate the product only in well-ventilated areas.
- Do not operate the product with one hand! This product is intended for two handed uses only. Place right hand on the rear handle and left hand on the front handle. You cannot control reactive forces and you may lose control of the product, which may result in the skating or bouncing of the bar and chain along the limb or log.
- Do not operate the product if you are tired or ill.
- Do not operate the product under the influence of drugs, alcohol or medication.

## IMPORTANT SAFETY WARNINGS

- Do not operate the product if you have any medical conditions that might be aggravated by strenuous work. Consult a doctor before operating this product.
- Do not touch the exhaust during use - IT GETS VERY HOT during use.
- Do not operate the product if it is damaged, improperly adjusted, or not completely and securely assembled. Make sure that the saw chain stops moving when the throttle trigger is released.
- Do not operate the product on a tree unless you have been specifically trained to do so.
- Do not operate the product on a tree! Operation of the product while up on a tree may result in serious or even fatal injuries.
- Do not operate the product near or around flammable liquids or gases.
- Do not smoke whilst operating the product.
- Do not lock the product over fixed stands.
- Do not grip the handles with constant or excessive pressure. This might increase the feeling of vibration and the risk of “Vibration White Finger (VWF)” disease.
- Do not over-reach when operating the product or cut above shoulder height.
- When cutting a limb (branch) that is under tension, be alert for spring back so that you will not be struck when the tension in the wood fibres is released.
- Always keep proper footing and operate the chain saw only when standing on fixed, secure and level surface. Slippery or unstable surfaces can lead to loss of balance or control of the chain saw.

## IMPORTANT SAFETY WARNINGS

- Cut wood only. Do not use the product for purposes not intended for. For example, do not use chain saw for cutting plastic, masonry or non-wood building materials. Use of the chain saw for operations different than intended could result in a hazardous situation.

### Transport and storage

- Engage chain brake before stopping engine- swap around before transporting the product.
- Carry the product with the chain brake engaged, the guide bar and saw chain to the rear, and the exhaust away from the body.
- Fit the guide bar cover on the saw chain during transportation or storage.
- Only carry the product in a horizontal position. Grip the front handle in a manner that the product is balanced horizontally.
- Secure the product when transporting in a vehicle to prevent turnover, fuel spillage and damage to the product. Use rope or ratchet tie-down if necessary.
- Store the product and fuel so that there is no risk of leakages or fumes coming into contact with sparks or naked flames from electrical equipment, electric motors, relays/switches, boilers etc.
- For longer periods of storage or transportation the fuel and chain oil tanks must be emptied. Dispose of waste oil and fuel at a local petrol station, local authority centre or where facilities exist.
- Store fuel and oil in an approved container specifically designed for that purpose.

## IMPORTANT SAFETY WARNINGS

- Clean the product and Have it well cleaned before any long-term storage.

### **Causes and operator prevention of kickback**

- Kickback may occur when the nose or tip of the guide bar touches an object, or when the wood closes in and pinches the saw chain in the cut.
- Tip contact in some cases may cause a sudden reverse reaction, kicking the guide bar up and back towards the operator.
- Pinching the saw chain along the top of the guide bar may push the guide bar rapidly back towards the operator.
- Either of these reactions may cause you to lose control of the saw which could result in serious personal injury. Do not rely exclusively upon the safety devices built into the chain saw. As a chain saw operator, take several steps to keep the cutting jobs free from accidents or injuries.
- Kickback is the result of tool misuse and/or incorrect operating procedures or conditions. It can be avoided by taking proper precautions as given below.
  1. Maintain a firm grip, with thumbs and fingers encircling the chain saw handles, with both hands on the saw and position your body to allow you to resist kickback forces. Kickback forces can be controlled by the operator, if proper precautions are taken. Do not let go of the chain saw.

## IMPORTANT SAFETY WARNINGS

2. Do not overreach and do not cut above shoulder height. This helps prevent loss of control and enables better control of the chain saw in unexpected situations.
3. Only use replacement bars and chains specified by the manufacturer. Incorrect replacement bars and chains may cause chain breakage and/or kickback.
4. Follow the manufacturer's sharpening and maintenance instructions for the saw chain. Decreasing the depth gauge height can lead to increased kickback.

### **Vibration and noise reduction**

To reduce the impact of noise and vibration emission, limit the time of operation, use low-vibration and low-noise operating modes as well as wear personal protective equipment.

- Take the following points into account to minimise the vibration and noise exposure risks:
- Only use the product as intended by its design and these instructions.
- Ensure that the product is in good condition and well maintained.
- Use correct attachments for the product and ensure they are in good condition.
- Keep a tight grip on the handles/gripping surfaces.
- Maintain this product in accordance with these instructions and keep it well lubricated (where appropriate).

## IMPORTANT SAFETY WARNINGS

- Plan your work schedule to spread any high vibration tool use across a longer period of time.

### Emergency

Familiarise yourself with the use of this product by means of this instruction manual. Memorise the safety directions and follow them to the letter. This will help to prevent risks and hazards.

- Always be alert when using this product, so that you can recognise and handle risks early. Fast intervention can prevent serious injury and damage to property.
- Engage chain brake and disconnect the spark plug connector if there are malfunctions. Have the product checked by a qualified professional and repaired, if necessary, before you operate it again.
- In case of fire stop the engine and disconnect the spark plug connector. Take fire-extinguishing measures immediately if the product switch is no longer accessible.



**WARNING! Never use water to extinguish the product on fire. Burning fuel must be extinguished with special extinguishing agents! We recommend that you keep a suitable fire extinguisher within reach in your work area! We recommend to have dry powder fire extinguisher always available.**

## IMPORTANT SAFETY WARNINGS

### Residual risks

Even if you are operating this product in accordance with all the safety requirements, potential risks of injury and damage remain.

The following dangers can arise in connection with the structure and design of this product:

- Health defects resulting from vibration emission if the product is used over long periods of time or not adequately managed and properly maintained.
- Injuries and damage to property due to broken application tools or the sudden impact of hidden objects during use.
- Danger of injury and property damage caused by flying objects.
- Burns, if touching hot surfaces!



**WARNING! This product produces an electromagnetic field during operation! This field may under some circumstances interfere with active or passive medical implants! To reduce the risk of serious or fatal injury, we recommend persons with medical implants to consult their doctor and the medical implant manufacturer before operating this product!**

### Safety symbols

The purpose of safety symbols is to attract your attention to any possible dangers. The safety symbols and their explanations deserve your careful attention and full understanding. The symbol warnings do not, by themselves, eliminate any danger. The instructions and warnings they give are no substitute for proper accident prevention measures.



**WARNING:** Be sure to read and understand all safety instructions within this operator's manual, including all safety alert symbols such as "**DANGER**", "**WARNING**", and "**CAUTION**" before using this tool. Failure to follow all instructions listed below may result in electric shock, fire and/or serious personal injury.

**SAFETY ALERT SYMBOLS:** Indicate **DANGER**, **WARNING**, or **CAUTION**. May be used in conjunction with other symbols or pictographs.

### Symbol meanings

This page depicts and describes safety symbols that may appear on this product. Read, fully understand and follow all instructions on the machine before attempting to assemble and operate.

## SYMBOLS



Before any use, refer to the corresponding paragraph in the manual.



This symbol, before a safety comment, indicates a precaution, a warning or a danger. Ignoring this warning can lead to an accident for yourself or for others. To limit the risk of injury, fire, or electrocution, always apply the recommendations indicated.



The product complies with the applicable European Directives and an evaluation method of conformity for these Directives was done.



The exhaust gas is poisonous and asphyxiating. If inhaled, it may even be lethal. Do not operate the engine in closed or poorly-ventilated places.



Petrol and petrol vapours are extremely flammable.



DO NOT touch to prevent burns.



Wear hearing protection and eye protection (PPE) when using the device.



Wear dust protection.

## SYMBOLS



Wear robust footwear when using the device.



Wear protective gloves when using the device.



Guaranteed sound power level data (114dB), in accordance with Directive 2000/14/ EC.



Beware of kickback (recoil).



Avoid contact with the tip of the guide bar (chain return point). This will result in kickback of the chainsaw.



DO NOT hold the saw with one hand.



Hold the saw firmly with both hands. Place your right hand on the rear handle and your left hand on the front handle.



DO NOT start or use the equipment close to people (especially children) or animals. During operation, it is recommended that a minimum distance of 10 metres from other people is maintained.



UK conformity assessed.

## TECHNICAL DATA

Model	CS4100A-5
Type of engine	RY1E40F (air cooled 2-stroke petrol engine)
Fuel Tank Volume	260ml
Fuel type	Unleaded petrol (mixed with lubricant oil) required, E10 compatible
Mixing ratio	Petrol : Oil = 40 : 1
Oil tank volume	210ml
Idle speed of the engine	3100±300 rpm
Engine speed with cutter running	4300 rpm
Maximum power	1,4kW
Displacement	41cm <sup>3</sup>
Maximum engine power speed	8000 rpm
Maximum engine speed	11000 rpm
Weight (empty tank, without accessories)	4,5kg
Cutting length	37,5cm
Chain pitch	9,525 (3/8")
Gauge of chain	1,27 (0,050")
Maximal speed of the chain	21m/s
Type of chain	Oregon 91P057X
Type of guide bar	Oregon 160SDEA041 (112364)
Sprocket (number of teeth x pitch)	6 Teeth x 9,525mm
Spark plug	L8RTF
Sound Pressure Uncertain K	L <sub>pA,eq</sub> : 99dB(A) Uncertain K <sub>pA</sub> =3,0dB(A)
Guaranteed power level	L <sub>wA,d</sub> : 114dB(A) (2000/14/EC)
Value of vibration	a <sub>front_hv,eq</sub> : max. 6,5 m/s <sup>2</sup> ,K=1,5m/s <sup>2</sup> a <sub>rear_hv,eq</sub> : max. 6,0 m/s <sup>2</sup> ,K=1,5m/s <sup>2</sup>

## DESCRIPTION OF PRODUCT

### Parts description

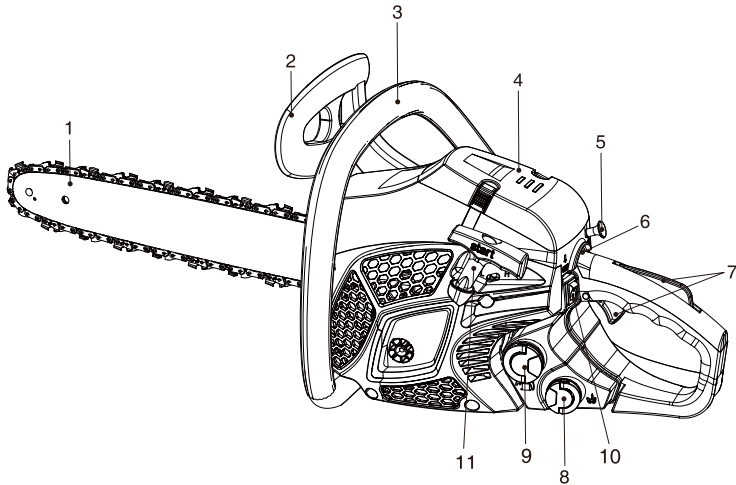

1. Chain and guide bar
2. Chain brake
3. Handle
4. Air filter cover
5. Choke
6. Prime bulb
7. Throttle trigger lock-out (upper one)  
Throttle trigger (lower one)
8. Chainsaw oil tank
9. Fuel tank
10. ON/OFF switch
11. Starter

## DESCRIPTION OF PRODUCT

### Check the delivery parts

Remove the machine from its packaging carefully and make sure that all of the following parts are present:

- a. Chainsaw (Pre-assembled)
- b. Bar cover
- c. Fuel mixing bottle
- d. Hex key
- e. Socket wrench
- f. Screw driver

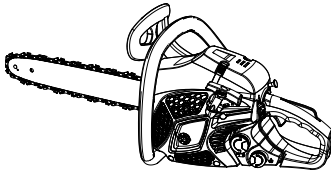

a

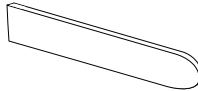

b

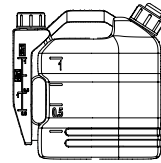

c



d

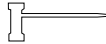

e

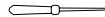

f



**WARNING:** If any parts are damaged or missing, do not operate this tool until these parts have been replaced. Failure to heed this warning could result in serious personal injury.



**NOTE:** Always recycle the packaging in accordance with local recycling guidelines.

## OPERATION



**WARNING:** The product and the packaging are not children's toys! Children must not play with plastic small parts! There is a danger of choking and suffocation!



**WARNING:** Risk of cuts! The teeth of the saw chain are very sharp! Protective gloves must be worn for all work on the saw chain.



**WARNING:** Take care of small parts that are removed during assembly or when making adjustments. Keep them secure to avoid loss.

### Filling the fuel tank



**WARNING:** No petrol has been added to the new machine due to transportation requirements. Be sure to fill it with mixed fuel before operation.



**WARNING:** When filling the tank:

The Chainsaw must always be stopped and cooled.

Never smoke during refueling. It must not have flames or sparks near the fuel. Before refueling, allow the chainsaw to cool completely. Do not attempt to refuel when the engine is hot.

If fuel has been spilled, immediately stop refueling and do not start the engine. Clean up the spill and fill the machine in another location.

Never fill the fuel tank to the flange; there is a risk of overflow.

Do not refuel in a closed and unventilated area.

The fuel used for this machine is a mixture of unleaded petrol and approved engine lubricant. Unleaded gasoline is a quality petrol type. This will help to avoid damaging the fuel lines of the engine and other engine parts.

The recommended mixing ratio is **40:1** (make sure the mixing ratio is correct before filling the product).

#### 1. Mixing (40:1)

- a) Mix in a clean, empty container (supplied).
- b) Open the left cover of the bottle as shown below, and fill it with 2-stroke oil as required up to the 0.5 or 1 scale mark indicated by the arrow.

## OPERATION

### Mixing (40 :1)

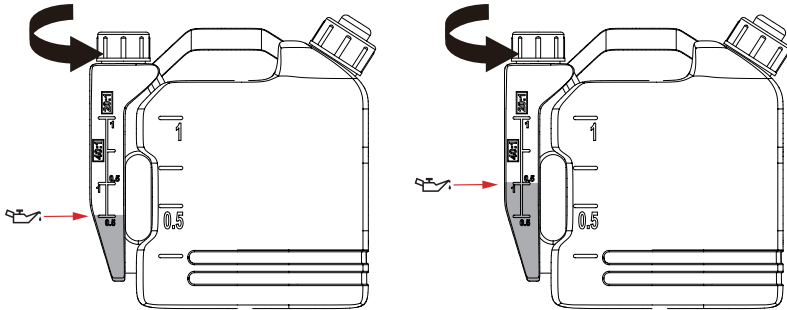

- c) Open the right cover of the bottle and take out included extension tube, and accordingly add unleaded petrol up to the 0.5 or 1 scale mark indicated by the arrow, in accordance with the amount of 2-stroke oil added previously (0.5 or 1).

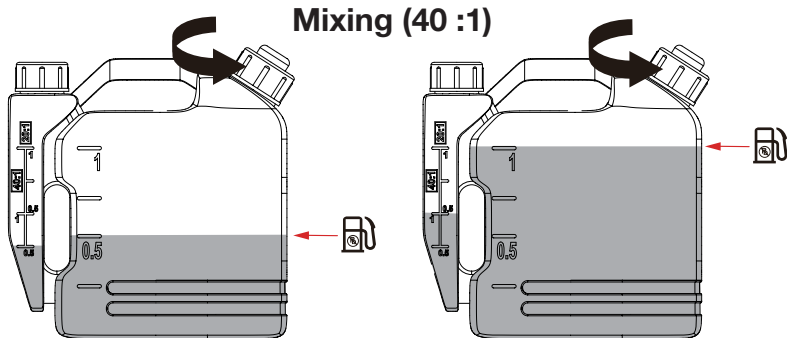

- d) Grip the bottle with both hands, invert it and shake vigorously up and down to mix the engine oil and petrol thoroughly and evenly.
- e) You may use the included extension tube for the mixing bottle to facilitate refilling the mixed fuel into the machine.

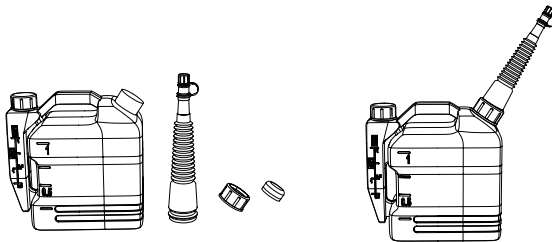

Note: The fuel must be kept in a clean and safe container and always closed.

If you are not using the product for a long time, remove the fuel mixture and add it to a container. Do not leave the fuel for a long time in the product. The fuel may clog the carburetor and the engine will not operate properly.

## OPERATION

When the fuel is no longer used or worn, please dispose of it in an authorised location. Check local laws regarding disposal of fuels.



**WARNING: Fuel stabilisers / enhancers are required for use with E10 fuel to prolong the life of the fuel, for easier starting, and performance.**

### 2. Filling the fuel tank (40:1)



**WARNING: Do not attempt to start engine if not following the instruction with wrong liquid or low quality oil filled in. It may causes engine faulty. Contact an authorised service centre.**

- a) Lift up the fuel cap handle as shown in the figure.

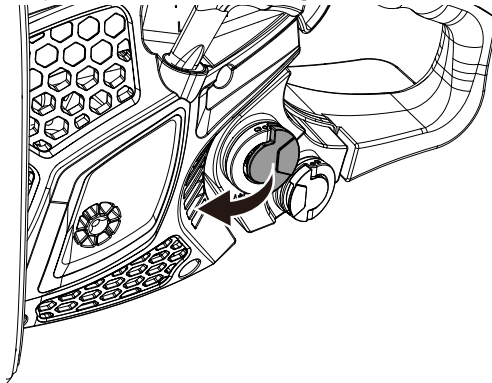

- b) Rotate it counterclockwise and open the fuel tank cap.

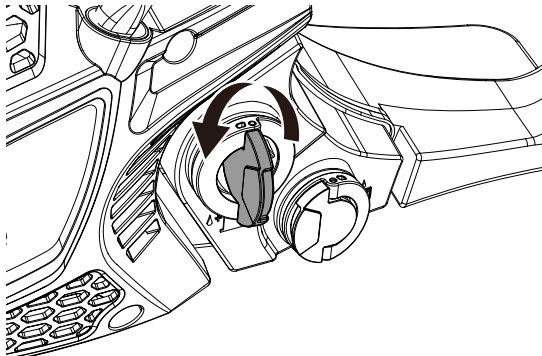

- c) Fill the tank slowly with the fuel mixture (40:1). Do not exceed the maximum capacity.  
d) Replace the cap on the fuel tank and tighten it.  
e) Fold down the cap handle.

## OPERATION

### 3. Filling the chainsaw oil tank



**WARNING:** if the saw blade is not adequately lubricated, it will result in reduced machine performance and accelerated chain wear.

Use high quality chain lubricating oil to minimise wear between the saw chain and guide bar while in use.

**Never use waste or reclaimed oil. this results in damage to the oil pump, saw chain and guide bar.**

NOTE: We recommend using **SAE No. 30** in the summer and **SAE No. 10** in the winter or when cutting resinous wood.

- a) Lift up the cap handle as shown in the figure.

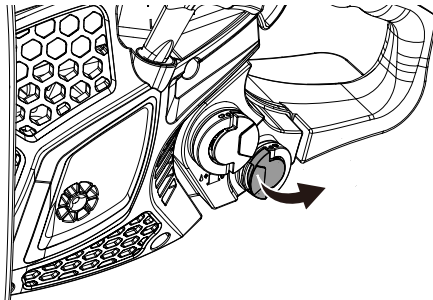

- b) Rotate it counterclockwise and open the chainsaw oil cap.

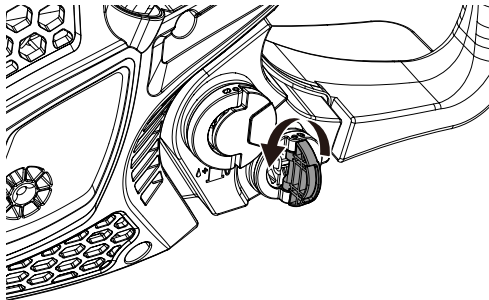

- c) Fill the tank slowly with lubricant oil. Do not exceed the maximum capacity.  
d) Tighten the cap securely.  
e) Fold down the cap handle.

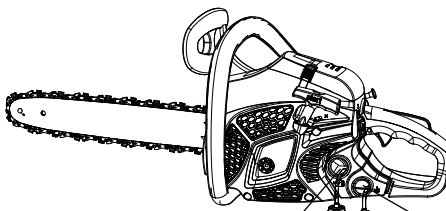

Fuel tank (40:1)

Chainsaw oil tank

## OPERATION

### Starting the engine



**WARNING:** Filling machine with oil and fuel before attempting to start the machine. Check the level of filling and refill when necessary.

Before using the chainsaw, inspect the work area. This must be cleared. Remove any branches, obstacles and other items that may cause damage during cutting.

#### 1. Start the cold engine

- a) The automatic ON switch (10) shall remain in the ON position.

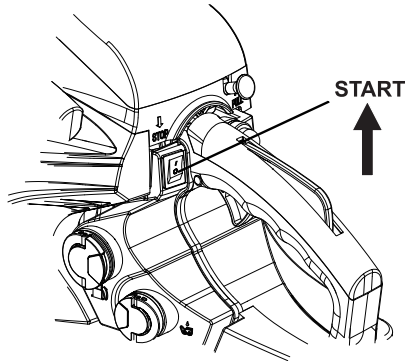

Note: The machine is equipped with an **automatic ON switch**; depressing switch "OFF" bold text - OFF will cause the chainsaw to stop the chainsaw.

- b) Engage the chain brake (2).

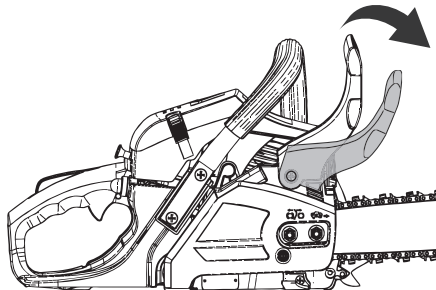

- c) Press the prime bulb (6) for 10 times.

## OPERATION

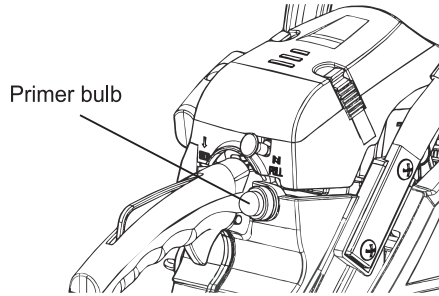

- d) Pull the choke lever (5). Pull the choke lever fully out, until you hear a click.

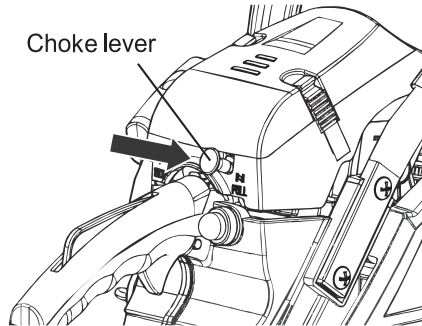

- e) Pull the starter (3) for 2-3 times to prime the engine, not trying to start.

**NOTE:** Hold the chainsaw firmly against the ground. Put the chainsaw on the ground with your foot located through the rear handle and then firmly pull on the starter rope.

Use your right hand to pull on the starter rope.

In both cases, the saw must remain away from the operator's body.

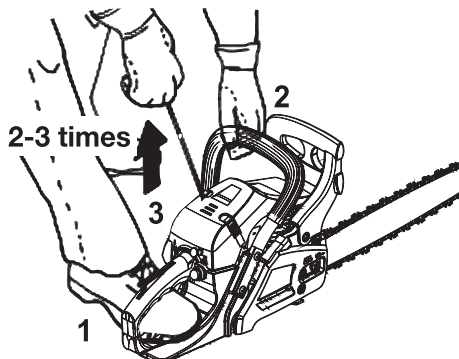

## OPERATION

- f) Push the choke control in (Failure to do this may cause the engine to flood).

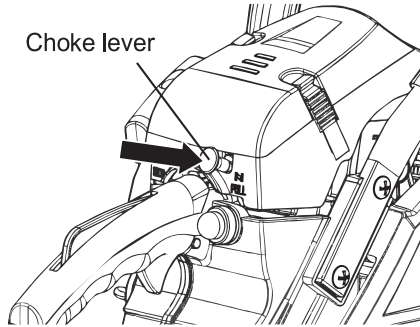

- g) Abruptly pull, needs to be a fast movement the starter 3-4 times until the engine start. Operate the throttle trigger lock and trigger (7) immediately to make the machine to idle speed.

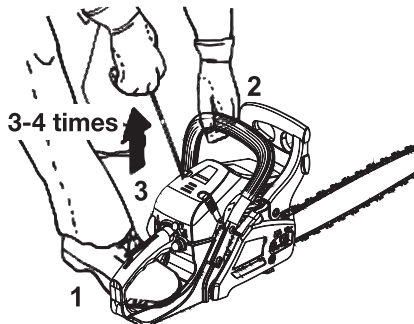

**WARNING:** If the engine won't start, do not keep pulling the starter, as this may lead to engine damage. Repeat the procedures from step a. Or contact us for troubleshooting report.

- h) Allow the engine to run for 15 seconds until the engine runs steadily.  
**Note:** It is common with smoke exhaust especially for petrol engine when first started.
- i) Disengage the brake (2) and squeeze throttle trigger (7) to run the chainsaw. Ensure the area around the bar is clear and the product is firmly held before using throttle.

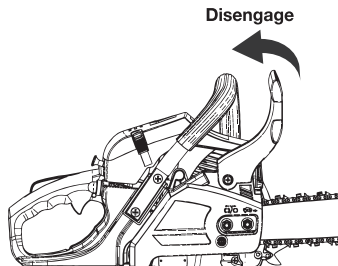

## OPERATION

### 2. Start the hot engine

- The automatic ON switch shall remain in the ON position.
- Engage the chain brake.
- Press the prime bulb for 10 times.
- Pull the starter 3-4 times until the engine start.



**WARNING: If the engine won't start, do not keep pulling the starter, as this may lead to engine damage. Repeat the procedures from step a.**

- Disengage the brake and trigger the throttle trigger to run the chainsaw.

### Stopping the engine

Engage the chain brake then depress the ON/OFF button -- "**OFF**" position until the chainsaw stops.

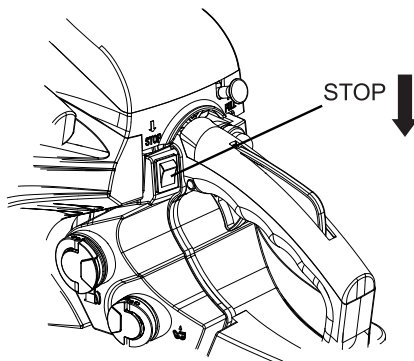

**NOTE:** The machine is equipped with an **automatic ON switch**; depressing switch "OFF" bold text - OFF will cause the chainsaw to stop the chainsaw.

### Main settings

#### a) Chain brake

The chain brake is a safety mechanism activated by the front hand guard (chain brake lever). When kickback occurs the chain stops immediately.

Disengage chain brake: When the chain brake lever is in the disengaged position, the product can be operated with running the saw chain.

Engage the chain brake: When the chain brake lever is in the engaged position, the saw chain is stopped.



## OPERATION

The following function check should be carried out before each use. The purpose of the chain brake testing is to reduce the possibility of injury due to kickback.

- 1) Make sure the chain brake is disengaged. Disengage the chain brake by pulling the front hand guard back towards the front handle .
- 2) Place the product on any suitable flat surface, make sure the saw chain is not touching the surface or other objects.
- 3) Grasp the front handle with your left hand. Your thumb and fingers should encircle the handle. Grasp the rear handle with your right hand. Your thumb and fingers should encircle the handle.
- 4) Start the product as described, press the throttle interlock , then fully squeeze in the throttle trigger with your index finger and hold in this position.
- 5) While the engine is running, engage the chain brake by rotating your left hand forward against the front hand guard. The saw chain should stop immediately.

### b) Release of the chain brake

To use the chain saw again, the chain brake must be released. This must be operated when machine is off and cooled. Pull the front hand guard backward until it returns to its disengaged position with a click sound.

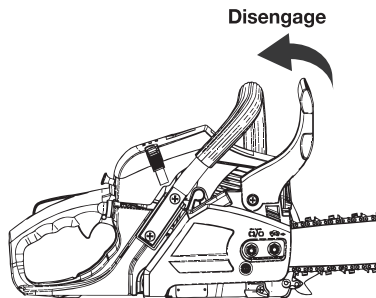

### c) Sharpening of the chain

For best performance, we strongly recommend that you periodically sharpen the chain. The chain can either be sharpened by a professional or by yourself, using a hand sharpener.

The chain must be sharpened when:

- Wood chips have become powder
- To make a normal cut, Excessive force is required
- The cut is not straight
- Vibration increases
- Fuel consumption has increased

## OPERATION

### d) Checking the lubrication of the chain

- Before checking the oil, make sure that the bar and the chain are in place.
- Once the engine is started, turns it at medium speed and checks that the chain oil is sprayed and traces off the ground.
- The oil flow of the chain is adjustable to obtain the proper flow. Insert a screwdriver on the clutch side.
- Turn the adjuster to obtain the correct flow rate for the job.
- The chainsaw must essentially consume the contents of the oil tank between each full of fuel. Do not forget to fill the oil tank when filling the machine with fuel.

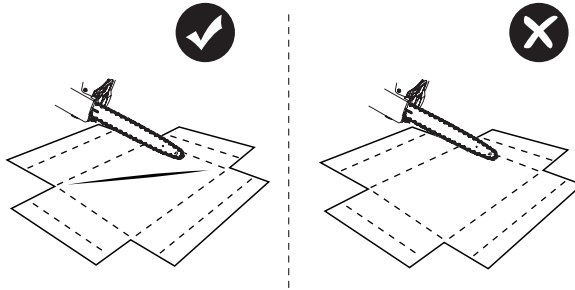

## OPERATION

### Cutting work

The tool should only be used to cut trees. Do not use it for other applications.

Do not attempt to remove the chainsaw when it is stuck during operation. Stop the machine and remove the wedge blade with a wedge.

Maintain a firm footing, keep a good balance and do not climb on the tree trunk.

Try not to work on a slope. However, if you have to work on a slope, always stand higher than the tree trunk.

Before bending a branch or trunk in bending, observe the direction of bending and finish the cut opposite the bending side to prevent the chain guide from getting stuck in the cut.

#### a. Felling of trees

Examine the work area and estimate where the tree will fall. Start the machine as described above. Start by making a notch in the direction of fall chosen.

When the tree falls, shout or sound a warning to alert people in the vicinity. When the shaft falls, you must move away from the cutting area.

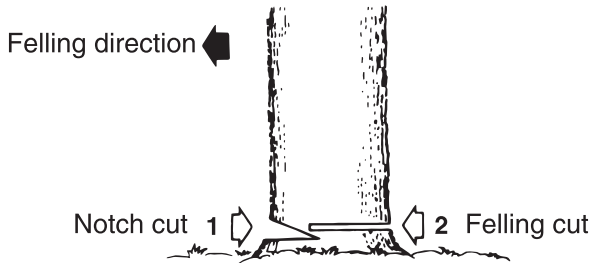

#### b. Trunk on the ground

Cut half of the trunk, turn it over and finish the cut on the other side.

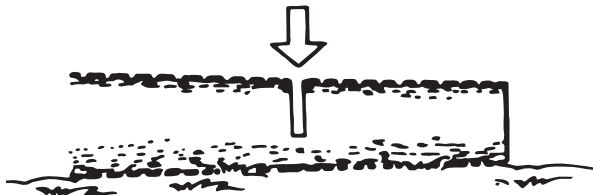

#### c. Trunk in elevation

Begin by cutting a first part from below and then from above. Then, on the second part, repeat this operation.

## OPERATION

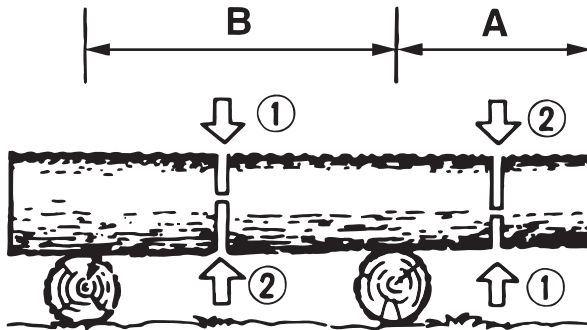

### d. Pruning of a felled tree

Observe first the direction of flexion of the branch. Make a first notch on the side on the side of branch and finish the cut on the opposite side.

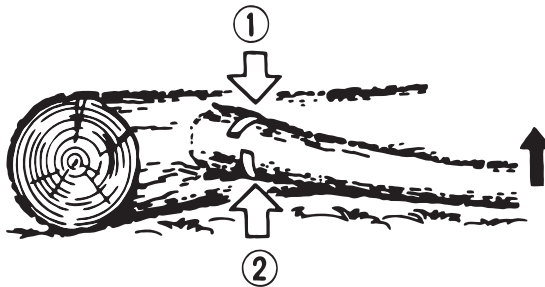

### e. Pruning a tree

Begin pruning by nicking the tree from below and then finish at the top.

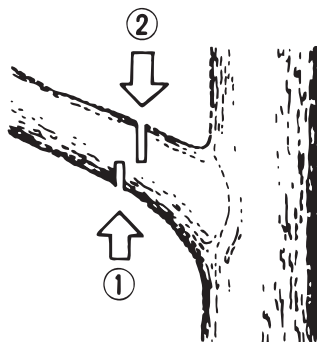

## OPERATION

### Change bar and saw chain



**WARNING:** Before replacing the bar and saw chain, be sure to turn off the machine, wait for it to cool down completely.



**WARNING:** Never replace the saw chain with bare hands.



Always wear protective gloves when using the device.

- a) Disengage the brake (2).

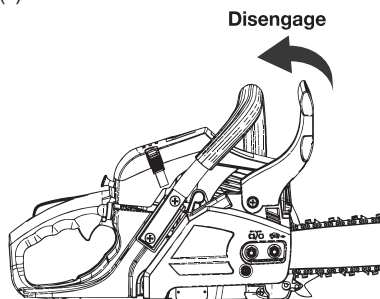

- b) Loosen the fixing nuts counterclockwise and remove the clutch cover.

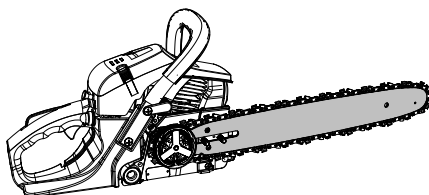
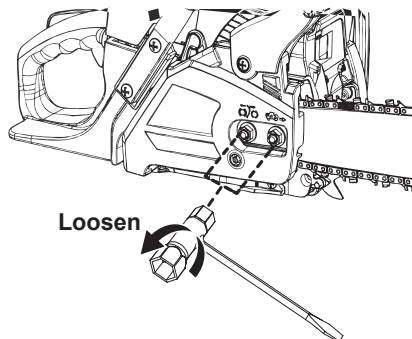

## OPERATION

- c) Remove the worn chain and bar carefully.

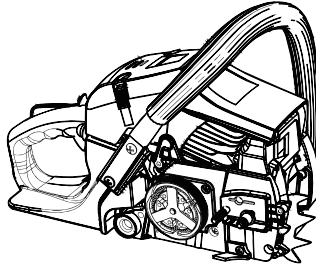

- d) Place the slot on the new guide bar over the 2 bolts.

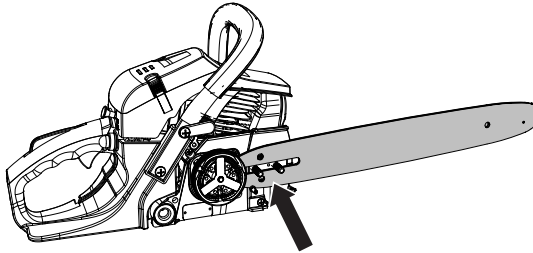

- e) Push the guide bar to the left towards the drive sprocket.

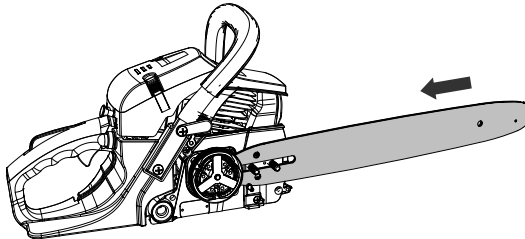

## OPERATION

- f) Place the saw chain over the drive sprocket (behind the clutch) and fit around the nose sprocket at the tip of the guide bar in the correct direction. Make sure the drive links are correctly inserted in the drive sprocket and the nose sprocket.

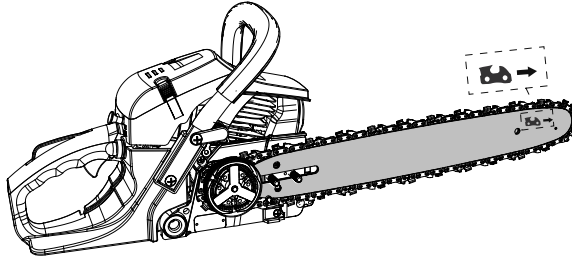

**WARNING:** The direction of the saw chain 'cutters' must be as indicated by the symbol and arrow on the guide bar.

- g) Pull the guide bar carefully towards the right to tighten the saw chain. Make sure the saw chain is placed above the chain catcher.

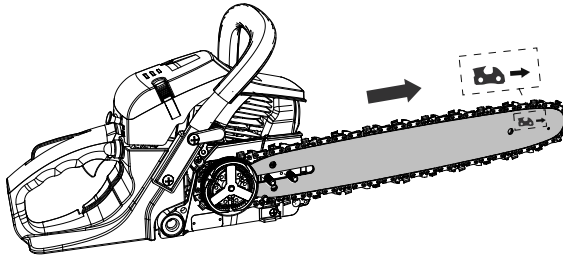

- h) Align the tensioner pin with the lower hole on the guide bar to fit the clutch cover. Tighten the fixing nuts finger tight.

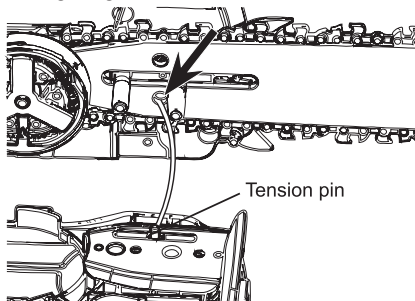

## OPERATION

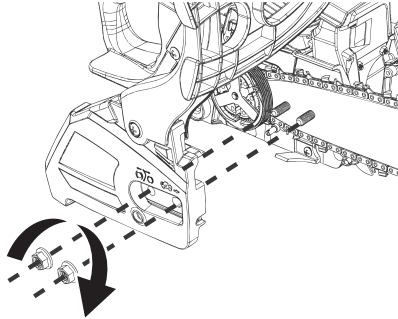

**Note:** Tighten the fixing nuts finger tight only at this stage. The chain tension cannot be adjusted with fixing nuts fully tightened.

- i) Adjust the chain tension by turning the tension screw until the straps touch just the bottom side of the bar. Check if the chain is rotated correctly and tight. After adjusting the tension, it should be possible to lift the saw chain 3-4 mm from the guide bar.

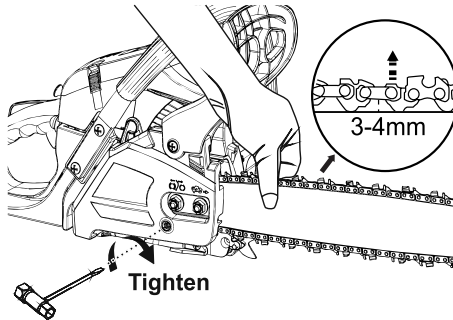

- j) Then tighten the fixing nuts to secure the guide bar and the clutch cover. Rotate the chain with your hand to check that it is turning without excessive resistance and that it is properly tightened. Repeat the installation if the chain is not tight.

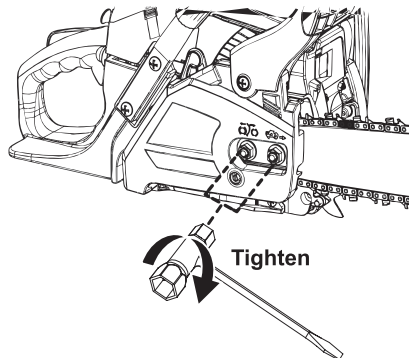

## OPERATION

### Tightening the chain



**WARNING:** Disconnect the spark plug connector before adjusting saw chain tension! The cutting edges of the saw chain are sharp! Always wear protective gloves when handling chain! Always maintain proper chain tension! A loose chain increases the risk of kickback! A loose chain may jump out of the guide bar groove! This may injure the operator and damage the chain! A loose chain will cause rapid wear to the chain, guide bar and the drive sprocket! Tensioning the chain too tightly will overload the engine and cause damage, and insufficient tension can cause chain derailing, it may jump out guide bar groove and cause an injury, whereas a correctly tightened chain provides the best cutting characteristics and prolonged working life! The chain life mainly depends upon sufficient lubrication and correct tensioning!

Always check the saw chain tension before use, after the first cuts and regularly during use. Watch saw chain tension carefully for the first half hour of cutting.

During cutting the temperature of the chain rises and its length changes. It is important therefore to check the chain tension at least every 10 minutes and to adjust it again as required. Upon initial operation, new chains can lengthen considerably. This is normal during the break-in period and the interval between future adjustments will lengthen quickly.

Make sure that the chain is inside the groove of the guide. Hold the guide by its tip. Adjust the tension of the chain with the tension adjustment screw until the chain teeth touch the bottom of the guide. Turn the chain tension adjustment screw clockwise until the chain is tight. Do not stretch the chain too much. Check the tension of the chain and check if the casing is properly tightened. If this is not the case, please repeat the procedure.



**NOTE!** All the chain links must lie properly in the guide groove of the cutter bar.



**NOTE!** During cutting the temperature of the chain rises and its length changes. It is important therefore to check the chain tension at least every 10 minutes and to adjust it again as required.



**NOTE!** A new chain will stretch so adjust the tension after a few cuts. Watch saw chain tension carefully for the first half hour of cutting.



**CAUTION!** Proper cutting chain tension is extremely important. If saw chain is too tight, the guide bar and saw chain will be quickly damaged. If the saw chain is too loose, it may jump out guide bar groove and cause an injury.

## MAINTENANCE AND STORAGE

### 1. Maintenance



Before any maintenance work, the machine must be switched off and completely cooled.

Perform the maintenance work according to the instructions below and perform them regularly. A clean, well-maintained machine increases its service life and efficiency. On the contrary, an improperly maintained machine can cause damage, accidents and render the tool inoperable in the short term.

Any other maintenance, modification or repair work must be carried out by a qualified professional.

Do not immerse the tool in water or any other liquid.

#### a. After each use

- Clean the engine cooling fins with a blower.
- Check the chain brake stops the chain from moving when engaged, therefore working correctly.
- Clean the plastic parts with a damp cloth.
- Check the chain bar/guide is in workable condition and the groove hasn't been damaged during use.
- Check the auto lubrication circuit if it is obstructed or not.
- Check sprocket condition
- Clean the cylinder fins with a compressor

#### b. Cleaning the air filter

Use a compressor to blow dust and chips.

To clean the filter foam: open the air filter cover (4), remove the foam. Clean this foam with petrol, Squeeze excess petrol and allow to properly dry out and dry. Replace the foam in the air filter and reassemble as described in the diagram.

After 10 uses, replace the foam with a new one.

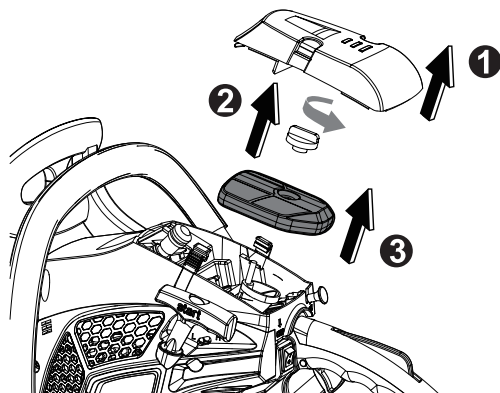

## MAINTENANCE AND STORAGE

### c. Cleaning the oil filter and fuel filter

Clean these items regularly. Remove them from the tanks using clamps. Clean them with petrol and then put them back in place afterwards.

### d. Guide bar

Cleaning: Remove bar guide to remove dirt from grooves and oil inlet. Regularly grease the pinion.

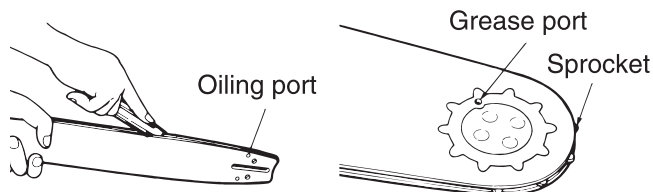

Check: Reverse the bar from time to time to avoid the effects of wear. The bar rail should always be in place. Use a ruler to observe it. If a gap is observed between them, then the rail is normal. Otherwise, the rail is worn out. A bar must be corrected or replaced.

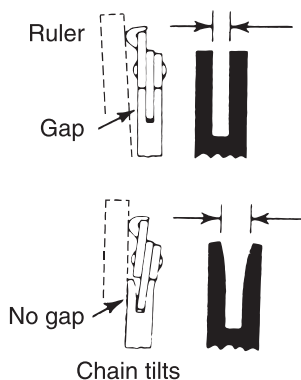

### e. Sprocket

Check the sprocket on signs of wear. If wearing is important, replace it with a new one. Do not install a chain on a worn or damaged sprocket. Do not use a worn chain, replace the chain if you see any signs of damage or wear.

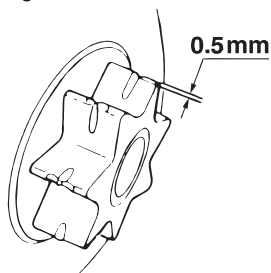

## MAINTENANCE AND STORAGE

### f. Spark plug

Clean the electrodes with a wire brush and set the gap to 0.6mm if necessary.

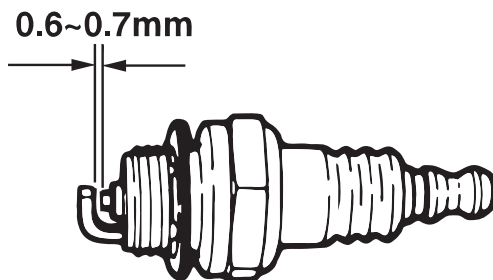

### g. Chain saw

Check each time the cutter and cutting angles are as shown below.

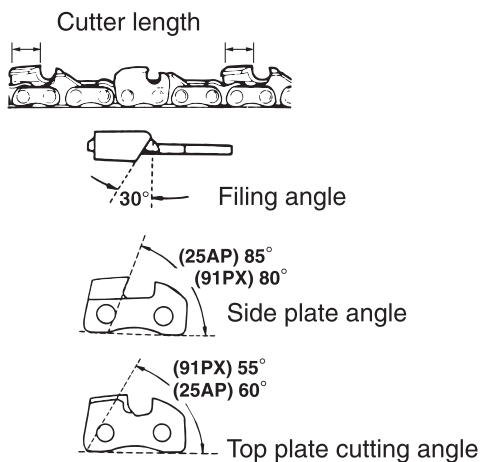

### h. Sharpening of the chain

For best performance, we strongly recommend that you periodically sharpen the chain. The chain can either be sharpened by a professional or by yourself by providing you with a sharpening guide (make sure you know how to use it).

The chain must be sharpened when:

- Wood chips have become powder
- To perform a normal cut, force on the tool#
- The cut is not straight
- Vibration increase

## MAINTENANCE AND STORAGE

- Fuel consumption has increased
- Sharpening method:

The chain saw must be switched off and locked before sharpening. Use a round file or sharpening device (see in store).

Place the file on the tooth and push straight. Shift with the same movement.

After sharpening all teeth, check if the teeth are sharp.

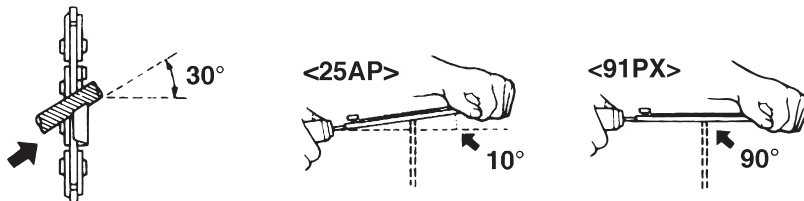

### 2. STORAGE

When storing, the tool must be turned off, cooled, emptied of fuel and thoroughly cleaned.

Store the tool in a dry, clean place, preferably in its packaging, and out of the reach of children. Store all accessories and other items with the tool.

Description	Models or specification
Spark plug	L8RTF/LD
Guide bar	160SDEA041
Saw chain	91P057X

## TROUBLESHOOTING

PROBLEM	POSSIBLE CAUSES	REMEDIES
Unit won't start or starts but will not run	<ol style="list-style-type: none"> <li>1. Incorrect starting procedures</li> <li>2. Incorrect carburetor mixture adjustment setting</li> <li>3. Fouled spark plug</li> <li>4. Fuel filter blocked</li> <li>5. Chain brake is engaged</li> <li>6. Wrong fuel mixture</li> </ol>	<ol style="list-style-type: none"> <li>1. Follow instructions in the user guide or refer to the starting procedure checklist on page 22</li> <li>2. Have carburetor adjusted by an authorised service centre</li> <li>3. Clean/gap or replace plug</li> <li>4. Replace fuel filter</li> <li>5. Pull chain brake in disengage position</li> </ol>
Unit starts but engine has low power	<ol style="list-style-type: none"> <li>1. Incorrect lever position on choke</li> <li>2. Dirty air filter</li> <li>3. Incorrect carburetor mixture adjustment setting</li> </ol>	<ol style="list-style-type: none"> <li>1. Move to RUN position</li> <li>2. Remove, clean and reinstall filter</li> <li>3. Have carburetor adjusted by an authorised service centre</li> </ol>
Engine hesitates	<ol style="list-style-type: none"> <li>1. Incorrect carburetor mixture adjustment setting</li> </ol>	<ol style="list-style-type: none"> <li>1. Have carburetor adjusted by an authorised service centre</li> </ol>
No power under load	<ol style="list-style-type: none"> <li>1. Incorrectly gapped spark plug</li> </ol>	<ol style="list-style-type: none"> <li>1. Clean/gap or replace plug</li> </ol>
Runs erratically	<ol style="list-style-type: none"> <li>1. Incorrect carburetor mixture adjustment setting</li> </ol>	<ol style="list-style-type: none"> <li>1. Have carburetor adjusted by an authorised service centre</li> </ol>
Smokes excessively	<ol style="list-style-type: none"> <li>1. Incorrect fuel mixture</li> </ol>	<ol style="list-style-type: none"> <li>1. Use properly mixed fuel (40:1 mix)</li> </ol>
Poor performance when operated	<ol style="list-style-type: none"> <li>1. Blunt chain</li> <li>2. Loose chain</li> </ol>	<ol style="list-style-type: none"> <li>1. Sharpen or replace the chain</li> <li>2. Tension the chain</li> </ol>
Engine dies	<ol style="list-style-type: none"> <li>1. Empty petrol tank</li> <li>2. Fuel filter in the wrong position in the tank</li> </ol>	<ol style="list-style-type: none"> <li>1. Fill up the petrol tank</li> <li>2. Completely fill the petrol tank or reposition the fuel filter in the petrol tank</li> </ol>
Insufficient chain lubrication (the cutter rail and chain get hot)	<ol style="list-style-type: none"> <li>1. Empty oil tank for the chain</li> <li>2. Oil lubrication opening blocked</li> </ol>	<ol style="list-style-type: none"> <li>1. Top up the oil tank for the chain</li> <li>2. Clean the oil lubrication hole in the cutter bar Clean the groove in the cutter bar</li> </ol>

# DECLARATION OF CONFORMITY

To the provisions of Council Directives

We  
**SUMEC UK Co.,Ltd.**  
**Unit A&B, Escrick Business Park**  
**Escrick, York YO 19 6FD**

**Declare that the product:**  
Machine Description: Petrol chainsaw  
CS4100A-5

**Complies with the essential health and safety requirements of the following directives:**

Supply of Machinery (Safety) Regulations 2008

2006/42/EC

Electromagnetic Compatibility Regulations 2016

2014/30/EU

Noise Emission in the Environment by Equipment for use Outdoors Regulations 2001 2000/14/EC amended by 2005/88/EC:

- |  |             |
|--|-------------|
| - Conformity Assessment Procedure as per | Annex V     |
| - Measured Sound Power Level             | 107.8 dB(A) |
| - Declared Guaranteed Sound Power Level  | 114 dB(A)   |

**Standards and technical specification referred to :**

BS EN ISO 11681-1

BS EN ISO 14982

Authorised Signatory

Date: 18.11.2024



Signature: \_\_\_\_\_

Place: York

Name: Mariana Hall

General Manager

SUMEC UK

Unit A&B Escrick Business Park

Escrick, York

YO19 6FD



## DISPOSAL

### DISPOSING OF THE PACKAGING

Dispose of the packaging separated into single type materials. Dispose of cardboard and carton as waste paper and film via the recyclable material collection service.

### DISPOSING OF THE CHAINSAW

Dispose of the chainsaw in accordance with the applicable disposal regulations for your country.

### OLD DEVICES MUST NOT BE DISPOSED OF WITH HOUSEHOLD WASTE!



This symbol indicates that this product must not be disposed of together with domestic waste in compliance with the Directive

(2012/19/EU) pertaining to waste electrical and electronic equipment (WEEE). This product must be disposed of at a designated collection point. This can occur, for example, by handing it in at an authorised collecting point for the recycling of waste electrical and electronic equipment. Improper handling of waste equipment may have negative consequences for the environment and human health due to potentially hazardous substances that are often contained in electrical and electronic equipment. By properly disposing of this product, you are also contributing to the effective use of natural resources. You can obtain information on collection points for waste equipment from your municipal administration, public waste disposal authority, an authorised body for the disposal of waste electrical and electronic equipment or your waste disposal company.