



YARD FORCE®

FOR LIFE ON THE GO

ER U45 /FLH 2800 B2

GB

ELECTRIC GARDEN SHREDDER

Original Instructions

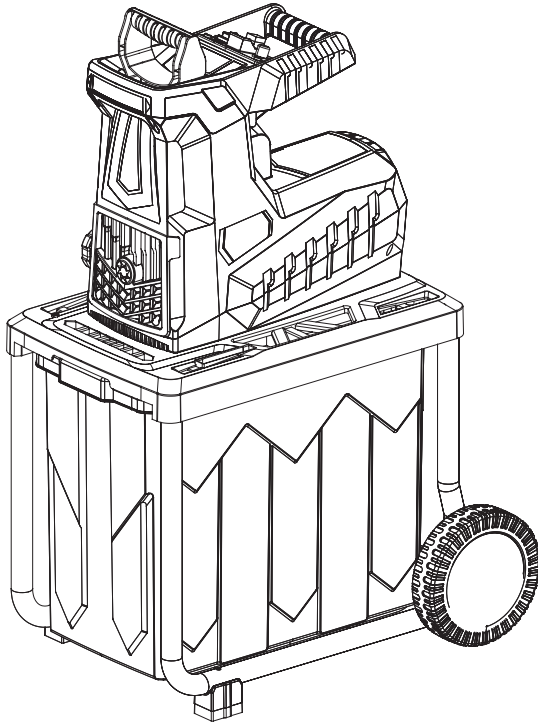

**READ & UNDERSTAND
INSTRUCTION MANUAL**



Save all warnings and instructions for future reference.

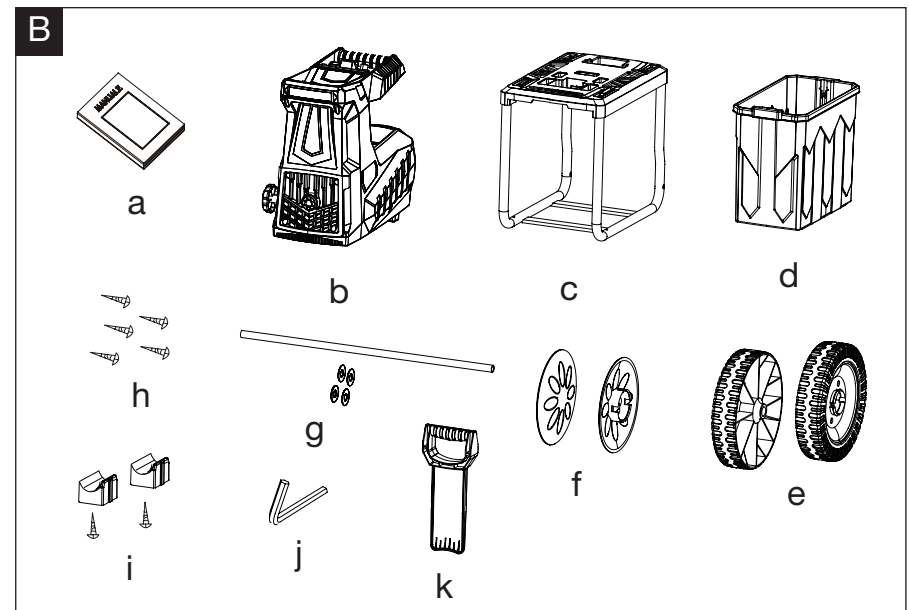
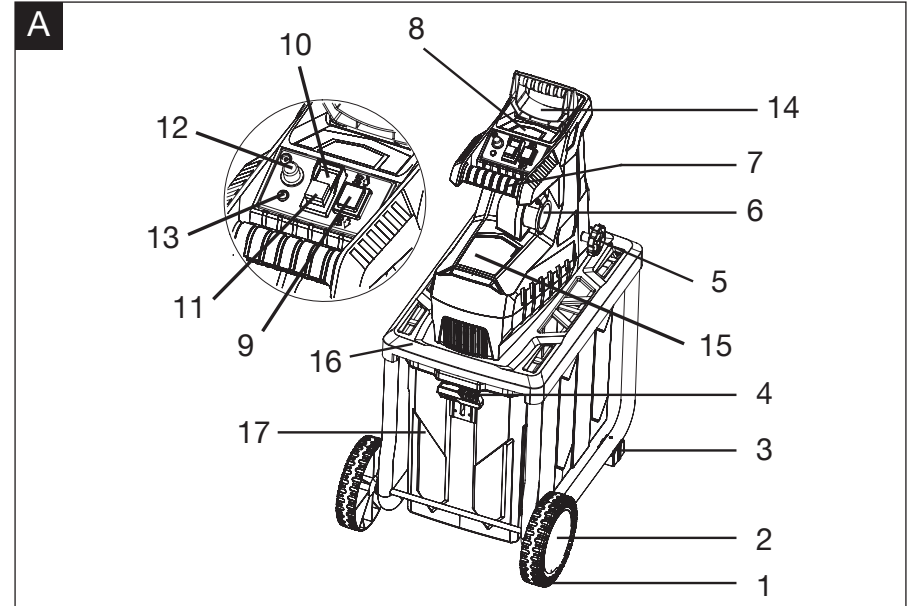

YARD FORCE

ER U45 Original Instruction

CONTENT

Intended use	06
General safety warnings	06
Symbols	13
Technical data	16
Description of product	17
Installation	18
Operation	19
Maintenance and storage	23
Troubleshooting	24
Declaration of conformity	25

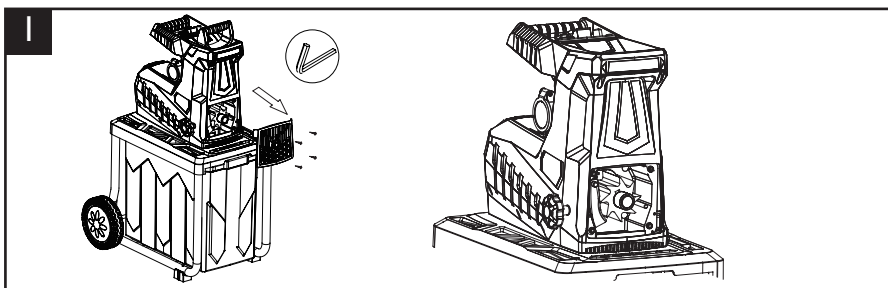
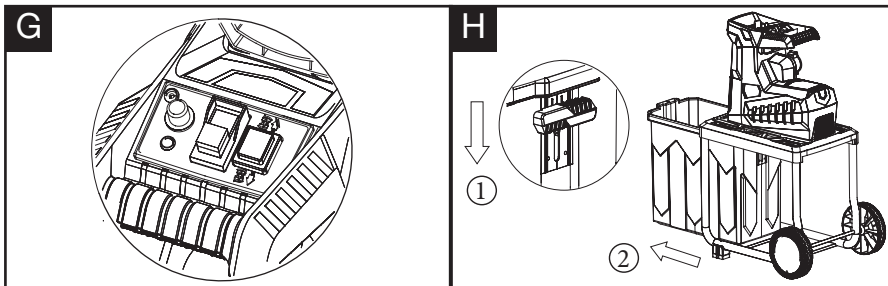
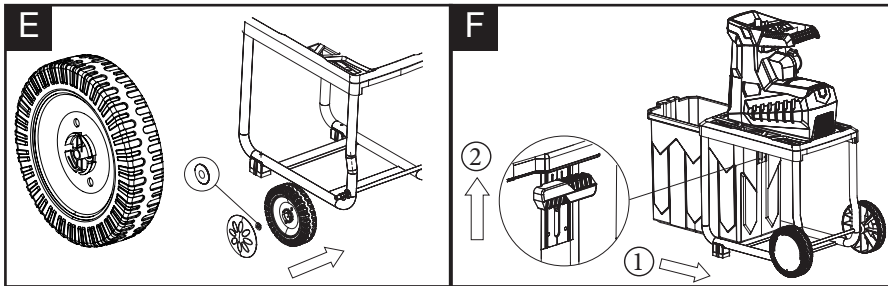
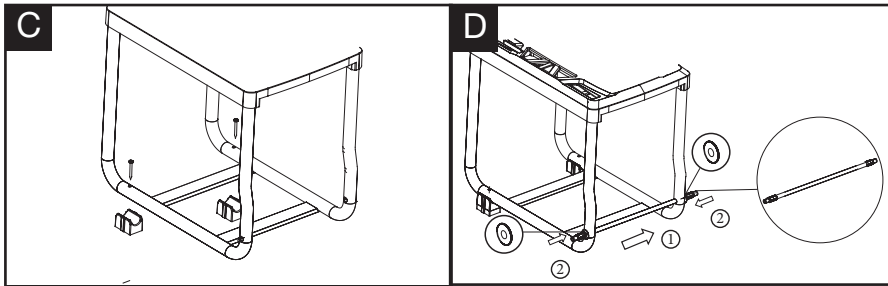

INTENDED USE

The shredder is intended for compacting fibrous and wood-related materials such as hedge and tree cuttings, branches, bark and pine cones.

Any use not expressly permitted in this manual may damage the shredder and pose a serious danger to the user. Note that despite the measures taken to integrate safety into the design, despite the safety precautions and despite the supplementary protective measures, there is still a residual risk. This applies in particular when chopping rose hedges or other thorny bushes.

Do not feed the shredder with stones, glass, metal, bones, plastics or fabrics.

The operator or user is responsible for accidents and injury or damage to third parties.

The manufacturer will not be held responsible for any damage caused by improper operation or use beyond the purpose intended.

This product is only intended for home use, it is not suitable for commercial use.

GENERAL SAFETY WARNINGS

Keep this operating manual for future reference. If you pass this device on to a third party, you must also supply this operating manual.

IMPORTANT READ CAREFULLY BEFORE USE KEEP FOR FUTURE REFERENCE

Safety notes

- Never allow children, persons with limited physical, sensory or mental capabilities or inadequate experience and knowledge or persons unfamiliar with the instructions to operate the machine. Children must be supervised to prevent them from playing with the device.
- Local regulations or bylaws may determine the minimum age for using the shredder.
- Cleaning and maintenance must not be performed by children.

GENERAL SAFETY WARNINGS

NOTE: Observe noise control and local regulations.

Caution! When using the device, observe the following basic safety measures for the prevention of electric shocks and the risk of injury and fire:

Preparation:

- Never use the shredder with other persons or animals nearby.
- Wear hearing and eye protection at all times when using the shredder.
- Wear appropriate protective clothing such as protective gloves, firm footwear and long trousers. Do not wear loosely fitting clothes or clothes with dangling cords or belts. Do not operate the machine barefoot or in sandals.
- Only use the shredder in the open (that is, away from walls or other rigid structures) on a firm, level surface. Only use the machine in the recommended position.
- Do not use the machine on a paved, gravelled area, which could be damaged by ejected material.
- Before you start up the shredder, check that all of the nuts, bolts and other fastenings are tight. Covers must be fastened properly and in good working order. Replace any damaged or illegible stickers.
- Always inspect the connection and extension cables for signs of damage or aging before use. If the cable is damaged during use, it must be disconnected immediately from the mains supply.

DO NOT TOUCH THE CABLE BEFORE ISOLATED

GENERAL SAFETY WARNINGS

FROM THE NETWORK. Do not use the machine if the cable is damaged or worn.

- Only use replacement parts and accessories supplied and recommended by the manufacturer. Using third-party parts will immediately invalidate the guarantee.
- Do not leave the shredder working unattended and keep it in a dry place out of children's reach.
- Only connect the shredder to a properly earthed mains power supply. Make sure that the extension cable and socket are properly earthed.
- While being used in the open, connect the shredder to a residual current (RC) circuit breaker with a trip current of not more than 30 mA.

Working with the device:

- Make sure that the funnel feeder is empty before you start the shredder.
- Keep your head, hair and body away from the intake opening.
- Do not touch dangerous moving parts before the machine has been disconnected from the power supply and the dangerous moving parts have come to a complete standstill.
- Avoid an abnormal posture. When feeding material, never stand on a higher level than the plane of the base of the machine.
- Do not stand in the ejection area while operating the machine.
- When feeding material into the machine, be extremely

GENERAL SAFETY WARNINGS

careful not to introduce pieces of metal, stones, bottles, cans, or other foreign objects.

- Never operate the machine with defective protective devices or shields or without safety devices (such as the attached collection box) or with a damaged or worn cable.
- Turn off the machine before attaching or removing the collection box.
- Avoid an abnormal posture. Always keep your balance in order to always have a secure footing on slopes.
- Do not use the shredder
- in the rain and in bad weather, especially when there is danger of lightning. Work in daylight or under good lighting conditions.
- Do not operate the shredder when you are tired or distracted, or under the influence of alcohol or medication. Always take a break when you need one.
- Switch the shredder off and pull the plug under the following circumstances. Make sure all moving parts have completely stopped.
 - when you are not using the device,
 - transporting it or leaving it unattended;
 - before releasing a jammed blade.
 - when you are checking the device, cleaning it or removing blockages;
 - when you are carrying out cleaning or maintenance work or replacing accessories;
 - Before moving or lifting the shredder.

GENERAL SAFETY WARNINGS

- Do not allow shredded material to accumulate near the ejection area. This may otherwise hinder proper ejection and force the material back up through the feeder.
- Do not transport or tip the shredder with the motor running.
- Keep hands, other body parts and clothing out of the filling chamber and ejection channel and away from other moving parts.
- In the event of blockages in the machine intake or ejection, switch off the motor and disconnect the machine from the mains before removing leftover material in the intake opening or ejection channel. Ensure that the motor is free of rubbish and other accumulations in order to safeguard the motor from damage or possible fire. Remember that the cutting tool is also activated when the starting mechanism is started on a motor operated machine.
- Immediately switch off the power source and wait until the machine has completely stopped, if the cutting mechanism hits a foreign object, or if the machine starts to make unusual noises or vibrate. Disconnect the machine from the mains and take the following steps before restarting and operating the machine:
 - check for damage;
 - replace or repair damaged parts;
 - check for loose parts and tighten them.

GENERAL SAFETY WARNINGS

CAUTION! The following states how damage to the device and possible injury to people can be avoided:

- Clean the ventilation slits regularly; keep to the maintenance instructions.
- Do not overload your device. Work only within the indicated range of performance. Do not employ any low power machines for heavy work. Do not use your device for purposes for which it has not been designed.
- Only switch the shredder off once the funnel feeder is completely empty since the shredder may otherwise clog up and not be able to start afterwards.
- Do not attempt to repair the shredder yourself unless you are qualified to do so. Any work not specified in this manual may only be carried out by our service centre.

Electrical safety

CAUTION! The following states how to avoid accidents and injuries due to electric shock:

- Use the tension relief provided for the fixing of the extension cord.
- Damaged cables, coupling and plugs or connecting leads not corresponding to specifications, must not be employed. Remove the plug immediately from the plug socket in case of damage to the mains cable.
- Do not touch the mains power supply cable under any circumstances until you have pulled the plug out of the mains socket.

GENERAL SAFETY WARNINGS

- If the power cable for this equipment is damaged, it must be replaced by the manufacturer, a customer service agent of the same or a similarly qualified person in order to prevent hazards.
- Do not use the appliance if the on/off switch does not work properly. Always have a damaged switch repaired by our Service Centre.
- Only use extension cables that have been approved for outdoor use and are resistant to splash water. The core diameter for extension cables measuring up to 25 m must be at least 3 x 1.5 mm², and 3 x 2.5 mm² for cables longer than 25m.
- Always roll the whole cable off the reel before use. Check the cable for damage.
- Do not unplug the shredder by the cable.
- Keep the cable away from heat, oil and sharp edges.
- Keep the extension cable away from moving dangerous parts to avoid damage to cables, which may cause contact with live parts.

SYMBOLS

Safety symbols

The purpose of safety symbols is to attract your attention to any possible dangers. The safety symbols and their explanations deserve your careful attention and full understanding. The symbol warnings do not, by themselves, eliminate any danger. The instructions and warnings they give are no substitute for proper accident prevention measures.



WARNING: Be sure to read and understand all safety instructions within this operator's manual, including all safety alert symbols such as "**DANGER**", "**WARNING**", and "**CAUTION**" before using this tool. Failure to follow all instructions listed below may result in electric shock, fire and/or serious personal injury.

SAFETY ALERT SYMBOLS: Indicate **DANGER**, **WARNING**, or **CAUTION**. May be used in conjunction with other symbols or pictographs.

Symbol meanings

This page depicts and describes safety symbols that may appear on this product. Read, fully understand and follow all instructions on the machine before attempting to assemble and operate.

SYMBOLS

 Declaration of conformity (see chapter “Declaration of conformity”): Products marked with this symbol meet all the applicable Community regulations of the European Economic Area.



General warning sign.
Read the operating manual.



Caution! Switch off the motor and disconnect from the mains before adjustment or cleaning work, or if the flex is caught or has been damaged.



Wear hearing protection.



Wear eye protection.



Wear hand protection.



Do not expose the unit to rain.



Warning! Danger of injury from rotating blade cylinder. Keep your hands and feet away from the funnel feeder while the shredder is in operation.

SYMBOLS



Warning! Danger from spin-off.
Keep your distance from the feeder and ejection area, and keep others away from the danger area.



Warning! Electric shock hazard.



Guaranteed noise power level.



Do not dispose of electrical equipment in the domestic waste.



Wait until all machine components have completely stopped before touching them.



Do not use as a step



Function selector switch:
Upper position: Reverse gear to release blockages.
Middle position: No operation
Lower position: normal operation - chopping

TECHNICAL DATA

Model		ER U45
Rated voltage/frequency		230–240 V~/50 Hz
Rated power		2800 W (P40)
IP rating		IPX4
Branch thickness		Max 45 mm
Capacity of box		60 l
Weight		28.5 kg
Measured sound pressure level (L_{pA})		63.4 dB(A)
Measured sound power level (L_{wA})		83.4 dB(A), K=3 dB(A)
Guaranteed sound power level		92 dB(A)
Wheel size		Ø 200 mm

- Continuous-operation periodic duty (20 s on - 30 s idle)
- The max. branch thickness that can be chaffed is dependent on the type of wood and the quality of the goods being cut.
- For hard wood (e.g. oak/beech branches), the max. branch thickness that can be chaffed is less than for soft wood (e.g. pine/spruce wood). For dry or knotted wood, the cutting thickness may also be less.

DESCRIPTION OF PRODUCT

Parts description (Fig. A)

1. Wheel cover
2. Wheel
3. Support foot
4. Safety switch
5. Adjustor screw
6. Power cable with plug
7. Handle
8. Funnel feeder
9. Function switch
10. ON switch
11. OFF switch
12. Overload protection switch
13. Power-On indicator
14. Pusher
15. Shredder unit
16. Chassis

Check the delivery parts (Fig. B)

Remove the machine from its packaging carefully and make sure that all of the following parts are present:

- a. Manual
- b. Shredder unit
- c. Chassis
- d. Collector box
- e. Two wheels
- f. Two wheel covers
- g. Wheel shaft kit (1pc shaft + 4pcs washers + 2pcs cotter pins)
- h. Five self-tapping screws 6x25 mm
- i. Two support foot with two self-tapping screws 5x45mm
- j. Allen key
- k. Pusher



WARNING: If any parts are damaged or missing, do not operate this tool until these parts have been replaced. Failure to heed this warning could result in serious personal injury.



NOTE: Always recycle the packaging in accordance with local recycling guidelines.

INSTALLATION

Assembling the shredder

1. Mount the support feet on the chassis leg. Fasten with selfcutting Screws 5 x 45 mm. **(Fig. C)**
2. Assemble the wheel axle through the holes in the base frame and fix it by outer washer and cotter pins. **(Fig. D)**
3. Place the two wheels on the wheel axle, place the outer washers and secure the split pins.
4. Fit the wheel covers with a audible click on the wheels.
5. Mount the Chopper unit with a Phillips screwdriver (not included in delivery) with the four enclosed Screws on base frame. **(Fig. E)**
6. To insert the the collecting container Unlock the safety switch, by pushing into the "OFF" position. Push the collecting container in the base frame. The collecting tray can only be placed in one direction. **(Fig. F)**
7. Safe the Collecting container by pulling the safety switch into the "ON" position.

Power-On indicator

The Power-On indicator will light when all three following conditions are met:

1. Collector box and safety switch are in proper position
2. The device is connected to the mains supply
3. The overload protection has not been triggered. (See respective section.)

The device will not operate while the Power- On indicator is off.

OPERATION

Start-up

Before starting the shredder, make sure that the shredder unit is firmly attached to the chassis and the collector box and safety switch are in their proper positions.

NOTE: The shredder cannot be switched on before the collector box and safety switch are in their proper positions.

Switching the shredder NO and OFF (Fig. G)

NOTE: Make sure that the mains power voltage agrees with the type plate on the shredder.

1. Connect the power cable to a suitable power outlet. Check that the Power-On indicator turns on.
2. Check that the funnel feeder is empty.
3. To switch on in continuous mode for shredding, press the function switch downwards. Then, press the "ON" switch to start shredding material. To switch off, press the "OFF" switch. Always move the function switch back into the middle neutral position.
4. To start returning material, press the function switch upwards. Then, press and hold the "ON" switch to start the motor. Releasing the "ON" switch will turn off the machine.

NOTE: Avoid changing the direction quickly. Let the motor come to a full stop before restarting.

Pusher

If small shredded material is not drawn in correctly, the material can be with the help of the stopper in the Funnel pressed down will be. During operation, insert the tamper between the handle and the control panel. The tamper is safely stored in the hopper.

Emptying the collector box (Fig. H)

NOTE: Do not leave it until too late to empty the collector box. Remember that the collector box fills unevenly under the ejector opening.

1. Switch the shredder off. (see" switching the shredder on and off")
2. Unlock the collector box by placing the safety switch in the OFF position.
3. Remove the collector box from the chassis and empty it.
4. Make sure that the area around the safety switch is free of wood chippings before you reattach the collector box.
5. Reattach the collector box and place the safety switch in the ON position.

Overload protection

In the event of overload, e.g. due to branches that are too thick, the equipment automatically switches off.

The overload protection switch is motivated and the Power-On indicator turns off which means power off.

Restart prevention

After switching off automatically as a result of overload, the equipment will not restart automatically.

After 1 - 2 minutes, to press the Overload protection switch to repower the machine.

The Power-On indicator turns red which means power on.

Working methods

General working instructions

- For safety reasons, the shredder will not operate without a correctly attached collector box.
- Keep hold of branches while feeding them into the shredder until they are automatically drawn in.
- Be aware of the possible intake speed of the cutter and do not overload the equipment.
- Do not allow shredded material to accumulate near the ejection area. This may otherwise hinder proper ejection and force the material back up through the funnel feeder.
- To protect the shredder from clogging, shred wilted garden waste that has been left for a few days and shred thin twigs alternately with branches.
- Before you shred roots, remove any remaining soil and stones from them
- Do not shred soft, damp material such as kitchen waste, grass or leaves: compost it directly.
- Keep a few dry branches for the end, as they will help clean the shredder.
- Only switch the shredder off when all of the shredding material has passed through the cylinder blade. Otherwise, the cylinder blade may jam the next time you switch the shredder on.

Shredding the material

1. Connect the power supply and switch the shredder ON to start shredding the material (see "switch the shredder on and off")
2. Adjust the pressure plate to correct position by rotating the adjuster screw. (see "adjusting the pressure plate")
3. Insert the material into the funnel feeder until you see the shredded material comes out and falls into the collector box.
4. The designed system between blade and pressure plate will draw the material in automatically. If failed, you can use the pusher to push the material down along the funnel feeder.
5. Empty the collector box when it is about 3/4 full. (See "emptying the collector box".)

Freeing up a jam

Overload protection switch motivated

1. Press the function switch to return to neutral position.
2. After 1-2 minutes, press down the overload protection switch to repower the machine.
3. Press the function switch upwards to allow the blade rotate anti-clockwise to return the material.
4. Press and hold the "ON" switch to start the machine to return the jammed material.
5. Switch the shredder ON and OFF (see "switching the shredder on and off") to check if the jam is fixed.
6. If jam is fixed, switch the shredder ON (see "switching the shredder on and off") to continue shredding material.
7. If jam is not fixed, repeat above steps. If still fail to fix, open the blade cover to clean the jammed material, **(Fig. I)**
 - Unplug the power supply.
 - Loosen the four blade cover screws by enclosed Allen key.
 - Pull to remove the blade cover.
 - Clean the jammed material from the cylinder blade and pressure plate.
 - Put the blade cover back and tighten the four screws.
8. Connect the power supply and switch the shredder ON and OFF (see "switching the shredder off and on") to check.

Overload protection switch not motivated

1. Switch the shredder OFF (see "switching the shredder on and off").
2. Press the function switch upwards to allow the blade rotate anti-clockwise to return the material.
3. Press and hold the "ON" switch to start the machine to return the jammed material.
4. Switch the shredder OFF and ON (see "switching the shredder on and off") to check if the jam is fixed.
5. If jam is fixed, switch the shredder ON (see "switching the shredder on and off") to continue shredding the material.
6. If jam is not fixed, repeat above steps. If still fail to fix, open the blade cover to clean the jammed material:
 - Unplug the power supply
 - Loosen the four blade cover screws by enclosed Allen wrench.
 - Pull to remove the blade cover.
 - Clean the jammed material from the cylinder blade and pressure plate.
 - Put the blade cover back and tighten the four screws.
7. Connect the power supply and switch the shredder OFF and ON (see "switching the shredder on and off") to check. Adjusting the pressure plate

OPERATION

Adjusting the pressure plate

The pressure plate factory setting is correct and only has to be adjusted when worn. You will recognise that the cutting system has become worn when the shredded material is only compressed, and comes out in long chains.

The running-in process may require that you initially readjust the pressure plate in short intervals,

1. Check the funnel feeder is empty and clean.
2. Connect the power supply and switch ON the machine to shred the material(see" switching the shredder on and off").
3. Turn the adjustor screw slowly clockwise until you you hear scraping noises. Small aluminum shavings will come out.
4. Switch OFF the machine and unplug the power supply.

MAINTENANCE AND STORAGE

WARNING: Leave all work not described in this manual to an authorised customer service centre. Only use original parts.

NOTE: Wear hand protection when working on the cylinder blade

WARNING: Switch the shredder off, unplug it form the mains, and wait for the cylinder blade to come to a complete stop before working on it.

Danger: Rotating blades. Keep hands and feet out of openings while machine is running

Cleaning

Risk of electric shock!

Moisture in the device may cause a short circuit or electric shock.

- Before cleaning, disconnect the power cable from the socket.
- Make sure that no water or other liquid gets inside the housing.
- Never clean the device with running water (e.g. a garden hose).

NOTE: Improper cleaning can damage the device.

- Always keep the shredder, wheels and air vents clean. Use a brush or cloth to clean it, avoid cleaners and solvents.
- Always check that the shredder and especially the guards are not worn down or damaged but firmly attached before use. Check that the nuts, bolts and screws are tight.
- Check the covers and guards for damage and improper attachment. If necessary, change the components
- Keep the shredder in a dry place out of children's reach. Do not cover the shredder in nylon bags, as moisture may develop.

TROUBLESHOOTING

Fault/malfunction	Cause	Remedy
Motor not running or cuts out during operation	Collector box incorrectly attached	Push the collector box home to its correct position, and place the safety switch on the collector box to the ON position.
	Overload protection	Push down the overload protection switch to reset
	No mains power supply	Check the socket, cable, lead and plug for damage, and if necessary, have any damage repaired by qualified repair personnel.
	Safety switch is not properly in place on the collector box	Move the safety switch into the ON position (see "emptying the collector box")
Shredding does not work	Cylinder blade running in reverse	Change rotational direction using the function switch
	Shredding material is too soft	Insert wood or shred dried branches
	cylinder blade is jammed	Free up the jam (See "Freeing up the jam")
Shredding material comes out in chains	Pressure plate is incorrectly adjusted	Readjust the pressure plate (See "Adjusting the pressure plate")

DECLARATION OF CONFORMITY

To the provisions of Council Directives

We
MEROTEC GmbH,
Otto-Brenner-Straße 8, 47877 Willich
Deutschland

Declare that the product:
Machine Description: Electric Garden Shredder
ER U45 /FLH 2800 B2

Complies with the essential health and safety requirements of the following directives:

2006/42/EC Machinery Directive
2014/30/EU EMC Directive
2000/14/EC Noise Directive, amended by 2005/88/EC
conformity assessment procedure: 2000/14/EC Annex V
Measured sound power level LwA =83,4 dB(A)
Guaranteed sound power level LwA = 92 dB(A)
2011/65/EU RoHS Directive

Standards and technical specification referred to :

EN 50434:2014
EN 50581:2012
EN 60335-1:2012+A11:2014
EN 55014-1:2017
EN 55014-2:2015
EN 61000-3-2:2014
EN 61000-3-11:2000
EN 62233:2008

Authorized Signatory
Date: 21.01.2022

Signature: 
Place: Willich
Name: Roland Menken
General Manager

MEROTEC GmbH,
Otto-Brenner-Straße 8, 47877 Willich
Deutschland

