

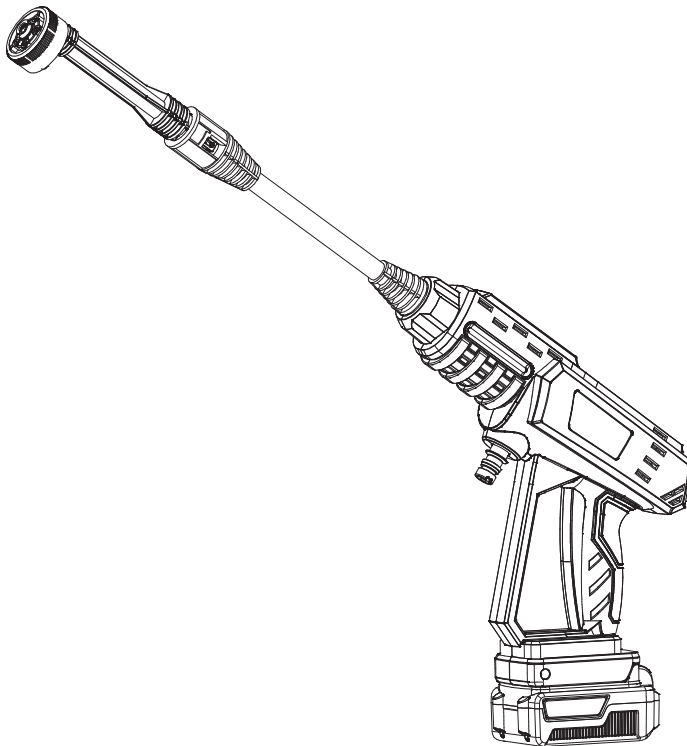

Original User's Instructions

# 18V Cordless Hand Held Pressure Washer 1x4.0Ah

SKU: 74918



**READ BEFORE USE**

**PLEASE KEEP THESE INSTRUCTIONS FOR FURTHER REFERENCE**

# PRODUCT SUPPORT

In the unlikely event of you needing technical support, replacement part or you believe a repair is needed, please contact us in the first instance by following the steps below.



SCAN ME

## STEP 1

Find your proof of purchase and scan this QR code **OR** call our helpline below

## STEP 2

Get in touch with our team and receive expert technical support



## STEP 3

Our team will arrange collection to repair your product under warranty **OR** an alternative resolution



## STEP 4

Your product will be assessed and if required, repaired back to full working order



## STEP 5

Your repaired product will be returned to you via courier within 10 days



## GET IN TOUCH

 01904 947568

 [support@coreservice.co.uk](mailto:support@coreservice.co.uk)

We recommend you keep the original packaging, if repair is needed.

 Technical support: 9am-5pm, Mon-Fri

 Helpline: 24/7

 **HAWKSMOOR**

## CONTENTS

- **WHAT'S IN THE BOX ----- 4**
- **SPECIFICATIONS ----- 5**
- **EXPLANATIONS AND SYMBOLS, CAUTIONS AND WARNINGS ----- 6**
- **IMPORTANT SAFETY WARNINGS ----- 8**
- **PRODUCT DESCRIPTION AND IDENTIFICATIONS ----- 17**
- **ASSEMBLY AND OPERATING INSTRUCTIONS -----18**
- **CARE AND CLEANING ----- 25**
- **TROUBLE SHOOTING ----- 27**
- **DECLARATION OF CONFORMITY / PERFORMANCE ----- 29**
- **ENVIRONMENTAL INFORMATION -----30**
- **WARRANTY -----31**
- **CUSTOMER SUPPORT ----- 31**

## WHAT'S IN THE BOX

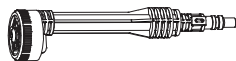

5 in 1 nozzle

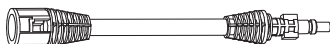

Extension lance

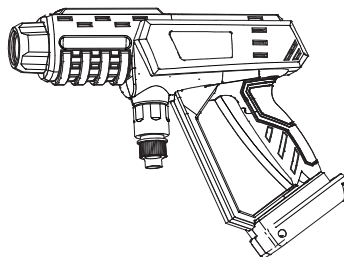

Pressure cleaner

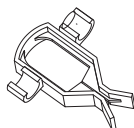

Bucket clip



Bottle feed connector and hose

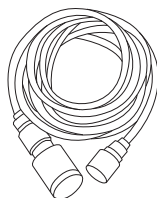

Water hose

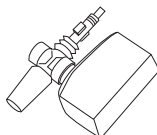

Foam sprayer

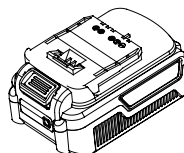

Battery pack

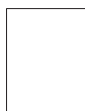

Product support  
leaflet

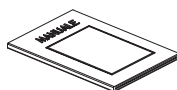

Manual

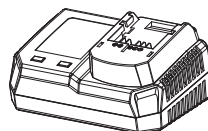

Charger

**If you do not have all these items, please contact:**

**[www.coreservice.co.uk](http://www.coreservice.co.uk)**

**Hotline: +44 01904 947568**

**Email [support@coreservice.co.uk](mailto:support@coreservice.co.uk)**

## SPECIFICATION

Technical Data	
Model	GY212806
Nominal voltage of product with battery	18V
Max. pressure	24bar
Rated pressure	21bar
Max. flow	288L/h
Rated flow	204L/h
Weight(with battery pack)	3kg
Battery (Li-Ion)	B0P-SP06-18ZK
Capacity	4Ah
Battery charging time Max.	60min
Battery charger Model	B0Q-SP07-2040ZZ
Battery charger input	220-240V AC, 50/60Hz 130W
Battery charger output	20V d.c. 4.5A
Protection class of batter charger	Class II/ 
Protection category	IPX0

## EXPLANATIONS AND SYMBOLS, CAUTIONS AND WARNINGS

Symbols are used in this manual to attract your attention to possible risks. The safety symbols and the explanations which accompany them must be perfectly understood. The warning themselves do not prevent the risks and cannot be a substitute for proper methods of avoiding accidents.



This symbol, before a safety comment, indicates a precaution, a warning or a danger. Ignoring this warning can lead to an accident for yourself or for others. To limit the risk of injury, fire, or electrocution always apply the recommendations indicated.



Read the operator's manual.



Wear protective gloves!



Wear slip-resistant, sturdy footwear!



Wear mask!



Objects thrown by the product could hit the user or other bystanders. Always ensure that other people and pets remain at a safe distance from the product when it is in operation. In general, children must not come near the area where the product is. Minimum distance 15m.



Do not use in rain or wet conditions.



Guaranteed sound power level value



Complies with European regulations applicable to this product.



UK conformity assessed.



Machine is not suitable for connection to the potable water mains.



Remove battery pack before carrying out any adjustment, servicing or maintenance.



Recycle unwanted materials instead of disposing of them as household waste. All tools, cables and packaging should be sorted, taken to the local recycling centre and disposed of in an environmentally-friendly way.



Do not direct the jet at persons, animals, live electrical equipment or the unit itself.

### Warning symbols on battery pack and charger



Do not dispose of batteries in rivers or immerse in water.



Do not subject the battery to strong sunlight over long periods and do not leave it on a heater (max.45°C).



Do not dispose of batteries in a fire. They will explode and cause injury.



**Li-Ion**

Li-Ion battery. This product has been marked with a symbol relating to 'separate collection' for all battery packs and battery pack. It will then be recycled or dismantled in order to reduce the impact on the environment. Battery packs can be hazardous for the environment and for human health since they contain hazardous substances.



Double insulation (Only for charger)



The charger is for indoor use only.

T 3.15A



Fuse

## IMPORTANT SAFETY WARNINGS

### Safety Warnings

This product is not intended for use by children and persons with reduced physical, sensory or mental capabilities, or lack of experience and knowledge.

Children should be supervised to ensure that they do not play with the product.



**WARNING! Your safety and the safety of others is very important. Of course, it is not practical or possible to warn you about all the hazards associated with operating or maintaining this product. At all times you must use your own good judgment.**

### Safety Warnings for high pressure cleaner

- **WARNING:** This product has been designed for use with the cleaning agent supplied or recommended by the manufacturer. The use of other cleaning agents or chemicals may adversely affect the safety of the machine.
- **WARNING:** During use of high-pressure cleaners, aerosols may be formed. Inhalation of aerosols can be hazardous to health.
- **WARNING:** High pressure jets can be dangerous if subject to misuse. Never direct the jet at persons, live electrical equipment or the product itself.
- The liquid must not be directed towards equipment containing electrical components, such as the interior of ovens.
- **WARNING:** Do not use the machine within range of persons unless they wear protective clothing.
- **WARNING:** Do not direct the jet against yourself or others in order to clean clothes or foot-wear.

- **WARNING:** Risk of explosion – Do not spray flammable liquids.
- **WARNING:** High pressure cleaners shall not be used by children or untrained personnel.
- **WARNING:** High pressure hoses, fittings and couplings are important for the safety of the product. Use only hoses, fittings and couplings recommended by the manufacturer.
- **WARNING:** To ensure machine safety, use only original spare parts from the manufacturer or approved by the manufacturer.
- **WARNING:** Water that has flowed through backflow preventers is considered to be non-potable.
- **WARNING:** Remove the battery from the product during cleaning or maintenance and when replacing parts or converting the machine to another function.
- **WARNING:** Do not use the machine if a supply cord or important parts of the machine are damaged, e.g. safety devices, high pressure hoses, trigger gun.
- **WARNING:** Always switch off the mains disconnecting switch when leaving the machine unattended.
- **Never** use the product with inflammable or toxic liquids, or liquids with characteristics incompatible with its proper operation.
- **Never** use the product outdoors in the rain.
- **Never** lock the gun trigger in the operating position.
- Check that the product is fitted with its rating label; contact your dealer if it is missing. Products without rating label must not be used, since they cannot be identified and are potentially hazardous.
- **Never** tamper with or adjust the setting of the safety valve or the safety devices.
- **Never** change the original diameter of the adjustable nozzle.
- The appliance shall not be left unattended while it is connected to the supply mains.

- **Do not** allow vehicles to drive over the pressure hose.
- **Do not** move the product by pulling on the pressure hose.
- When directed towards tyres, tyre valves or other pressurised components, the high-pressure jet is potentially dangerous. Do not apply a jet stream and always keep the nozzle at a distance of at least 30 cm during cleaning.
- Protect all electrical conductors against the water jet.
- High pressure may cause parts to rebound: wear all the protective clothing and equipment needed to ensure the operator's safety.
- Wear appropriate Personnel Protection Equipment (PPE) while operation e.g. safety boots, safety gloves, safety helmets with visors, hearing protection etc.
- Be aware of kick-back: grip the gun firmly when squeezing the trigger.
- Comply with the regulations of the local water supply authority. Under EN 12729 (BA) the product can be connected directly to the mains drinking water supply only if the supply hose is fitted with a backflow preventer device with drainage facility.
- Discharge residual pressure before disconnecting the hose from the product.
- Check before each use, and at regular intervals, that all metal fasteners are tight and the product's components are in good condition; inspect for broken or worn parts.
- The appliance is not to be used if it has been dropped, if there are visible signs of damage or if it is leaking.
- Keep the appliance out of reach of children when it is energised or cooling down.
- **WARNING:** Use only detergents compatible with the high-pressure hose cladding materials or other cladding materials.

## Safety Warning For Battery Pack

- Fully charge battery pack before the first use.
- Recharge battery pack when the power output starts to slow. Do not continue to use product when battery capacity level is low.
- To prevent serious damage to the battery pack, charge in temperatures above 5°C or below 45°C. Longest life and best performance can be achieved when battery is charged at room temperature (20 °C ± 5 °C).
- If the battery temperature is hot after use, it must be allowed to cool before putting it into the charging station.
- If the battery pack becomes too hot during charging, disconnect and switch off immediately. Contact the service center directly.
- **Do not dismantle, open or shred cells or battery pack.**
- **Do not short-circuit a battery pack.** Do not store battery packs haphazardly in a box or drawer where they may short-circuit each other or be short-circuited by conductive materials. **When battery pack is not in use, keep it away from other metal objects, like paper clips, coins, keys, nails, screws or other small metal objects, that can make a connection from one terminal to another. Shorting the battery terminals together may cause burns or a fire.**
- Do not carry individual battery packs in your pockets or bag as they could short-circuit against other metal items.
- Do not expose battery pack to heat or fire. Avoid use or storage in direct sunlight for extended periods of time.
- Do not subject battery pack to mechanical shock.
- In the event of battery leaking, do not allow the liquid to come into contact with the skin or eyes. If contact has been made, wash the affected area with copious amounts of water and seek medical advice.

- Should a Li-ion battery catch fire, ensure to use the correct fire extinguisher to combat the fire. Do not throw or spray water on a burning Li-ion battery.
- Keep battery pack clean and dry. Wipe the battery pack terminals with a clean dry cloth if they become dirty.
- Battery pack needs to be charged before use. Always refer to this instruction and use the correct charging procedure.
- **Do not** maintain battery pack on charge when not in use.
- After extended periods of storage, it may be necessary to charge and discharge the battery pack several times to obtain maximum performance.
- Battery pack gives its best performance when it is operated at normal room temperature ( $20\text{ }^{\circ}\text{C} \pm 5\text{ }^{\circ}\text{C}$ ).
- When disposing of battery packs, keep battery packs of different electrochemical systems separate from each other.
- Recharge only with the charger specified by manufacturer. Do not use any charger other than that specifically provided for use with the equipment. A charger that is suitable for one type of battery pack may create a risk of fire when used with another battery pack.
- **Do not** use any battery pack which is not designed for use with the equipment.
- Keep battery pack out of the reach of children.
- Retain the original product literature for future reference.
- Remove the battery from the equipment when not in use.
- Dispose of properly.
- **Do not** mix cells of different manufacture, capacity, size or type within a device.
- **Do not** remove battery pack from its original packaging until required for use.

## **Safety Warning For Battery Charger**

- Charge only battery pack of the same model provided by manufacturer and of models recommended by manufacturer.
- Do not use the original charger on other Li-ion batteries or on any other type of battery as this can increase the risk of fire or explosion.
- Check the battery charger, cable and plug before each use. Do not use the battery charger if damaged. Do not open the battery charger yourself, charger must be repaired by qualified personnel using original spare parts.
- The charger is designed to use a standard household 220-240 V~ 50Hz power source, ensure that the plug matches the outlet.
- Never modify the plug in any way, this will reduce the risk of electric shock.
- Do not abuse the cord of charger. Never use the cord for carrying, pulling or unplugging the charger. Keep cord away from heat, oil, sharp edges or moving parts. Damaged or entangled cords increase the risk of electric shock.
- Make sure the charger cord is situated so that it will not be stepped on, tripped over or get damaged.
- If the supply cord is damaged, it must be replaced by the manufacturer, its service agent or similarly qualified persons in order to avoid a hazard.
- Keep the battery charger clean. Contamination can increase the risk of electric shock.
- Protect the battery charger from rain and moisture. If water accesses the battery charger there is an increased risk of electric shock.

- Battery will heat up whilst charging. When charging batteries, ensure that the battery charger is in a well-ventilated area and to reduce the risk of fire, do not operate battery charger on or close to inflammable materials such as paper or textiles.
- Do not overcharge any batteries. Ensure that batteries and chargers are not left unsupervised during charging.
- The temperature range over which the battery pack can be charged is typically between 5°C-45°C. Attempts to charge out with the prescribed temperature range may automatically be blocked by the protection circuitry of the battery pack. Longest life and best performance can be obtained if the battery pack is charged at room temperature.
- Disconnect charger from the power supply when not in use. This will reduce the risk of electric shock or damage to the charger.
- This charger can be used by children aged from 8 years and above and persons with reduced physical, sensory or mental capabilities or lack of experience and knowledge if they have been given supervision or instruction concerning use of the appliance in a safe way and understand the hazards involved.
- Children shall not play with the appliance. Cleaning and user maintenance shall not be made by children without supervision.

## **Vibration and Noise Reduction**

To reduce the impact of noise and vibration emission, limit the time of operation, use low-vibration and low- noise operating modes as well as wear personal protective equipment.

Take the following points into account to minimise the vibration and noise exposure risks:

1. Only use the product as intended by its design and these instructions.
2. Ensure that the product is in good condition and well maintained.

3. Use correct application tools for the product and ensure they in good condition.
4. Keep tight grip on the handles/grip surface.
5. Maintain this product in accordance with these instructions and keep it well lubricated (where appropriate).
6. Plan your work schedule to spread any high vibration tool use across a longer period of time.

The European Physical Agents (Vibration) Directive has been brought in to help reduce hand arm vibration syndrome injuries to users of product's with vibration emission. The directive requires manufacturers and suppliers to provide indicative vibration test results to enable users to make informed decisions as to the period of time a product can be used safely on a daily basis and the choice of tool. Further advice can be found at [www.hse.gov.uk](http://www.hse.gov.uk)

## **Emergency**

Familiarise yourself with the use of this product by means of this instruction manual. Memorise the safety directions and follow them to the letter. This will help to prevent risks and hazards.

1. Always be alert when using this product, so that you can recognise and handle risks early. Fast intervention can prevent serious injury and damage to property.
2. Switch off and disconnect from the power supply if there are malfunctions. Have the product checked by a qualified professional and repaired, if necessary, before you operate it again.

## **Residual risks**

**Even if you are operating this product in accordance with all the safety requirements, potential risks of injury and damage remain. The following dangers can arise in connection with the structure and design of this product:**

1. Health defects resulting from vibration emission if the product is being used over long periods of time or not adequately managed and properly maintained.
2. Injuries and damage to property due to broken attachments or the sudden impact of hidden objects during use.
3. Danger of injury and property damage caused by flying objects.



**WARNING! This product produces an electromagnetic field during operation! This field may under some circumstances interfere with active or passive medical implants! To reduce the risk of serious or fatal injury, we recommend persons with medical implants to consult their doctor and the medical implant manufacturer before operating this product!**

## PRODUCT DESCRIPTION AND IDENTIFICATIONS

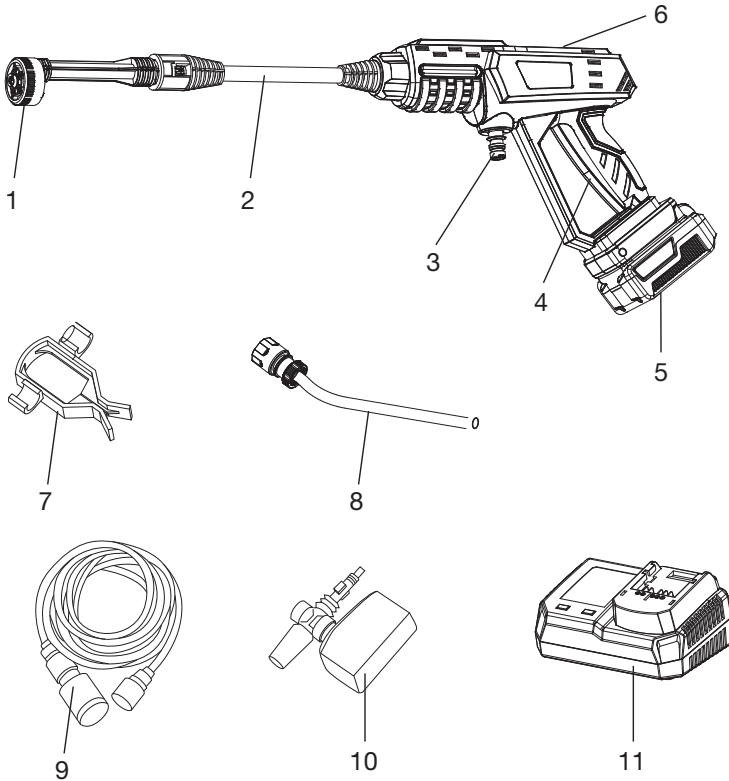

1. 5 in 1 lance
2. Extension lance
3. Water Inlet
4. On/off switch
5. Battery pack
6. Speed setting buttons
7. Bucket clip
8. Bottle interface
9. Water hose with filter
10. Foam sprayer
11. Charger

**Not all the accessories illustrated or described are included in standard delivery.**

## ASSEMBLY AND OPERATING INSTRUCTIONS

### Attaching the battery pack

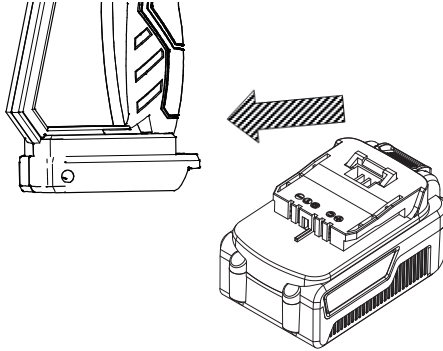

- Align the groove on the battery pack with the corresponding ribs in the receptacle of the spray gun.
- Insert the battery pack until it is securely locked in position.

### Detaching the battery pack

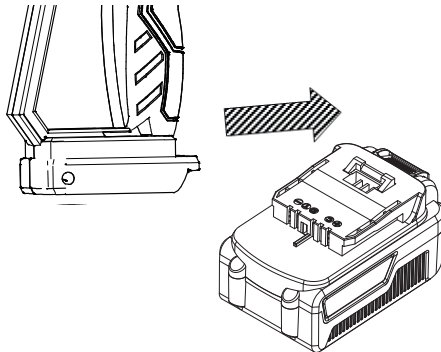

- Press the unlocking button and pull the battery pack out.

## Mounting of lance and nozzle.

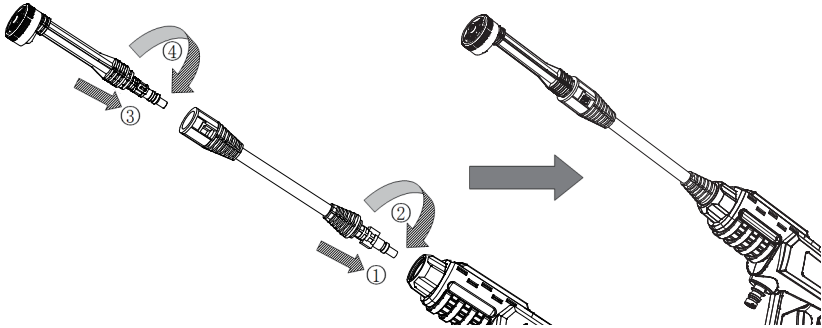

## Connect the water hose to the water inlet

Attach the hose (A end) to the pressure washer water inlet connector, make sure it is locked into position when you hear the “click” sound.

Check the connection by gently pulling upon the hose, make sure the hose is locked into position.

The B-end of the hose has a filter that can be placed directly into the water source for drawing water. The filter at the B-end of the hose can be removed, allowing the hose to connect directly to a tap for water intake. When connecting directly to a tap, it is important to use a backflow preventer to prevent water from flowing back into the potable water system.

**NOTE:** A backflow preventer is available from specialist retailers.

**NOTE:** Water pressure from the tap should not be higher than 0.6Mpa.

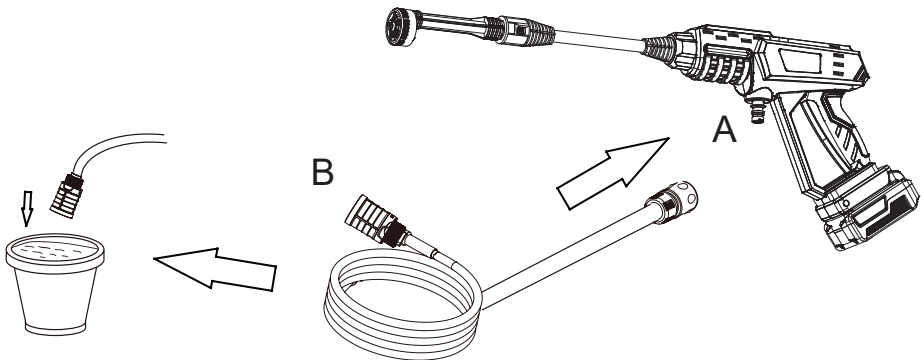

### How to use bucket clip

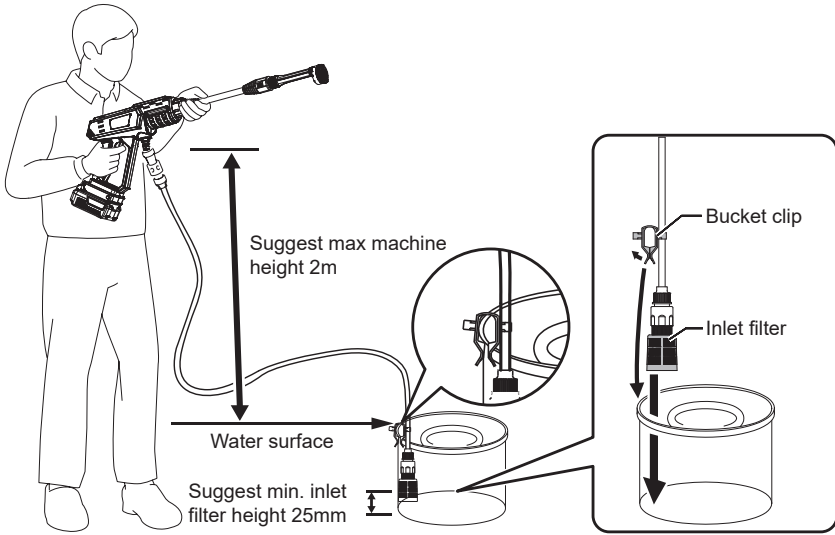

### How to use bottle interface?

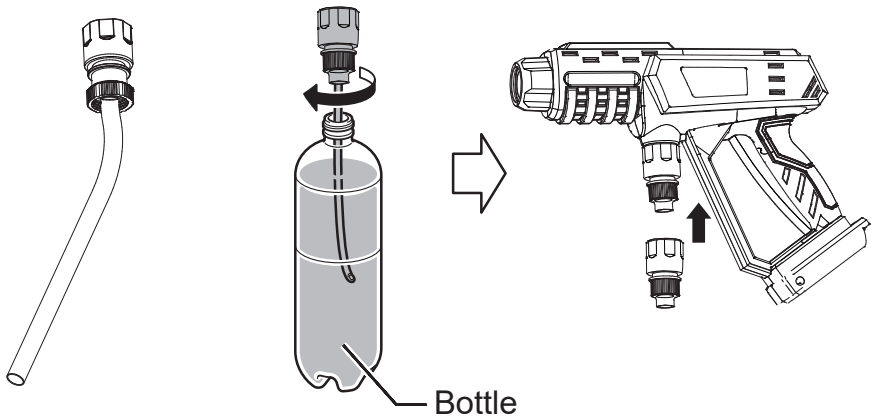

## OPERATION

### Intended use

The product is designated with a rated voltage of 18 V  $\text{---}$  .

The machine is intended for domestic use to clean vehicles, tools, bicycles, outdoor toys, greenhouses, garden furniture, etc.

The water jet should not be directed against persons, animals, any electrical equipment or the product itself. Do not flush any objects which contain health hazardous materials (e.g. asbestos). Do not run the product with inflammable, explosive and toxic liquids.

For safety reasons it is essential to read the entire instruction manual before first operation and to observe all the instructions therein.

### Switching on and off

**Switch on:** Hold the handle and press the on/off switch, then press either the high-speed or low-speed button. The machine will start.

**Warning:** When starting the machine, ensure the spray nozzle is not pointed at people or animals. The speed can be changed by pressing (high speed/low speed) while the machine is running.

**Switch off:** Release the switch lever (4).

Hold trigger for 5-10 seconds for the water to pump into the product if using unsuppressed water feed (eg. bucket or bottle)

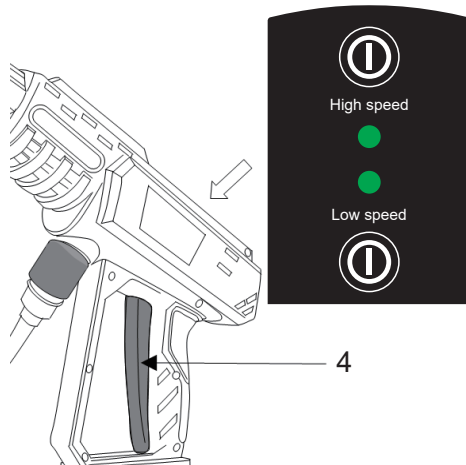

### Adjusting the spray pattern

- 0° - Thin and powerful stream of water for difficult stains and debris.
- 15° - Thin angled spray for focused cleaning.
- 25° - Medium angled spray for focused cleaning.
- 40° - Large fan pattern for wider cleaning applications.
-  - When using a detergent or cleaning solution.

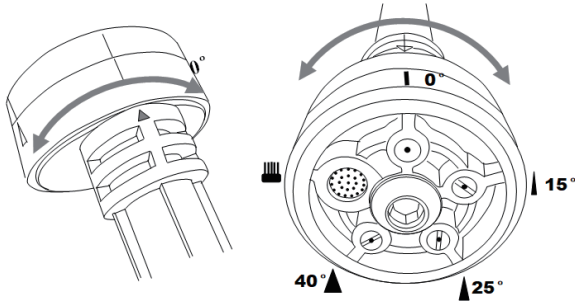

### Cleaning with detergents

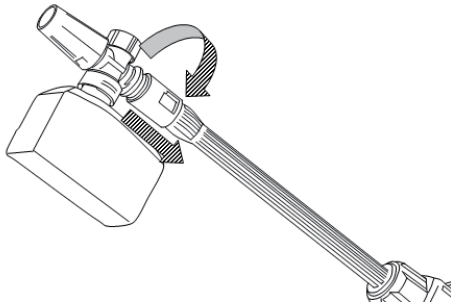

- Pour detergent into the detergent tank.
- The liquid detergent will be mixed with water automatically, and discharged through the detergent nozzle at a low pressure.
- Allow detergent to remain on the surface for a short time before rinsing. Do not allow detergent to dry on the surface.
- Rinse with clean water under high pressure.

## BEFORE OPERATION



**WARNING:** The charger and battery pack are specially designed to work together so do not attempt to use any other devices. Never insert or allow metallic objects into your charger or battery pack connections otherwise an electrical failure and hazard will occur.

**NOTE:** The battery pack comes partly charged. Charge the battery pack prior to first use, ideally for at least 60 minutes.

- Always pull the plug of the charger from the mains before removing or connecting the battery pack to the charger.
- Never charge the battery pack when the ambient temperature is below 5°C or above 45°C.
- Never recharge a battery pack again immediately after rapid charging. This could overcharge the battery pack, thus reducing the lifespan of the battery pack and charger.
- Rest the charger for at least 15 minutes between continuously charging sessions.

### Checking battery capacity

Press the battery capacity level button to check the charging level of the battery pack. The status/remaining capacity will be shown on the battery charging level indication light.

3 Green LED on	Battery pack fully charged
2 Green LED on	Battery pack 65% charged
1 Green LED on	Battery pack 35% charged
No LED lit	Battery is dead and needs to be charged

Charge the battery pack before operating when it is at medium or low battery charging level.

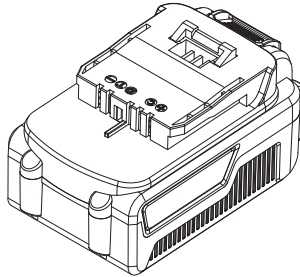

### Charging procedure

- 1) Slide the battery pack into the charger base ensuring the terminals are fully connected.
- 2) Connect the battery charger to the power supply. The indicator light will be red to show that the charging has started.
- 3) When charging is completed, the light will turn to green. The pack is now fully charged, unplug the charger and remove the battery pack.

### Charging light indicator

Red LED on; Green LED off	Charger ready
Red LED on; Green LED flashes	Battery pack charging
Red LED off; Green LED on	Battery pack fully charged
Red LED flashes; Green LED off	Battery pack too cold or hot
Red LED flashes faster; Green LED off	Battery pack defected

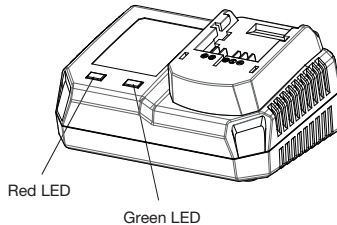

**WARNING:** When battery pack runs out after continuous use or exposure to direct sunlight or heat, allow time for the pack to cool down before re-charging to achieve the full capacity.

## CARE AND CLEANING

Your tool has been designed to operate over a long period of time with a minimum of maintenance. Continuous satisfactory operation depends upon proper tool care and regular cleaning.



**Always switch the product off, remove the battery pack from the product and let the product cool down before performing inspection, maintenance and cleaning work!**



1. Keep the product clean. Remove debris from it after each use and before storage.
2. Regular and proper cleaning will help ensure safe use and prolong the life of the product.
3. Inspect the product before each use for worn and damaged parts. Do not operate it if you find broken and worn parts.



**WARNING! Only perform repairs and maintenance work according to these instructions! All further works must be performed by a qualified specialist!**

### General cleaning

1. Clean the product with a slightly damp cloth and mild soap. Use a brush for areas that are hard to reach.



**NOTE:** Do not use chemical, alkaline, abrasive or other aggressive detergents or disinfectants to clean this product as they might be harmful to its surfaces.

2. Check for any damage and wear. Repair damages in accordance with this instruction manual or take it to an authorised service centre before using the product again.

### Maintenance

Before and after each use, check the product and accessories for wear and damage. If required, exchange them for new ones as described in this instruction manual. Observe the technical requirements.

### Spare parts/Replacement parts

The following parts of this product may be replaced by the consumer. Spare parts are available at an authorised dealer or through our customer service.

Description	Model no. or Specification
5 in 1 lance	ACBK011020
Water hose	ACBK011021
Bucket clip	ACBK011024
Bottle interface assembly	ACBK011023

## Water filter



**NOTE:** Never operate the product with the filter removed or if the filter is damaged.

### Water inlet filter

1. Unscrew and remove the water inlet filter from the water inlet.
2. Rinse the filter with clear water.
3. Reassemble the adaptor afterwards.

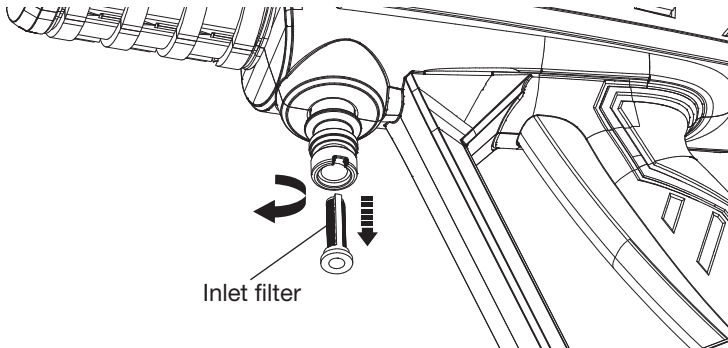

## Decalcification

From time to time - according to the nature of your tap water - calcium deposits form in the product and accessories. The strength of the deposits (and thus the frequency of decalcification) depends upon the degree of hardness of the water and how often the product is used. Check with your supplier in order to find the hardness of the water in your area.



**NOTE:** Use a mixture of water and citric acid or vinegar for decalcification. These substances are readily biodegradable and environmentally friendly!

1. Make a mixture of one part of proper vinegar and two parts hot water (< 50°C) in a suitable container, e. g. in a bowl.
2. Lay the detachable accessories in the mixture.
3. Leave the accessories in the mixture for approximately 12 hours.
4. Rinse the accessories with clear water.

## Repair

This product does not contain any parts that can be repaired by the consumer. Contact our customer service team below or see page 2/32 for product support and spare parts.

## **Storage**

1. Switch the product off and disassemble the battery pack from the product.
2. Disconnect the product from the water supply. Empty the water in water hose if necessary.
3. Clean the product as described above.
4. Drain remaining water at the end of the working session.
5. Store the product and its accessories in a dry, frost-free place. Always store the product in a place that is inaccessible to children. The ideal storage temperature is between 10 °C and 30 °C.
6. We recommend using the original package for storage or covering the product with a suitable cloth or enclosure to protect it against dust.

## **Transportation**

1. Switch the product off and disassemble the battery from the product.
2. Disconnect the product from the water supply. Empty the water in water hose if necessary.
3. Attach transportation guards, if applicable.
4. Protect the product from any heavy impact or strong vibrations which may occur during transportation in vehicles.
5. Secure the product to prevent it from slipping or falling over.

## TROUBLE SHOOTING

Use this section to help you to try and solve any problems you may have:

PROBLEM	POSSIBLE CAUSES	REMEDIES
1. Product does not start	1.1. Battery discharged 1.2. Battery too hot/cold 1.3. Other electrical defect to the product	1.1. Recharge battery 1.2. Allow to cool/warm 1.3. Contact customer service team, see page 2/32 for product support
2. Product does not reach full power	2.1. Filter dirty 2.2. Air being sucked into the system	2.1. Clean the filter 2.2. Check tightness of hose fittings
3. Strong pressure fluctuations	3.1. Water inlet volume is too low 3.2. Intake filter dirty 3.3. Air being sucked into the system 3.4. Water tank empty	3.1. Increase water inlet quantity 3.2. Clean the filter 3.3. Check tightness of hose fittings 3.4. Refill water tank
4. Water leakage from product	4.1. Seals worn	4.1. Contact customer service team, see page 2 and 32 for product support and spare parts
5. Excessive vibration/ noise	5.1. Screws and nuts loose 5.2. Motor problems 5.3. Water inlet volume is too low	5.1. Check screws and nuts for tightness and re-tighten as necessary 5.2. Contact customer service team, see page 2 and 32 for product support and spare parts 5.3. Increase water inlet quantity
6. No water jet	6.1. No water supply 6.2. Filter is dirty 6.3. Hose blocked 6.4. Nozzle blocked	6.1. Check water supply 6.2. Clean filter 6.3. Check hose 6.4. Check nozzle

**NOTE: IF YOU EXPERIENCE A PROBLEM WITH YOUR TOOL, PLEASE DO NOT ATTEMPT TO OPEN OR REPAIR THE TOOL YOURSELF. DOING SO MAY VOID THE WARRANTY AND COULD CAUSE DAMAGE OR PERSONAL INJURY. IF THE PROBLEM STILL PERSISTS, PLEASE CONTACT US BY REFERRING TO THE SERVICE & SUPPORT INFORMATION ON THE FOLLOWING PAGE.**

## DECLARATION OF CONFORMITY / PERFORMANCE



**Product Code: 74918 (GY212806)**

**Product Description: Hawksmoor 18V Cordless Hand Held Pressure Washer**

1. Toolstation (company number 04372131)

This declaration of conformity is issued under the sole responsibility of Toolstation

2. Object of the declaration

The object of the declaration described above is in conformity with the relevant Community harmonization legislation:

Electrical Equipment (Safety) Regulation 2016 as amended

Electromagnetic Compatibility Regulations 2016 as amended

The Restriction of the use of Certain Hazardous Substances in Electrical and Electronic Equipment Regulations 2012 as amended

3. References to the relevant standards used or references to the specifications in relation to which conformity is declared:

BS EN 60335-1

BS EN 60335-2-54

BS EN 60335-2-29

BS EN 55014-1

BS EN 55014-2

BS EN 61000-3-2

BS EN 61000-3-3

4. Additional information

Signed for and on behalf of Toolstation Limited

## ENVIRONMENTAL INFORMATION



The symbol on the product or its packaging indicates that this product must not be disposed of with your other household waste. Instead, it is your responsibility to dispose of your waste equipment by handing it over to a designated collection point for the recycling of waste electrical and electronic equipment. The separate collection and recycling of your waste equipment at the time of disposal will help conserve natural resources and ensure that it is recycled in a manner that protects human health and the environment. For more information about where you can drop off your waste for recycling, please contact your local authority, or where you purchased your product.

## WARRANTY

Toolstation products deliver reliable service for normal, household use in domestic settings. All Toolstation products are individually tested before leaving the factory.

If you are a consumer and you experience a problem with your Toolstation product, which is found to be defective due to faulty materials or workmanship within the Warranty Period, this Toolstation Warranty will cover repair or - at the discretion of Toolstation – replacement with a functionally equivalent Toolstation product.

Your product is under warranty for 2 years from the date of purchase or the date of delivery of the product, if later.

The warranty is subject to the following provisions:

- The warranty does not cover accidental damage, misuse, cabinet parts, knobs, or consumable items.
- The product must be correctly installed and operated in accordance with the instructions contained in this manual.
- It must be used solely for domestic purpose.
- The warranty will be rendered invalid if the product is re-sold or has been damaged by inexpert repair.
- Specifications are subject to change without notice.
- The manufacturer disclaims any liability for the incidental or consequential damages.
- The warranty is in addition to, and does not diminish your statutory or legal rights

## CUSTOMER SUPPORT

[www.coreservice.co.uk](http://www.coreservice.co.uk)

Call us +44 01904 947568

Email: [support@coreservice.co.uk](mailto:support@coreservice.co.uk)

Made in China

# PRODUCT SUPPORT

In the unlikely event of you needing technical support, replacement part or you believe a repair is needed, please contact us in the first instance by following the steps below.



SCAN ME

## STEP 1

Find your proof of purchase and scan this QR code **OR** call our helpline below

## STEP 2

Get in touch with our team and receive expert technical support



## STEP 3

Our team will arrange collection to repair your product under warranty **OR** an alternative resolution



## STEP 4

Your product will be assessed and if required, repaired back to full working order



## STEP 5

Your repaired product will be returned to you via courier within 10 days



## GET IN TOUCH

 01904 947568

 [support@coreservice.co.uk](mailto:support@coreservice.co.uk)

We recommend you keep the original packaging, if repair is needed.

 Technical support: 9am-5pm, Mon-Fri

 Helpline: 24/7

  
**HAWKSMOOR**