

POWERBASE

4V 4.0Ah Cordless
Pruners 491570

Instruction Manual

IMPORTANT!
Please read these
instructions fully before
starting assembly.



These instructions contain important information that will help you get the best from your product, ensuring it is assembled correctly and safely. If you need help or have damaged or missing parts, call the Customer Helpline on 01904 727 509.

Contents

General safety warnings	3
Additional safety instructions for batteries and chargers	11
Intended use	16
Warning symbols	17
In the box	18
Assembly	19
Operation	22
Maintenance and storage	24
Troubleshooting	26
Technical data	27
Disposal	28
Getting help	28
Warranty	29

General Safety Warnings

General power tool safety warnings



WARNING! Read all safety warnings and all instructions.

Failure to follow the warnings and instructions may result in electric shock, fire and/or serious injury.

Save all warnings and instructions for future reference.

The term 'power tool' in the warnings refers to your mains-operated (corded) power tool or battery-operated (cordless) power tool.

Work area safety

- **Keep work area clean and well lit.** Cluttered or dark areas invite accidents.
- **Do not operate power tools in explosive atmospheres, such as in the presence of flammable liquids, gases or dust.** Power tools create sparks which may ignite the dust or fumes.
- **Keep children and bystanders away while operating a power tool.** Distractions can cause you to lose control.

Electrical safety

- **Power tool plugs must match the outlet. Never modify the plug in any way. Do not use any adaptor plugs with earthed (grounded) power tools.** Unmodified plugs

and matching outlets will reduce the risk of electric shocks.

- **Avoid body contact with earthed or grounded surfaces, such as pipes, radiators, ranges and refrigerators.** There is an increased risk of electric shocks, if your body is earthed or grounded.
- **Do not expose power tools to rain or wet conditions.** Water entering a power tool will increase the risk of electric shocks.
- **Do not abuse the cord. Never use the cord for carrying, pulling or unplugging the power tool.** Keep the cord away from heat, oil, sharp edges or moving parts. Damaged or entangled cords increase the risk of electric shocks.
- **When operating a power tool outdoors, use an extension cord suitable for outdoor use.** When using a cord suitable for outdoor use, this will reduce the risk of electric shocks.
- **If operating a power tool in a damp location is unavoidable, use a residual current device (RCD) protected supply.** Use of an RCD reduces the risk of electric shock.

Personal safety

- **Stay alert, watch what you are doing and use common sense when operating a power tool. Do not use a power tool while you are tired or under the influence of drugs, alcohol or medication.** A moment of inattention while operating power tools may result in serious personal injury.
- **Use Personal Protective Equipment**

(PPE). Always wear eye protection.

Protective equipment, such as an eye mask, a dust mask, non-skid safety shoes, hard hat, or hearing protection used for appropriate conditions will reduce personal injuries.

- **Prevent unintentional starting. Ensure the switch is in the ‘off’ position before connecting to a power source and/or battery pack, picking up or carrying the tool.** Carrying power tools with your finger on the switch or energising power tools that have the switch on invites accidents.
- **Remove any adjusting key or wrench before turning the power tool on.** A wrench or a key left attached to a rotating part of the power tool may result in personal injury.
- **Do not overreach. Keep proper footing and balance at all times.** This enables better control of the power tool in unexpected situations.
- **Dress properly. Do not wear loose clothing or jewellery. Keep your hair, clothing and gloves away from moving parts.** Loose clothes, jewellery or long hair can be caught in moving parts.
- **If devices are provided for the connection of dust extraction and collection facilities, ensure these are connected and properly used.** Use of dust collection can reduce dust-related hazards.
- **If devices are provided for the connection of dust extraction and collection facilities, ensure these are connected and properly used.** Use of dust collection can reduce dust-related hazards.
- **Do not let familiarity gained from**

frequent use of tools allow you to become complacent and ignore tool safety principles. A careless action can cause severe injury within a fraction of a second.

Power tool use and care

- **Do not force the power tool. Use the correct power tool for your application.** The correct power tool will do the job better and safer at the rate for which it was designed.
- **Do not use the power tool if the switch does not turn it on and off.** Any power tool that cannot be controlled with the switch is dangerous and must be repaired.
- **Disconnect the plug from the power source and/or the battery pack from the power tool, before making any adjustments, changing accessories, or storing power tools.** Such preventive safety measures reduce the risk of starting the power tool accidentally.
- **Store idle power tools out of the reach of children, and do not allow persons unfamiliar with the power tool or these instructions to operate the power tool.** Power tools are dangerous in the hands of untrained users.
- **Maintain power tools. Check for misalignment or binding of moving parts, breakage of parts and any other condition that may affect the power tools operation. If damaged, have the power tool repaired before use.** Many accidents are caused by poorly maintained power tools.

- **Keep cutting tools sharp and clean.** Properly maintained cutting tools with sharp cutting edges are less likely to bind and are easier to control.
- **Use the power tool, accessories and tool bits, etc., in accordance with these instructions, taking into account the working conditions and the work to be performed.** Use of the power tool for operations different from those intended, could result in a hazardous situation.
- **Keep handles and grasping surfaces dry, clean and free from oil and grease.** Slippery handles and grasping surfaces do not allow for safe handling and control of the tool in unexpected situations.

Battery tool use and care

- **Recharge only with the charger specified by the manufacturer.** A charger that is suitable for one type of battery pack may create a risk of fire when used with another battery pack.
- **Use power tools only with specifically designated battery packs.** Use of any other battery packs may create a risk of injury and fire.
- **When a battery pack is not in use, keep it away from other metallic objects, like paper clips, coins, keys, nails, screws or other small metallic objects, that can make a connection from one terminal to another.** Shorting the battery terminals together may cause burns or a fire.
- **Under abusive conditions, liquid may be**

ejected from the battery; avoid contact. If contact accidentally occurs, flush with water. If liquid contacts eyes, immediately seek medical help. Liquid ejected from the battery may cause irritation or burns.

- **Do not use a battery pack or tool that is damaged or modified.** Damaged or modified batteries may exhibit unpredictable behaviour resulting in fire, explosion or risk of injury.
- **Do not expose a battery pack or tool to fire or excessive temperature.** Exposure to fire or temperature above 130°C may cause an explosion.
- **Follow all charging instructions and do not charge the battery pack or tool outside the temperature range specified in the instructions.** Charging improperly or at temperatures outside the specified range, may damage the battery and increase the risk of fire.

Service

Have your power tool serviced by a qualified technician using only identical replacement parts. This will ensure that the safety of the power tool is maintained.

Never service damaged battery packs. Service of battery packs should only be performed by the manufacturer or authorised service providers.

Additional Safety Instructions for Batteries and Chargers

Safety warnings for the battery pack



WARNING! Read all safety warnings and all instructions. Failure to follow the warnings and instructions may result in electric shocks, fire and/or serious injury.

Save all warnings and instructions for future reference.

- Do not dismantle, open or shred cell in the tool.
- Do not short-circuit a battery pack. Do not store battery packs haphazardly in a box or drawer where they may short circuit each other, or be short-circuited by conductive materials. When the battery pack is not in use, keep it away from other metallic objects, like paper clips, coins, keys, nails, screws or other small metal objects that can make a connection from one terminal to another. Shorting the battery terminals together may cause burns or a fire.
- Do not expose battery packs to heat or fire. Avoid storage in direct sunlight.
- Do not subject battery packs to mechanical shock.
- In the event of the battery leaking, do not allow the liquid to come into contact with the skin or eyes. If contact has been made, wash the affected area with copious amounts of water and seek medical advice.
- Seek medical advice immediately if a cell or battery pack has been swallowed.
- Keep the battery pack clean and dry.

- Wipe the battery pack terminals with a clean, dry cloth if they become dirty.
- Battery packs need to be charged before use. Always refer to this instruction manual and use the correct charging procedure.
- Whilst the battery pack is being charged, refrain from any maintenance.
- After extended periods of storage, it may be necessary to charge and discharge the battery pack several times to obtain maximum performance.
- The battery pack gives its best performance when it is operated at normal room temperature ($20^{\circ}\text{C} \pm 5^{\circ}\text{C}$).
- When disposing of battery packs, keep battery packs of different electrochemical systems separate from each other.
- Recharge only with the charger specified by the manufacturer. Do not use any charger other than that specifically provided for use with the equipment. A charger that is suitable for one type of battery pack may create a risk of fire when used with another battery pack.
- Do not use any battery pack which is not designed for use with the equipment.
- Keep the battery pack out of the reach of children.
- Retain the original product literature for future reference.
- Remove the battery from the equipment when not in use.
- Dispose of the battery properly.

Safety warnings for charging



WARNING! Read all safety warnings and all instructions. Failure to follow the warnings and instructions may result in an electric shock, fire and/or serious injury.

Save all warnings and instructions for future reference.

- If the type-c charging cable is damaged, it must be replaced in order to avoid a hazard.
- Before charging, read the instructions.
- After charging, disconnect the type c charging cable from the mains supply. Then remove the type c charging cable from the pruner.
- Do not charge a leaking battery.
- Before charging, ensure your charger matches the local AC supply.
- Charge the battery indoors and only use in dry conditions.
- The charging device must be protected from moisture.
- Do not use the charging device in the open.
- Shorting the battery terminals together may cause burns or a fire.
- Respect the polarity “+/-“ when charging.
- Do not open the unit and keep out of the reach of children.
- Do not charge the batteries of other manufacturers or ill-suited models.

- Ensure that the connection between the type c charging cable and pruner is correctly positioned and is not obstructed by foreign bodies.
- Ensure type c charging port is clear and unobstructed. Store in a dry and frost-free place to protect against dirt and humidity.
- When charging batteries, ensure that the battery charger is in a well-ventilated area and away from flammable materials. Batteries can heat up quickly whilst charging. Ensure that batteries and chargers are not left unsupervised during charging.
- Do not recharge non-rechargeable batteries, as they can overheat and break.
- Longer life and better performance can be obtained if the battery pack is charged when the air temperature is between 18°C and 24°C. Do not charge the battery pack in air temperatures below 0°C, or above 45°C. This is important as it can prevent serious damage to the battery pack.
- Charge only the battery pack of the same model provided by the manufacturer, and those of models recommended by the manufacturer.

Additional instructions for cordless pruners

- Do not use the pruner in bad weather conditions, especially when there is a risk of lightning. This decreases the risk of being struck by lightning.

- Keep all power cords and cables away from the cutting area. Power cords or cables may be hidden and can be accidentally cut by the blade.
- Wear gloves while working. Adequate protective equipment will reduce the risk of injury.
- Hold the pruner via the insulated gripping surfaces only, because the blade may contact hidden wiring. Blades contacting a 'live' wire may make exposed metal parts of the pruner 'live' and could give the operator an electric shock.
- Keep all parts of the body away from the blade. Do not remove cut material or hold material to be cut when blades are moving. A moment of inattention while operating the pruner may result in serious personal injury.
- When clearing jammed material or servicing the pruner, make sure the power switch is off and the battery pack is removed or disconnected. Unexpected actuation of the pruner while clearing jammed material or servicing may result in serious personal injury.
- Carry the pruner via the handle with the blade stopped, taking care not to operate the power switch. Proper carrying of the pruner will decrease the risk of inadvertent starting and resultant personal injury from the blades.
- When transporting or storing the pruner, always use the blade cover. Proper handling of the pruner decreases the risk of personal injury from blades.

- Follow instructions for lubricating and changing accessories.
- Keep handles dry, clean, and free from oil and grease. Greasy, oily handles are slippery, causing loss of control.
- Do not modify the product in any way or use parts and accessories that are not recommended by the manufacturer.
- **WARNING!** The blades continue to move after releasing the trigger. Turn off the tool and wait until the blades come to a complete stop before adjusting or cleaning.
- **CAUTION!** Wear protective gloves while working with the pruner. Never touch the blades while the tool is in operation and be aware of the sharp edges, even when the pruner is not in use.

Vibration and noise reduction

To reduce the impact of noise and vibration emissions, limit the time of operation, use low-vibration and low-noise operating modes as well as wear personal protective equipment.

- Take the following points into account to minimise the vibration and noise exposure risks.
- Only use the product as intended by its design and these instructions.
- Ensure that the product is in good condition and well maintained.
- Use correct application tools for the

product and ensure they are in good condition.

- Keep tight grip on the handles/gripping surface.
- Maintain this product in accordance with these instructions and keep it well lubricated (where appropriate).
- Plan your work schedule to spread any high vibration tool use across a longer period of time.

Emergency

Familiarise yourself with the use of this product by means of this instruction manual. Memorise the safety directions and follow them to the letter. This will help to prevent risks and hazards.

- Always be alert when using this product, so that you can recognise and handle risks early. Fast intervention can prevent serious injury and damage to property.
- Switch off and disconnect from the power supply if there is any malfunction. Have the product checked by a qualified specialist and repaired, if necessary, before you put it into operation again.

Residual risks

Even if you are operating this product in accordance with all the safety requirements, potential risks of injury and damage remain. The following dangers can arise in connection with the structure and design of this product:

- Health defects resulting from vibration emission, if the product is being used over long periods of time, or not adequately managed and properly maintained.
- Injuries and damage to property due to broken application tools or the sudden impact of hidden objects during use.
- Danger of injury and property damage caused by flying objects.



WARNING! This product produces an electromagnetic field during operation! This field may, under some circumstances, interfere with active or passive medical implants! To reduce the risk of serious or fatal injury, we recommend persons with medical implants to consult their doctor and the medical implant manufacturer, before operating this product!

Intended Use

This product is a battery-driven electric pruner. It comprises a fixed blade, a Moveable blade, lithium battery, battery charger and other components. It's designed for cutting or trimming 14mm or less branches. Simple and easy to operate, it also has 8-10 times the efficiency of traditional manual pruners. Pruning quality is significantly higher compared to manual pruners.

Warning Symbols

The following warning symbols appear throughout this manual and indicate the appropriate safety measures you should take when operating and maintaining the electric cordless pruner.



To reduce the risk of injury, the user must read the instruction manual.



WARNING!

This is a warning symbol. This symbol is used throughout the user guide whenever there is a risk of personal injury. Ensure that these warnings are read and understood at all times.



Do not expose the tool to moisture. Do not work when it is raining.



Keep hands away from blade.



Wear safety glasses.



The product complies with the applicable European directives and an evaluation method of conformity for these directives was done.



WEEE symbol. Waste electrical products should not be disposed of with household waste. Please recycle where facilities exist. Check with your local authority or local store for recycling guidelines.



Batteries contain Li-ion. Do not dispose of waste batteries in domestic waste. Contact your local authority to find out how to dispose of batteries.

In the Box

Parts

1. Moveable blade
2. Fixed blade
3. Battery capacity indicating lights
4. Main trigger
5. Power ON/OFF switch
6. Working indicating light
7. Type c charging port
8. Type c charging cable
9. Blade sheath
10. Quick change button

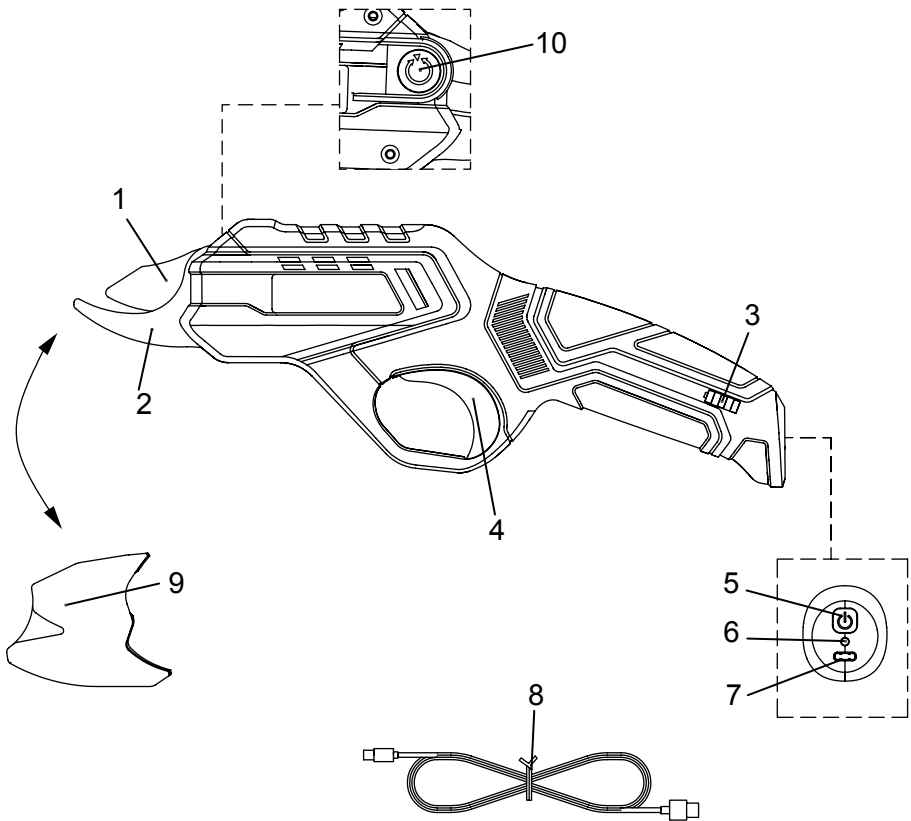

If there are any parts missing, please call the customer helpline on 01904 727 509

Assembly



WARNING!

Always wear gloves when handling the pruner.

Unpacking

1. Remove all packing materials and shipping devices, if applicable.
2. Unpack all parts and lay them on a flat and stable surface.
3. Make sure the delivery contents are complete and free of any damage. If you find that parts are missing or show damage, do not use the product. Contact the aftersales service within 28 days of purchase. Using an incomplete or damaged product represents a hazard to people and property.
4. Ensure that you have all the accessories and tools needed for assembly and operation. This also includes suitable personal protective equipment.

Pruner assembly

Open the packaging and remove the blade sheath, as shown below.

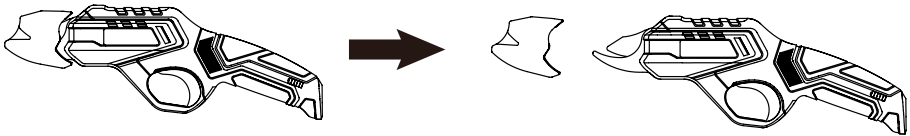

Charging the Battery



WARNING!

Never insert or allow metallic objects into your charger or battery pack connections; an electrical failure and hazard will occur.

The battery needs to be charged before first use and whenever it fails to produce sufficient power on jobs that were easily done before.

The charging procedure



WARNING! It is not recommended to charge the battery immediately after using the machine, as the battery temperature is high. The pruner should be cooled for a period of time.

1. Connect the type c charging cable (8) to the type c charging port (7). The working indicating light (6) will be red.
2. Battery capacity indicating lights (3) switching from one red light to red, yellow, and green three lights means it is being charged. When charging is complete, the left three battery capacity indicating lights (3) will become red, yellow, and green three lights.
3. Once the battery is fully charged, disconnect the charger from the mains and remove type c charging cable from the machine.

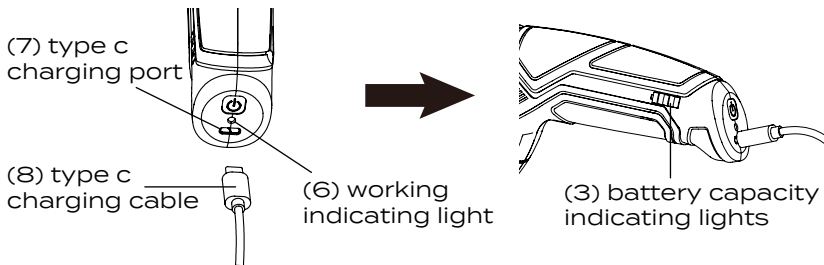

Important charging notes

Longest life and best performance can be obtained if the battery pack is charged when the air temperature is between 18-24°C. Do not charge the battery pack in a very low or very high air temperature. This is important and will prevent serious damage to the battery pack.

When using your tool continuously, the batteries in your battery pack will become hot. You should let a hot battery pack cool down for approximately 30 minutes before attempting to recharge.

The charger and battery pack may become warm to touch while charging. This is a normal condition and does not indicate a problem.

Use the charger at normal room temperatures whenever possible. To prevent overheating, do not cover the charger and do not charge battery packs in direct sunlight or near heat sources.

If the battery pack does not charge properly:

1. Check the mains socket by plugging in a lamp or other appliance.
2. Move the charger and battery pack to a location where the surrounding air temperature is approximately 18-24°C.
3. If charging problems persist, take or send the tool, battery pack and charger to your local service centre.

The battery pack should be recharged when it fails to produce sufficient power on jobs which were easily done before. **DO NOT CONTINUE** to use under these conditions. Follow the charging procedure. You may also charge a partially used pack whenever you desire, with no adverse effect on the battery pack.

Under certain conditions, with the charger plugged in to the power supply, the exposed charging contacts inside the charger can be shorted by foreign material. Foreign materials of a conductive nature, such as, but not limited to, steel wool, aluminium foil, or any build-up of metallic particles, should be kept away from charger cavities. Always unplug the charger from the power supply when there is no battery pack in the cavity. Unplug the charger before attempting to clean it.

Do not immerse the charger in water or any other liquid.



WARNING! Don't allow any liquid to get inside the charger; electric shock may result. To facilitate the cooling of the battery pack after use, avoid placing the charger or battery pack in a warm environment, such as in a metal shed or an un-insulated trailer.



WARNING! Never attempt to open the battery for any reason. If the plastic housing of the battery pack breaks or cracks, return it to a service centre for recycling; do not put it into further use.

Operation

Pruner operation



WARNING! Wear protective gloves and eye protection while working with the pruner.

1. Press ON/OFF switch power on, the working indicating light will be green.

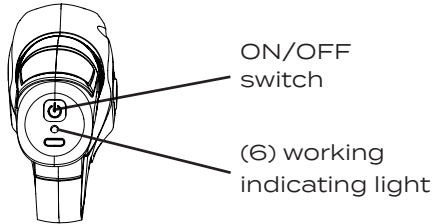

2. Quickly press the main trigger twice, and then the pruner is ready to operate.

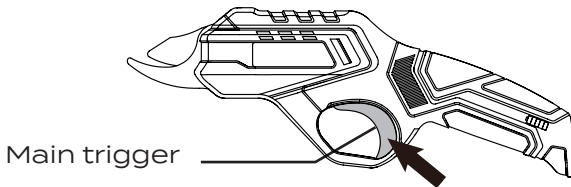

3. When the main trigger is pressed, the blade performs a cutting action. Once the trigger is released, the moveable blade will return to the 'open' position.

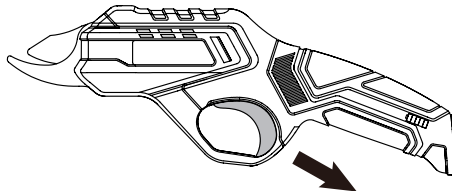

4. Press and hold the main trigger for 5 seconds, and the blade will remain closed. Press the switch twice quickly, and the blade will open again.

Note:

If pruner is not operated for 30 seconds, the pruner will go into standby mode, and the working indicating light will be green. To reactivate the pruner, quickly press the trigger twice.

If pruner is not operated for 120 seconds, the pruner will automatically shut down and the working indicating light(6) will turn off.

Switch off

Press the ON/OFF the switch to turn off the power.

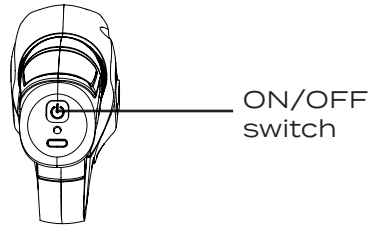

Maintenance and Storage

Preventative maintenance



WARNING! Before any maintenance, or adjustment, always turn off the pruner and wear protective gloves. This protective measure aims to reduce the risk of accidental pruning scissor activation.

1. Turn off the pruner by press the power ON/OFF switch (5).
2. Press quick change button (10).
3. Pull out the moveable blade (1).
4. Insert the new cutting blade back into the tool while holding the quick change button (10).
5. Ensure that the cutting blade is firmly in place.

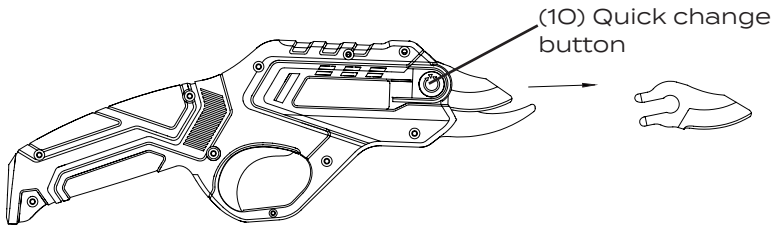

Cleaning



WARNING! Before commencing cleaning procedures or when clearing a blockage, make sure that the pruner is turned off. Wear safety glasses to protect your eyes whilst cleaning.

Keep the pruner clean, use a clean cloth to clean the pruner (do not use any abrasive or solvent-based cleaning agents). Use a soft brush or a dry towel to clean the dust off the pruning shear head.

Do not immerse the pruner, battery or charger in any liquid.

Storage and transport

After cleaning the pruner thoroughly, store it in a safe, dry room, allowing the motor to cool down beforehand.

Store the pruner out of the reach of children.

Use the original packaging to store the pruner, whenever possible.

Troubleshooting

Problem	Possible case	Solution
Can't turn on	<ol style="list-style-type: none">1. Low battery capacity2. The pruner battery temperature is too high or low.3. The pruner is in standby mode	<ol style="list-style-type: none">1. Recharge battery2. Allow the pruners to warm/cool naturally to room temperature (within battery operating temperature 10–40 °C)3. Quickly press the main trigger twice
Can't cut off the branches completely	<ol style="list-style-type: none">1. Low battery capacity.2. The blade is blunt.3. Wood is too large/hard.	<ol style="list-style-type: none">1. Recharge battery.2. Change the blade.3. Wood is unsuitable for this pruner.
Cutting blade became jammed in the branch	<ol style="list-style-type: none">1. Battery capacity low2. Wood is too large/hard	<ol style="list-style-type: none">1. Recharge battery2. Wood is unsuitable for this pruner.
Temperature extremely high	Product has overheated	Please let the machine to cool completely.

Technical Data

Model No.	J1J-2ZTH-ZZ-14
Voltage	4V DC
Max. cutting capacity	14mm soft wood 12mm hardwood
Product weight	0.72kg
The vibration total value	$< 2.5\text{m/s}^2$ $K=1.5\text{m/s}^2$
A weighted sound pressure level	63.3dB, K=3dB
A weighted sound power level	71.3dB, K=3dB

Type c charging cable	
Output voltage & current	5.0V $\overline{\text{---}}$, 2.0A
Battery pack	
Battery voltage	4.0 V $\overline{\text{---}}$, Li-ion
Battery capacity	4.0Ah



WARNING! The sound values have been determined according to the noise test code given in EN 62841-1, using the basic standards ISO 11203 and ISO 3744.

The sound intensity level for the operator may exceed 80dB(A) and ear protection measures are necessary.

The declared vibration value (according to EN 62841-1) has been measured in accordance with a standard test method, and may be used for comparing one product with another.

The declared vibration value may also be used in a preliminary assessment of exposure.

Depending on the actual use of the product, the vibration values can differ from the declared total. Adopt proper measures to protect yourself against vibration exposures. Take the whole work process into consideration, including times the product is running under no load or switched off.



WARNING! This tool may cause Hand-Arm Vibration Syndrome (HAVS) if its use is not adequately managed.

Preventative measures include, among others, regular maintenance and care of the product and cutting attachments, keeping hands warm and periodical breaks, as well as proper planning of work processes.

Disposal

The pruner and its accessories are made of various recyclable materials. Dispose of the pruner in accordance with your local recycling regulations.

Getting help

Our dedicated UK-based customer helpline is open 7 days a week to assist you with assembly, parts queries and technical support. We are open during office hours but you can always send an email via **support@coreservice.co.uk**. Our experts are here to get you back enjoying your garden in no time.

For useful assembly, starting and maintenance videos, and for ordering spares, please visit **www.coreservice.co.uk**.

Using our service does not affect your statutory rights.

Warranty

This product is covered by a 1 year warranty.

The warranty covers any manufacturing defect in materials, workmanship and finish.

Any claim under this warranty must be made by going to your nearest The Range store, taking your proof of purchase with you, and claims must be made within 1 year of the date of purchase.

We will offer you a free repair of the item where this is possible, or a replacement or a refund. Your statutory rights remain unaffected, in particular, any rights you may have under the Consumer Rights Act 2015.

This warranty is given by CDS Group, Plymouth, PL6 5ZD
CDS Group, Dublin, DO2 AY28 .

Please note: This warranty does not apply to products misused or neglected and only covers domestic use. The warranty period for the battery pack and charger is 1 year.