

POWERBASE

20cm 20V Cordless
Pole Saw 660838

Instruction Manual

IMPORTANT!
Please read these
instructions fully before
starting assembly.

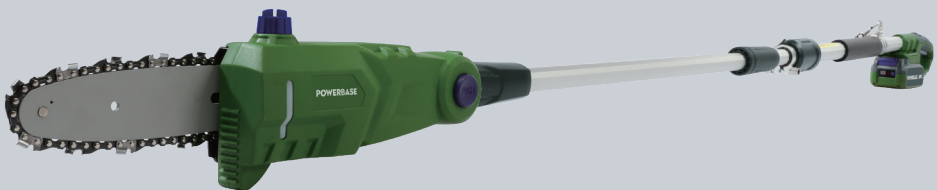

These instructions contain important information that will help you get the best from your product, ensuring it is assembled correctly and safely. If you need help or have damaged or missing parts, call the Customer Helpline on 01904 727 509.

Contents

General Safety Warnings	3
Service	8
Additional Safety Instructions for Batteries and Chargers	9
Additional Safety Instructions for Pole Saw	12
Intended Use	18
Warning Symbols on the Power Tool	18
In the Box	21
Assembly	22
Operating the Pole Saw	27
Maintenance and Storage	32
Troubleshooting	37
Technical Data	38
Disposal	40
Getting help	40
Warranty	40

General Safety Warnings

General power tool safety warnings

 **WARNING** Read all safety warnings, instructions, illustrations and specifications provided with this power tool. Failure to follow all instructions listed below may result in electric shock, fire and/or serious injury.

Save all warnings and instructions for future reference

The term 'power tool' in the warnings refers to your mains-operated (corded) power tool or battery-operated (cordless) power tool.

Work area safety

- **Keep work area clean and well lit.** Cluttered or dark areas invite accidents.
- **Do not operate power tools in explosive atmospheres, such as in the presence of flammable liquids, gases or dust.** Power tools create sparks which may ignite the dust or fumes.
- **Keep children and bystanders away while operating a power tool.** Distractions can cause you to lose control.

Electrical safety

- **Power tool plugs must match the power outlet. Never modify the plug in any way. Do not use any adaptor plugs with earthed (grounded) power tools.** Unmodified plugs and matching outlets will reduce the risk of

electric shock.

- **Avoid body contact with earthed or grounded surfaces, such as pipes, radiators, ranges and refrigerators.** There is an increased risk of electric shock. If your body is earthed or grounded.
- **Do not expose power tools to rain or wet conditions.** Water entering a power tool will increase the risk of electric shock.
- **Do not abuse the cord. Never use the cord for carrying, pulling or unplugging the power tool.** Keep cord away from heat, oil, sharp edges or moving parts. Damaged or entangled cords increase the risk of electric shock.
- **When operating a power tool outdoors, use an extension cord suitable for outdoor use.** When using a cord suitable for outdoor use, this will reduce the risk of electric shock.
- **If operating a power tool in a damp location is unavoidable, use a residual current device (RCD) protected supply.** Use of an RCD reduces the risk of electric shock.

Personal safety

- **Stay alert, watch what you are doing and use common sense when operating a power tool. Do not use a power tool while you are tired or under the influence of drugs, alcohol or medication.** A moment of inattention while operating power tools may result in serious personal injury.

- **Use personal protective equipment (PPE). Always wear eye protection.** Protective equipment, such as a dust mask, non-skid safety shoes, hard hat, or hearing protection used for appropriate conditions will reduce personal injuries.
- **Prevent unintentional starting. Ensure the switch is in the ‘off’ position before connecting to a power source and/or battery pack and when picking up or carrying the tool.** Carrying power tools with your finger on the switch or energising power tools that have the switch on invites accidents.
- **Remove any adjusting key or wrench before turning the power tool on.** A wrench or a key left attached to a rotating part of the power tool may result in personal injury.
- **Do not overreach. Keep proper footing and balance at all times.** This enables better control of the power tool in unexpected situations.
- **Dress properly. Do not wear loose clothing or jewellery. Keep your hair, clothing and gloves away from moving parts.** Loose clothes, jewellery or long hair can be caught in moving parts.
- **If devices are provided for the purpose of dust extraction and collection facilities, ensure these are connected and properly used.** Use of dust collection can reduce dust-related hazards.
- **Do not let familiarity gained from frequent use of tools allow you to become complacent and ignore tool safety principles.** A careless action can cause

Power tool use and care

- **Do not force the power tool. Use the correct power tool for your application.** The correct power tool will do the job better and safer at the rate for which it was designed.
- **Do not use the power tool if the switch does not turn it on and off.** Any power tool that cannot be controlled with the switch is dangerous and must be repaired.
- **Disconnect the plug from the power source and/or the battery pack from the power tool before making any adjustments, changing accessories or storing power tools.** Such preventive safety measures reduce the risk of starting the power tool accidentally.
- **Store idle power tools out of the reach of children, and do not allow persons unfamiliar with the power tool or these instructions to operate the power tool.** Power tools are dangerous in the hands of untrained users.
- **Maintain power tools. Check for misalignment or binding of moving parts, breakage of parts and any other condition that may affect the power tools operation. If damaged, have the power tool repaired before use.** Many accidents are caused by poorly maintained power tools.
- **Keep cutting tools sharp and clean.** Properly maintained cutting tools with sharp cutting edges are less likely to bind and are easier to control.
- **Use the power tool, accessories and tool bits, etc. in accordance with these**

instructions, taking into account the working conditions and the work to be performed. Use of the power tool for operations different from those intended, could result in a hazardous situation.

- **Keep handles and grasping surfaces dry, clean and free from oil and grease.** Slippery handles and grasping surfaces do not allow for safe handling and control of the tool in unexpected situations.

Battery tool use and care

- **Recharge only with the charger specified by the manufacturer.** A charger that is suitable for one type of battery pack may create a risk of fire when used with another battery pack.
- **Use power tools only with specifically designated battery packs.** Use of any other battery packs may create a risk of injury and fire.
- **When a battery pack is not in use, keep it away from other metallic objects, like paperclips, coins, keys, nails, screws or other small metallic objects, that can make a connection from one terminal to another.** Shorting the battery terminals together may cause burns or a fire.
- **Under abusive conditions, liquid may be ejected from the battery; avoid contact. If contact accidentally occurs, flush with water. If liquid contacts eyes, immediately seek medical advice.** Liquid ejected from the battery may cause irritation or burns.
- Do not use a battery pack or tool that

is damaged or modified. Damaged or modified batteries may exhibit unpredictable behaviour resulting in fire, explosion or risk of injury.

- **Do not expose a battery pack or tool to fire or excessive temperature.** Exposure to fire or temperature above 130°C may cause explosion.
- **Follow all charging instructions and do not charge the battery pack or tool outside the temperature range specified in the instructions.** Charging improperly or at temperatures outside the specified range may damage the battery and increase the risk of fire.

Service

Have your power tool serviced by a qualified technician using only identical replacement parts. This will ensure that the safety of the power tool is maintained.

Never service damaged battery packs. Service of battery packs should only be performed by the manufacturer or authorised service providers

Additional Safety Instructions for Batteries and Chargers

Safety warnings for the battery pack



WARNING! Read all safety warnings and all instructions. Failure to follow the warnings and instructions may result in electric shocks, fire and/or serious injury.

Save all warnings and instructions for future reference.

- Do not dismantle, open or shred cells or battery pack.
- Do not expose battery packs to heat or fire. Avoid storage in direct sunlight.
- Do not subject battery packs to mechanical shock.
- In the event of the battery leaking, do not allow the liquid to come into contact with the skin or eyes. If contact has been made, wash the affected area with copious amounts of water and seek medical advice.
- Seek medical advice immediately if a cell or battery pack has been swallowed.
- Keep the battery pack clean and dry.
- Wipe the battery pack terminals with a clean dry cloth if they become dirty.
- Battery packs need to be charged before use. Always refer to this instruction manual and use the correct charging procedure.
- Whilst the battery pack is being charged, refrain from any maintenance.
- After extended periods of storage, it may be necessary to charge and discharge

the battery pack several times to obtain maximum performance.

- The battery pack gives its best performance when it is operated at normal room temperature ($20^{\circ}\text{C} \pm 5^{\circ}\text{C}$).
- When disposing of battery packs, keep battery packs of different electrochemical systems separate from each other.
- Recharge only with the charger specified by the manufacturer. Do not use any charger other than that specifically provided for use with the equipment. A charger that is suitable for one type of battery pack may create a risk of fire when used with another battery pack.
- Do not use any battery pack which is not designed for use with the equipment.
- Keep the battery pack out of the reach of children.
- Retain the original product literature for future reference.
- Remove the battery from the equipment when not in use.
- Dispose of the battery properly.

Safety warnings for the battery charger



WARNING! Read all safety warnings and all instructions. Failure to follow the warnings and instructions may result in an electric shock, fire and/or serious injury.

Save all warnings and instructions for future reference.

- This power tool is not intended for use by persons (including children) with reduced physical, sensory or mental capabilities, or lack of experience and knowledge, unless they have been given supervision or instruction concerning use of the power tool by a person responsible for their safety.
- Children should be supervised to ensure that they do not play with the power tool.
- Before charging, read the instructions.
- After charging, disconnect the battery and charger from the mains supply. Then remove the chassis connection followed by the battery connection.
- Do not charge a leaking battery.
- Do not use chargers for purposes in which they are not designed for.
- Before charging, ensure your charger is matching the local AC supply.
- Charge the battery indoors and use only in dry conditions.
- The charging device must be protected from moisture.
- Do not use the charging device in the open.
- Shorting the battery terminals together may cause burns or a fire.
- Respect the polarity “+/-“ when charging.
- Do not open the unit and keep out of the reach of children.
- Do not charge the batteries of other manufacturers or ill-suited models.
- Ensure that the connection between the battery charger and battery is correctly

positioned and is not obstructed by foreign bodies.

- Ensure the slot for the batter charger is clear and unobstructed. Store in a dry and frost-free place to protect against dirt and humidity.
- When charging batteries, ensure that the battery charger is in a well-ventilated area and away from flammable materials. Batteries can heat up quickly whilst charging. Ensure that batteries and chargers are not left unsupervised during charging.
- Do not recharge non-rechargeable batteries, as they can overheat and break.
- Longer life and better performance can be obtained if the battery pack is charged when the air temperature is between 18°C and 24°C. Do not charge the battery pack in air temperatures below 0°C, or above 45°C. This is important as it can prevent serious damage to the battery pack.

Additional Safety Instructions for Pole Saw

the saw is operating. Before you start the pole saw, make sure the saw chain is not touching anything. A moment of inattention while operating pole saws may cause entanglement of your clothing or body with the chainsaw.

- Carry the pole saw by the front handle with

the saw chain stopped and the guide bar pointing to the rear. When transporting or storing the chainsaw always fit the guide bar cover. Proper handling of the chain saw will reduce the likelihood of accidental contact with the moving saw chain.

- Wear safety glasses and hearing protection. Further protective equipment for head, hands, legs and feet is recommended. Adequate protective clothing will reduce personal injury by flying debris or accidental contact with the saw chain.
- Do not operate a chainsaw in a tree unless specifically trained to do so. Improper operation of a chainsaw in a tree, may result in personal injury.
- Always keep proper footing and operate the pole saw only when standing on a fixed, secure and level surface. Slippery or unstable surfaces such as ladders may cause a loss of balance or control of the pole saw.
- When cutting a limb that is under tension be alert for spring back. When the tension in the wood fibres is released the spring loaded limb may strike the operator and/or throw the pole saw out of control.
- Use extreme caution when cutting bush and saplings. The slender material may catch the saw chain and be whipped toward you or pull you off balance.
- Carry the pole saw by the front handle with the pole saw switched off and away from your body. When transporting or storing the chainsaw, always fit the guide bar cover. Proper handling of the chainsaw will reduce the likelihood of accidental contact with the moving saw chain. Follow instructions for lubricating, chain tensioning and

- changing accessories.
- Improperly tensioned or lubricated chain may either break or increase the chance for kickback.
 - Keep handles dry, clean and free from oil and grease. Greasy, oily handles are slippery causing loss of control.
 - Cut wood only. Do not use pole saw for purposes it's not intended for. For example: Do not use pole saw for cutting plastic, masonry or non-wood building materials. Use of the pole saw for operations different than intended could result in a hazardous situation.
 - This pole saw is not intended for tree felling. Use of the pole saw for operations different than intended, could result in serious injury to the operator or bystanders.
 - Hold the pole saw by insulated gripping surfaces only, because the saw chain may contact hidden wiring or its own cord. Saw chains contacting a 'live' wire may make exposed metal parts of the chainsaw 'live' and could give the operator an electric shock.
 - Keep the pole saw a sufficient distance away from overhead electrical power lines.
 - Be aware of the dangers of operating positions, as well as the risk of being struck by falling branches or branches that hit the ground and rebound. Remove the branches in sections.
 - Keep bystanders at a safe distance from the power tool during its operation.
 - Keep firm footing and balance during operation, including the need to use the harness provided.
 - Use PPE when operating, including hearing protection, eye protection (visor or glasses)

and head protection and clothing.

Prevention of kickback

- Kickback may occur when the nose or tip of the guide bar touches an object, or when the wood closes in and pinches the saw chain in the cut.
- Tip contact in some cases may cause a sudden reverse reaction, kicking the guide bar up and back towards the operator.
- Pinching the saw chain along the top of the guide bar may push the guide bar rapidly back towards the operator.
- Either of these reactions may cause you to lose control of the pole saw which could result in serious personal injury. Do not rely exclusively upon the safety devices built into your saw. As a pole saw user, you should take several steps to keep your cutting jobs free from accident or injury.

Kickback is the result of tool misuse and/or incorrect operating procedures or conditions and can be avoided by taking proper precautions as given below:

- Maintain a firm grip, with thumbs and fingers encircling the pole saw handles, with both hands on the saw and position your body and arm to allow you to resist.
- Kickback forces can be controlled by the operator, if proper precautions are taken. Do not let go of the pole saw.
- Do not overreach and do not cut above shoulder height. This helps prevent unintended tip contact and enables better control of the pole saw in

unexpected situations.

- Only use replacement bars and chains specified by the manufacturer. Incorrect replacement bars and chains may cause chain breakage and/or kickback.
- Follow the manufacturer's sharpening and maintenance instructions for the saw chain. Decreasing the depth gauge height can lead to increased kickback.

Precautions for pole saw

- Never stand directly under the limb you are cutting. Always position yourself out of the path of falling debris.
- Never stand on a ladder or other types of unstable support while using the pole saw.
- Always use both hands to operate the pole saw. Keep a firm, steady pressure on the pole saw while cutting, but do not try to force the saw through the wood.
- Do not use the pole saw to cut limbs larger in diameter than the length of the guide bar.
- Keep other people away from the cutting end of the pole saw and at a safe distance from the work area.
- Do not use the pole saw near cable, electric the power or telephone lines. Maintain a minimum clearance of 10 feet from all power lines.



WARNING!

Even when the tool is used as prescribed it is not possible to eliminate all residual risk factors. The following hazards may arise in connection with the tool's

construction and design.

- Damage to lungs if an effective dust mask is not worn.
- Damage to hearing if effective hearing protection is not worn.
- Health defects resulting from vibration emission, if the appliance is being used over longer periods of time or not adequately managed and properly maintained.



WARNING!

This power tool produces an electromagnetic field during operation. This field may under some circumstances interfere with active or passive medical implants.

To reduce the risk of serious or fatal injury, we recommend persons with medical implants to consult their physician and the medical implant manufacturer, before operating this power tool.

Intended Use

This Li-ion cordless pole saw is intended for cutting wood. Observe the technical data for the maximum cutting capacity. Do not cut non-plant material or wood exceeding the stated maximum capacity. For safety reasons, it is essential to read this entire instruction manual before first operation and to observe all the instructions herein. This product is intended for private domestic use only, not for any commercial trade use. It must not be used for any purposes other than those described in this manual.

Warning Symbols on the Power Tool



Warning!



The product complies with the applicable European directives and an evaluation method of conformity for these directives was done.



The product complies with the applicable UK directives and an evaluation method of conformity for these directives was done.



To reduce the risk of injury, the user must read the instruction manual.



Wear ear protection.



Wear safety glasses.



Wear safety helmet.



Wear suitable foot protection.



Wear suitable hand protection.



Keep bystanders away.



Do not operate or expose the product to rain or wet conditions.



Keep sufficient distance away from electrical power lines



Guaranteed sound power level data is 99dB.



Remove the battery pack before any adjustment or maintenance.

Warning symbols on the charger



Before use, carefully read through the user manual.



The charger is for indoor use only.



Class II equipment.



WEEE symbol. Waste electrical products should not be disposed of with household waste. Please recycle where facilities exist. Check with your local authority or local store for recycling guidelines.



Fuse 3.15A.

Warning symbols on the battery



Do not dispose of batteries in rivers or immerse them in water.



Do not subject the battery to strong sunlight over long periods, and do not leave it on a heater (max. 45°C).



Do not throw on fire.



Contains a Li-ion battery. Do not dispose of waste batteries in domestic waste. Contact your local authority to find out how to dispose of batteries.

In the Box

Parts

1. Working head
2. Oil bottle cap
3. Bar sheath
4. Guide bar
5. Saw chain
6. Battery pack
7. Charger
8. Main switch
9. Safety lock-off button
10. Quick click for telescopic pole
11. Shoulder strap
12. Front handle
13. Telescopic pole handle
14. Working head attachment lock
15. Chain cover fastening wheel
16. Chain tension wheel
17. Cutting angle adjustment button

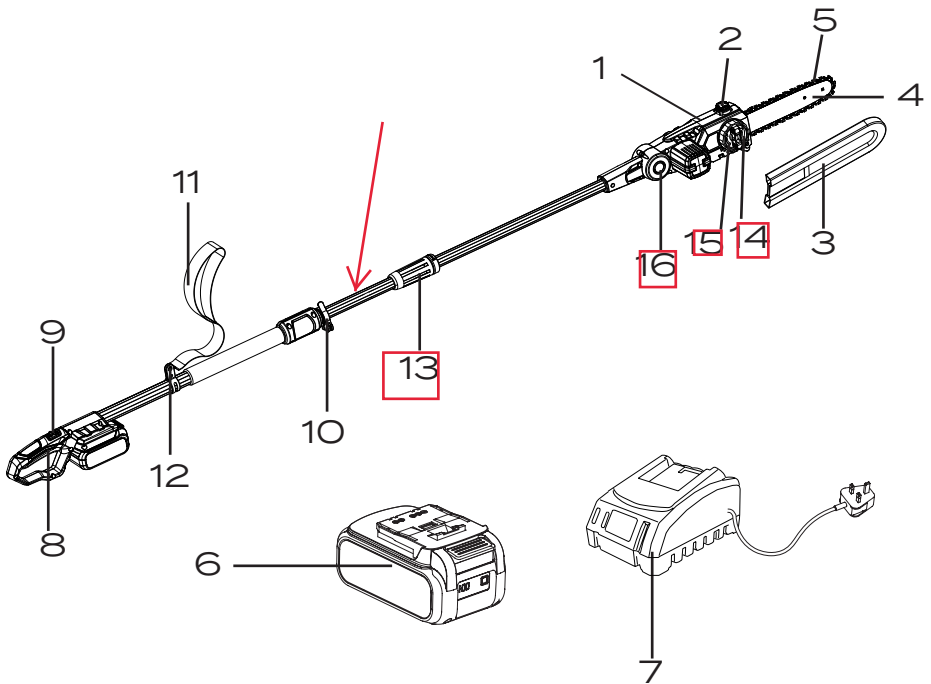

Assembly



WARNING: Ensure the battery pack is disconnected from the pole saw before carrying out assembly.

Charging the battery



WARNING!

The charger and battery pack are specifically designed to work together, do not attempt to use any other devices. Never insert or allow metallic objects into your charger or battery pack connections; an electrical failure and hazard will occur.

The battery needs to be charged before first use and whenever it fails to produce sufficient power on jobs that were easily done before.



WARNING! NEVER LEAVE THE BATTERY AND CHARGER UNATTENDED WHEN CHARGING THE BATTERY.

This product comes with a Lithium-ion battery pack. Lithium-ion batteries don't lose charge when they are not in use, and don't lose charging capacity over time. Nevertheless, it is best practice to only charge the battery when empty or if there is insufficient charge to do the job.

Charging procedure



WARNING! The battery cannot be charged immediately after use, it should be allowed to cool down for 30 minutes. The LED light (8) switching from green to red means it is being charged.

1. Connect the charger (7) to a power supply. The left red light (8) will illuminate.
2. Slide the battery pack into the charger, make sure the battery pack (6) is fully seated in position. The left red light is on and the right green light (9) is flashing to indicate the charging is on going.
3. When charging is complete, the left light is off and the right green light is on.

4. Once the battery is fully charged, disconnect the charger from the mains and remove the battery pack from the charger.

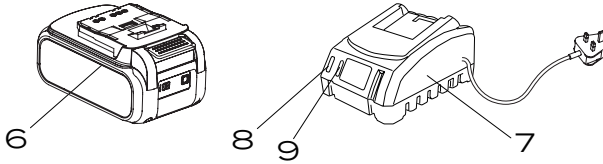

Important charging notes

1. Never allow the battery to completely discharge before recharging. The battery pack should be placed on the charger whenever the battery pack is noticeably running down or the tool no longer performs a task it previously performed.
2. Avoid conducting short charges. Make sure that the battery is fully charged each time by allowing the charger to complete its full charging cycle.
3. Avoid allowing loose items like screws or nails, etc. to be stored with battery packs, as these or similar items can short battery packs and cause a fire or explosion.
4. Always unplug the charger when not in use and store in a dry and secure place.
5. Avoid charging or storing your battery in temperatures below 0°C and above 40°C.
6. After use, allow the battery pack to cool down for approximately 30 minutes before attempting to recharge.

If the battery pack does not charge properly:

- Check the main socket by plugging in a lamp or other appliance.
 - Move the charger and battery pack to a location where the surrounding air temperature is approximately 18–24°C.
 - If charging problems persist, take the tool, battery pack and charger to your local store.
7. The battery pack should be recharged when it fails to produce sufficient power on jobs which were easily done before. **DO NOT CONTINUE** to use under these conditions. Follow the charging procedure. You may also charge a partially used pack whenever you desire with no adverse effect on the battery pack.
 8. Under certain conditions with the charger plugged into the power supply, the exposed charging contacts inside the charger can be shorted by foreign materials. Foreign materials

of a conductive nature, such as, but not limited to, steel wool, aluminium foil, or any build-up of metallic particles, should be kept away from charger cavities. Always unplug the charger from the power supply when there is no battery pack in the cavity. Unplug the charger before attempting to clean.

9. Do not immerse the charger in water or any other liquid.



WARNING!

Never attempt to open the battery pack for any reason. If the plastic housing of the battery pack breaks or cracks, dispose of the battery pack in accordance with local regulations; do not put it into further use.

Install the battery pack



WARNING! Always release the On/Off switch before inserting or removing the battery pack.

Remove the battery pack: Press the button (A) on the end of the battery pack, then remove the pack from the saw.

Install the battery pack: Align the ribs on both sides of the battery pack with the slots in the housing, and slip it into place. Always insert it all the way until it locks in place with a click sound. If it's not correctly inserted, it may accidentally fall out of the saw, causing injury to you or bystanders.

To release the battery from the saw, push the button (A) on the end of the battery pack and pull away from the saw.

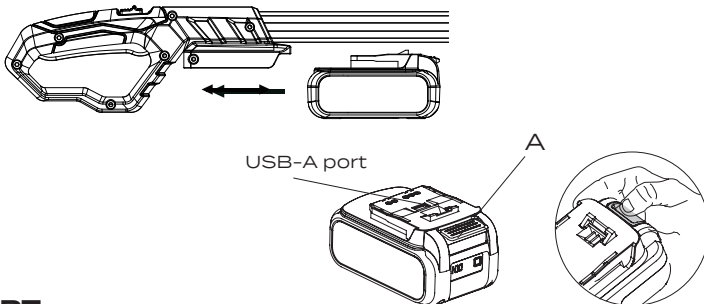

USB-A PORT

The USB-A port is on the top cover of the battery pack. Connect your electric device to the USB-A port on the battery pack using the USB-A cable. Push the button to start charging.

Assembling the pole saw

Before using the pole saw, a one-time assembly is required. When removed from the box, the two parts are disconnected, as shown in photo below.

Attach the working head to the telescopic pole handle. When inserted, the working head will need to line up with the telescopic pole handle, and must be inserted fully. Turn the lock nut clockwise to lock, ensuring it is fully locked.

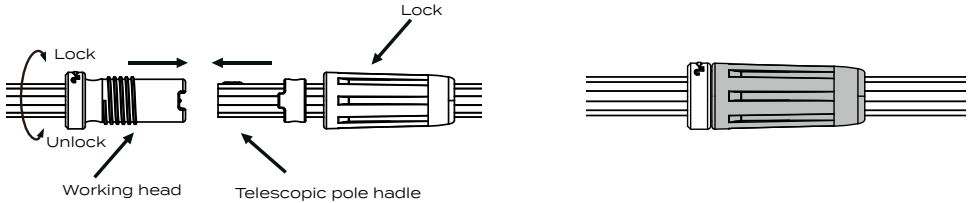

When detaching, push the locker button, turn the locker anticlockwise to unlock, then pull the handle out.

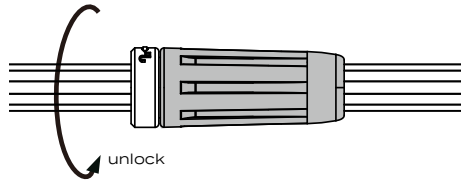

Assembling the shoulder strap

Attach the shoulder strap cross the hook on telescopic pole handle.

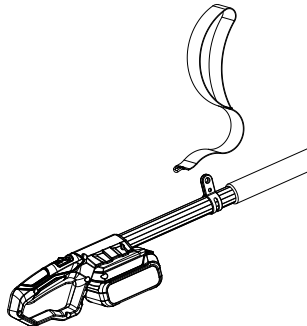

Fill lubrication oil

Fill the oil tank with 100ml of specialist chain oil (not supplied, available to purchase separately) and keep oil topped up during use.

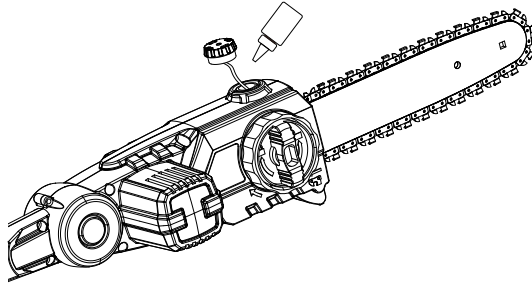

Precautions for safe handling of pole saw chain oil



WARNING! Do not eat, drink or smoke during use. Only use in a well-ventilated area to prevent buildup of excessive levels of vapour. Wear appropriate Personal Protective Equipment (PPE), including protective gloves, eye protection and suitable protective clothing including footwear.

Wash hands and other exposed areas with mild soap and water after each use and particularly before eating, drinking or smoking.

Operating the Pole Saw

Telescopic handle

Adjust the length of the pole saw according to the working situation. Pull the lever of the quick clip to release the pole.

Loosen the locking clip to unlock position, then pull the pole out to the desired pole length.

Turn locking clip to the lock position.

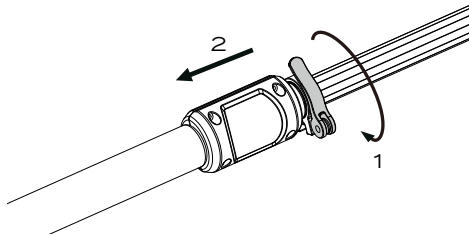

Function of the swivel head

Note: The working head can be locked in three positions (0° , 15° , 30°).

Hold the pole handle tightly. Push the lock button and then turn the working head to the desired position. Release the lock button and check whether the cutter head is locked in place.

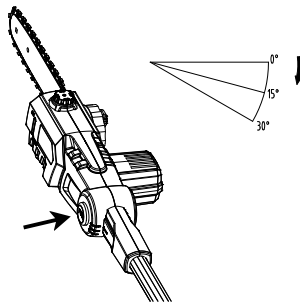

NOTE: Failure to properly secure the pole saw head may result in personal injury and/or property damage.



WARNING: Always make sure that the working head is locked in the desired position before operation. Do not rotate the working head when the saw is being operated.

Switch ON/OFF

Switching on

Push forward the safety lock-off button and then press the main switch on the handle.

Release the safety lock-off button.

Switching off

Release the main switch on the handle.

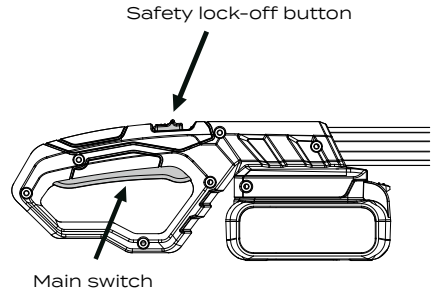

Check the oil supply

Important: The pole saw is not filled with oil. It is essential to fill with oil before use. Never operate the pole saw without chain oil or at an empty oil tank level, as this will result in extensive damage to the product.

NOTE: Chain life and cutting capacity depend on optimum lubrication. Therefore, the chain is automatically oiled during operation.

Check the proper functioning of the automatic oiler by running the chainsaw, pointing the tip of the guide bar towards a piece of cardboard or paper on the ground. If an increasing oil pattern develops on the cardboard, the automatic oiler is operating fine. If there is no oil pattern, despite a full oil reservoir, contact customer service.



WARNING: Do not touch the ground with the chain. Ensure enough safety clearance.

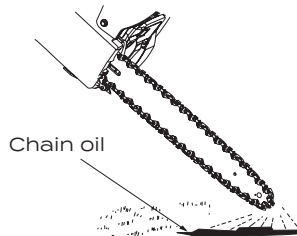

Chain Tension



WARNING! Remove the battery pack before making adjustments or carrying out maintenance. Always use gloves when handling the chain.

NOTE! The chain and bar were pre-assembled onto this pole saw before packing. Thus, the user will not have to assemble them when unpacking this tool. However, please check the chain tension before each use.

1. Loosen the cover fixing wheel before adjusting chain.
2. Turn the chain tension adjusting wheel clockwise, until the slack is out of the chain.
3. Wearing protective gloves, pull down on chain to check chain tension.
4. Do not over-tension chain. Over-tensioning will cause excessive wear and will reduce the life of the guide bar and chain. Over-tensioning also reduces the number of cuts per battery charge.
5. When chain tension is correct, tighten the cover fixing wheel firmly.

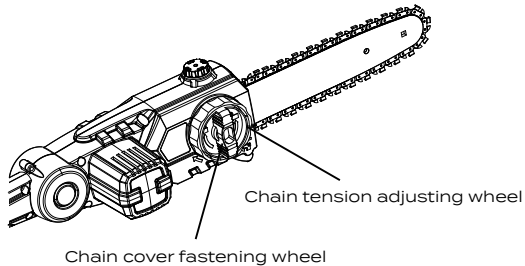

Important! It is very important to check the chain tension is loose. Check if the chain is loose every 10 minutes.



NOTE! When tensioned correctly, it should be possible to pull one full chain link free of the bar channel with ease.

- A new chain will expand its length during the first period of use. Check and re-adjust the tension frequently as a loose chain can easily derail or cause rapid wear of itself and the chain bar.

Pruning



Warning! Always turn off the motor before laying down the power tool.

Risk of recoil.

Recoil is caused by wood or other firm objects coming into contact with the top side or the tip of the saw rail. This may cause the power tool to be thrown back with force at the operator, which may cause serious injuries.



Warning! Danger of injury!

Dangerous recoil may occur during operation of the power tool! This may cause serious injuries or death!

Make absolutely sure that no wood or other firm objects can come into contact with the area shown in the diagram below. Only if you work carefully and properly can you reliably reduce the risk of recoil!

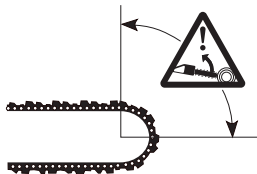

Pull sawing

This technique involves sawing with the bottom side of the saw rail from top to bottom. The sawing chain pushes the power tool forward, away from the operator. The front edge of the power tool forms a support rest absorbing the forces caused by sawing into a tree trunk.

Pull sawing allows the operator to exercise much more control over the power tool and to prevent it from recoiling. This is why you should make pull sawing the sawing technique of choice.

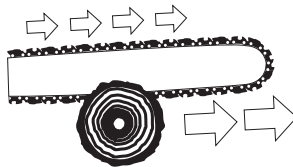

Push sawing

This technique involves sawing with the top side of the saw rail from bottom to top. The sawing chain pushes the power tool backward toward the operator. If the saw rail becomes jammed, the power tool may be thrown back toward the operator with great force.

If the operator is unable to counterbalance the backward pushing force of the sawing chain using their own body weight, only the tip of the sawing chain may be in contact with the wood, which may cause a recoil.



Tree cutting

NOTE: Always work on the opposite side of the branch you want to cut down. Always start at the bottom of the trunk and work your way up.

When removing larger branches, first cut the branch from below (1). Then cut through from above (2), and finally cut off the remaining branch (3).

Danger of injury. Branches that rest against a surface or are under tension may cause the sawing chain to become jammed in the wood!



Maintenance and Storage

Maintenance

This product does not contain any parts that can be repaired by the consumer. Contact an authorised service centre or a similarly qualified person to have it checked and repaired.



WARNING! Always switch the product off, disconnect it from the battery pack and let the product cool down before performing inspection, maintenance and cleaning work!

General cleaning

1. Switch the product off, disconnect it from the battery pack and let it cool down.
2. Check, clean and store the product as described below.
3. Clean the product with a damp cloth and pH-neutral soap. Use a brush for areas that are hard to reach.
4. In particular clean the air vents after every use with a cloth and brush.
5. Remove stubborn dirt with high pressure air (max. 3 bar).

NOTE: Do not use chemical, alkaline, abrasive or other aggressive detergents or disinfectants to clean this product as they might be harmful to its surfaces.

Change the chain and bar

1. Loosen tension wheel (A). Remove chain cover with adjusting wheel together.
2. Fit the chain around the bar ensuring that the direction of the chain is as depicted in the picture on the bar. Fit the chain on the sprocket.

Note: Make sure cutting edges of the chain are facing in the right direction. Make sure the tension guide plate (B) is facing outside.

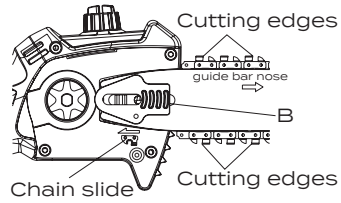
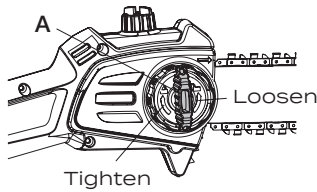

Change the chain and bar

1. Loosen tension wheel (C). Remove chain cover with adjusting wheel together.

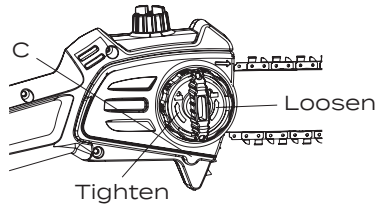

Saw chain tension adjustment

1. Loosen tension wheel (17) before adjusting chain.
2. Turn the adjusting wheel (18) until slack is out of the chain.
3. Wearing protective gloves, pull down on the chain to check the chain tension
4. Do not over-tension the chain. Over-tensioning will cause excessive wear and will reduce the life of the guide bar and chain. Over-tensioning also reduces the amount of cuts per battery charge.

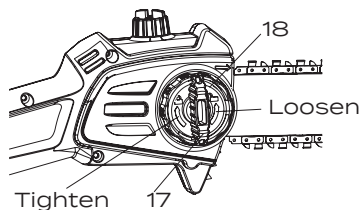

5. When chain tension is correct, tighten tension wheel (17) firmly.



NOTE! When tensioned correctly, it should be possible to pull one full chain link free of the bar channel with ease.

- A new chain will expand its length during the first period of use. Check and re-adjust the tension frequently, as a loose chain can easily derail or cause rapid wear of itself and the chain bar.



CAUTION! If the saw chain is TOO LOOSE or TOO TIGHT the V-drive wheel, chain bar, chain and crank shaft bearing will suffer premature wear. Below Fig. shows the correct tension A (when cold) and tension B (when warm). Fig. C shows a chain that is too loose.

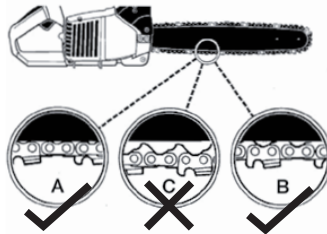

Care of guide bar

Uneven bar wear causes most guide bar problems. Incorrect sharpening of the chain cutter and depth gauge settings often cause this. When bar wears unevenly, it widens the guide bar groove. This causes chain clatter and rivet popping. Saw will not cut straight. Replace guide bar if this occurs.

Inspect guide bar before sharpening the chain. A worn or damaged guide bar is unsafe. A worn or damaged guide bar will damage the chain. It will also make cutting harder.

Normal guide bar maintenance

1. Reverse the bar occasionally to prevent partial wear.
2. The bar rail should always have parallel internal faces (see diagram). Check for wear of the bar rail. Apply a ruler to the bar

and the outside of the cutter. If a gap is observed between them, the rail is normal. Otherwise, the bar rail is worn. Such a bar needs to be corrected or replaced.

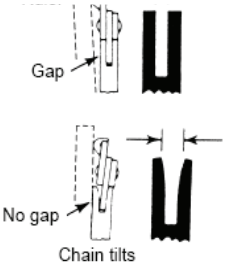

Sharpening saw chain

Keep the chain sharp. Your saw will cut faster and more safety.

A dull chain will cause undue sprocket, guide bar, chain and motor wear. If you must force chain into wood and cutting creates only sawdust with few large chips, chain is dull.

Sharpening cutters

Use the file guide for 30° filing.

1. Make sure the saw is held securely.
2. Make sure the battery is taken off.
3. Adjust chain for proper tension.
4. Clamp guide bar in vice to hold saw steady. (Note: Do not clamp the chain).
5. Press a 5/32" round file (attached to file guide) into the groove between the top plate and the depth gauge on the chain. The file guide should rest on both the top plate and the depth gauge. (Note: File at midpoint of the guide bar).

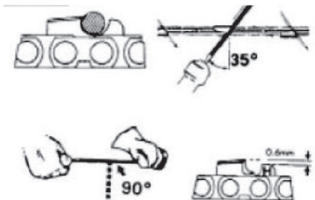



NOTE: Illustration above shows file guide placement and filing direction for sharpening cutters on left side of the chain.

6. Hold the file guide level. Make sure 30° mark on file guide is parallel to centre of guide bar. This will ensure that you file cutters at a 30° angle.
7. File from the inside towards the outside of the cutter until sharp. Only file in this one direction.
(Note: Two or three strokes with file should sharpen cutter).

Filing cutter depth gauges

The cutter depth gauge clearance is reduced as cutters are sharpened. After every second or third sharpening, reset cutter depth gauges.

1. Place the depth gauge tool (.025") firmly across the top of two cutters. Make sure the depth gauge enters the slot in the depth gauge tool.
2. Use a medium flat file. File the depth gauge level with depth gauge tool.
3. Remove depth gauge tool. With a flat file, round off the front corner of the cutter depth gauge.

After several hand filings, have an authorised service centre or sharpening service machine, sharpen the chain. This will ensure even filing.

Cleaning the bar and chain



WARNING! Wear safety gloves when cleaning the bar and chain! Use appropriate tools to remove debris, e.g. a brush or wooden stick! Never use your bare hands!

Always use original spare parts for replacement.

1. Keep the bar and chain clean and free of debris. Remove debris.
2. Apply a small amount of suitable lubricant, like gear grease, on the cutting device to retain a good cutting performance.

Storage

1. Make sure that the product has been thoroughly cleaned before storing it in a clean dry place, out of the reach of children.
2. Remove and clean guide bar and chain. Clean guide bar and chain by soaking in a petroleum based solvent or mild soap and water mixture. Place chain in a container filled with oil. This will prevent rust.



Troubleshooting



Although your new cordless pole saw is really easy to operate, if you do experience problems, please check the following:

Problem	Possible cause	Solution
Product not running	1. Battery discharged	1. Charge rechargeable battery
	2. Battery pack does not sit in place correctly	2. Install the battery pack once again
	3. Device defective	3. Contact service centre
Chain not cutting properly	1. Incorrectly mounted saw chain	1. Charge the battery pack
	2. Saw chain blunt	2. Clean the air vents
	3. Chain tension insufficient	3. Check chain tension
Bar and chain running hot and smoking	1. Too little oil	1. Check bar lube reservoir, where appropriate, refill with oil
	2. Tension over tightened	2. Tension chain. Refer to Chain Tension in this manual

Technical Data

Model No.	ET1612HB
Voltage	20V d.c.
Chain speed	5.5m/s
Bar length	20cm(8")
Bar/chain code	O80SDEAO41(547980) 91PO33X
Chain Pitch	0.952cm
Chain Gauge	1.5mm
Number of Chain Drive Link	33
Net weight	3.8kg
Oil tank capacity	100ml
Vibrations	Rear handle: 4.92m/s ² , K=1.5m/s ² Front handle: 2.57m/s ² , K=1.5m/s ²

Charger	
Model no.	BOQ-SPO6-20ZB
Input voltage & power	220-240V~ 50/60Hz 65W
Output voltage & current	20V  2.4A
Protection class	 /II

Battery pack	
Model no.	BOP-SPO6-20-ZU
Battery voltage	20V  , Li-ion
Battery capacity	5.0Ah
USB-A	5V  2A

Technical Data

Noise emission value:

Noise measurement value determined in accordance with EN 62841.

The A-rated noise level of the power tool is typically as follows:

Sound power level L_{WA} : 94.16dB(A)

Uncertainty $k= 2.54$ dB(A)

Guaranteed sound power level L_{WA} : 99dB(A)

The vibration level varies in accordance with the use of the power tool and may, in some cases, be higher than the value specified in these instructions. There is a risk of underestimation of the vibration load if the power tool is used regularly in this manner. Try to keep the vibration loads as low as possible. Measures to reduce the vibration load are, e.g. wearing gloves and limiting the working time. (e.g. times when the power tool is switched off and times where the power tool is switched on but running without load).



NOTE:

The vibration level specified in these instructions has been measured in accordance with a standardised measuring procedure specified in EN 62841 and can be used to make equipment comparisons. The specified vibration emission value can also be used to make an initial exposure estimate.



WARNING! This equipment may cause Hand-Arm Vibration Syndrome (HAVS) if its use is not adequately monitored and managed.

Preventative measures include, among others, regular maintenance and care of the product and cutting attachments, keeping hands warm and periodical breaks, as well as proper planning of work processes.

Disposal

The pole saw and its accessories are made of various recyclable materials. Dispose of the pole saw in accordance with your local recycling regulations.

Getting help

Our dedicated UK-based customer helpline is open 7 days a week to assist you with assembly, parts queries and technical support. We are open during office hours but you can always send an email via **support@coreservice.co.uk**. Our experts are here to get you back enjoying your garden in no time.

For useful assembly, starting and maintenance videos, and for ordering spares, please visit **www.coreservice.co.uk**.

Using our service does not affect your statutory rights.

Warranty

This product is covered by a 3 year warranty.

The warranty covers any manufacturing defect in materials, workmanship and finish.

Any claim under this warranty must be made by going to your nearest Homebase store, taking your proof of purchase with you, and claims must be made within 3 years of the date of purchase.

We will offer you a free repair of the item where this is possible, or a replacement or a refund. Your statutory rights remain unaffected, in particular, any rights you may have under the Consumer Rights Act 2015.

This warranty is given by HHGL Limited, MK9 1BA; HHGL (ROI) Limited, DO2 X576.

Please note: This warranty does not apply to products misused or neglected and only covers domestic use. The warranty period for the battery pack and charger is 1 year.