

# SOVEREIGN

## 200W FINISHING SANDER

Item No. 594447

Model No. AJ65A



Technical Support & Parts  
**01904 727509**  
Mon-Fri 9am-5pm Sat-Sun 11am-4pm  
[www.coreservice.co.uk](http://www.coreservice.co.uk)

## ORIGINAL INSTRUCTION MANUAL

Please read these instructions fully before starting assembly.

HHGL Limited, MK9 1BA; HHGL (ROI) Limited, D02 X576

Mar 21

# CONTENTS

CONTENTS	2
GENERAL SAFETY WARNINGS	3
WARNING SYMBOLS	9
IN THE BOX	10
OPERATION	11
MAINTENANCE AND STORAGE	18
TECHNICAL DATA	19
RECYCLING AND DISPOSAL	21
UK PLUG	21
GETTING HELP	22
WARRANTY	23

# GENERAL SAFETY WARNINGS



**WARNING! Read all safety warnings, instructions, illustrations and specifications provided with this power tool.** Failure to follow all instructions listed below may result in electric shock, fire and/or serious injury.

**Save all warnings and instructions for future reference.** The term 'power tool' in the warnings refers to your mains-operated (corded) power tool or battery-operated (cordless) power tool.

## 1) Work area safety

- a) **Keep work area clean and well lit.** Cluttered or dark areas invite accidents.
- b) **Do not operate power tools in explosive atmospheres, such as in the presence of flammable liquids, gases or dust.** Power tools create sparks which may ignite the dust or fumes.
- c) **Keep children and bystanders away while operating a power tool.** Distractions can cause you to lose control.

## 2) Electrical safety

- a) **Power tool plugs must match the outlet. Never modify the plug in any way.** Do not use any adaptor plugs with earthed (grounded) power tools. Unmodified plugs and matching outlets will reduce risk of electric shock.
- b) **Avoid body contact with earthed or grounded**

**surfaces, such as pipes, radiators, ranges and refrigerators.** There is an increased risk of electric shock if your body is earthed or grounded.

- c) Do not expose power tools to rain or wet conditions.** Water entering a power tool will increase the risk of electric shock.
- d) Do not abuse the cord. Never use the cord for carrying, pulling or unplugging the power tool.** Keep the cord away from heat, oil, sharp edges or moving parts. Damaged or entangled cords increase the risk of electric shock.
- e) When operating a power tool outdoors, use an extension cord suitable for outdoor use.** Use of a cord suitable for outdoor use reduces the risk of electric shock.
- f) If operating a power tool in a damp location is unavoidable, use a residual current device (RCD) protected supply.** Use of an RCD reduces the risk of electric shock.

### **3) Personal safety**

- a) Stay alert, watch what you are doing and use common sense when operating a power tool.** Do not use a power tool while you are tired or under the influence of drugs, alcohol or medication. A moment of inattention while operating power tools may result in serious personal injury.
- b) Use personal protective equipment (PPE). Always wear eye protection.** Protective

equipment such as a dust mask, non-skid safety shoes, hard hat, or hearing protection used for appropriate conditions will reduce personal injuries.

- c) **Prevent unintentional starting. Ensure the switch is in the 'off' position before connecting to a power source and/or battery pack, picking up or carrying the tool.** Carrying power tools with your finger on the switch or energising power tools that have the switch on invites accidents.
- d) **Remove any adjusting key or wrench before turning the power tool on.** A wrench or a key left attached to a rotating part of the power tool may result in personal injury.
- e) **Do not overreach. Keep proper footing and balance at all times.** This enables better control of the power tool in unexpected situations.
- f) **Dress properly. Do not wear loose clothing or jewellery.** Keep your hair, clothing and gloves away from moving parts. Loose clothes, jewellery or long hair can be caught in moving parts.
- g) **If devices are provided for the connection of dust extraction and collection facilities, ensure these are connected and properly used.** Use of these devices can reduce dust-related hazards.
- h) **Do not let familiarity gained from frequent use of tools allow you to become complacent and ignore tool safety principles.** A careless action can cause severe injury within a fraction of a second.

#### 4) Power tool use and care

- a) **Do not force the power tool. Use the correct power tool for your application.** The correct power tool will do the job better and safer at the rate for which it was designed.
- b) **Do not use the power tool if the switch does not turn it on and off.** Any power tool that cannot be controlled with the switch is dangerous and must be repaired.
- c) **Disconnect the plug from the power source and/or the battery pack from the power tool before making any adjustments, changing accessories, or storing power tools.** Such preventive safety measures reduce the risk of starting the power tool accidentally.
- d) **Store idle power tools out of the reach of children, and do not allow persons unfamiliar with the power tool or these instructions to operate the power tool.** Power tools are dangerous in the hands of untrained users.
- e) **Maintain power tools. Check for misalignment or binding of moving parts, breakage of parts and any other condition that may affect the power tools operation.** If damaged, have the power tool repaired before use. Many accidents are caused by poorly maintained power tools.
- f) **Keep cutting tools sharp and clean.** Properly maintained cutting tools with sharp cutting edges are less likely to bind and are easier to control.
- g) **Use the power tool, accessories and tool bits,**

**etc., in accordance with these instructions, taking into account the working conditions and the work to be performed.** Use of the power tool for operations different from those intended could result in a hazardous situation.

- h) Keep handles and gripping surfaces dry, clean and free from oil and grease.** Slippery handles and gripping surfaces do not allow for safe handling and control of the tool in unexpected situations.

## **Service**

- a) Have your power tool serviced by a qualified repair person using only identical replacement parts.** This will ensure that the safety of the power tool is maintained.

## **ADDITIONAL SAFETY WARNINGS FOR SANDERS**

- a. Harmful/toxic dusts will arise from sanding, e.g. lead painted surfaces, woods and metals. Contact with or inhalation of these dusts can endanger the health of the operator and bystanders.** Always use eye goggles and a dust mask.
- b. Hearing protection should be worn when using the sander.**
- c. Always wear safety glasses or eye shields when using the sander. Everyday spectacles have only impact-resistant lenses; they are not**

**safety glasses.** Following this rule will reduce the risk of serious personal injury.

- d. After long working periods, external metal parts and accessories could be hot.**
- e. If possible, ensure the work-piece is firmly clamped to prevent movement.**
- f. Your sander is a hand held tool; do not clamp your sander.**
- g. Before sanding, check the area is free of nails, screws, etc.**
- h. Never stop the sander by applying a force to the base plate.**
- i. Only use sand paper in good condition. Do not use torn or worn paper.**
- j. Do not sand material containing asbestos, due to a health risk.**
- k. Do not sand lead-based paint due to the risk of lead poisoning.**
- l. Do not eat or drink in the working area of the sander.**
- m. Do not allow people to enter the working area without wearing a dust mask.**
- n. Where possible, seal off the working area to contain the dust for later removal.**
- o. Your tool is designed for dry sanding only, not wet sanding.**
- p. Do not sand magnesium material due to the risk of fire.**

# WARNING SYMBOLS



**Warning**



**Read the instructions**



**Wear ear protection**



**Wear eye protection**



**Wear a dust mask**



**Class II tool**



**The product complies with the applicable European directives, and an evaluation method of conformity for these directives was done.**



**Recycle unwanted materials instead of disposing of them as household waste. All tools, hoses and packaging should be sorted, taken to the local recycling centre and disposed of in an environmentally safe way.**



**The product complies with the applicable UK directives, and an evaluation method of conformity for these directives was followed.**

## IN THE BOX

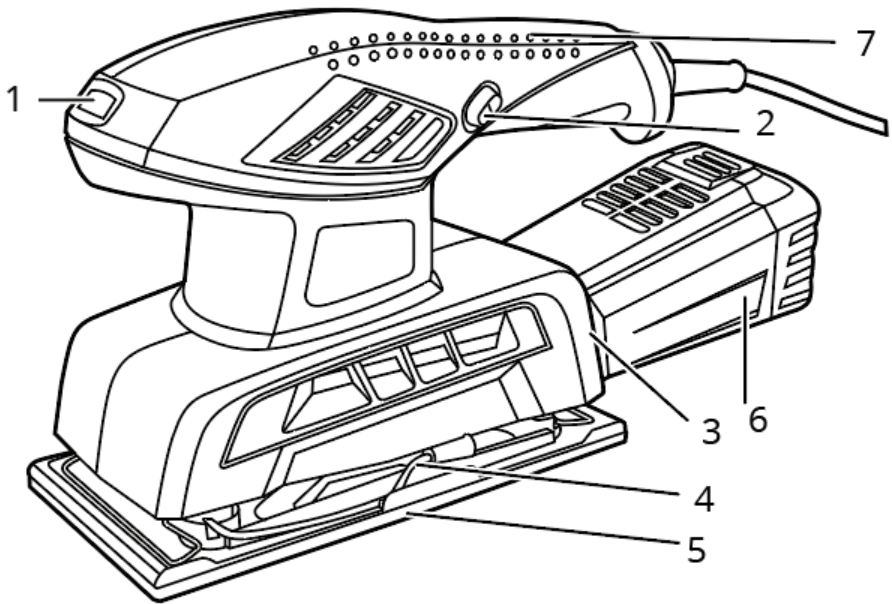

### Description

1. Speed selection
2. On/off switch
3. Dust outlet
4. Fasten clip
5. Sanding base
6. Dust collection box
7. Soft grip

### Accessories

1pc 80# sanding paper

# OPERATION



**NOTE:** Before using your sander, be sure to read the instruction manual carefully.

## INTENDED USE

This tool is intended for dry sanding of wood, plastic, filler and coated surfaces.

### 1. FITTING THE SANDING PAPER

#### SANDING PAPER WITH CLIP SYSTEM (SEE FIG. A, B, C, D)

##### FIT THE SANDING PAPER

Fit the sanding paper over the base. Make sure the sanding paper is even with the edges, and that the dust collection holes in the base and sanding paper is aligned, and that the sanding paper is taut on the base.

Lift the sanding paper retaining clips to the open position and insert one end of the sanding paper under the retaining clip.

Push the clip back into the retaining position. Lightly stretch the paper over the base plate ensuring that it is not folded or wrinkled, then position under the other retaining clip back into the retaining position. Check that the paper is flat to the base plate, if not, release either clip and reposition the paper before resetting the clip. Switch on momentarily to check that the sander is functioning correctly. If there is undue vibration, repeat the paper positioning procedure.

##### REMOVE THE SANDING PAPER

To remove the sanding paper, lift up the clamp lever and move away from the clamp lever lock. The sanding paper clamp is now loose. Repeat with the other clamp on the opposite side of your sander.

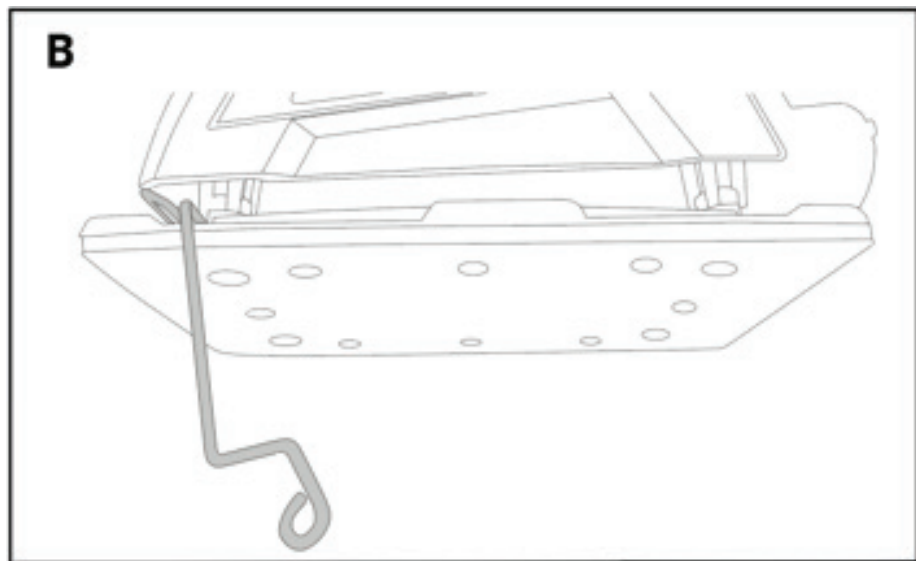
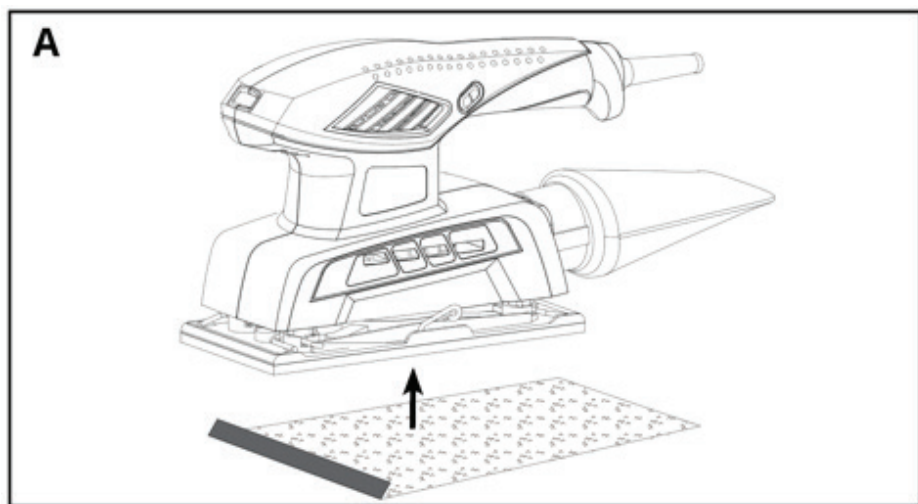

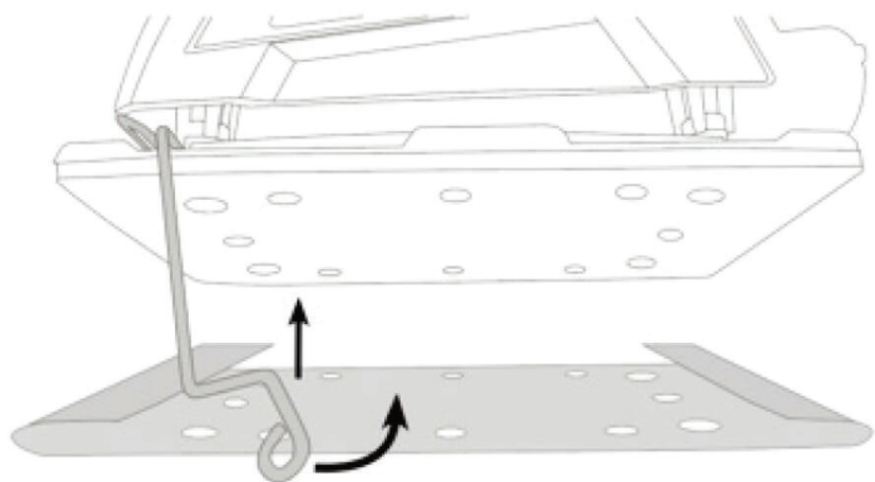
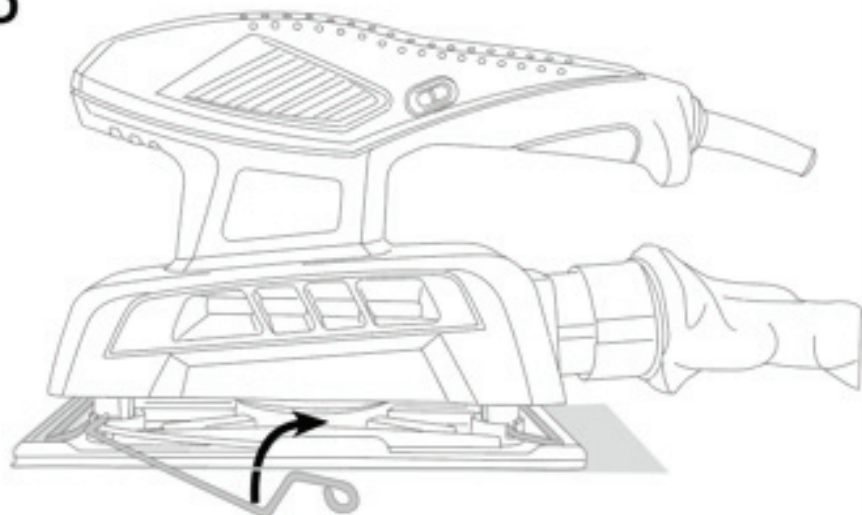
**C****D**

## **B C2. USING THE DUST COLLECTION BOX (SEE FIG. E)**

### **A) ATTACH THE DUST BOX**

Your sander is equipped with a dust collection box (6), which is designed for collect dust. Insert the dust collection box into the rear dust outlet the sander. Then pull the dust collection box and make sure it is tightened securely on the dust outlet.



**CAUTION:** To prevent the possibility of sanding dust or foreign objects being thrown into your face or eyes, never attempt to use your sander without the collection box properly installed.

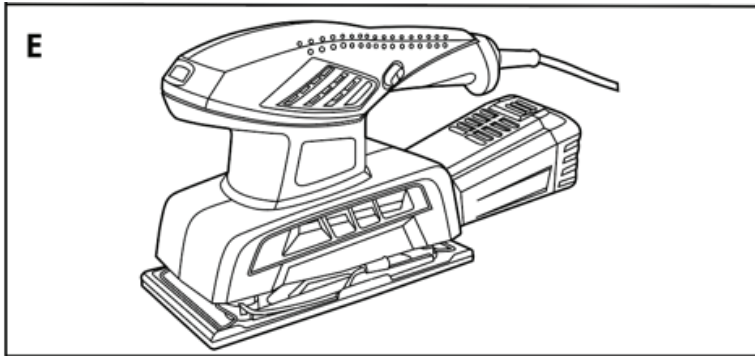

### **B) EMPTY DUST BOX**

For more efficient operation, empty the dust box every 5-10mins. This will permit the air to flow through the box efficiently.

To empty the dust box, pull off the from out of the dust extraction outlet directly and shake out the dust.

## **3. USING THE DUST OUTLET (SEE FIG. F)**

Your sander is equipped with a 35mm dust outlet, which is designed for connecting the hose of a vacuum cleaner.

If the vacuum hose is 35mm, insert the hose directly into the rear dust outlet of the sander.

First, turn on the vacuum cleaner, and then turn on the sander. If you stop sanding, first turn off the sander and then turn off your vacuum cleaner.

**NOTE:** Please pull the dust adaptor to make sure it is tightened securely to the dust outlet.

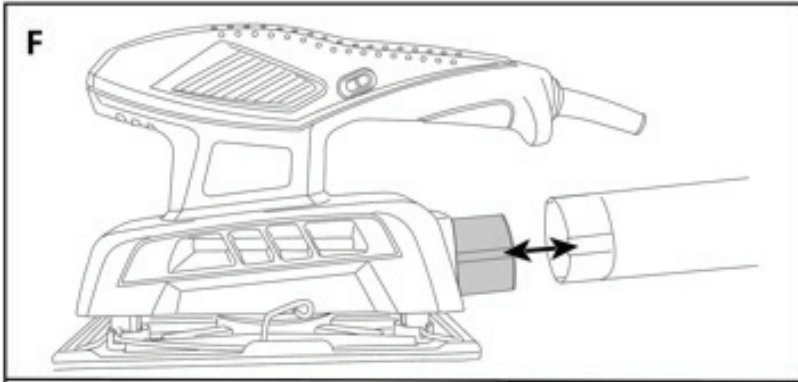

#### 4. OPERATING THE ON/OFF SWITCH (SEE FIG. G)

Slide the on/off switch to the position marked 'I' to start the tool. Slide it to the position marked '0' to stop it.

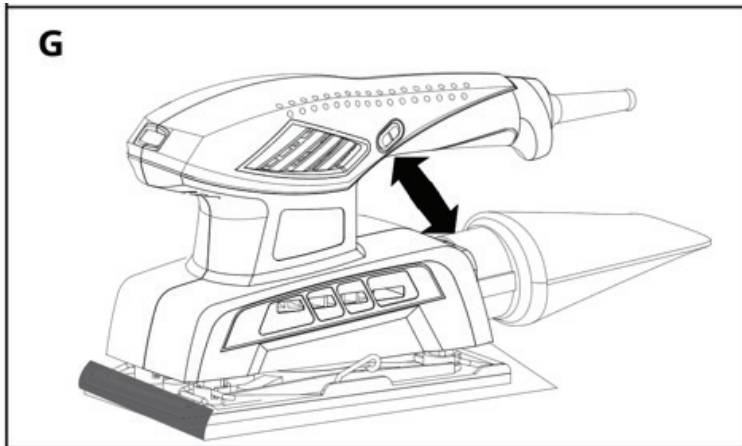

## **5. USING THE SANDER**

The workpiece to be sanded must be secured. If it is small or it may move during sanding, it must be held in a vice or suitably clamped.

Be sure to hold the sander firmly whilst it is on and apply it gently to the work, it may 'kick' on first contact. Hold the sander so that it is flat on the work and move slowly, preferably with a smooth, circular motion. Regularly check the condition of the sanding paper and replace when worn for best results.

## **6. FLUSH SANDING FACILITY**

Your sander can sand flush on three sides of the baseplate, which allows easy access to corners and edges of moldings.

## **7. ORBITAL SANDING**

Your sander operates in small a circular rotation which allows efficient material removal. Operate your sander in long sweeping movements across your workpiece and even across the grain. For a finer finish, always use a fine grain sanding paper, and only move the sander in the direction of the grit and never across the grain. Do not allow your sander to remain in the same position otherwise you will remove material and create an uneven surface.

## **8. SELECT THE RIGHT SAND PAPER**

Selecting the correct grit of sandpaper is an extremely important decision that will allow you to achieve the best quality sanding finish.

Coarse grit will remove the most material and finer grit will give you the best finish in all sanding operations. The condition of the surface to be sanded will determine which grit will do the job.

If the surface is rough:

Start with coarse grit (sold separately) and sand until the surface is uniform. Then use medium to remove any scratches left by the coarse grit. Then use finer grit (sold separately) for finishing the surface.

**NOTE:** Always continue sanding with each grit until the surface is uniform.

# MAINTENANCE AND STORAGE



## **IMPORTANT!**

Make sure that the tool has been thoroughly cleaned before storing it in a clean, dry and safe place, out of the reach of children.

1. Switch the product 'OFF' and disconnect it from the power supply before transporting it anywhere.
2. Always carry the product on its gripping surfaces.
3. Protect the product from any heavy impact or strong vibrations which may occur during transportation in vehicles.
4. Secure the product to prevent it from slipping or falling over.

If the supply cord is damaged, it must be replaced by the manufacturer, its service agent or similarly qualified persons in order to avoid a hazard.

# TECHNICAL DATA

<b>Model</b>	<b>AJ65A</b>
Voltage/power	230-240V~ 50Hz/200W
No-load speed	6000-12000/min
Sanding pad size	90x187mm
Protection class	□ / II
Weight	1.9kg
<b>NOISE AND VIBRATION DATA</b>	
A weighted sound pressure (LpA)	80.6 dB(A), k=3dB(A)
A weighted sound power (LwA)	91.6 dB(A), k=3dB(A)
Vibrations	ah=8.106 m/s <sup>2</sup> , K=1,5 m/s <sup>2</sup>

The sound intensity level for the operator may exceed 80 dB(A) and ear protection measures are necessary.

The declared vibration value has been measured in accordance with a standard test method (according to EN 62841) and may be used for comparing one product with another. The declared vibration value may also be used in a preliminary assessment of exposure.



## WARNING!

The vibration emission value during actual use of the power tool can differ from the declared value depending on the ways in which the tool is used and dependant on the following examples and other variations on how the tool is used:

How the tool is used and the materials being cut or drilled.

The tool being in good condition and well maintained.

Using the correct accessory for the tool and ensuring it is sharp and in good condition.

The tightness of the grip on the handles and if any anti-vibration accessories are used.

And the tool is being used as intended by its design and these instructions.

**This tool may cause hand-arm vibration syndrome if its use is not adequately managed.**



**WARNING!** To be accurate, an estimation of exposure level in the actual conditions of use should also take account of all parts of the operating cycle, such as the times when the tool is switched off and when it is running idle but not actually doing the job. This may significantly reduce the exposure level over the total working period.

Helping to minimise your vibration exposure risk.

ALWAYS use sharp chisels, drills and blades.

Maintain this tool in accordance with these instructions and keep well lubricated (where appropriate).

If the tool is to be used regularly then invest in anti-vibration accessories.

Plan your work schedule to spread any high vibration tool use across a number of days.

# RECYCLING AND DISPOSAL



Waste electrical products should not be disposed with household waste. Please recycle where facilities exist. Check with your local authority or retailer for recycling advice.

# UK PLUG

If you need to replace the fitted plug then follow the instructions below.

**IMPORTANT:** The wires in the mains lead are coloured in accordance with the following code: Blue-Neutral, Brown-Live



**WARNING!** Never connect live or neutral wires to the earth terminal of the plug. Only fit an approved 13Amp BS1363/A plug and the correct rated fuse.

As the colours of the wire in the mains lead of this product may not correspond with the coloured markings identifying the terminals in your plug, proceed as follows: The blue wire must be connected to the terminal marked N or coloured black. The brown wire must be connected to the terminal marked L or coloured red.

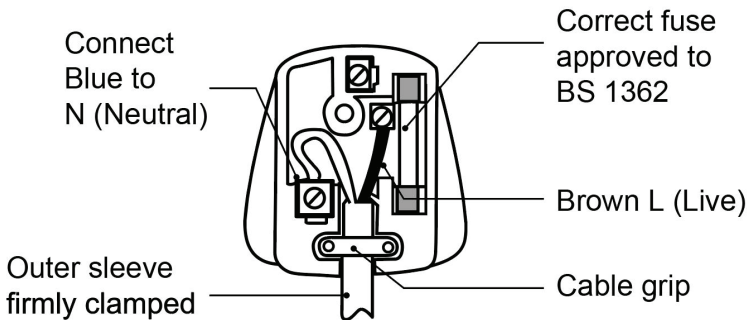

## GETTING HELP

Our dedicated UK-based customer helpline is open 7 days a week to assist you with assembly, parts queries and technical support. We are open during office hours but you can always send an email via **support@coreservice.co.uk**. Our experts are here to get you back enjoying your garden in no time.

For useful assembly, starting and maintenance videos, and for ordering spares, please visit **www.coreservice.co.uk**.

Calling our service does not affect your statutory rights.

## **WARRANTY**

This product is covered by a 1 year warranty.

The warranty covers any manufacturing defect in materials, workmanship and finish.

Any claim under this warranty must be made by going to your nearest Homebase store, taking your proof of purchase with you, and claims must be made within 12 months of the date of purchase.

We will offer you a free repair of the item where this is possible, or a replacement or a refund. Your statutory rights remain unaffected, in particular any rights you may have under the Consumer Rights Act 2015.

This warranty is given by HHGL Limited, MK9 1BA and HHGL (ROI) Limited, D02 X576.

Please note: This warranty does not apply to products misused or neglected and only covers domestic use. It does not apply to commercial use of the product. In addition, the warranty will be void for the following reasons: Any damage resulting from product misuse or product neglect.

