



Keeping Britain green and pleasant since 1920

Q **GTP25** 38cm 25.4cc Petrol Grass Trimmer 495408



Original Instructions



IMPORTANT! Please read these instructions fully before starting assembly.

These instructions contain important information that will help you get the best from your product, ensuring it is assembled correctly and safely. If you need help or have damaged or missing parts, call the Customer Helpline on **01904 727 500**.

Contents

General safety warnings	3
Intended use	8
Warning symbols	8
In the box	10
Assembly	11
Preparation	13
Operation	14
Maintenance	20
Storage	25
Troubleshooting	28
Technical data	29
Disposal and recycling	30
Getting help	30
Warranty	30

General Safety Warnings

Safety warnings



WARNING! Read all safety warnings and instructions.

Failure to follow the warnings and instructions may result in serious injury.



WARNING! Read all safety warnings and instructions designated by the symbol.

Save all warnings and instructions for future reference.

- Always ensure anyone intending to operate this machine is fully conversant with the contents of this instruction manual prior to assembling, maintaining or operating the machine.
- Perform assembly operations as described in this manual. Failure to observe this warning may lead to serious injury, death, or damage to the machine.
- Always take care when removing the packaging, to prevent damage to you or to the machine.

IMPORTANT! Before assembling the machine, check all the parts indicated in the manual are in the box. Inspect all the parts for signs of damage. Do not assemble the machine if you observe any damaged components.

NOTE! This machine complies with the Noise Emission Directive 2000/14/EC.

General safety

- Keep this operating and maintenance manual in a safe place for reference at a later date.
- Read the instructions carefully. Be familiar with the controls and the proper use of the equipment.
- Never allow children or people unfamiliar with the instructions to use the machine. Local regulations can restrict the age of the operator.
- Never trim while people, especially children or pets, are nearby. Keep in mind that the operator or user is responsible for accidents or hazards occurring to other people or their property.
- This appliance is not intended for use by people (including children) with reduced physical, sensory or mental capabilities, or lack of experience and knowledge, unless they have been given supervision or instruction concerning the use of the appliance by a person responsible for their safety.
- Do not touch the rotating spool.

Personal safety

- Do not allow children or untrained individuals to use this unit.
- Never start or run the engine in an enclosed or poorly ventilated area; breathing exhaust fumes can kill.
- Clear the work area before each use. Remove all objects, such as rocks, broken glass, nails, wire, or other such debris, which can be thrown or become entangled in the cutting line.

- Wear safety glasses or goggles when operating this unit.
- Wear heavy, long trousers, boots, and gloves. Do not wear loose fitting clothing, shorts, or go barefoot. Do not wear jewellery of any kind.

Operation safety

- Never operate this unit on the operator's left side.
- Secure long hair below shoulder level, to prevent entanglement in moving parts.
- Keep all bystanders, children, and pets at least 15m (50ft.) away.
- Do not operate this unit when you are tired, ill, or under the influence of alcohol, drugs, or medication.
- Do not operate it in poor lighting.
- Keep firm footing. Do not overreach. Overreaching can result in loss of balance or exposure to hot surfaces.
- Keep all parts of your body away from any moving parts.
- To avoid hot surfaces, never operate the unit with the bottom of the engine above waist level.
- Do not touch the area around the exhaust or cylinder of the units; these parts get hot during operation.
- Always stop the engine and remove the spark plug wire before making any adjustments or repairs, except for carburettor adjustments.
- Inspect the unit for loose fasteners, fuel leaks, etc., before each use. Replace any damaged parts before use.

- The string head will rotate during carburettor adjustments and engine starting.
- It has been reported, in certain individuals, that vibrations from hand-held tools may contribute to a condition called Raynaud's Syndrome. Symptoms may include tingling, numbness and blanching of the fingers, usually apparent upon exposure to cold. Hereditary factors, exposure to cold and dampness, diet, smoking and work practices are all thought to contribute to the development of these symptoms. It is presently unknown what, if any, vibrations or extent of exposure may contribute to the condition. There are measures that can be taken by the operator to possibly reduce the effects of vibration:
 - a) Keep your body warm in cold weather. When operating the unit, wear gloves to keep the hands and wrists warm. It is reported that cold weather is a major factor contributing to Raynaud's Syndrome.
 - b) After each period of operation, exercise to increase blood circulation.
 - c) Take frequent work breaks. Limit the amount of exposure per day.
 - d) Keep the tool well maintained, fasteners tightened and worn parts replaced.
- If you experience any of the symptoms of this condition, immediately discontinue use and see your doctor about these symptoms.

- Mix and store fuel in a container approved for petrol clearly identified as 2-stroke.
- Mix fuel outdoors where there are no sparks or flames. Wipe up any fuel spillage. Move 10m (30ft.) away from the refuelling site before starting the engine.
- Stop the engine and allow to cool before refuelling or storing the unit.
- Allow the engine to cool; empty the fuel tank and secure the unit from moving before transporting in a vehicle.
- Replace the string head if cracked, chipped, or damaged in any way. Be sure the string head is properly installed and securely fastened. Failure to do so can cause serious injury.
- Make sure all guards, straps, and handles are properly and securely attached.
- Use only the manufacturer's replacement string in the cutting head. Do not use any other cutting attachment. To install any other brand of cutting head to this string trimmer may result in serious personal injury.
- Never operate the unit without the grass guard in place and in good condition.
- Maintain a firm grip on both handles while trimming. Keep the string head below waist level. Never cut with the string head located over 76cm (30in.) above the ground.
- Do not use metal cutting blades.

Intended Use

This machine is designed to be used as a machine for trimming grass and light foliage.
For non-commercial use!

Non-intended use:

This machine is not designed for trimming hedges or any other job task whereby the machine has to be raised over a 30° angle.

Residual risks:

The machine uses a rotating cutting tool. Through this rotational motion, debris can be thrown from the cutting head of the unit, e.g. stones and sticks.

Warnings Symbols

The following warning symbols appear through this manual and indicate the appropriate safety measures you should take when operating and maintaining the machine.



Wear protective glasses, hearing protection, and a safety helmet (PPE).



Wear protective gloves.



Wear safety shoes.



Read the instructions for use prior to operating the machine.



When starting and working, keep the filament head away from foreign materials.



When working, maintain a safe distance of 15m from other people and from animals.



Only the filament trimmer may be used as a tool.



Maximum permitted rotational speed of the cutting tool.



Warning! Hot surface, do not touch.



No naked flames.



Conforms to all relevant safety standards.



Guaranteed sound power level data (114dB), in accordance with Directive 2000/14/EC.

In the Box

Parts

1. Line spool with cutting line
2. Safe guard
3. Lower tube
4. Steady grip
5. Switch On/Off
6. Throttle lock
7. Throttle lever
8. Choke lever
9. Starter

10. Spark plug boot
11. Air filter housing cover
12. Petrol tank
13. Housing for engine cooler
14. Fuel pump
15. Belt
16. Fuel mixer
17. Spark plug wrench

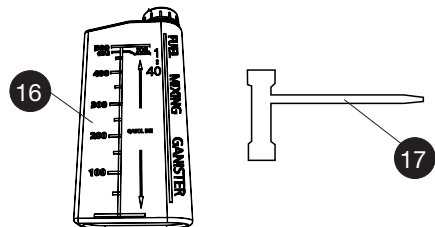
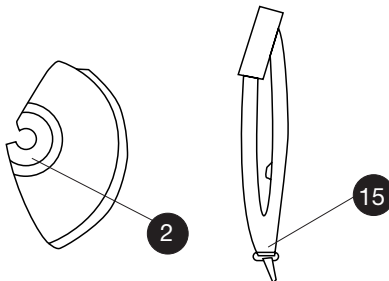
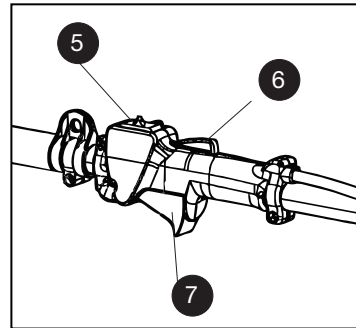
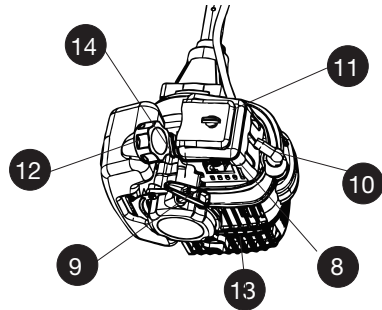
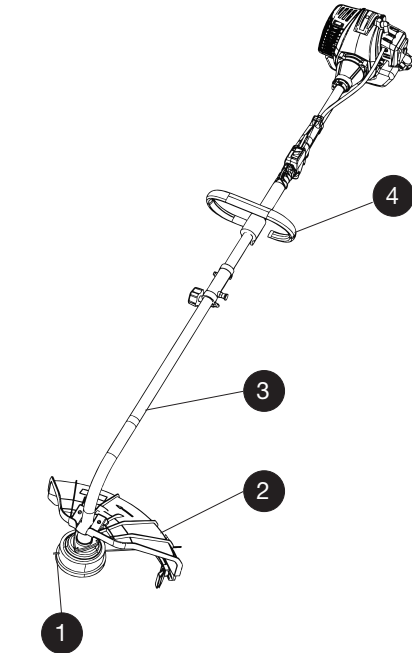

Assembly



WARNING!

Take care when removing packaging to prevent damage to the machine. Make sure that you have sufficient space to put the machine down. Keep your feet apart so that you have a stable position; bend at the knees and keep your back straight.

Always recycle the packaging in accordance with local recycling schemes.

When assembling this machine, please follow the instructions.

Assembling the handle

Position the handle in the middle of the shaft.

Attach the handle holder and tighten using the wing screws.

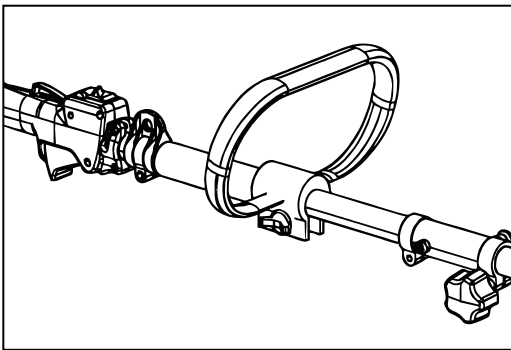
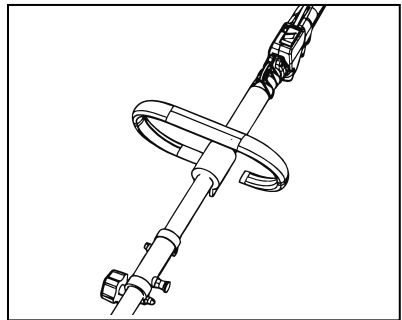
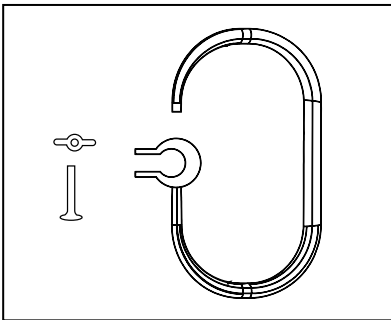

Mounting the shaft

Push the lower part of the shaft (b) right down until the stop pin (a) slots into the hole (c) in the shaft. This is easier to do if you rotate the bottom of the shaft (b) slightly in both directions. The pin (a) is in place when it is completely lodged in the hole. Lastly, tighten the knob (d) securely.

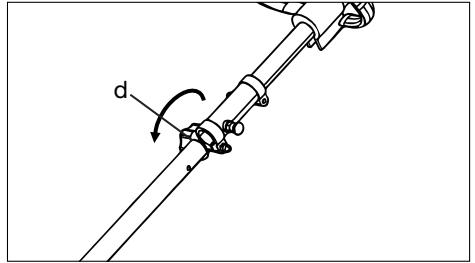
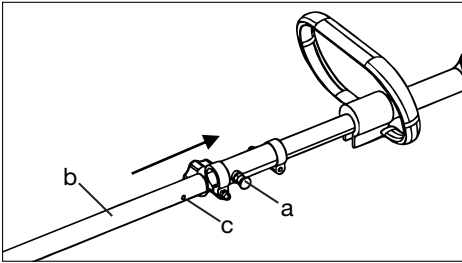

Assembling the safety guard

Remove the screws from the cutting head holder.

Assemble the safety guard and tighten the screws using the accessory provided.

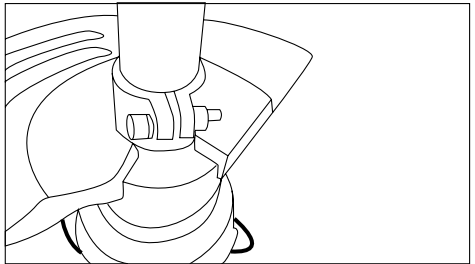
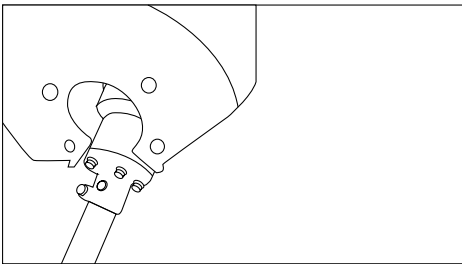
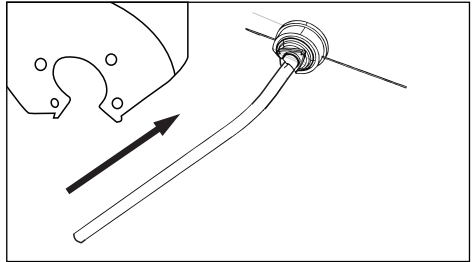
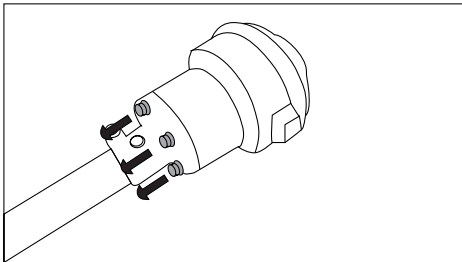

Fitting the belt

Place the harness so that it runs over the left shoulder, crossing the chest and back.

In case of emergency, pull the rope of the quick-release mechanism. The metal locking bar will be released automatically from the securing clip.



WARNING! Always attach the product to the harness! Do not carry it only with your hands!

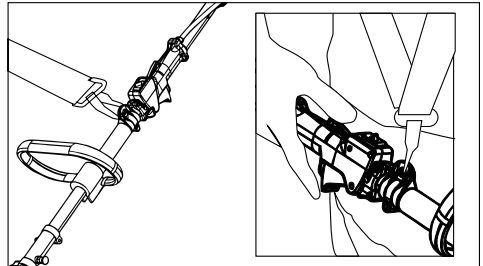
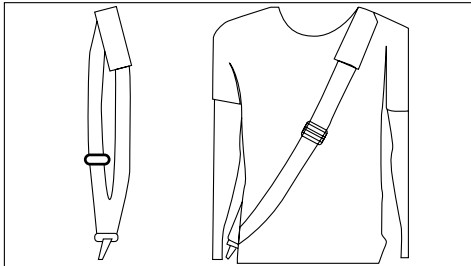

Preparation

Filling with engine fuel

Danger of injury! Fuel is explosive!

Turn off and cool the motor down before filling the tank with fuel. You must observe all safety instructions relating to handling fuel.

Risk of device damage!

The device is supplied without motor or gearbox oil.

ATTENTION! Before operating, you must fill it with fuel.



WARNING! Always switch the engine off before fuelling. Never add fuel to a machine with a running or hot engine. Move at least 30ft. (9m) from the refuelling site before starting the engine. Do not smoke!

IMPORTANT! Keep the bottle flat while filling and use a funnel.

This product is powered by a 2-stroke engine and requires pre-mixing of petrol and 2-stroke oil. Mix a high quality 2-stroke engine oil, according to JASO FC classic. Do not use automotive oil or 2-stroke outboard oil. DO NOT mix quantities larger than usable in a 30-day period.

1a. Fuel mixture:

1 Litre (1000ml) petrol: 25cc (25ml) 2-stroke engine oil (40:1 ratio).

Using a funnel and keeping the bottle level, pour the fuel to the line marked PETROL; and pour engine oil to the line marked OIL. Shake vigorously to mix the two products prior to pouring into the tank of the grass trimmer.

1b. Filling tank

Clean the surface around the fuel cap to prevent contamination. Loosen the fuel cap slowly. Rest the cap on a clean surface. Carefully pour fuel into the tank, avoiding spillage. Prior to replacing the fuel cap, clean and inspect the seal located inside the fuel cap. Immediately replace the fuel cap and hand tighten. Wipe up any fuel spillage.

NOTE: It is normal for smoke to be emitted from a new engine after first use.

Emptying engine fuel

Only ever empty the tank outdoors or in well-ventilated rooms. Make sure not to spill fuel or chain oil into the soil (environmental protection). Use a proper base.

Hold a collection container beneath the fuel drain bolt.

Unscrew the tank cap and remove it.

Allow the fuel to run out completely.

Screw the tank cap firmly by hand.

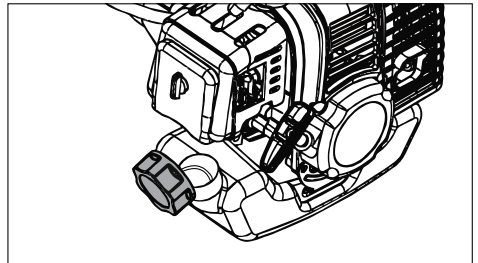
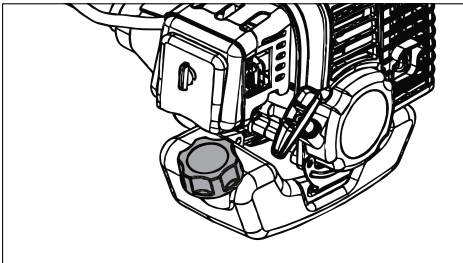

Operation

When working with the equipment, the appropriate plastic guard hood for 'cutting blade mode' or 'cutting line mode' must be fitted to prevent objects being thrown out by the equipment.

The integrated blade in the cutting line guard hood automatically cuts the line to the optimum length.

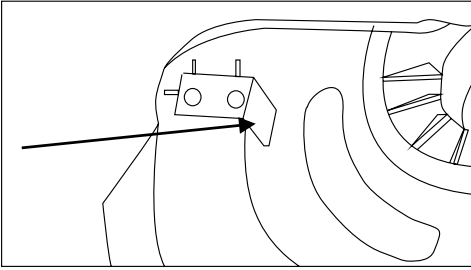

Start the engine

Do not start the unit until it has been completely assembled.

Danger of injury!

Do not operate the device unless you did not find any faults. If a part has become defective, be sure to replace it before you use the device again.

Check before use!

Check the safe condition of the device.

Check the device for leaks.

Check the device for visual defects.

Check that all parts of the device have been securely fitted.

Check that all safety devices are in proper condition.

Danger of injury!

Before starting work, always check the ground and remove all objects which could be thrown by the device.

Once the machine has been set up properly, start the engine as follows:

1. Set the equipment down on a hard, level surface.
2. Push the engine switch to the '1' position.

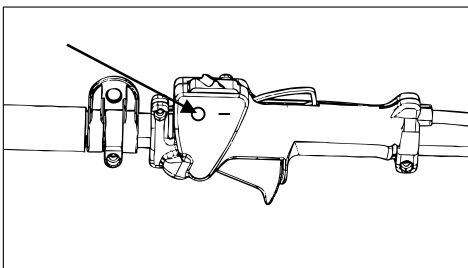

3. Put the choke lever on the  position.

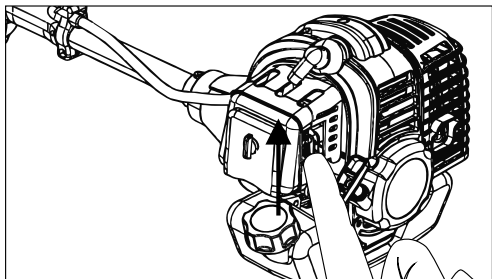

4. Press the fuel pump more than 5 times.

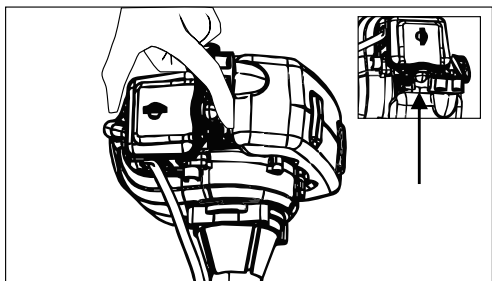

5. Press and hold the machine then, pull the recoil starter handle 5-6 times until the engine starts.

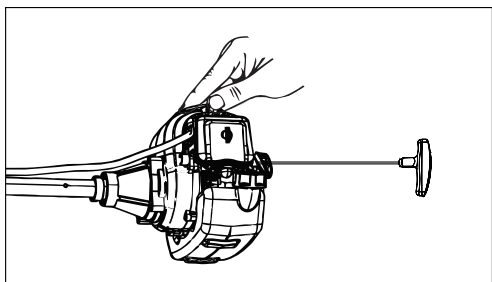

6. Adjust the choke lever to  position. Pull the recoil starter again to start the engine.

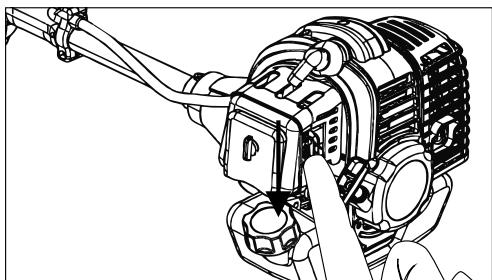

7. Run the machine for 30 seconds at idle speed, clutch lock-off lever and throttle lever at the same time.

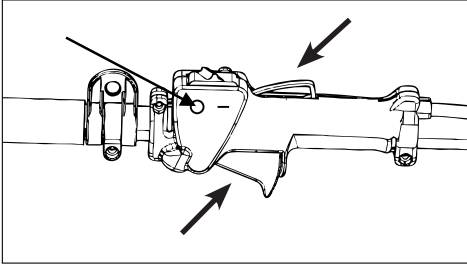

8. Adjusting line length while working:
9. This machine is fitted with a 'Tap & Go' head. To release more line, tap the cutting line head against the ground with the engine at top speed, the line will be released automatically and the knife will cut off the excess length.

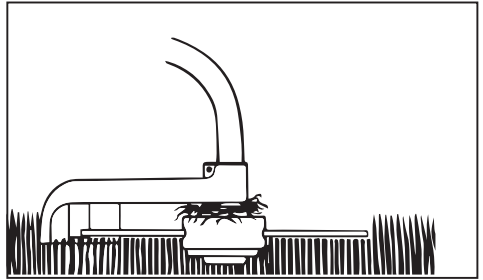
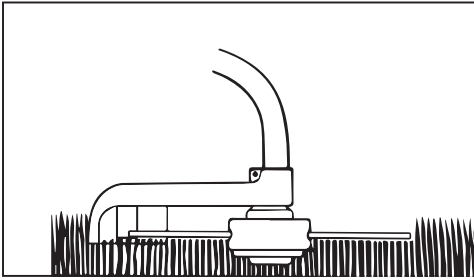

If you experience any problems, turn off the engine and the machine will stop running. To stop the cutting head, release the throttle lever.

The further you push the throttle lever, the higher the motor speed. When releasing the throttle lever, the motor becomes idle and the cutting tools will stop.

If the machine is hot, the choke level can be adjusted to  position directly when restart the machine.

NOTE: If the engine does not start up after several attempts, refer to the section 'Troubleshooting'.

NOTE: Always pull the starter cord out in a straight line. If it is pulled out at an angle, friction will occur on the eyelet. As a result of this friction, the cable will become frayed and will wear away faster. Always hold the starter handle when the cable retracts. Never allow the cable to snap back when it has been pulled out.

NOTE: Do not start the motor in tall grass.

Stop the engine

Push the engine switch to the '0' position

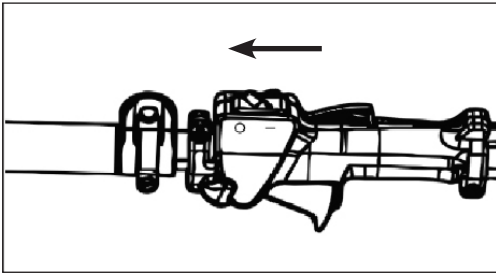

ATTENTION: When the engine has been switched off, the cutter continues running for several seconds; therefore, do not touch the cutting head of the brush cutter until it has come to a complete stop!

Working instructions

Extending the cutting line

CAUTION! Do not use any kind of metal wire or metal wire encased in plastic in the line spool. This may cause serious injury to the user. To extend the cutting line, run the engine at full speed and tap the line spool on the ground. This will automatically extend the line.

The blade on the safety shield will cut the line to the appropriate length.

IMPORTANT: Remove all grass and weed remnants at regular intervals to prevent the shaft tube overheating. Lawn, grass and weed remnants become trapped under the safety shield and prevent the shaft tube from receiving adequate ventilation. Remove these remnants using a tool not bare hands.

Different cutting methods

When the equipment is correctly assembled, it will cut weeds and long grass in places which are difficult to access, e.g. along fences, walls and foundations, and trees. It can also be used for 'mowing' vegetation to prepare a garden for other applications.

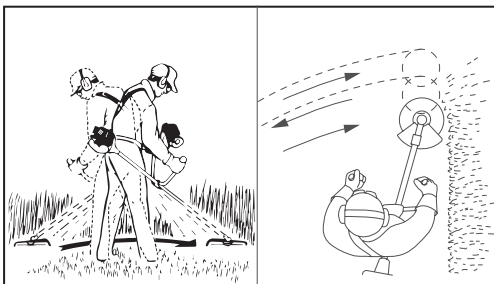

ATTENTION: Even if it is used carefully, cutting around foundations, stone or concrete walls will result in the line suffering more than normal wear.

Trimming/mowing

Swing the trimmer from side to side in a scything motion. Always keep the line spool parallel to the ground. Check the site and decide which cutting height you require. Guide and hold the line spool at the required height to obtain an even cut.

Low trimming

Hold the trimmer right in front of you at a slight angle so that the underside of the line spool is above the ground and the line strikes the correct target. Always cut away from yourself. Never draw the trimmer towards yourself.

Cutting along fences/foundations

Approach wire mesh fences, lath fences, natural stone walls and foundations slowly so that you can cut close to them without striking the obstacle with the line. If, for example, the line strikes stones, stone walls or foundations, it will wear or fray. If the line strikes wire fencing, it will break.

Trimming around trees

When trimming around tree trunks, approach slowly so that the line does not strike the bark. Walk around the tree, cutting from left to right. Approach grass or weeds with the tip of the line and tilt the line spool forwards slightly.



WARNING! Take extreme care during mowing work. When doing such work, keep a distance of 30 metres between yourself and other people or animals.

Mowing

When mowing, you want to cut all the vegetation down to the ground. To do this, set the line spool at an angle of 30° to the right. Place the handle in the required position. Take into consideration the danger of objects being thrown by the machine.



WARNING! Do not use the equipment to remove objects from footpaths, etc. The equipment is a powerful tool and can throw small stones and other objects a distance of 15 metres or more, causing injuries and damage to cars, houses and windows.

Jamming

If the cutting blade jams as a result of attempting to cut vegetation that is too dense, switch off the engine immediately. Remove the grass from the equipment before you restart it.

Maintenance



WARNING: Always wear protective gloves when working on or around cutting tools.

When not in use, transport or storage, always install the transport protection on all cutting tools.

Before performing any maintenance or cleaning work, always turn off the engine and pull out the spark plug boot.

1. Do not spray the unit with water. It damages the engine.
2. Clean the unit with a cloth or brush, etc.

Maintenance schedule			
	12 hours of use	24 hours of use	36 hours of use
Air filter	clean	clean	replace
Spark plug	check	clean	replace

Expert inspection is required:

If the brush cutter strikes an object.

If the motor stops suddenly.

If the gears are damaged.

Replacing the line spool/cutting line

1. Unscrew the line spool.

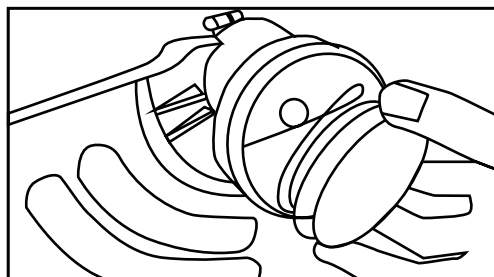

2. Remove any remaining cutting line.

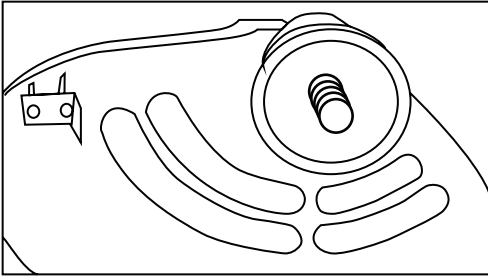

3. Place the new cutting line in the centre and hang the loop which has formed into the recess in the spool splitter.

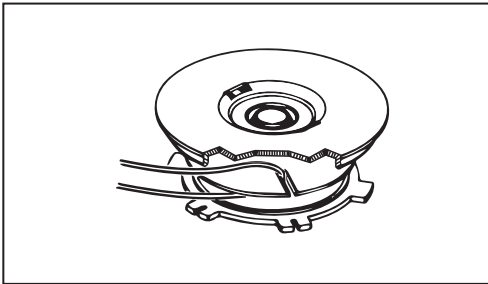

4. Wind the line onto the spool counter-clockwise and under tension. The spool splitter will separate the two halves of the line.

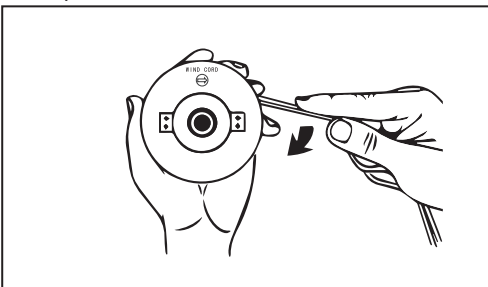

5. Hook the last 15cm of the two ends of the line onto the opposite lying line holders of the spool plate.

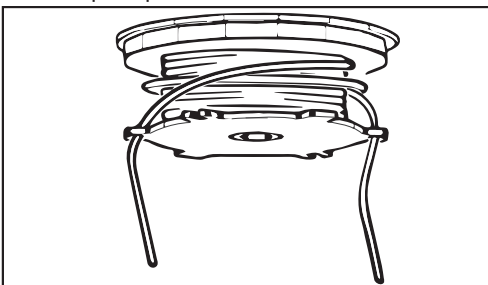

6. Thread the two ends of the line through the metal eyelets in the line spool housing.

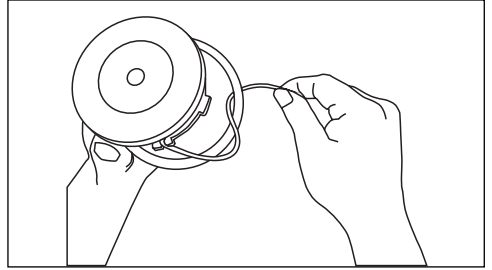
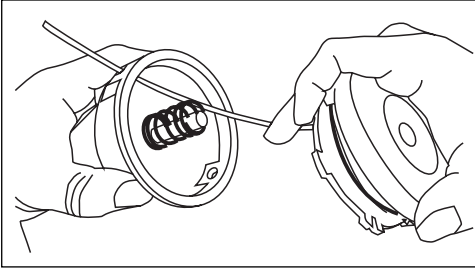

7. Remount the line spool.

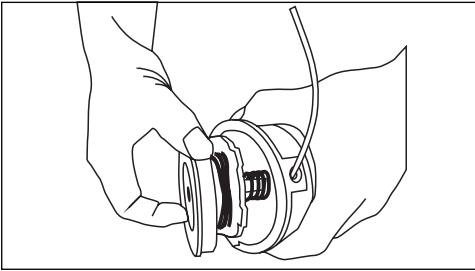

8. Tighten the screws.

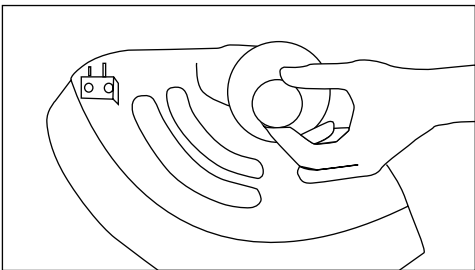
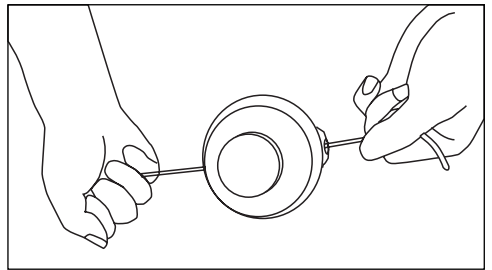
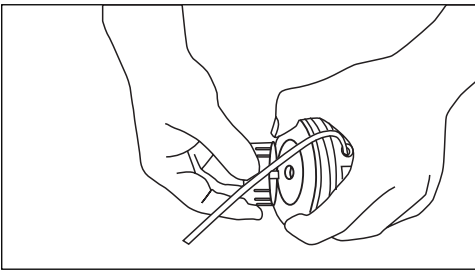

Grinding the safety hood blade

The safety hood blade can become blunt over time.

- When you notice this, undo the screw holding the safety hood blade on the safety hood.
- Clamp the blade in a vice.
- Sharpen the blade with a flat file and make sure that the angle of the cutting edge is not altered in the process. File in one direction only.

Replacing and re-sharpening the cutting blade at the end of the mowing season

Always re-sharpen the cutting blade or, if required, replace the cutting blade with a new one.

Changing and cleaning the spark plug

1. Once the engine has cooled, remove the spark plug using the socket spanner supplied.

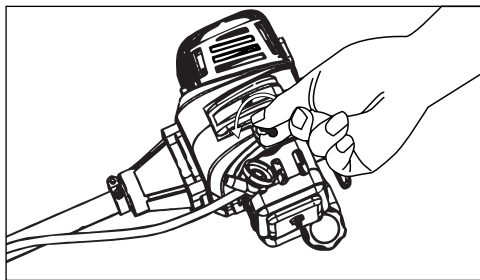
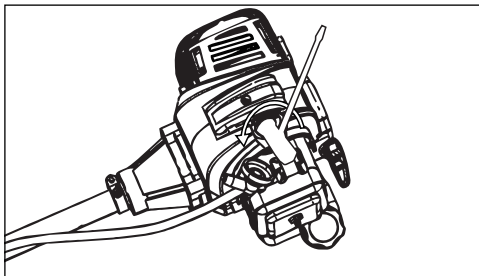
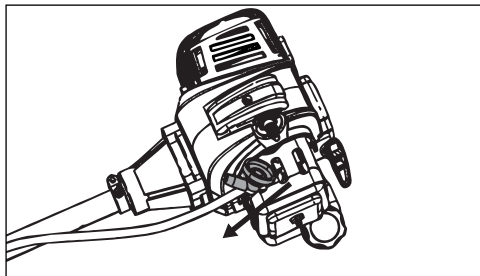

2. Clean the plug with a wire brush.
3. Using a feeler gauge, set the gap to 0.5-0.7mm.

4. Position the spark plug carefully by hand, to avoid cross-threading.

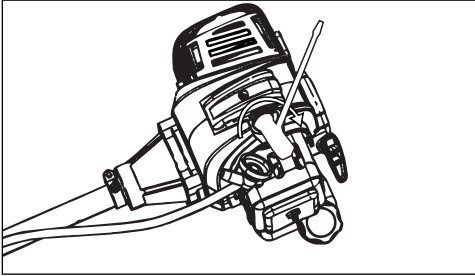

5. After the spark plug is seated, tighten with the spanner to compress the washer.

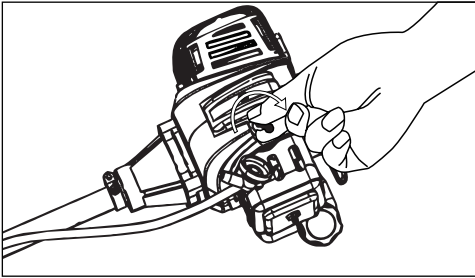

Cleaning the air filter

Soiled air filters reduce the engine power by supplying too little air to the carburettor. Regular checks are therefore essential.

- Unclip the air filter cover and remove the sponge filter element.
- To avoid objects falling into the air tank, replace the air filter cover.
- Wash the filter element in warm soapy water, rinse and allow to dry naturally.

IMPORTANT: Never clean the air filter with petrol or flammable solvents.

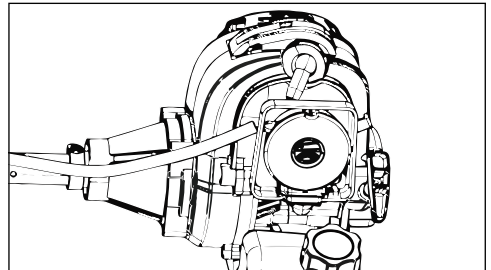
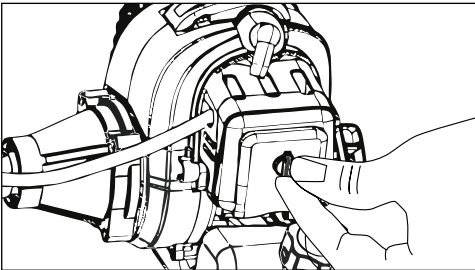



WARNING!

Never run the engine without the air filter element installed.

Worn parts

Even when used in the intended way, some components are subject to normal wear. These will have to be replaced depending on the kind of duration and usage. These parts include, among others, the cutting tool and the retaining disk.

WARNING! Use only original manufacturer's replacement parts, accessories and attachments. Failure to do so can cause poor performance, possible injury and may void your warranty. Never use the machine without the safety guard properly assembled!

Ordering replacement parts

Please quote the following data when ordering replacement parts:

- Type of machine
- Article number of the machine

Replacement parts/accessories:

For the cutting equipment listed here, you can always use the safety guards provided with the unit.

Grass trimmer: Spool 7910700716

Storage

Cleaning

Clean the equipment as required with a damp cloth and, if necessary, mild washing up liquid. Keep handles free of oil, so you always have a secure grip.

NOTE: Pull out the spark plug boot before carrying out cleaning.

Never immerse the equipment in water or other liquids in order to clean it.

Store the grass trimmer in a safe and dry place out of the reach of children.

Storage

NOTE: Never put the equipment into storage for longer than 30 days without carrying out the following steps.

Storing the equipment

If you intend to store the equipment for longer than 30 days, the equipment must be prepared accordingly; otherwise the fuel still remaining in the carburettor will evaporate and leave a rubbery sediment. This can cause problems when starting up the equipment and may require expensive repairs.

Slowly remove the fuel tank cap to release any pres-sure that may have formed in the tank. Carefully empty the tank.

To remove the fuel from the carburettor, start the engine and let it run until the equipment stops.

Leave the engine to cool (approx. 5 minutes).

Remove the spark plug (see section 10 Change and clean the spark plug).

Add one teaspoon of 2-stroke engine oil into the combustion chamber. Slowly pull the starter cord several times to apply a layer of oil to all internal components. Fit the spark plug again.

NOTE: Store the equipment in a dry place and far away from possible ignition sources.

Putting the equipment back into operation

Remove the spark plug (see section **Change and clean the spark plug**).

Quickly tug on the starter cord to remove excess oil from the combustion chamber.

Clean the spark plug and check that the electrode gap is correct, or insert a new spark plug with the correct electrode gap.

Prepare the equipment for operation.

Fill the tank with the relevant mixture of fuel and oil (see the section **Fuel and oil**).

Transport

Transportation:

Due to security reasons please, ensure that the equipment is sent back free of oil and gas!

Adjusting the idle speed.

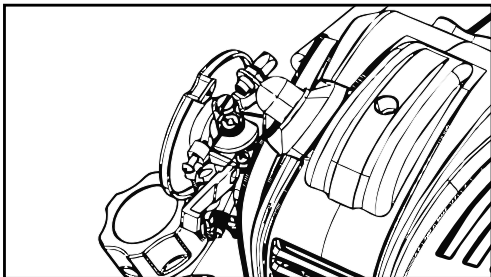

If the cutting device runs idle, correct the idle speed.

1. Allow the engine to warm for 3-5 minutes
(No high speeds!).
2. Turn the adjusting screw (S): clockwise
 - idle speed increases (+)
 - counterclockwise
 - Idle speed decreases (-)

The idle speed is 3000 min⁻¹

Contact the manufacturer if the cutter continues to run at idle.

Do not continue to operate the unit!

The user is responsible for all damages caused by non-compliance with instructions in this manual.

This also applies to non-authorized modifications of the tool, use of non-authorized spare parts, accessories, working tools, unrelated and not intended use, and secondary damages due to the use of faulty components.

Troubleshooting

The table below contains a list of fault symptoms and explains what you can do to remedy the problem if your equipment fails to work properly. If the problem still persists after working through the list, please contact your nearest service workshop.

Fault	Possible cause	Remedy
The equipment does not start	<ol style="list-style-type: none"> 1. Correct starting procedure not followed 2. Sooted or damp spark plug 3. Incorrect carburettor setting 4. Blade or Nylon cutter mounted incorrectly 5. No fuel in the tank 	<ol style="list-style-type: none"> 1. Follow the instructions for starting 2. Clean the spark plug or replace it with a new one 3. Contact an authorised customer service outlet 4. Reassemble the blade or Nylon cutter 5. Check the fuel level
The equipment starts but does not develop its full power	<ol style="list-style-type: none"> 1. Incorrect choke lever setting 2. Soiled air filter 3. Incorrect carburettor setting 4. Cutting blade blunt 	<ol style="list-style-type: none"> 1. Set the choke lever on the  position 2. Clean the air filter 3. Contact an authorised customer service outlet 4. Have cutting blade re-sharpened/replaced
The engine does not run smoothly	<ol style="list-style-type: none"> 1. Incorrect electrode gap on the spark plug 2. Incorrect carburettor setting 	<ol style="list-style-type: none"> 1. Clean the spark plug and adjust the electrode gap, or fit a new spark plug 2. Contact an authorised customer service outlet
Engine smokes excessively	<ol style="list-style-type: none"> 1. Incorrect fuel mix 2. Incorrect carburettor setting 	<ol style="list-style-type: none"> 1. Use the correct fuel mix (see fuel mixing table) 2. Contact an authorised customer service outlet
If the temperature of machine is too high	Engine is overloaded	Ensure the machine is rested at regular intervals

Technical Data

Property	Value
Engine type	Single-cylinder, 2-stroke
Displacement	25.4cm ³
Max. power	0.75kW
Max. engine speed	7500min ⁻¹
Idle speed	3100min ⁻¹
Min. clutch engaged speed	4500min ⁻¹
Tank capacity	600ml
Cutting width	380mm
Ignition	C.D.I
Diameter of cutting line	2.0mm
Net weight	5kg
Sound pressure level L_{PA} (dB)	99dB(A) K=3dB(A)
Sound power level L_{WA} (dB)	114dB(A)
Vibration (m/s ²)	8.3m/s ² K=1.5m/s ²
Spark type	L8RTF

Disposal and Recycling

The equipment is supplied in packaging to prevent it from being damaged in transit. The raw materials in this packaging can be reused or recycled. The equipment and its accessories are made of various types of material, such as metal and plastic. Defective components must be disposed of as special waste. Ask your dealer or your local council.

Getting Help

Our dedicated UK-based customer helpline is open 7 days a week to assist you with assembly, parts queries and technical support. We are open during office hours but you can always send an email via **support@gardenservicecentre.co.uk**. Our experts are here to get you back enjoying your garden in no time.

For useful assembly, starting and maintenance videos, and for ordering spares, please visit **www.gardenservicecentre.co.uk**.

Calling our service does not affect your statutory rights.

Warranty

This product is covered by a 2-year warranty.

The warranty covers any manufacturing defect in materials, workmanship, and finish.

Any claim under this warranty must be made by going to your nearest Homebase store, taking your proof of purchase with you. Claims must be made within 2 years of the date of purchase.

We will offer you a free repair of the item where this is possible, or a replacement or a refund. Your statutory rights remain unaffected, in particular, any rights you may have under the Consumer Rights Act 2015.

This warranty is given by HHGL Limited, Witan Gate House, 500-600 Witan Gate, Milton Keynes, MK9 1BA.

PLEASE NOTE: This warranty does not apply to products misused or neglected, and only covers domestic use. It does not apply to commercial use of the product.