



# User Manual

Spend a little Live a lot

**GARDENLINE**<sup>®</sup>  
Essentials

## 1000W Hover Mower

**GEHM28**



# Contents

<b>Product images and parts list .....</b>	<b>3</b>
<b>General information.....</b>	<b>7</b>
Reading and storing the instruction manual.....	7
Explanation of symbols.....	7
<b>Safety .....</b>	<b>11</b>
Proper use.....	11
Safety notes .....	12
<b>Checking the hover mower and product contents .....</b>	<b>16</b>
<b>Assembly .....</b>	<b>17</b>
Mounting the lower handle .....	17
Mounting the cord strain relief .....	17
Mounting the upper handle .....	17
Fit the cables clips .....	18
<b>Operation .....</b>	<b>19</b>
Switching on/off .....	19
Height adjustment .....	19
Mowing .....	20
<b>Maintenance .....</b>	<b>22</b>
<b>Cleaning .....</b>	<b>27</b>
<b>Troubleshooting.....</b>	<b>28</b>
<b>Storage .....</b>	<b>30</b>
<b>Disposal.....</b>	<b>31</b>
<b>Technical data.....</b>	<b>32</b>
<b>EC Declaration of Conformity</b>	
<b>Warranty</b>	
Warranty Card	
Warranty Conditions	

A

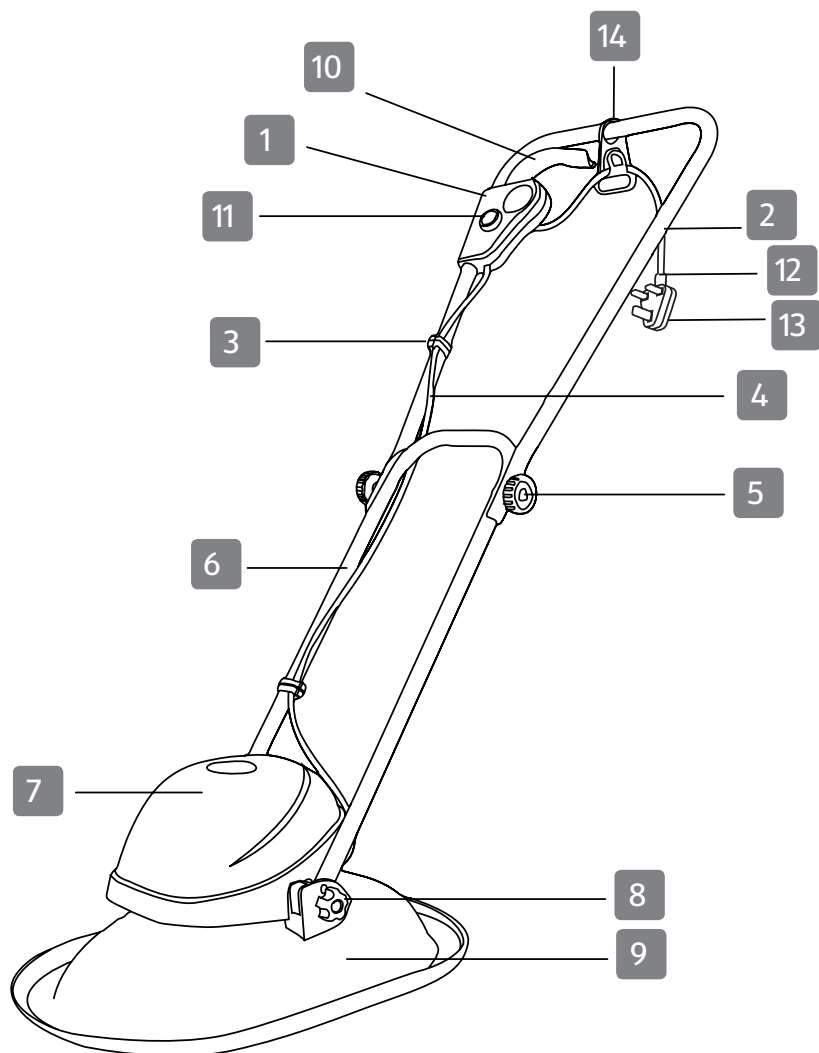

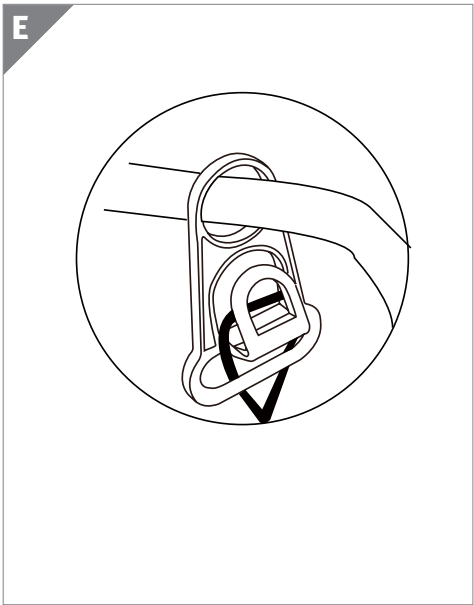
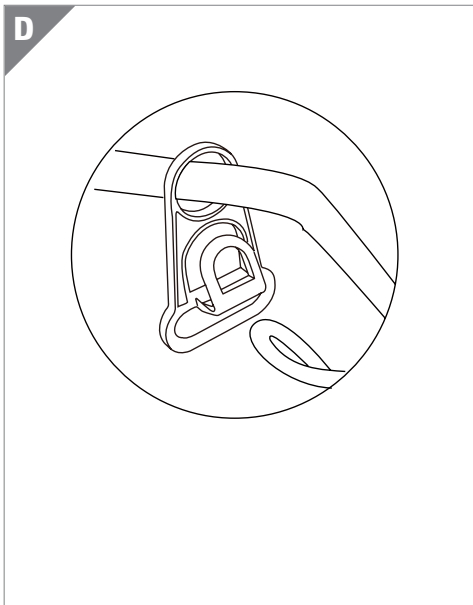
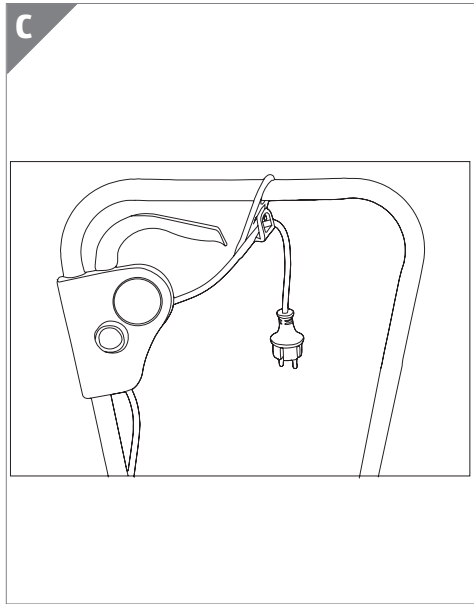
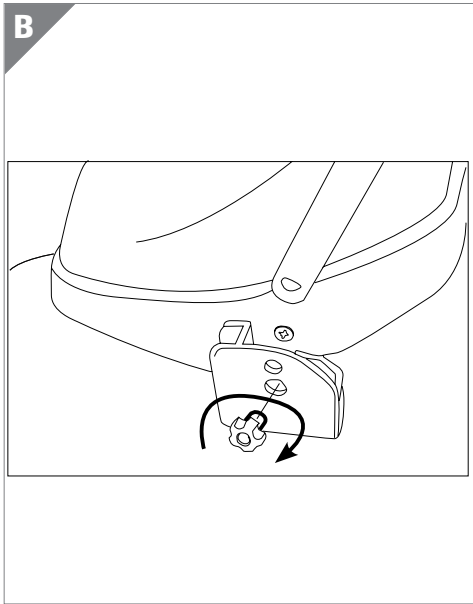

F

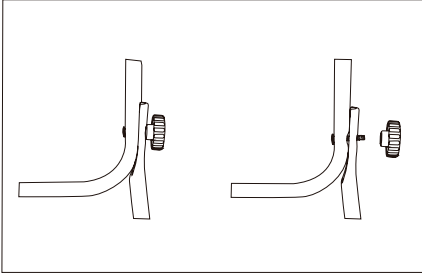

G

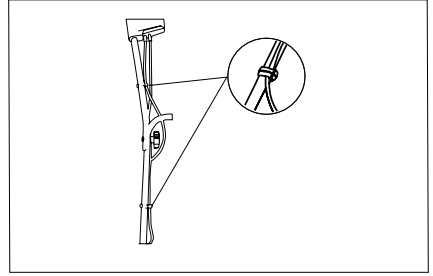

H

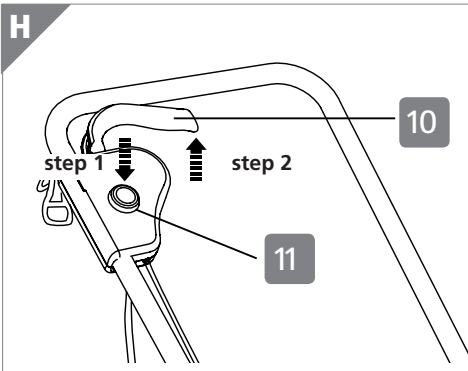

I

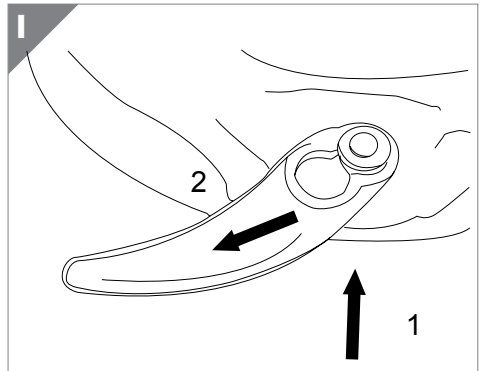

J

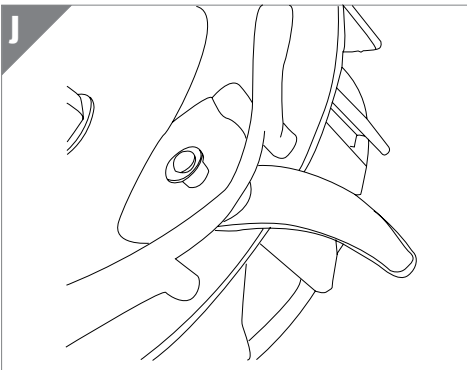

K

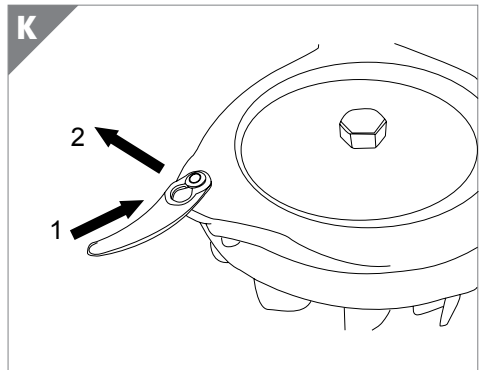

- 1 Switch Box
- 2 Upper Handle
- 3 Cable Clip
- 4 Mains Cable
- 5 Handle Clamp
- 6 Lower Handle
- 7 Motor Housing
- 8 Lower Handle Securing Bolt
- 9 Mower Deck
- 10 Switch Lever
- 11 Lock-off Button
- 12 Power Cord
- 13 Plug
- 14 Cord Strain Relief

## Reading and storing the instruction manual



This instruction manual accompanies this hover mower. It contains important information on assembly, start-up and handling. Before using the hover mower, read the instruction manual carefully. This particularly applies to the safety notes. Failure to heed this instruction manual may result in severe injury or damage to the hover mower. The instruction manual is based on the standards and rules in force in the European Union. Store the instruction manual for future use. If you pass the hover mower on to third parties, please be absolutely sure to include this instruction manual.

You can request an electronic version of these instructions from our customer service.

## Explanation of symbols

The following symbols and signal words are used in this instruction manual, on the hover mower or on the packaging.



Read the user manual before using the machine.



Warning! Danger!





You must always wear safety goggles to guard your eyes from flying debris, ear plugs or similar ear defenders to protect your hearing and respiratory protection to protect breathing.



**IMPORTANT!** Wear gloves to protect your hands.



Wear safety boots to protect your feet.



Guaranteed sound power level value in dB.



The product complies with the applicable European directives and an evaluation method of conformity for these directives was carried out.



WEEE symbol. Waste electrical products should not be disposed of with household waste. Please recycle where facilities exist. Check with your Local Authority or local store for recycling advice.



Do not expose the product to rain or wet conditions.

## AFTER SALES SUPPORT

8



GB +44 (0)1904 727501  
IRE +353 (0)1 902 2605



[www.coreservice.co.uk](http://www.coreservice.co.uk)





This product is constructed using protection class II. That means it is equipped with enhanced or double insulation and does not need to be earthed.



Objects thrown by the product could hit the user or other bystanders. Always ensure that other people and pets remain at a safe distance from the product when it is in operation. In general, children must not come near the area where the product is in operation.



Beware of sharp blades. Blades continue to rotate after the motor is switched off. Remove the plug from the mains before maintenance or if the cord is damaged.



**STOP**

Cutting device continues to rotate after the product is switched off. Wait until all components have completely stopped before touching the product.



Switch the product off and disconnect it from the power supply before assembly, cleaning, adjustments, maintenance, storage and transportation.



**WARNING!**

This appliance should be connected to your mains supply using an RCD (Residual Current Device). The operating current of this device must be less than 30mA. Contact an electrician if you are unsure of how to proceed.

For safety reasons, this lawnmower is not to be used by children, young people under 16 years of age, or any other persons who are not acquainted with these operating instructions.

For extension cables up to 15metres, use a wire cross section of 1.5mm<sup>2</sup>. For extension cables over 15meters but less than 40 meters, use a wire cross section of 2.5mm<sup>2</sup>.

**AFTER SALES SUPPORT**

## Safety

### Proper use

1. Operate the product only in daylight or in good artificial light.
2. Avoid operating the product in wet grass.
3. Always be sure of your footing on slopes.
4. Walk, never run.
5. Do not use this appliance in wet conditions, e.g., rain etc.
6. Mow across the face of slopes, never up and down.
7. Exercise extreme caution when changing direction on slopes.
8. Do not mow excessively steep slopes.
9. Use extreme caution when reversing or pulling the product towards you.
10. Stop the blades if the product has to be tilted for transportation when crossing surfaces other than grass, and when transporting the product to and from the area to be used.
11. Switch on the motor carefully according to the instructions and with your feet well away from the blades.
12. Do not tilt the product when switching on the motor except if the product has to be tilted for starting. In this case do not tilt it more than absolutely necessary and lift only the part which is away from the operator.
13. Do not put hands or feet near or under rotating parts. Keep clear of the discharge opening at all times.
14. Do not transport the product while the power source is



- running.
15. Stop the product, and remove the plug from the socket. Make sure that all moving parts have come to a complete stop:
    - Whenever you leave the product.
    - Before clearing blockages or unclogging the chute.
    - Before checking, cleaning or working on the product.
    - After striking a foreign object. Inspect the product for damage and make repairs before restarting and operating the product.
  16. If the product starts to vibrate abnormally (check immediately):
    - Inspect for damage.
    - Replace or repair any damaged parts.
    - Check for and tighten any loose parts.
  17. Keep extension cords away from moving hazardous parts to avoid damages to the cords which can lead to contact with live parts.

## Safety notes



### **WARNING!**

**DO NOT TOUCH THE ROTATING BLADES.**

- This machine can cause serious injuries. Read the instruction manual carefully for the correct handling, preparation, maintenance, starting and stopping of the appliance. Be familiar with the controls and the proper use of the appliance.

---

## AFTER SALES SUPPORT



Read and understand the operator's manual and observe the warnings and instruction labels affixed to the appliance.

- Never allow children or people unfamiliar with these instructions to use the appliance. Never operate this appliance when tired or under the influence of alcohol, medication or drugs.
- Use appropriate tools. This product is intended for private use only, not for any commercial applications. It may not be used for any purposes other than those described.

## Work Area Safety

- Keep work areas clean. Cluttered areas can cause accidents.
- Keep all bystanders, children, and pets at least 5 metres away. The operator or user is responsible for accidents or hazards occurring to other people or the property.

## Personal Safety

- Use personal protective equipment (PPE). Always wear eye protection. Protective equipment such as a dust mask, non-skid safety shoes or gloves used for appropriate conditions will reduce personal injuries.
- Dress appropriately. Do not wear loose clothing or jewelry, as these can be caught in moving parts. Preferably wear nonslip



- footwear when working outdoors. Wear a protective hair covering to keep long hair out of the way.
- Stay alert and use caution and common sense when operating the tool. A moment of lapsed concentration while operating the tool may result in serious personal injury.
  - This appliance can be used by persons aged 16 years and above and persons with reduced physical, sensory or mental capabilities or lack of experience and knowledge if they have been given supervision or instruction concerning use of the appliance in a safe way and understand the hazards involved.
  - Children should be supervised to ensure that they do not play with the product.
  - Read the instructions carefully. Be familiar with the controls and the correct use of the product.
  - Never allow children or people unfamiliar with these instructions to use the product. Local regulations can restrict the age of the operator.
  - Never operate the product while children, other people or pets are nearby.
  - Keep in mind that the operator or user is responsible for accidents or hazards occurring to other people or their property.

## Operational Safety

- Be certain the parts are fully tightened before operating the tool. Check it periodically for tightness during use to avoid serious injury.

---

## AFTER SALES SUPPORT



- While operating the product always wear substantial footwear and long trousers. Do not operate the product when barefoot or wearing open sandals. Avoid wearing clothing that is loose fitting or that has hanging cords or ties.
- Thoroughly inspect the area where the product is to be used and remove all objects which can be thrown by the product.
- Before using, always visually inspect to see that the blade, blade bolt and the blade assembly are not worn or damaged.
- Replace worn or damaged components in sets to preserve balance. Replace damaged or unreadable labels.
- Before use check the supply and extension cord for signs of damage or aging. If the cord becomes damaged during use, disconnect the cord from the supply immediately. **DO NOT TOUCH THE CORD BEFORE DISCONNECTING THE SUPPLY.**
- Do not use the product if the cord is damaged or worn. If the cord requires replacement this should only be carried out by the Service Agent or a similarly qualified person.
- Keep all nuts, bolts and screws tight to be sure the product is in a safe working condition.
- Never replace the plastic blade with metallic cutting means.
- Be careful during adjustment of the product to prevent entrapment of the fingers between moving blades and fixed parts of the product.
- When servicing the blades be aware that, even though the power source is switched off, the blades can still be moved.
- Replace worn or damaged parts for safety. Use only genuine replacement parts and accessories.



## Checking the hover mower and product contents



### **WARNING!** **RISK OF DAMAGE!**

If you are not cautious when opening the packaging with a sharp knife or other pointed objects, you may easily damage the hover mower. Therefore, be very careful when opening.

1. Take the hover mower out of the packaging and check whether the appliance or the individual parts exhibit damage. If this is the case, do not use the hover mower. Contact the manufacturer at the service address specified on the warranty card.
2. Check to make sure that the delivery is complete (see Fig A).

## AFTER SALES SUPPORT





## Assembly

### Mounting the lower handle

1. To attach the lower handle insert it into the slots on either side of the mower deck (see Fig B). Make sure that the holes in the handle are lined up with the holes in the mower deck.
2. Push the handle fixing bolts through the lower handle holes and into the threaded hole in the mower deck, then turn the fixing bolt in a clockwise direction by hand to secure the handle to the mower. You may find it difficult to fit the screw end into the threaded hole.

### Mounting the cord strain relief

1. To fit the upper handle first slide the cable restraint up and over the handle (see Fig C).
2. Double the extension cord back, about a foot from the end. Lead the loop through the cord strain relief (14) and hang the loop over the hook.
3. Gently pull on the cord to ensure that it is fastened (see Fig D and Fig E).

### Mounting the upper handle

1. Attach the upper handle to the lower handle with the safety



button on the switch box facing up. You will have to flex the upper handle slightly to fit it over the lower handle.

2. Line up the holes and secure together using the handle clamp wheels, washers and bolts (see Fig F). Tighten the clamps by hand.

### **Fit the cables clips**

1. The clips should all be fitted on the same side as the power lever. Fit one clip above the handle clamp and two below (see Fig G).



## Operation

### Switching on/off

1. Ensure the start lever (10) is released.
2. Press the lock-off button (11) and hold it in position (Fig H, step 1).
3. Squeeze the start lever (10) towards the handle (2) to switch the product on. Hold the start lever (10) in position during operation (Fig H, step 2).
4. Release the lock-off button (11) once the product is running.
5. Release the start lever (10) to switch the product off.

**NOTE!** The product can only be started by pressing the lock-off button (11) first followed by squeezing the start lever (10). Reverse operation will not start the product.

**NOTE!** The cutting device will continue to rotate for a short period after the product has been switched off.

### Height adjustment



#### **WARNING!**

Make sure that the hover mower is switched off unplugged and that the blades have stopped rotating before attempting to adjust the cutting height.





**WARNING!**

Do not touch the rotating blade.

1. Turn the hover mower over and remove the blades (see replacing the blades).
2. Fit the blades onto the blade holder pegs on the upper side of the blade holder for the lowest cut (see Fig I) or onto the lower side for the highest cut (see Fig J).

**Mowing**

1. Never cut off more than one-third of the total length of the grass for a healthy lawn. In the autumn, lawns should only be cut as long as there is growth.
2. Slowly push the product forward.
3. Mow in slightly overlapping rows. The most effective pattern for mowing lawns is straight lines along one of the sides. This will keep the rows even and ensures that all the lawn is cut without missing any spots.

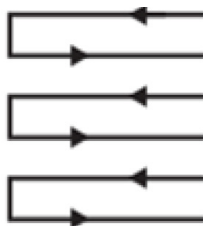

4. Circle around flower beds. When reaching a flower bed in the middle of the lawn, cut a width or two around the circumference of the bed.
5. Pay special attention when changing direction.



### **WARNING!**

If the product strikes a foreign object stop the motor. Switch the product off, disconnect it from the power supply and let it cool down. Inspect the product thoroughly for damage. Have any damage repaired by a suitable qualified person before restarting.

Extensive vibration of the product during operation is an indication of damage. Stop the motor unplug and check for damage.

### **LIST OF CONSUMABLE PARTS:**

GM004-101A-03	Plastic blade
HM001-115A-YH10	Knob
T42010635001	Bolt



## Maintenance

1. Always switch the product off, disconnect it from the power supply and let the product cool down before performing inspection, maintenance and cleaning work!
2. Keep the product clean. Remove debris from it after each use and before storage.
3. Regular and proper cleaning will help ensure safe use and prolong the life of the product.
4. Inspect the product before each use for worn or damaged parts. Do not operate it if you find broken or worn parts.



### **WARNING!**

Only perform repairs and maintenance work according to these instructions. All further works must be performed by a qualified specialist.

## Maintenance after each use

1. Clean the product with a dry cloth. Use a brush for areas that are hard to reach.
2. Clean the air vents after every use with a cloth and brush.
3. Remove stubborn dust with high pressure air (max. 3 bar).
4. Check for any damage or wear. Repair damage in accordance

---

## AFTER SALES SUPPORT

with this instruction manual or take it to an authorised service centre before using the product again.

**NOTE!** Do not use chemical, alkaline, abrasive or other aggressive detergents or disinfectants to clean this product as they may cause damage to the cosmetic surfaces.

### **Spare parts/Replacement parts**

Plastic blades may be replaced by the consumer. Spare parts are available at an authorised dealer or through our customer service.

### **Underbody and cutting device**

1. Keep the underbody and cutting device clean and free of debris.
2. Check all nuts and bolts periodically for tightness before operation. After prolonged use, especially in sandy soil conditions, the cutting device will become worn and lose some of its original shape. The cutting efficiency will be reduced and the cutting device should be replaced.
3. Keep the cutting device sharp to ensure a good cutting performance. Replace a worn or damaged cutting device with a new one of the same type.



## Replace the blades

Always unplug the hover mower before removing or refitting the blades. Only use the original supplied free blades for replacement.

1. Turn the hover mower over so you can see the blade holder. The blades have a keyhole shaped slot (Fig 11). To remove a blade push it towards the larger end of the blade upwards. You will have to push the blade quite hard before it moves.
2. Before fitting a new blade, clean the blade holder pegs. To fit a new blade, place the larger end of the keyhole slot over the blade holder peg and then pull the blade outwards until the peg is fitted into the smaller end of the keyhole slot. You will have to pull the blade quite hard before it moves.
3. Ensure the blades are secure before using the hover mower.

## Power cord

If the supply cord is damaged, it must be replaced by the manufacturer, its service agent or similarly qualified persons in order to avoid a hazard.





## UK plug

If you need to replace the fitted plug, then follow the instructions below.

**IMPORTANT:** The wires in the mains lead are coloured in accordance with the following code:

Blue – Neutral, Brown – Live

In case the colours of the wires in the mains lead don't match the colour marking on the terminals, please proceed as follow. Connect the blue wire to the terminal marked N (Neutral) or coloured black. The brown wire must be connected to the terminal marked L or coloured red.

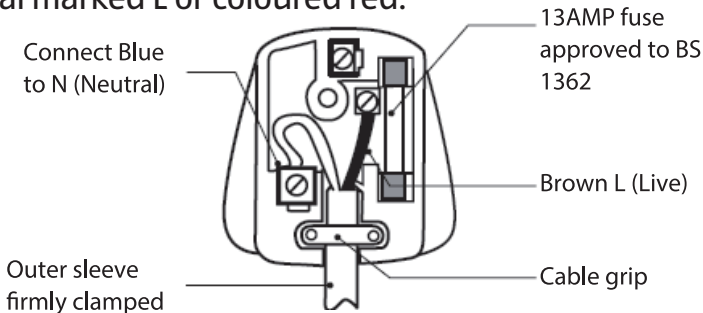

## Repair

This product does not contain any parts that can be repaired by the consumer other than those covered in the Maintenance section. Contact an authorised service centre or a similarly qualified person to have it checked and repaired.



## Transportation

1. Switch the product off and disconnect from the power supply before transporting it anywhere.
2. Adjust the cutting height to the highest position as described above.
3. Attach transportation guards, if applicable.
4. Always transport the product by its handle. When lifting the product use the transportation handle as an aid.
5. Protect the product from any heavy impact or strong vibrations which may occur during transportation in vehicles.
6. Secure the product to prevent it from slipping or falling over.

---

## AFTER SALES SUPPORT



## Cleaning

Before cleaning, inspecting or repairing your unit, make sure that the motor has stopped and is cool. Disconnect the plug to prevent accidental starting.

**Note!** To ensure the best performance of your hover mower, it is important to keep it clean. Always clean your hover mower immediately after use.

Do not allow grass cuttings and other debris to become dry and hard on any of the mower surfaces. This will directly affect the cutting performance. Make sure that the underside of the hover mower deck is clean and clear. Never clean the hover mower with a water jet or high pressure cleaner. The motor must remain dry. Do not use aggressive cleaning agents such as cold cleaner or petroleum ether.

The hover mower should be thoroughly cleaned after every use, especially the underneath. To do so, tip the hover mower onto its left side. Dirt and grass is easiest to remove immediately after you have finished mowing the grass.



## Troubleshooting

Suspected malfunctions are often due to causes that the user can fix themselves.

Therefore check the product using this section. In most cases the problem can be solved quickly.



### **WARNING!**

Only perform the steps described within these instructions! All further inspection, maintenance and repair work must be performed by an authorised service centre or a similarly qualified specialist if you cannot solve the problem yourself!



Fault	Possible cause	Troubleshooting
Product does not start	Not connected to power supply	Connect to power supply
	Power cord or plug is defective	Perform check by a qualified electrician
	Other electrical defect	Perform check by a qualified electrician.
	Lock-off button not pressed	Press the lock-off button first, then the start lever
	Blown fuse	Replace with genuine 13 AMP BS1362.
Product does not reach full power	Extension cord not suitable for operation with this product	Use a suitable extension cord
	Power source (e.g. generator) has too low a voltage	Connect to another power source
	Air vents are blocked	Clean the air vents
Unsatisfactory result	Cutting device is worn	Replace with a new one
	Cutting material exceeds capacity	Only cut materials according to the capacity of the product
	Cutting height is incorrect	Adjust the cutting height



## Storage

1. Clean the product as described above.
2. Store the product and its accessories in a dry, frost-free place.
3. Always store the product in a place that is inaccessible to children. The ideal storage temperature is between 10°C and 30°C.
4. We recommend using the original packaging for storage or covering the product with a suitable cloth or enclosure to protect it against dust.
5. Fold the upper handle bar (2) and fix it in position as described above.

---

## AFTER SALES SUPPORT

30



GB +44 (0)1904 727501  
IRE +353 (0)1 902 2605



[www.coreservice.co.uk](http://www.coreservice.co.uk)

## Disposal

### Disposing of the packaging



Dispose of the packaging separated into single type materials. Dispose of cardboard and carton as waste paper and foils via the recyclable material collection service.

### Disposing of old devices



**Old devices must not be disposed of with household waste!**

— If the hover mower can no longer be used, every user is required by law to dispose of old devices separately from their household waste, e.g. at a collection point in the community/borough. This ensures that old devices are recycled in a professional manner and also rules out negative consequences for the environment.



## Technical Data

Rated voltage	230 - 240 V~, 50 Hz
Rated input	1000 W
Cutting width	280 mm
Rated no load speed	7000 min <sup>-1</sup>
Cutting height	C10/20 mm; 2 levels
Protection class	II
Degree of protection	IPX4
Weight	approx. 5,4 kg

### NOISE AND VIBRATION DATA

A weighted sound pressure	84dB(A) K PA: 3dB(A)
A guaranteed sound power level	96dB(A)
Wear ear protection	
Typical weighted vibration	2.357m/s <sup>2</sup> K=1.5m/s <sup>2</sup>

The declared vibration value has been measured in accordance with a standard test method and may be used for comparing one tool with another. The declared vibration value may also be used in a preliminary assessment of exposure.

**WARNING!** The vibration emission value during actual use of the tool can differ from the declared value depending on the ways in which the tool is used. Identify safety measures to protect the operator that are based on an estimation of exposure in the actual conditions of use (taking account of all parts of the operating cycle such as the times when the tool is switched off and when it is running idle in addition to the trigger time).

The sound intensity level for the operator may exceed 85dB(A) and ear protection measures are necessary.

## AFTER SALES SUPPORT



# SUMEC

## Declaration of CE Conformity

We  
 SUMEC Hardware & Tools Co., Ltd.  
 1 Xinghuo RD., Nanjing, China  
 And our branch office  
 SUMEC UK Co., Ltd.  
 Unit A&B, Escrick Business Park  
 Escrick, York YO 19 6FD

Declare that the product  
 Electric Hover Mower  
 Model No: GEHM28  
 Manufacture Model No.:N1F-HM-280/1000-D  
 Function: Cutting grass  
 Serial number: 00001---09274

Complies with the following directives:  
 EMC Directive: 2004/108/EC  
 Machinery Directive: 2006/42/EC  
 Noise Directive: 2000/14/EC amended by 2005/88/EC  
 RoHS Directive: 2011/65/EU  
 WEEE Directive: 2012/19/EU

Standards conform to:  
 EN 55014-1:2006+A1+A2 EN 55014-2:1997+A1+A2  
 EN 61000-3-2:2006+A1+A2 EN 61000-3-3:2013  
 EN 60335-1:2012+A11 EN 50636-2-91:2014 EN62233:2008

We additionally confirm the following in accordance with the 2000/14/EC  
 emissions guideline:

Conformity Assessment Procedure as Per Annex VI,  
 Measured sound pressure level L pA:80.4 dB(A),k=2.5 dB(A)  
 Measured sound power level L wA :91.24 dB(A),K=3.3 dB(A)  
 Guaranteed sound power level L wA: 96 dB(A)

Authorized Signatory

Date: 19-11-2015 \_\_\_\_\_

Signature: 

Name: Liu Kai

General Manager

SUMEC Hardware & Tools Co., Ltd.





# WARRANTY CARD

GB IRE

## 1000W Hover Mower GEHM28

Your detail:

Name \_\_\_\_\_

Address \_\_\_\_\_

\_\_\_\_\_

\_\_\_\_\_

 \_\_\_\_\_ E-Mail \_\_\_\_\_

Date of purchase \* \_\_\_\_\_

\* We recommend you keep the receipt with this warranty card.

Location of purchase \_\_\_\_\_

Description of malfunction :

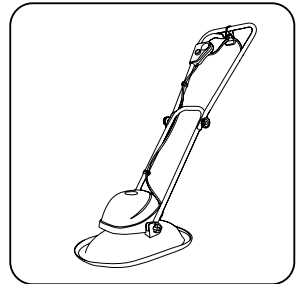





Return your completed warranty card together with the faulty product to:

Unit A&B  
Escrick Business Park  
Escrick  
York  
YO19 6FD

Email: [support@coreservice.co.uk](mailto:support@coreservice.co.uk)  
Tel: 01904 727501

### AFTER SALES SUPPORT-7 DAYS A WEEK

  +44 (0)1904 727501  [www.coreservice.co.uk](http://www.coreservice.co.uk)  
 +353 (0)1 902 2605

MODEL: GEHM28 PRODUCT CODE: 64311 04/2017

Phone lines available  
Mon - Fri : 9am - 5pm  
Sat - Sun: 11am - 4pm.  
Calls are charged at local rate,  
mobiles may vary

**1**  
YEARS WARRANTY

## Warranty conditions

Dear Customer,

The **ALDI warranty** offers you extensive benefits compared to the statutory obligation arising from a warranty:

**Warranty period:** 1 years from date of purchase

**Costs:** Free repair/exchange or refund.  
No transport costs.

**Hotline:** Support line charged at local rate

<b>ADVICE:</b> Please contact our service hotline by phone, e-mail or fax before sending in the device. This allows us to provide support in the event of possible operator errors.
---

**In order to make a claim under the warranty, please send us:**

- Together with the faulty item the original receipt and the warranty card properly completed.
- The faulty product with all components included in the packaging.

---

**The warranty does not cover** damage cause by:

- **Accident or unanticipated events.** (e.g. lighting, water, fire)
- **Improper use** or **Transport.**
- **Disregard of the safety** and **maintenance instructions.**
- Other **improper treatment** or **modification.**
- **The rotating blades.**

After the expiry of the warranty period, you still have the possibility to have your product repaired at your own expense. If the repair or the estimate of costs is not free of charge you will be informed accordingly in advance.

This warranty does not effect your statutory rights.

---



**Spend a little Live a lot**

Great care has gone into the manufacture of this product and it should therefore provide you with years of good service when used properly. In the event of product failure within its intended use over the course of the first 1 year after date of purchase, we will remedy the problem as quickly as possible once it has been brought to our attention. In the unlikely event of such an occurrence, or if you require any information about the product, please contact us via our helpline support services, details of which are to be found both in this manual and on the product itself.



**Importer:**  
SUMEC UK  
UNIT A&B ESCRICK BUSINESS PARK  
ESCRICK, YORK, YO19 6FD, UK  
Email: [support@coreservice.co.uk](mailto:support@coreservice.co.uk)

**AFTER SALES SUPPORT-7 DAYS A WEEK**



**GB** +44 (0)1904 727501

**IRE** +353 (0)1 902 2605



[www.coreservice.co.uk](http://www.coreservice.co.uk)

MODEL: GEHM28 PRODUCT CODE: 64311 04/2017

**1**

**YEARS WARRANTY**