

GARDENLINE®

46cm SP PETROL LAWNMOWER

User Guide



After Sales Support

Now you have purchased a Gardenline® product you can rest assured in the knowledge that, as well as your 3 year parts and labor guarantee, you have the added peace of mind of dedicated help lines and web support.

AFTER SALES SUPPORT-7 DAYS A WEEK



GB 0845 872 2740

IRE 019022605

(Charged at local rates)



www.coreservice.co.uk

MODEL: GPMXSZ46I, 05/2014, 60469



Please read this manual thoroughly before use and retain for future reference.

Contents

Page

02	Welcome
03	General Information
05	Safety Instructions
08	Assembly and Parts List
11	Getting Started
13	Features
14	Operating Instructions
16	Mowing Guidance
18	Maintenance
23	Frequently Asked Questions
24	Useful Information
27	Declaration of Conformity

You have made an excellent choice with the purchase of this quality Gardenline product.

By doing so you now have the assurance and peace of mind which comes from purchasing a product that has been manufactured to the highest standards of performance and safety, supported by the high quality standards of Aldi.

We want you to be completely satisfied with your purchase so this Gardenline product is backed by a comprehensive manufacturer's 3 year warranty and an outstanding after sales service through our dedicated Helpline.

We hope you will enjoy using your purchase for many years to come. If you require technical support or in the unlikely event that your purchase is faulty please telephone our helpline for immediate assistance. Please contact the technical helpline before returning your product to store. Faulty product claims made within the 3 year warranty period will be repaired or replaced free of charge provided that you have satisfactory proof of purchase (keep your till receipt safe!).

This does not affect your statutory rights. However, be aware that the warranty will become null and void if the product is found to have been deliberately damaged, misused or disassembled.

Read and follow the operating instructions and safety information before using this product for the first time.

Read all safety regulations and instructions.

Any errors made in following the safety regulations and instructions may result in serious injury, fire or electric shock. Keep all safety regulations and instructions in a safe place for future use. When using equipment, a few safety precautions must be observed to avoid injuries and damage. Please read the complete operating manual with due care. Keep this manual in a safe place, so that the information is available at all times. If you give the equipment to any other person, give them these operating instructions as well. We accept no liability for damage or accidents which arise due to non-observance of these instructions and the safety information.

Warning! For safety reasons, the Lawnmower is not to be used by children, young people under 16 years of age, or any other persons who are not acquainted with these operating instructions.

Items supplied

- Open the packaging and take out the equipment with care.
- Remove the packaging material and any packaging and/or transportation braces (if applicable).
- Check to see that all items are included.
- Inspect the equipment and accessories for transport damage.
- Keep the packaging until the end of the warranty period.

Explanation of the symbols and warning signs on the machine



1



2



3



4



5



6

- 1 Read the user manual before using the machine.
- 2 You must always wear safety goggles to guard your eyes from flying debris, ear plugs or similar ear defenders to protect your hearing and a safety helmet to protect against the risk of falling objects.
- 3 Important! Wear gloves to protect your hands.
- 4 Wear safety boots to protect your feet.
- 5 Warning! Danger!
- 6 Sound level data (115dB) in accordance with Directive 2000/14/EC

Machine handling pictograms

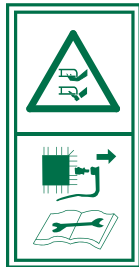

- 1 Keep bystanders away.
- 2 Beware of sharp blades- remove spark plug lead before maintenance.
- 3 No naked flames.
- 4 Hot surfaces will burn fingers or palms.
- 5 Warning! The lawnmower exhaust gas contains toxic substances. Do not run the engine in closed or poorly ventilated areas.
- 6 Blade continues to rotate for a period after the machine is switched off. Do not touch the blade until all the machine components have been stopped completely.

Warning: When using petrol tools, basic safety precautions, including the following, should always be followed to reduce the risk of serious personal injury and/or damage to the unit.

Read all these instructions before operating this product and keep them stored in a safe place for future reference.

1. Keep this operating and maintenance manual in a safe place for reference at a later date.
2. Read the instructions carefully. Be familiar with the controls and the proper use of the equipment.
3. Never allow children or people unfamiliar with these instructions to use the lawnmower. Local regulations can restrict the age of the operator.
4. Never mow while people, especially children, or pets are nearby. Keep in mind that the operator or user is responsible for accidents or hazards occurring to other people or their property.
5. This appliance is not intended for use by people (including children) with reduced physical, sensory or mental capabilities, or lack of experience and knowledge, unless they have been given supervision or instruction concerning use of the appliance by a person responsible for their safety.
6. Do not touch the rotating blade.
7. While mowing, always wear substantial footwear and long trousers. Do not operate the equipment when barefoot or wearing open sandals;
8. Thoroughly inspect the area where the equipment is to be used and remove all objects which can be thrown up by the machine;
9. Petrol is highly flammable: store fuel in containers specifically designed for this purpose;
 - refuel outdoors only and do not smoke while refuelling;
 - add fuel before starting the engine. Never remove the cap of the fuel tank or add petrol while the engine is running or when the engine is hot;
 - If petrol is spilled, do not attempt to start the engine but move the machine away from the area of spillage and avoid creating any source of ignition until petrol vapours have dissipated;

- replace all fuel tank and container caps securely;
- 10. Replace faulty silencers;
- 11. Prior to use, visually inspect to see that the blade, blade bolts and cutter assembly are not worn or damaged. Replace worn or damaged blades and bolts in sets to preserve balance;
- 12. Keep all nuts, bolts and screws tight to be sure the equipment is in a safe working condition;
- 13. Never store the equipment with petrol remaining in the tank inside a building where fumes can reach an open flame or spark;
- 14. Allow the engine to cool before storing in any enclosure;
- 15. To reduce the risk of a fire hazard, keep the engine, silencer, and petrol storage area free of grass, leaves, or excessive grease;
- 16. Check the grass bag frequently for wear or deterioration;
- 17. Replace worn or damaged parts for continued safety;
- 18. If the fuel tank has to be drained, this should be done outdoors.
- 19. Do not operate the engine in a confined space where dangerous carbon monoxide fumes can collect;
- 20. Mow only in daylight or in good artificial light;
- 21. Where possible avoid operating the equipment on wet grass;
- 22. Always be sure of your footing on slopes;
- 23. Walk, never run;
- 24. Mow across the face of slopes, never up and down;
- 25. Exercise extreme caution when changing direction on slopes;
- 26. Do not mow excessively steep slopes;
- 27. Use extreme caution when reversing or pulling the lawnmower towards you;
- 28. Stop the blade if the lawnmower has to be tilted for transportation when crossing surfaces other than grass, and when transporting the lawnmower to and from the area to be mowed;
- 29. Never operate the lawnmower with defective guards, or without safety devices, for example deflectors and/or grass catchers, in place;
- 30. Do not change the engine governor settings or over speed the engine;
- 31. Start the engine carefully according to instructions and with feet well away from the blade;
- 32. Do not tilt the lawnmower when starting the engine;
- 33. Do not start the engine without the grass collector located;

34. Do not put hands or feet near or under rotating parts. Keep clear of the discharge opening at all times;
35. Never pick up or carry a lawnmower while the engine is running;
36. Stop the engine and disconnect the spark plug cable, making sure that all moving parts have come to a complete stop:
 - Before clearing blockages or unclogging the chute;
 - Before checking, cleaning or working on the lawnmower;
 - After striking a foreign object, inspect the lawnmower for damage and make repairs before restarting and operating the lawnmower;
 - If the lawnmower starts to vibrate abnormally, check immediately;
37. Stop the engine and disconnect the spark plug wire, make sure that all moving parts have come to a complete stop before refueling;

Proper use

The lawnmower is designed exclusively for cutting grass.

The manufacturer cannot be held liable for damage caused by improper or incorrect usage.

Please note that our equipment has not been designed for use in commercial, trade or industrial applications. Our warranty will be voided if the machine is used in commercial, trade or industrial businesses or for the equivalent purposes.

Environmental protection

Dispose of soiled maintenance material and operating material at the appropriate collection point. Recycle packaging material, metal and plastics.

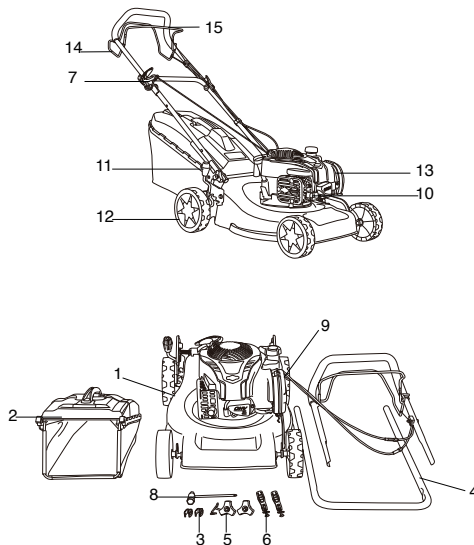

Fig 1

Layout (Fig 1)

- | | |
|---|--------------------------------------|
| 1. Main mower deck(with upper handle) | 8. Socket spanner for spark plug 1pc |
| 2. Hybrid Collection box | 9. Air Filter |
| 3. Cable clip 2pc | 10. Spark Plug |
| 4. Lower handle | 11. Cut Height Adjuster |
| 5. Lower handle fixing knob with nut M8 2pcs | 12. wheelx4 |
| 6. Quick release 2pcs | 13. Briggs & Stratton Engine |
| 7. Rope guide 1pc(attached to the lower handle) | 14. Propulsion lever |
| | 15. Start/stop bar |

Installation

Always take care when removing the packaging to prevent damage to you or to the lawnmower.

Before assembling the lawnmower, check all the parts indicated in the manual are in the box. Inspect all the parts for signs of damage. Do not assemble the lawnmower if you observe any damaged components.

1 Remove the packaging

- 1a. Remove all parts of the lawnmower from the box and carefully remove all packaging. Take care not to lose any instructions which may be attached to the parts. These provide important information which will be required while assembling the lawnmower.
- 1b. Keep all packaging until the lawnmower is fully assembled and has been operated successfully.

Note! Always recycle the packaging in accordance with local recycling schemes.

This item requires a two person lift to remove from the packaging. Make sure that you have sufficient space to put the lawn mower down. Keep your feet apart so that you have a stable position, bend at the knees and keep your back straight.

2 Assemble the lower handle (Fig 2)

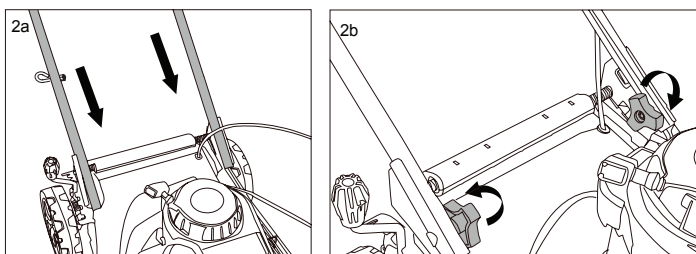

Fig 2

- 2a Remove the packaging from the handle. Set the height adjustment to the highest position, and align the lower handle with the holes in the deck. Make sure the holes in the lower handle are aligned with those in the support.
- 2b Fix the lower handle onto the deck firmly.

Note! Make sure the rope guide is on the right handle, when you stand behind the mower.

Lift the upper handle, and lock in place using the quick release lever and tensioning bolts that are attached to the handle.

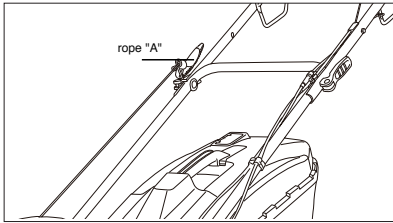

Fig 3

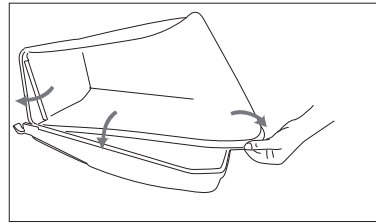

Fig 4

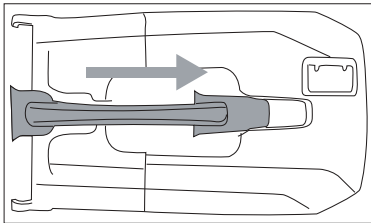

Fig 5

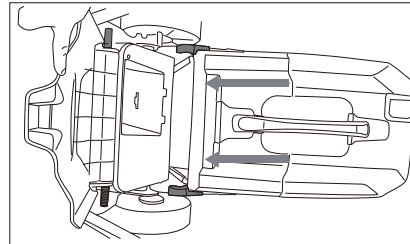

Fig 6

Note! Make sure the lower and upper handles are firmly connected. And that the cables are not twisted.(Fig 3)
 Pull on/off lever and gently pull the rope. Hook it around the guide rope "A".

2. Assembling the hybrid collection box.(Fig 4, 5, 6)

Raise the safety flap and hook the hybrid collection box onto the mower.

Release the safety flap.

Note! Always fit the hybrid collection box before starting the engine.

4 Fix the cable(Fig 7)

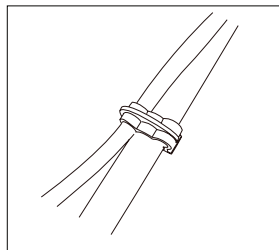

Fig 7

Ensure that the cables clips supplied are used to fix the cable to the lower handle.

Getting Started

5

Preparing to Operate the Lawnmower STOP !!!

Do not start the engine before adding oil to the oil sump. See below

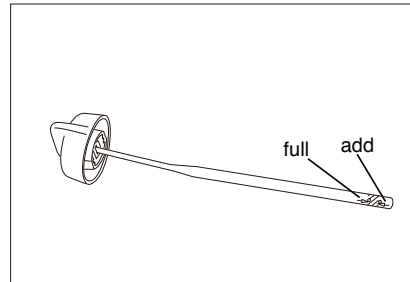
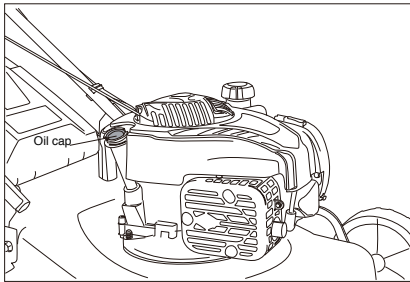

Fig 8

Note! The following procedures and adjustments must be performed before the engine is started. Do not attempt to make any of these adjustments while the engine is running.

Note! Always use high quality detergent oil classified SAE30 oil (or equivalent eg 5W 30, often termed as 4 Stroke lawn mower oil). Never use additives with recommended oil. To prolong the life of your engine it is important that the oil is changed after the first 5 hours of use.

Note! To prevent engine damage the engine is shipped without oil or petrol. The engine must be filled with the correct grade of oil and petrol before starting the engine.

Note! Running the engine with a low oil level will cause engine damage. It is recommend that high detergent, premium quality 4-stroke engine oil used. Using non-detergent oil can shorten the engine's service life and using 2-stroke oil will damage the engine.

Check the engine oil level when the engine is stopped and cool and the mower standing on a level surface.

Remove the oil filler dipstick and wipe any oil from it with a clean cloth.

Insert the dipstick into the any oil filler neck, but do not screw it in. Then remove the dipstick and check the oil level. The oil level must be between the Min and Max marks on the dipstick. If near the lower level, fill to the upper level with the recommended oil (SAE30 or equivalent). Do not overfill. Wipe away any spilt oil.

Fuel and lubrication

Note! Always use clean, fresh unleaded petrol. Purchase fuel in quantities that can be used within 30 days. Never mix oil with the petrol.

Note! Do not fill into the base of the tank neck to allow for fuel expansion. Do not overfill the fuel tank.

Note! Petrol is highly flammable and extreme precaution must be taken when handling or working with it. Keep out of reach of children.

Note! To prevent engine damage the engine is shipped without oil or petrol. The engine must be filled with the correct grade of oil and petrol before starting the engine.

Note! Refuel in a well-ventilated area with the engine stopped. Do not smoke or allow flames or sparks in the area where the engine is refuelled or where petrol is stored. Avoid repeated or prolonged contact with your skin or inhalation of vapour. Clean the area around the petrol filler cap before removing the cap. Remove the warning tag, check the fuel level.

Refill the tank if the fuel level is low.

Refuel carefully to avoid overfilling or spilling fuel. There should be no fuel in the filler neck.

Clean up any overflow or splashes of petrol before starting the engine.

Tighten the filler cap after filling, finger tight only.

Note! Do not use wasted or regenerated oil that can cause damage to the engine.

- 46cm cutting width suitable for medium to large lawns
- Steel deck prolongs useful life
- Briggs & Stratton 575EX engine, Ready Start
- Soft grip and ergonomic handle
- Self-propelled drive
- 60l Hybrid Collection box
- Single lever central height adjustment 7x positions 25~75mm

Operation

1. Setting the Cutting Height (Fig 9)

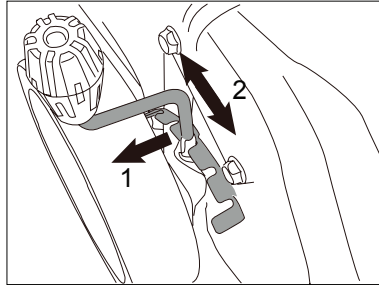

Fig 9

Note! The blade can cause serious injury. Before adjusting the mower height, stop the engine and wait for the mower blade to stop completely.

Pull the lever towards the wheel, then move it forward or backward to adjust the cutting height. Move it to any one of the 7 positions (25~75mm) for the desired cutting height; Return the lever into securing plate.

2. Starting the Engine

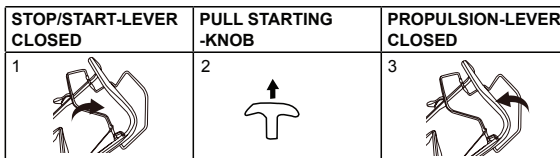

Fig 10

Starting procedure quick guide (Fig 10)

Note! Do not operate the machine in enclosed or poorly ventilated areas as the exhaust contains toxic substances. Keep hands, feet, hair and clothing away from all the moving parts of the machine. The exhaust and other parts of the machine will become hot during use.

Make sure that the blade is securely fastened before starting the engine.

Note! To start the engine, make sure that the spark plug cap is located on the plug and the machine is filled with sufficient oil and petrol.

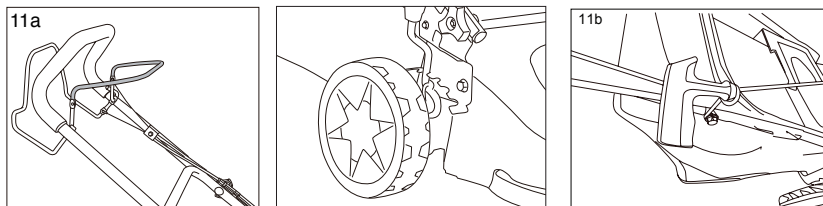

Fig 11

11a Start/Stop Bar Activation

Pull the Start/Stop bar towards you.

11b Pull cord handle

With right hand, slowly but firmly pull the starter handle and rope from the pull cord guide until you feel resistance, then pull briskly. If the engine fails to start after three pulls, repeat the start process. When the engine starts, return the starter rope to its rest position gently.

Note! Clearing a flooded engine:

If the engine won't start after you have operated the starter several times, the engine may be flooded with excess fuel.

Use the following procedure to clear and start a flooded engine:

- A. Release the stop/start bar.
- B. Remove the spark plug, dry it, and then reinstall it.

Note! Install the spark plug carefully by hand, to avoid cross-threading. After the plug is seated, tighten 1/8 to 1/4 turn with the spark plug socket spanner to compress the washer.

- C. Pull the stop/start bar toward the upper handle.
- D. Operate the starter as described above.

Mowing

Note! Always observe the strictest safety procedures when using the lawnmower.

Carefully read the safety instructions of this manual before using the lawnmower.

Start the engine and allow it run. See "Step-2 Starting the engine"

To stop the engine, release the stop / start bar.

Keep a firm grip on the upper handle with the stop/start bar and walk bar closed and walk along with it self-propelling, never run with the mower, be very careful when mowing uneven or rough ground. Mow across slopes, never up and down. Be careful when changing the direction of the mower on a slope. Do not use the mower on a steep slope of more than 15°.

The best result will be achieved if the grass is dry. Wet grass will tend to clog the blade and the grass collection system. Grass grows at different rates at different times of the year.

Never use the lowest cutting height for the first cut of the season or in drought conditions. Only about one third of the grass height should be cut.

If the lawnmower will not collect the cuttings efficiently, the grass discharge chute may be blocked. The hybrid collection box may be full, or the underside of the mower deck may be clogged.

Emptying the hybrid collection box

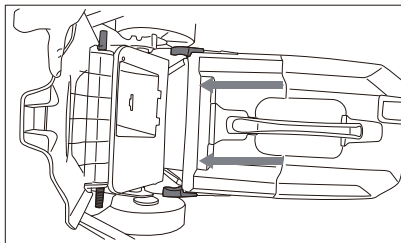

Fig 12

Note! Before you remove the hybrid collection box, stop the engine and wait until the blade stops completely.

Note! Always empty the hybrid collection box when you have finished the mowing, even if it is not full.

Stored grass residues are a fire hazard.

To remove the hybrid collection box, raise the discharge flap with

one hand and remove the hybrid collection box using its handle with your other hand.

Empty the grass debris from the hybrid collection box, and refit it. If any grass residues are caught in the discharge chute, clean it using a brush.

Do not remove grass debris in the mower casing or on the blade by hand or with your feet. Instead use suitable tools such as a brush or broom.

To ensure that the cut grass can be collected into the hybrid collection box, the discharge opening and inside the mower casing must be kept clear of any blockage.

Maintenance Schedule

Performing routine maintenance correctly on your lawnmower will ensure you get years of trouble free use.

Please keep this manual safe for future reference.

It is recommended that the following maintenance schedule is adhered to. This will ensure the lawnmower operates correctly and is safe to use.

	after every use	12 hours of use	24 hours of use	36 hours of use
Cleaning	clean	clean	clean	clean
Air filter		clean	clean	replace
Spark plug		clean	clean	replace
Engine oil	check	check	replace	check
Cutting blade	check	check	check	check

Cleaning

Before cleaning, inspecting or repairing your unit, make sure that the engine has stopped and is cool. Disconnect the spark plug to prevent accidental starting.

Note! To ensure the best performance of your lawnmower, it is important to keep it clean.

Always clean your lawnmower immediately after use.

Note! Do not allow grass cuttings and other debris to become dry and hard on any of the mower surfaces. This will directly affect the cutting and grass collection performance. Make sure that the underside of the lawnmower deck is clean and clear.

Note! Never turn the mower upside down.

Note! Before you tip the lawn mower onto its side, completely empty the fuel tank using a petrol suction pump.

Note! Never clean the lawn mower with a water jet or high-pressure cleaner. The engine must remain dry. Do not use aggressive cleaning agents such as cold cleaner or petroleum ether.

1. The lawn mower should be thoroughly cleaned after every use, especially the underneath and the blade mount. To do so, tip the lawn mower onto its left side (the opposite side to the oil filling socket). Dirt and grass is easiest to remove immediately after you have finished mowing the grass.
2. Check that the grass chute is free of any residual grass. Remove any such residue.

Maintenance Operations

Spark Plug

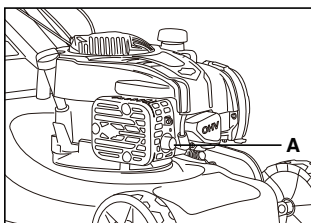

Fig 13

1. Once the engine has cooled, pull off the spark plug boot with a twist. Remove the spark plug using the socket spanner supplied.
2. Clean the plug with a wire brush.

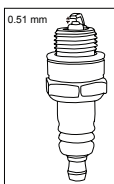

Fig 14

3. Using a feeler gauge set the gap to 0.51mm.
4. Install the spark plug carefully by hand, to avoid cross-threading.
5. After the spark plug is seated, tighten with the spanner to compress the washer.

Air Filter

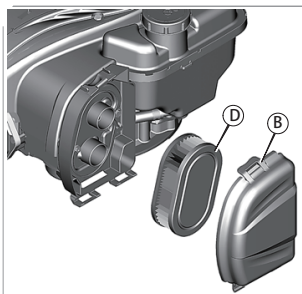

Fig 15

Note! Never run the engine without the air filter element installed.

The air cleaner system uses a pleated filter.

1. Open the cover (B).
2. Remove the filter(D).
3. To loosen debris, gently tap the filter on a hard surface. If the filter is excessively dirty, replace with a new filter.
4. Install the filter(D).
5. Close the cover(B).

Oil

Tilt the lawnmower towards the oil filler, have a container ready to catch the oil and remove the dipstick. Once the oil has been emptied, wipe clean any spillages.

Refill with 600ml SAE30 oil or equivalent ie SAE5W/30, SAE10W/30). When the dipstick is rested on the filler pipe (i.e. not screwed in place), the oil level must be between the min and max marks on the dipstick.

See "Filling with Engine Oil". Do not overfill.

Start the engine and allow it to run briefly.

Stop the engine, wait one minute and check the oil level. Top up if necessary.

Note! For more information see the Engine Manual.

Blades

For safety reasons you should only ever have your blade sharpened, balanced and mounted by an authorised service workshop. For optimum results it is recommended that the blade should be inspected once a year.

Note! For engine maintenance, see more details in the Engine Manual.

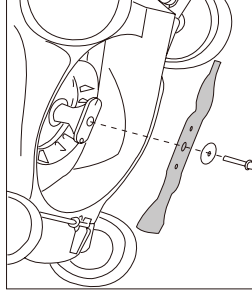

Fig 16

Note! Before you remove the hybrid collection box, stop the engine and wait until the blade stops completely.

Note! You will need garden gloves (not provided) and a spanner wrench to remove the blade.

Note! Don't invert the mower. Tip it slightly towards the oil filler pipe and reach under the deck.

Note! Always handle the blade with care- sharp edges could cause injury **USE GLOVES.**

Renew your metal blade after 50Hrs mowing or 2yrs whichever is sooner regardless of condition.

Note! If the blade is cracked or damaged replace it with a new one.

Note! Don't hold the blade by hand directly.

Note! Maintain the sharpness of the blade when cutting grass. If the blade has worn excessively and become pitted and blunt, it should be replaced or sharpened. The sharpness of the blade will affect the performance of the lawnmower.

For safety reasons we recommend that the blade only be changed by someone qualified and authorised to do so.

1. Tip the machine slightly towards the oil filler pipe and reach under the deck.
2. Hold the blade and unscrew the blade bolt counterclockwise using a spanner wrench. Remove the washer and the blade.
3. Inspect the blade adaptor on any signs of damage.
4. Fit a new blade, locate the blade on the two studs on the blade flange and then replace the washer and bolts.
5. Check the washer is still slightly domed to keep the pressure on the bolt to stop it unwinding, keeping the blade firmly secure. Then replace the washer (right way around!) and bolts.
6. Make sure the blade is correctly located, and then firmly tighten the bolt. Do not over tighten. The up turn of the blade must project into the motor compartment.

Frequently Asked Questions

10

FAULT	POSSIBLE CAUSES	TROUBLESHOOTING
Heavy vibration when running	Screws are loose	Check screws
	Blade fasteners are loose	Check blade fasteners
	Blade is unbalanced	Replace blade
Engine does not start	Start/stop bar not pressed	Press start/stop bar
	Primer bulb is empty	Press primer bulb 3-5 times.
	Spark plug is defective	Replace spark plug
	Fuel tank is empty	Refill with fuel
	Engine may be flooded	Remove plug and dry
Engine runs unsteadily	Air filter is soiled	Clean the air filter
	Spark plug is soiled	Clean the spark plug
Uneven mowing results	Blade is blunt	Sharpen the blade
	Cutting height is too low	Set correct height
Unsatisfactory bagging of the grass	Cutting height is too low	Set correct height
	Blade is worn	Replace the blade
	Collection box is clogged	Empty the grass bag

Technical data

Engine type	4 Stroke. Single cylinder
Engine displacement	140cc
Engine max. power	2.1kW/3600rpm
Engine speed	2900rpm
Cutting width	46cm
Collection box capacity	60l
Ignition	T.C.I
Fuel tank	0.8L
Oil tank	0.47L
Sound pressure level	96 dB(A)
Sound power level	80dB(A)
Vibration	7.3m/s^2 K=1.5 m/s^2
Spark type	QC12YC (Champion)
Net weight	26.5kg

STORAGE

Storing the Lawnmower for Short Periods

The lawnmower can be stored for short periods of time (less than 15 days) without performing any storage maintenance.

Before placing the lawnmower into storage always carry out the following:

- Allow the engine to fully cool.
- Ensure the Collection box is empty.
- Clean all debris from under the mower deck.
- Store the lawnmower on a flat and level surface with all 4 wheels on the ground upright.
- Store in a safe place which is not accessible by children or people who are not familiar with operation.

Warning

Do not empty the petrol tank in enclosed areas, near fire or when smoking. Petrol fumes can cause explosions and fire

Storing the Lawnmower for Extended Periods

If the lawnmower is to be placed into storage for more than 15 days, storage maintenance must be performed on the lawnmower. If the following steps are not carried out, when you next operate the lawnmower it may not start correctly and may need to be serviced.

Note! Do not empty the petrol tank in enclosed areas, near fire or when smoking. Petrol fumes can cause explosions and fire.

1. Empty the petrol tank with a petrol suction pump if available.
2. Start the engine and let it run until any remaining petrol has been used up.
3. Change the oil at the end of every season. To do so, remove the used engine oil from a warm engine and refill with fresh oil.
4. Remove the spark plug from the cylinder head. Fill the cylinder with approx. 20 ml of clean engine oil from an oil can. Slowly pull back the starter handle, which will bathe the cylinder wall with oil. Screw the spark plug back in.
5. Clean the cooling fins of the cylinder and the housing.

6. Be sure to clean the entire machine to protect the paint.
7. Store the machine in a well-ventilated place.

Waste disposal

The equipment and its accessories are made of various types of material, such as metal and plastic. Defective components must be disposed of as special waste. Ask your dealer or your local council.

SUMEC

Declaration of CE Conformity

We

SUMEC Hardware & Tools Co., Ltd.
1 Xinghuo RD., Nanjing, China
And our branch office
SUMEC UK Co., Ltd.
Unit A&B, Escrick Business Park
Escrick, York YO 19 6FD

Declare that the product
Gasoline Lawn Mower
Model No: XSZ46I
Function: Cutting grass
Serial number :00001-04744

Complies with the following directives:

EMC Directive: 2004/108/EC
Machinery Directive: 2006/42/EC
Noise Directive: 2000/14/EC amended by 2005/88/EC

Standards conform to:

EN ISO 14982:2009
EN 836:1997+A4

We additionally confirm the following in accordance with the
2000/14/EC emissions guideline:

Conformity Assessment Procedure as Per Annex VI,
Measured sound capacity level :94.91 dB (A)
Guaranteed sound capacity level: 96 dB (A)

Authorized Signatory

Date: 2014-02-10

Signature:

Name: Cai Ji Bo

General Manager
SUMEC Hardware & Tools Co., Ltd.



