



User Manual

Great care has gone into the manufacture of this product and it should therefore provide you with years of good service when used properly. In the event of product failure within its intended use over the course of the first 3 years after date of purchase, we will remedy the problem as quickly as possible once it has been brought to our attention. In the unlikely event of such an occurrence, or if you require any information about the product, please contact us via our helpline support services, details of which are to be found both in this manual and on the product itself.

GB

PRODUCED IN CHINA FOR:
ALDI STORES LTD. PO BOX 26, ATHERSTONE
WARWICKSHIRE, CV9 2SH.
Visit us at www.aldi.com

AFTER SALES SUPPORT

809147



GB +44 (0) 1904727501



support@coreservice.co.uk

MODEL:
IS08

10/2021

3
YEAR
WARRANTY

FERREX®

20 V LI-ION CORDLESS IMPACT DRIVER



Original User Manual

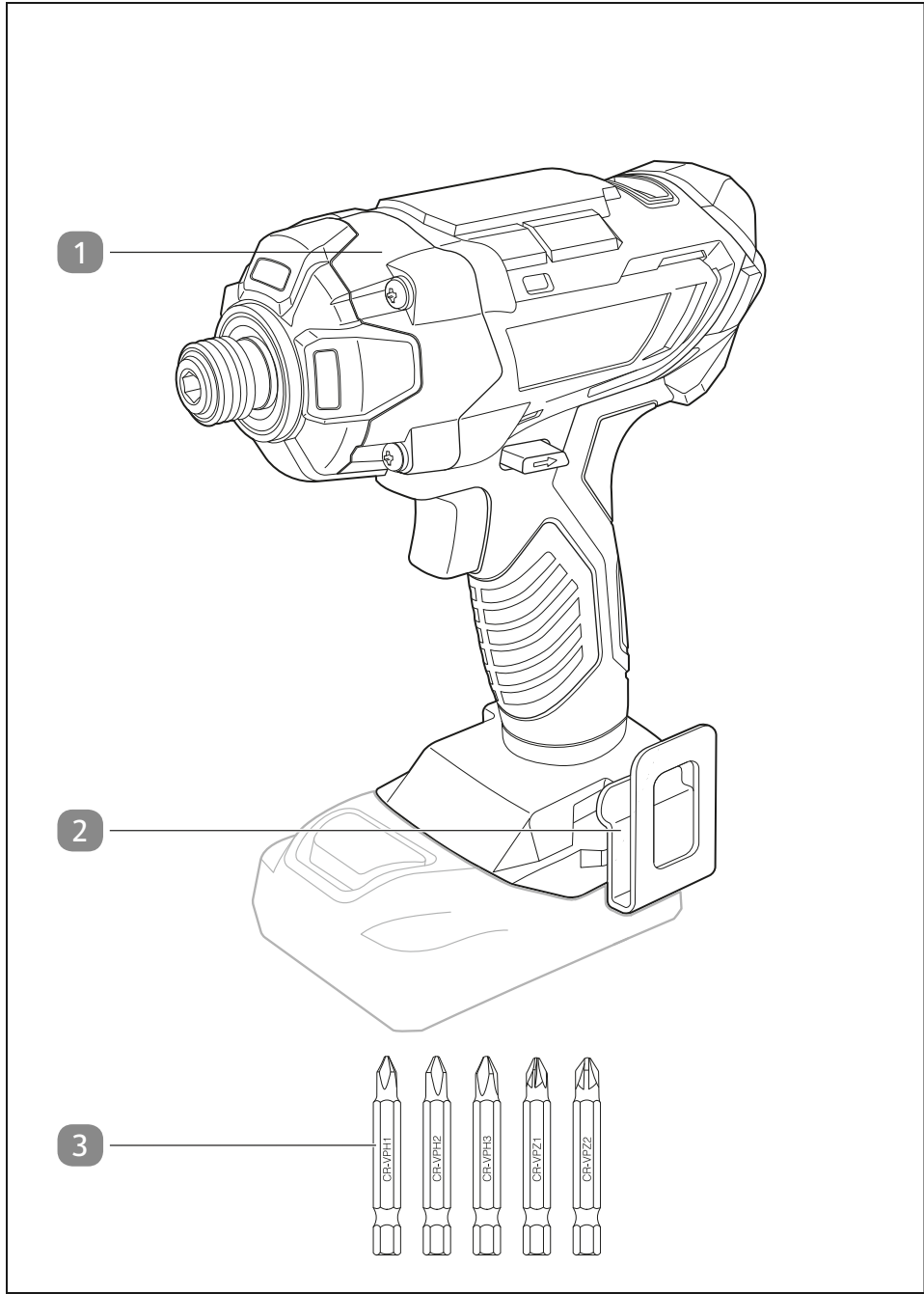

Scope of delivery

1 Cordless Impact Driver

2 Beltclip

3 Bit set

Operating manual and warranty card (not depicted)

Table of content

Overview	2
Scope of delivery	3
General information	5
Reading and storing the operating manual.....	5
Proper use.....	5
Explanation of symbols	6
Safety	6
General safety notes for power tools.....	7
Special safety instructions for the impact driver.....	11
Additional safety notes for power tools.....	11
Operating Controls	13
Before first use	14
Check the device and scope of delivery.....	14
Cleaning the device and accessories.....	14
Attaching the belt clip.....	14
Operation	15
Inserting bits.....	15
Insert / Remove Battery.....	15
Tightening and loosening screws.....	16
Cleaning	17
Maintenance	17
Testing	17
Storage	17
Troubleshooting	18
Technical data	18
Declaration of conformity	20
Disposal	22
Disposing of packaging.....	22
Dispose of old electrical device.....	22

General information

Reading and storing the operating manual



This operating manual is part of the 20V Li-Ion Cordless Impact Driver (hereinafter also called "device"). It contains important information on how to set up and use the product.

Before using the device, read the operating manual carefully, in particular the safety instructions. Failure to follow this operating manual may lead to severe injuries or product damage.

This user manual is based on the standards and regulations that are valid within the European Union. Outside the EU, please also note the country-specific directives and laws.

Keep this operating manual for future reference. If you pass this device on to a third party, you must also supply this operating manual.

Residual risks

Despite proper use, hidden residual risks cannot be completely excluded.

Depending on the type of device, the following risks may occur:

- Health risks which may result from vibration emissions if the device is used for a long period of time or is not properly used or maintained.
- Injuries and material damage, which are caused by the moving blade or breaking tool heads.
- Health risks may result from working with toxic or hazardous materials (eg. asbestos) or if appropriate personal protection, due to hazardous material use, is not applied.

Proper use

This device is designed for tightening or loosening screwed connections..

This device is intended for private use only and is not suitable for commercial use. Use the device only as described in this operating manual. Any other use is improper and may lead to product damage or even personal injury. This device is not a toy.

The manufacturer or retailer assume no liability for damage caused by improper or incorrect use.

Explanation of symbols

Explanation of symbols

The following symbols and signal words are used in this user manual, on the device or on the packaging.



This symbol provides you with useful additional information on handling and use.



Declaration of conformity (see chapter “Declaration of conformity”): Products marked with this symbol meet all the applicable Community regulations of the European Economic Area.



The new UKCA (UK Conformity Assessed) marking declares that the product conforms to all applicable U.K. legislative requirements and that appropriate conformity assessment procedures have been successfully completed.



Read the operating manual.



Wear protective goggles.



Wear hearing protection.



Wear a dust mask.

Safety

The following signal words are used in this operating manual.

 **WARNING!**

This signal symbol/word denotes a hazard with an average risk level that could lead to death or severe injury if it is not avoided.

▲ CAUTION!

This signal symbol/word denotes a hazard with a low risk level that could lead to mild or moderate injury if it is not avoided.

NOTE!

This signal word provides a warning about potential material damage.

General safety notes for power tools**▲ WARNING!**

Read all safety notes, instructions, illustrations and technical data provided with this power tool. Failure to follow the instructions below may result in electric shock, fire and/or serious injury.

Keep all safety notes and instructions for future reference.

The term "power tool" used in the safety notes refers to both mains-operated power tools (with power cord) and battery-powered power tools (without power cord).

Workplace safety

- **Keep your work area tidy and well lit.** *Clutter or unlit work areas can lead to accidents.*
- **Do not operate power tools in explosive atmospheres, such as in the presence of flammable liquids, gases or dust.** *Power tools create sparks which may ignite the dust or fumes.*
- **Keep children and bystanders away while operating a power tool.** *Distractions can cause you to lose control.*

Electrical safety

- **Power tool plugs must match the outlet. Never modify the plug in any way. Do not use any adapter plugs with**

earthed (grounded) power tools. *Unmodified plugs and matching outlets will reduce risk of electric shock.*

- **Avoid body contact with earthed or grounded surfaces, such as pipes, radiators, ranges and refrigerators.** *There is an increased risk of electric shock if your body is earthed or grounded.*
- **Do not expose power tools to rain or wet conditions.** *Water entering a power tool will increase the risk of electric shock.*

Personal safety

- **Stay alert, watch what you are doing and use common sense when operating a power tool. Do not use a power tool while you are tired or under the influence of drugs, alcohol or medication.** *A moment of inattention while operating power tools may result in serious personal injury.*
- **Use personal protective equipment. Always wear eye protection.** *Protective equipment such as a dust mask, non-skid safety shoes, hard hat or hearing protection used for appropriate conditions will reduce personal injuries.*
- **Prevent unintentional starting. Ensure the switch is in the off-position before connecting to power source and/or battery pack, picking up or carrying the tool.** *Carrying power tools with your finger on the switch or energising power tools that have the switch on invites accidents.*
- **Remove any adjusting key or wrench before turning the power tool on.** *A wrench or a key left attached to a rotating part of the power tool may result in personal injury.*
- **Do not overreach. Keep proper footing and balance at all times.** *This enables better control of the power tool in unexpected situations.*

- **Dress properly. Do not wear loose clothing or jewellery. Keep your hair and clothing away from moving parts.** *Loose clothes, jewellery or long hair can be caught in moving parts.*
- **If devices are provided for the connection of dust extraction and collection facilities, ensure these are connected and properly used.** *Use of dust collection can reduce dust-related hazards.*
- **Do not let familiarity gained from frequent use of tools allow you to become complacent and ignore tool safety principles.** *A careless action can cause severe injury within a fraction of a second.*

Using and handling the power tool

- **Do not overload the power tool. Use the appropriate power tool for your work.** *The right power tool allows you to work better and safer in the specified power range.*
- **Do not use any power tool that has a defective switch.** *Power tools that can no longer be switched on or off are dangerous and must be repaired.*
- **Disconnect the plug from the socket and/or remove any removable batteries before making adjustments to the device, changing any insert tool parts, or putting the power tool away.** *This precaution helps prevent unintentional starting of the power tool.*
- **Keep power tools out of the reach of children when not in use. Whoever is not familiar with the power tool or who has not read these instructions should not be allowed to use it.** *Power tools are dangerous if used by inexperienced persons.*
- **Power tools and insert tools must be subject to careful maintenance. Check whether moving parts function**

properly without jamming, and whether parts are broken or damaged to such an extent that they impair the functions of the power tool. Have damaged parts repaired before using the power tool. *Many accidents happen due to poorly maintained power tools.*

- **Keep cutting tools sharp and clean.** *Carefully maintained cutting tools with sharp blades tend to jam less and are easier to guide.*
- **Use power tools, insert tools, insert tool parts, etc. according to these instructions. While doing so, take into account the working conditions and the activity to be performed.** *The use of power tools for applications other than those intended can lead to dangerous situations.*
- **Keep handles and grip surfaces dry, clean and free of oil and grease.** *Slippery handles and grip surfaces hinder safe operation and control of the power tool in unforeseen situations.*

Using and handling the cordless tool

- **Only charge the batteries using chargers recommended by the manufacturer.** *Chargers suitable for a particular type of battery may present a fire hazard if used with other batteries.*
- **Only use purposely provided batteries in the power tools.** *The use of other batteries may lead to injuries and present a fire hazard.*
- **Keep unused batteries away from paper clips, coins, keys, nails, screws, or other small metal objects that could short the contacts.** *A short circuit between the battery contacts can cause burns or fire.*
- **If used incorrectly, fluid may leak from the battery. Avoid touching it. In case of accidental contact, rinse with water.**

If the fluid gets into your eyes, seek additional medical attention. *Leaking battery fluid may cause skin irritation or burns.*

- **Do not use a damaged or modified battery.** *Damaged or modified batteries may behave unpredictably and cause fire, explosion or injury.*
- **Do not expose batteries to fire or excessive temperatures.** *Fire or temperatures above 130 °C may cause an explosion.*
- **Follow all charging instructions and never charge the battery or cordless tool outside the temperature range specified in the operating manual.** *Incorrect charging or charging outside the permitted temperature range can destroy the battery and aggravate the fire hazard.*

Service

- **Have your power tool serviced by a qualified repair person using only identical replacement parts.** *This will ensure that the safety of the power tool is maintained.*
- **Never service damaged battery packs.** *Service of battery packs should only be performed by the manufacturer or authorized service providers.*

Special safety instructions for the impact driver

- **Hold the device by the insulated handle surfaces when performing work where there is a risk of the screw coming into contact with hidden power lines.** *If the screw comes into contact with a voltage-carrying line, metallic parts of the device could be energised as a result and inflict an electric shock.*

Additional safety notes for power tools

- Keep the device and its accessories away from hot surfaces.

Safety

- Do not let inexperienced persons or persons with physical, motor or mental impairments use the device and its accessories unsupervised.
- Children must not play with, clean or service the device and its accessories.
- Only use tools that fit into the power tool's retaining system.
- Let the tool cool down after use before touching it.
- Always wait until all moving parts come to a standstill after working with the tool.

Use and care of the battery

- Clean the battery and device contact pins with abrasive paper if necessary.
- Battery maintenance must be undertaken exclusively by the manufacturer or a service partner named by of the manufacturer.
- Do not drop or expose the battery to mechanical impacts.
- Never short circuit, disassemble or try to reactivate the battery.

⚠ WARNING!

Mortal danger through electromagnetic field.

The electromagnetic field that occurs during operation may, under certain circumstances, adversely affect active or passive medical implants.

- Consult your doctor or the manufacturer of the medical implant before operating the device.

Operating Controls

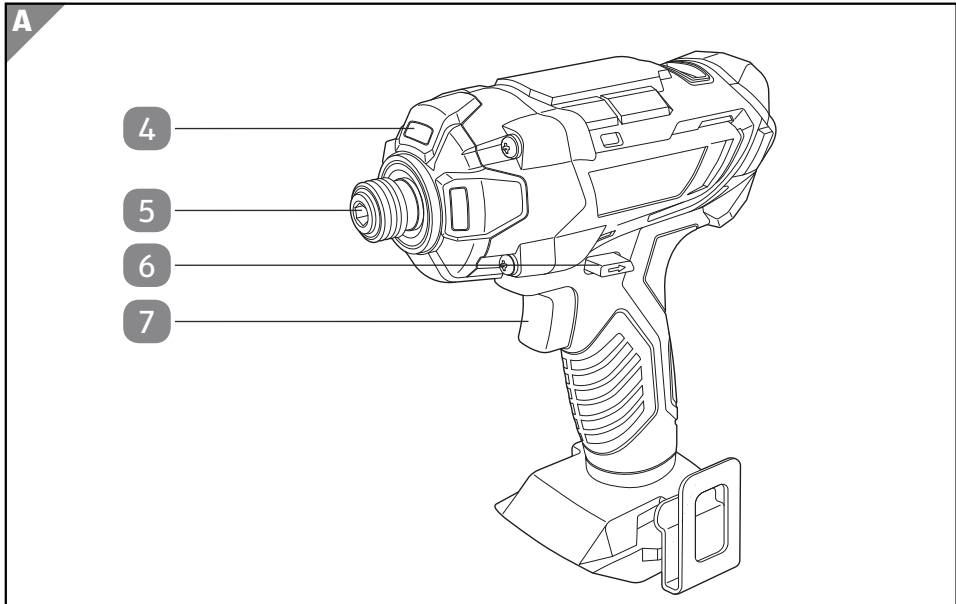

LED-light

The LED light **4** illuminates the working area in front of the chuck. The light is activated automatically when pushing the power switch **7**.

Direction switch

The direction switch **6** changes the rotating direction or blocks the power switch **7**.

- Position the direction switch to left, the bit support **5** rotates clockwise.
- Position the direction switch to right, the bit support rotates counter clockwise.
- Center position, blocks the power switch **7**.

Power switch

The power switch **7** activates the device and electronically controls the rotation speed. Firmly push the power switch for low rotation speed. Rotation speed is proportionally increased up to full speed by pushing the switch to full rearward position.

Before first use

Check the device and scope of delivery

NOTE!

Risk of damage!

If opening the packaging with a sharp knife or other pointed objects, careless handling can damage the device.

- Therefore, be very careful when opening.
1. Take the device out of the packaging.
 2. Check that the delivery is complete (see chapter "Scope of delivery").
 3. Inspect the device and individual parts for damage. Do not operate a damaged device; instead, contact the manufacturer via the service center listed on the warranty card.

Cleaning the device and accessories

1. Remove the packaging and all protective film.
2. Clean the device and accessories before using them for the first time.

⚠ CAUTION!

Risk of injury!

A damaged device or damaged accessories can lead to injuries.

- Check the device and the accessories (see section "Testing").

Attaching the belt clip



The belt clip can be attached to either side of the device.

1. Place the belt clip on the left or on the right side of the handle.
2. Fix the belt clip using the screw.

Operation

⚠ CAUTION!

Risk of injury!

A damaged device or damaged accessories can lead to injuries.

- Check the device and the accessories (see section "Testing").

This chapter describes how to operate the device. The following instructions for use serve for your own safety and for successful, safe use of the device.

General information for the battery and charger

- Only use suitable batteries (see chapter "Technical Data") and chargers approved by the manufacturer.
- The device has undervoltage detection. If the battery is empty, the device switches off.
- Read and follow the instructions in the operating manuals of the battery and charger used.
- To charge the battery, follow the instructions in the operating manuals of the battery and charger you are using.
- The battery must not be inserted before you make device settings, change tool insert parts or put the power tool away.



During a work break you can clip the device **1** to your belt by using the belt-clip **2**.

Inserting bits

1. Hold the bit support **5** between your thumb and finger and pull it towards the device.
2. Insert a bit into the bit holder as far as possible.
3. Release the bit support.

The bit is inserted.

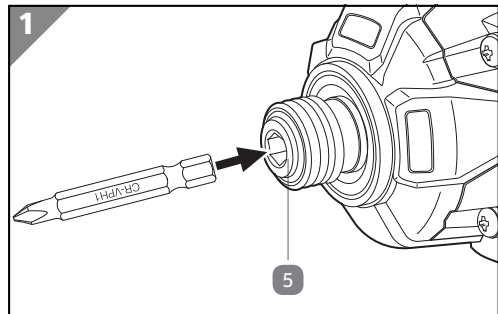

Insert / Remove Battery

Changing the battery corresponds to the sequence of removing the battery followed by inserting the battery.

⚠ CAUTION!

Fire and explosion hazard through reverse polarity or short circuiting

- Only use suitable batteries (see chapter "Technical Data") approved by the manufacturer.

Only use undamaged batteries.

Remove Battery

1. Press and hold the battery unlock key **8**.
2. Pull the battery **10** out of the battery holder **9**.

If the battery cannot be removed easily, the battery unlock key **8** has not been pressed enough. Press the battery unlock key more firmly.

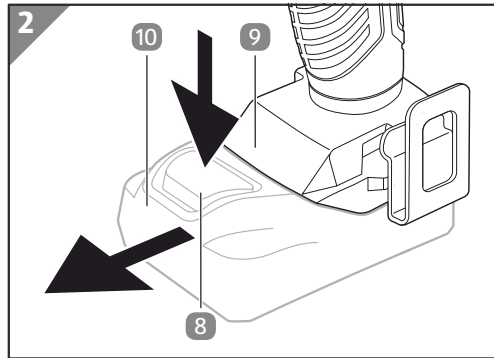

Insert Battery

1. Place the battery **10** on the front edge of the battery holder **9**.
2. Align the battery with the guides of the battery holder.
3. Slide the battery into the battery holder until it locks in
You will hear a "Click" when the battery lock engages.
4. Check that the battery is firmly inserted.

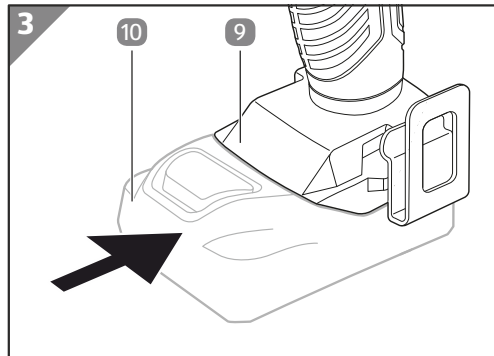

Tightening and loosening screws

1. Insert a bit into the bit holder **5** (see chapter „Inserting bits“).
2. Choose the direction of rotation (see chapter „Direction switch“).
3. Put the bit onto the screw / nut.
4. Press the power switch **7**. You can adjust the torque continuously by pressing the power switch more or less intensively.

5. Release the power switch as soon as the screw / nut is in the desired position.

Cleaning

1. Switch off the device **1** remove the battery **10** from the battery holder **9**.
2. Let the device and the accessory tool cool down completely.
3. Clean the housing with a soft, slightly damp cloth.
4. Clean the connection contacts of the battery holder with a dry, clean cloth.
5. Dry the device thoroughly and leave it to dry completely for a while.

Maintenance

The device and accessories are maintenance-free!



Do not lubricate the device. Dust and chips will deposit on a film of grease and increase wear!

Testing

Regularly inspect the device and its accessories to ensure that they are in fault-free condition and

- inspect the controls for damage.
- ensure that the accessories are in perfect condition.
- check that the vents are open and clean.

Do not operate a damaged device or accessory. Have the damaged device or accessory checked and repaired by an authorised service centre.

Storage

NOTE!

Risk of damage!

Improper storage of the device can result in damage.

- Allow the device to completely cool down.
 - Place the device so that it can't fall into water.
 - Store the device in a clean, dry, frost-protected place out of the reach of children.
1. Thoroughly clean the device (see "Cleaning").
 2. Always store device parts and accessories together with the device.
 3. If possible, pack the device in the original packaging.

Troubleshooting

Problem	Possible cause	Troubleshooting
The device 1 can not start.	The battery charge is too weak.	Charge the battery 10 .
	The battery 10 is not inserted correctly.	Slide the battery into the battery holder 9 as far as it will go until it clicks into place.
	The direction switch 6 is in the middle position.	Press the direction switch all the way in.

If the problem persists, contact the customer service listed on the last page.

Technical data

Model:	IS08
Item number:	809147
Idle speed n_0 :	0 to 2300 min ⁻¹
Blow count per minute:	0 to 3200 min ⁻¹
Maximum torque:	150 Nm
Chuck:	1/4" (hexagonal)
supplied Bits (each x1):	PH1, PH2, PH3, PZ1, PZ2
Sound pressure level L_{pA} :	77.00 dB(A)
Correction value K:	3 dB(A)
Sound power level L_{wA} :	88.00 dB(A)
Correction value K:	3 dB(A)
Hand-arm vibration ah:	1,08 m/s ²
Correction value K:	1,5 m/s ²

Noise/vibration information**▲ WARNING!****Health hazard!**

Working without hearing protection or protective clothing can damage your health.

- Wear hearing protection and appropriate protective clothing when working.

The specified total vibration value and the specified noise emission values have been measured according to a standardized test method (EN62841-1/EN62841-2-1) and can be used to compare one power tool with another. They can also be used for a preliminary assessment of exposure.

Measured according to DIN EN 62841-2-1. The noise level of 85 dB (A) is not exceeded. Protective measures are nevertheless recommended for the user (wear suitable hearing protection).

Also take into account possible deviations in the national regulations for the permitted workplace values.

Warning!

The vibration and noise emissions can deviate from the stated values during actual use of the power tool. This depends on the way the power tool is actually used and especially on the type of workpiece you are working on.

It is necessary to establish safety measures that protect the operator based on an estimate of the exposure during actual conditions of use (taking into account all parts of the operating cycle, such as periods when the power tool is switched off and periods when it is switched on but running without load).

Try to keep the exposure to vibrations and noise as low as possible. Examples of measures to reduce the exposure:

- wearing vibration-damping gloves while using the tool;
- limiting the working time;
- using accessories in good condition;
- regular maintenance and cleaning of the device;
- turning the device off while not in use;
- preventing overload of the device.

Declaration of conformity

Declaration of conformity

Original EU Declaration of Conformity

We,

MEROTEC GmbH
Otto-Brenner-Str. 8, D-47877 Willich, Germany

herewith declare under our own, sole responsibility that our product

20 V Impact Driver
Model no. IS08
for driving screws

complies with the following directives:

2006/42/EC Machinery Directive
2014/30/EU EMC-Directive
2011/65/EU^{*)} RoHS-Directive, amended by (EU) 2015/863

Applied harmonized standards:

EN 62841-1:2015
EN 62841-2-2:2014
EN 55014-1:2017+A11:2020
EN 55014-2:2015
EN 62233:2008
EN 62471:2008

Document representative:
Dirk Wohlrab
MEROTEC GmbH
Otto-Brenner-Str. 8
D-47877 Willich



Place, date: Willich, 02.06.2021
Authorised Signature:

Ronald Menken
General Manager
MEROTEC GmbH

^{*)}The object of the declaration described above is in conformity with Directive 2011/65/EU of the European Parliament and of the Council of 8 June 2011 on the restriction of the use of certain hazardous substances in electrical and electronic equipment.

Original UK Declaration of Conformity

We,

MEROTEC GmbH
Otto-Brenner-Str. 8, D-47877 Willich, Germany

herewith declare under our own, sole responsibility that our product

20 V Impact Driver
Model no. IS08
for driving screws

complies with the following regulations:

Supply of Machinery (Safety) Regulations 2008
Electromagnetic Compatibility Regulations 2016
The Restriction of the Use of Certain Hazardous Substances in Electrical and Electronic Equipment
Regulations 2012

Applied harmonized standards:

EN 62841-1:2015
EN 62841-2-2:2014
EN 55014-1:2017+A11:2020
EN 55014-2:2015
EN 62233:2008
EN 62471:2008

Document representative:
Dirk Wohlrab
MEROTEC GmbH
Otto-Brenner-Str. 8
D-47877 Willich

Place, date: Willich, 02.06.2021
Authorised Signature:

Ronald Menken
General Manager
MEROTEC GmbH

**UK
CA**

Disposal

Disposing of packaging



Dispose of packaging according to type. Sort the paperboard and cardboard as waste paper and the film as recyclable material.

Dispose of old electrical device

Applicable in the European Union and other European countries with systems for separate collections of recyclable waste.



This symbol indicates that this product may not be disposed of together with domestic waste in compliance with the (2012/19/EU) Regulation pertaining to waste electrical and electronic devices (WEEE).

This product must be handed in at a collection point intended for the purpose. This can occur, for example, by handing it in at an authorised collecting point for the recycling of waste electrical and electronic equipment. Owing to potentially hazardous substances that are frequently contained in waste electronic equipment, incorrect handling of waste equipment may have a negative impact on the environment and on the health of human beings. By disposing of this product correctly, you are also contributing towards an efficient use of natural resources. Information on collecting points for waste equipment can be obtained from your local authority, an authorised institution for the disposal of waste electrical and electronic equipment or the waste collection services.



Batteries and rechargeable batteries must not go in domestic waste!

As a consumer you are legally obliged to dispose of all batteries, irrespective of whether they contain harmful substances* or not, at a collection point in your community/district or at a retail outlet, so that they can be disposed of in an environmentally friendly manner.

* marked with: Cd = Cadmium, Hg = Mercury, Pb = Lead, Li = Lithium.