

CHALLENGE

2800W Blower and Vac

Original Instructions
Please retain for future reference

Model: CEBLV2840



Technical Support & Parts
01904 727508



challenge[®]

WARNING Important-Please read these instructions fully before starting assembly.

These instructions contain important information that will help you get the best from your product, ensuring it is assembled correctly and safely.

If you need help or have damaged or missing parts, call the Customer Helpline on 01904 727508.
SAN NO.: 0321/8AAA/B021

CONTENTS

Safety information	3
Intended use	10
Parts list	11
Assembly	12
Operation.....	14
Maintenance.....	17
Technical data.....	18
Trouble shooting.....	20
Guarantee.....	21

Produced in China.

Argos Limited

489-499 Avebury Boulevard, Milton Keynes, MK9 2NW.

Argos (N.I.) Ltd, Forestside Shopping Centre,

Upper Galwally, Belfast, United Kingdom, BT8 6FX.

Argos Distributors (Ireland) Limited,

Unit 7, Ashbourne Retail Park, Ballybin Road,
Ashbourne, County Meath, Ireland.

www.argos.co.uk



SAFETY INFORMATION

Description Of Symbols

Some of the following symbols may be marked on the product and indicate the appropriate safety measures you should take when operating and maintaining the product.



Caution/Warning.



Read instruction manual.



Keep bystanders away.



Switch off! Remove plug from mains before cleaning or maintenance.



Disconnect the mains plug if the cord becomes damaged or entangled.



Do not expose and operate the product to rain or wet conditions.



Do not open or remove safety shields while motor is running.



Danger-Risk of severing of fingers or hand - Impeller blade.



Wear hearing protection.



Wear protective gloves.



SAFETY INFORMATION

Description Of Symbols



Wear eye protection.



Wear protective, slip-resistant footwear.



Wear respiratory protection.



Keep a safety distance of at least 5m from bystanders.



Guaranteed sound power level value in 105 dB (A).



WEEE symbol. Waste electrical products should not be disposed of with household waste. Please recycle where facilities exist. Check with your local authority or retailer for recycling device.



Conforms to relevant EU regulatory requirements



Conforms to relevant UK regulatory requirements



This product is of protection class II. That means it is equipped with enhanced or double insulation.



SAFETY INFORMATION

Safety Warnings



WARNING! These instructions are for your safety. Please read through them thoroughly before use and retain them for future reference.



WARNING! Read all safety warnings and all instructions. Failure to follow the warnings and instructions may result in electric shock, fire and/or serious injury. Carefully read the instructions for the safe operation of the machine. Save all warnings and instructions for future reference.



WARNING! This appliance **MUST NOT** be used by children and persons with reduced physical, sensory or mental capabilities, or lack of experience and knowledge, unless they have been given supervision or instruction concerning use of the appliance by a person responsible for their safety. Local regulations can restrict the age of the operator.



WARNING! Never operate the machine while people, especially children, or pets are nearby.



WARNING! Children shall not play with the appliance.



WARNING! Do not touch moving hazardous parts before the machine is disconnected from the mains and the moving hazardous parts have come to a complete stop.



WARNING! Never to operate the machine with defective guards or shields, or without safety devices, or if the cord is damaged or worn.

SAFE OPERATING PRACTICES FOR HAND-HELD MAINS-OPERATED ELECTRICAL GARDEN BLOWER/VACUUMS



IMPORTANT! READ CAREFULLY BEFORE USE KEEP FOR FUTURE REFERENCE.



SAFETY INFORMATION

Training

- Read the instructions carefully. Be familiar with the controls and the correct use of the machine.
- Never allow children or people unfamiliar with these instructions to use the machine. Local regulations can restrict the age of the operator.
- Keep in mind, that the operator or user is responsible for accidents or hazards occurring to other people or their property.

Preparation

- Obtain ear protection and safety glasses. Wear them at all times while operating the machine.
- While operating the machine always wear substantial footwear and long trousers. Do not operate the machine when barefoot or wearing open sandals. Avoid wearing clothing that is loose fitting or that has hanging cords or ties.
- Do not wear loose clothing or jewellery that can be drawn into the air inlet. Keep long hair away from the air inlets.
- Operate the machine in a recommended position and only on a firm, level surface.
- Do not operate the machine on a paved or gravel surface where ejected material could cause injury.
- Before using, always visually inspect to see, that the securing, bolts and other fasteners are secure, the housing is undamaged and that guards and screens are in place. Replace worn or damaged components in sets to preserve balance.
- Before use, check the supply cord for signs of damage or aging. If the cord becomes damaged during use, disconnect the cord from the supply immediately. **DO NOT TOUCH THE CORD BEFORE DISCONNECTING THE SUPPLY.** Do not use the machine if the cord is damaged or worn. If the supply cord is damaged, it must be replaced by the manufacturer, its service agent or similarly or qualified in order to avoid a hazard.
- Never operate the machine while people, especially children, or pets are nearby.



SAFETY INFORMATION

Operation

- Before starting the machine, make certain that the feeding chamber is empty.
- Keep your face and body away from the feed intake opening.
- Do not allow hands or any other part of the body or clothing inside the feeding chamber, discharge chute, or near any moving part.
- Keep proper balance and footing at all times. Do not overreach. Never stand at a higher level than the base of the machine when feeding material into it.
- Always stand clear of the discharge zone when operating this machine.
- When feeding material into the machine be extremely careful that pieces of metal, rocks, bottles, cans or other foreign objects are not included.
- If the shredding mechanism strikes any foreign objects or if the machine should start making any unusual noise or vibration, immediately shut off the power source and allow the machine to stop. Disconnect the machine from the supply and take the following steps before restarting and operating the machine:
 - inspect for damage;
 - replace or repair any damaged parts; (refer to trouble shooting section)
 - check for and tighten any loose parts.
- Do not allow processed material to build up in the discharge zone; this may prevent proper discharge and can result in kickback of material through the intake opening.
- If the machine becomes clogged, shut-off the power source and disconnect the machine from supply before cleaning debris.
- Never operate the machine with defective guards or shields, or without safety devices, for example debris collection bag in place.
- Keep the power source clean of debris and other accumulations to prevent damage to the power source or possible fire.
- Do not transport this machine while the power source is running.
- Stop the machine, and remove plug from the socket. Make sure that all moving parts have come to a complete stop
 - whenever you leave the machine;
 - before clearing blockages or unclogging chute;
 - before checking, cleaning or working on the machine.
- Do not tilt the machine while the power source is running.
- Switch-off the machine before attaching or removing the debris collection bag.



SAFETY INFORMATION

Maintenance And Storage

- When the machine is stopped for servicing, inspection, storage, or to change an accessory, shut off the power source, disconnect the machine from the supply and make sure that all moving parts have come to a complete stop. Allow the machine to cool before making any inspections, adjustments, etc. Maintain the machine with care and keep it clean.
- Store the machine in a dry place out of the reach of children.
- Always allow the machine to cool before storing.
- When servicing the shredding fan be aware that, even though the power source is switched off due to the interlock feature of the guard, the shredding fan can still be moved.
- Replace worn or damaged parts for safety. Use only genuine replacement parts and accessories. (call customer helpline on 01904 727508)

Recommendation

- The machine should be supplied via a residual current device (RCD) with a tripping current of not more than 30 mA.
- If the supply cord is damaged, it must be replaced by the manufacturer, its service agent or similarly qualified person in order to avoid a hazard.
- Supply cords shall not be lighter than
 - if rubber insulated, ordinary tough rubber sheathed flexible cord (code designation H05 RN-F)
 - if polyvinyl chloride insulated, ordinary polyvinyl chloride sheathed flexible cord (code designation H05 VV-F)

Emergency



WARNING!

Familiarize yourself with the use of this machine by means of this instruction manual. Memorise the safety directions and follow them to the letter. This will help to prevent risks and hazards.

- Always be alert when using the machine, so that you can recognise and handle risks early. Fast intervention can prevent serious injury and damage to property.
- Switch off and disconnect from the power supply if there is any malfunction. Have the machine checked by a qualified specialist and repaired, if necessary, before you put it into operation again.



SAFETY INFORMATION

Maintenance And Storage



WARNING!

Even if you are operating the machine in accordance with all safety requirements, potential risks of injury and damage remain. The following dangers can arise in connection with the structure and design of this machine:

- Health defects resulting from vibration emission if the machine is being used over long periods of time or not adequately managed and properly maintained.
- Injuries and damage to property due to broken application tools or sudden impact of hidden objects during use.
- Danger of injury and property damage caused by flying objects. Do not abuse the supply cord. Never use the supply cord for carrying, pulling or unplugging the machine. Keep the supply cord away from heat, oil, sharp edges or moving parts. Damaged or entangled supply cords increase the risk of electric shock.

Intended Use

This product is not intended for use by persons (including children) with reduced physical, sensory or mental capabilities, or lack of experience and knowledge, unless they have been given supervision or instruction concerning use of the product by a person responsible for their safety.

Children should be supervised to ensure that they do not play with the product.

This device is intended solely to blow or collect leaves in private gardens. Any other use not expressly permitted in these instructions may result in damage and may pose a serious hazard to the user and is not permitted.

In particular, the unit must never be used:

- On a rainy day or in a humid environment;
- By children under 16;
- By unaccompanied minors.

PART LIST

Parts Description

- | | |
|-------------------------------|-----------------------------------|
| 1. Shoulder strap | 9. Debris collection bag |
| 2. Front handle | 10. Wheel |
| 3. Hook point (for strap) | 11. Upper Vacuum /Blower tube (A) |
| 4. Speed control | 12. Upper Vacuum/Blower tube (B) |
| 5. On/Off trigger | 13. Lower Vacuum /Blower tube (C) |
| 6. Air vents | 14. Screw (ST4*10)X2pcs |
| 7. Cord retainer | 15. Screw (ST4*16)X3pcs |
| 8. Vacuum/Blow selector lever | 16. Instruction manual |

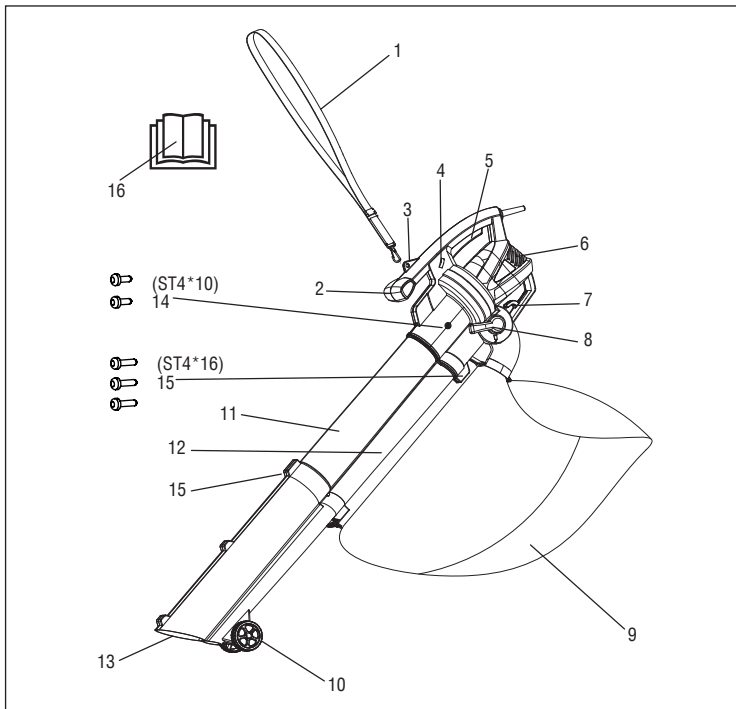

Tools Needed For Assembly

1. PH2 phillips screw driver (not supplied)

ASSEMBLY

Assembly



WARNING: Always switch off tool and unplug from outlet before removing vacuum bag for emptying.

1. Align the tube A and tube B to tube C. Secure the tube with the longer crosshead screws (item 14) in two positions.

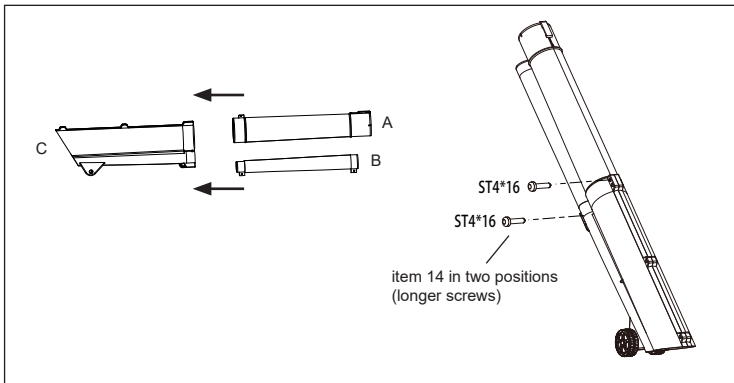

2. Align the vacuum/blower tube assembly to the motor unit and insert them all the way to the stop. Secure the tube and motor unit with shorter crosshead screws (item 13) in two positions and (item 14) in one position.

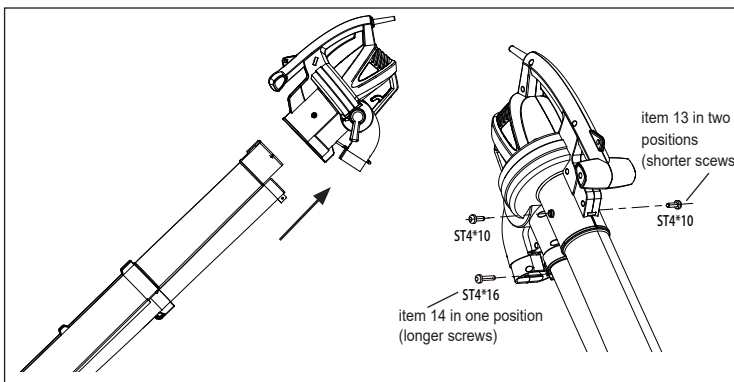

ASSEMBLY

Assembly

NOTE: Ensure that all screws are securely tightened with a phillips(PH2) head screwdriver (not supplied).

Align the collection bag with the outlet nozzle and insert into place. Attach the shoulder strap to the hook, place the shoulder strap over the shoulder, crossing the chest and the back to help the operator carry the product.

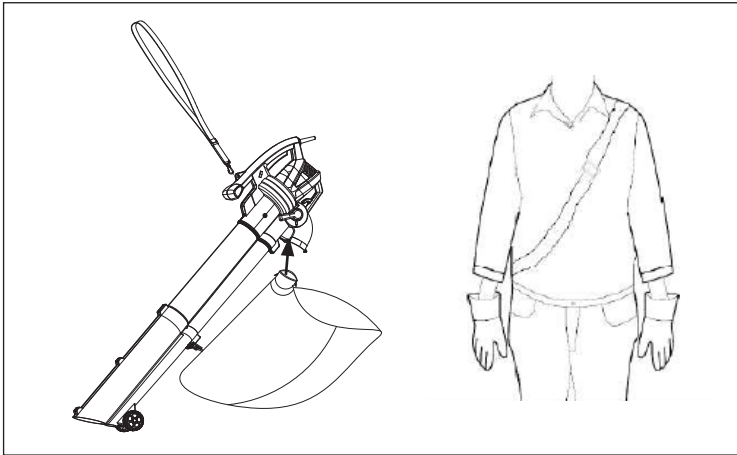

OPERATION

Before Starting

1. Push a loop of cable through the space in the handle and secure it over the cable restraint firmly.
2. Plug the Blower Vac into the mains supply and switch on.

NOTE: Ensure the Blower Vac tube is fitted correctly and attach the debris collection bag firmly .

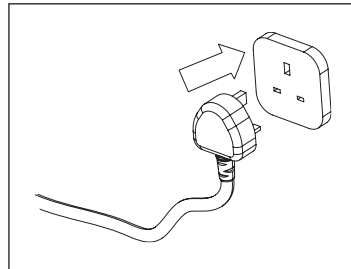
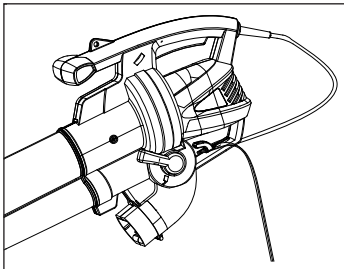

Starting the Blower & Vac

Select either the Vacuum or Blower function using the selector lever (A) on the side of the machine and press the on/off trigger (B). If more power is required, slide the speed controller from position "1" to position "6" (C).

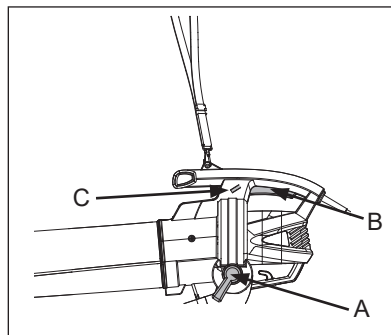

OPERATION

Stopping The Blower & Vac

To turn off the machine you can simply release the on/off trigger.



WARNING: Any hard objects, such as stones, tin cans, glass etc, will damage the suction fan.

Do not use the Blower/Vacuum/Shredder to suck up water or very wet debris. Never operate the Blower/Vacuum/Shredder without the debris collection bag fitted.

Using The Blower Mode

Select the blow function using the selector lever on the side of the machine and switch on. With the Blower Vac resting on its wheels, move it forward directing the nozzle at the debris to be cleared.

Adjust the speed with the speed control dial if more power is required.

Alternatively hold nozzle just above the ground and swing the machine from side to side. Moving forward and direct the nozzle at the debris to be cleared.

Blow the debris into a convenient heap then use the vacuum function to collect the debris.

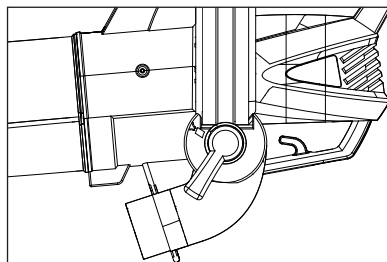

Blower mode(B)

OPERATION

Using The Vacuum Mode

Inspect the working area before starting. Remove any objects or debris that could be thrown, jammed or become entangled.

Select the vacuum function using the selector lever on the side of the machine and switch on.

With the Blower Vac resting on its wheels move the Blower Vac forwards directing the nozzle at the debris to be collected. Alternatively with the Blower & Vac held just above the ground swing the machine from side to side, moving forwards and directing the nozzle at the debris to be collected. Do not force the nozzle into the debris as this will block the suction tube and reduce the efficiency of the machine.

Adjust the speed with the speed control dial if more power is required.



WARNING: Unplug the machine before attempting to clear any blockage and follow instructions detailed on the following pages.



WARNING: Never use water for cleaning your product, use only a dry cloth. Do not clean with chemicals or solvents, some can destroy plastic parts.

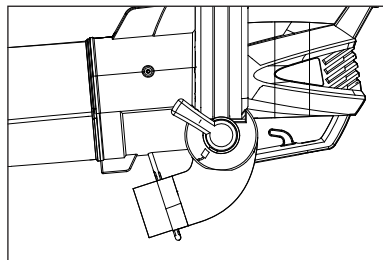

Vacuum mode(A)

MAINTENANCE

Cleaning Debris



WARNING! Always wear gloves when attempting to clear any blockages

1. Switch off and disconnect from the mains electricity supply before cleaning your product.
2. Always empty the collection bag, using the zip.
3. Check the upper tube assembly and lower tube for debris carefully tap the tube to loose the debris.
4. Remove the upper tube from the motor housing first. Wearing gloves, carefully rotate the fan and remove debris by hand. Clean the fan with a soft brush ensuring it is free from debris.
5. Clean the air vents with a soft brush.
6. Refit the tube and collection bag carefully

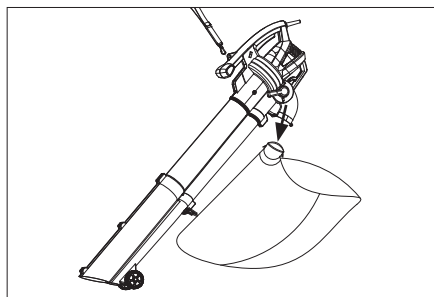

Storing Your Product

Always store the product in a dry place ensuring the supply cord is not likely to be damaged on sharp edges etc.

Maintenance

Our machines have been designed to operate over a long period of time with a minimum of maintenance. Continuous satisfactory operation depends upon proper machine care and regular cleaning.

Keep all nuts, bolts and screws tight to be sure the appliance is in safe working condition.

1. Check the collection bag frequently for wear or deterioration.
2. Replace worn or damaged parts.
3. Use only genuine replacement parts and accessories.
4. Store the appliance in a dry place.

TECHNICAL DATA

Technical Data Table

Model	CEBLV2840
Rated Voltage	230 -240V~/50Hz
Replacement fuse rating	13A
Rated Power	2800W
No-Load Speed	7000-14000 /min
Net Weight	4.1kg
Cable Length	10m
Capacity Of Dust Bag	40L
Tube Length	75cm
Nominal Air Speed (Blower)	up to 58.3m/s
Nominal Air Speed (Vacuum)	up to 23.4m/s
Nominal Air flow (Blower)	up to 13.9m ³ /min
Nominal Air flow (Vacuum)	up to 10.1m ³ /min
Air Flow (Blow/ Vacuum Mode)	10m ³ /min
Vibration	2.702m/s ² K=1.5m/s ²
Measured sound pressure level L _{pA} (Blower)	81.06dB(A)
Measured sound power level L _{wA} (Blower)	101.06dB(A)
Guaranteed sound power level L _{wA} (Blower)	105dB(A)
Measured sound pressure level L _{pA} (Vacuum)	81.06dB(A)
Measured sound power level L _{wA} (Vacuum)	101.06dB(A)
Guaranteed sound power level L _{wA} (Vacuum)	105dB(A)

Spare parts list	
Debris collection bag	CEBLV2840-9
Shoulder strap	CEBLV2840-1
Screws (item 13 and 14)	CEBLV2840-14

TECHNICAL DATA

Technical Data Table

The sound values have been determined according to noise test code given in EN50636-2-100, using the basic standards ISO 11094 and EN ISO 3744. The sound intensity level for the operator may exceed 80dB(A) and ear protection measures are necessary

- The declared vibration value has been measured in accordance with EN50636-2-100 test method and may be used for comparing one product with another.

The declared vibration value may also be used in a preliminary assessment of exposure.

TROUBLESHOOTING



WARNING: Only perform steps outlined below. Disconnect the product from the mains electricity Supply before examining the supply cord for any damage. For further advice contact the customer helpline.

Problem	Possible cause	Solution
Device does not start	Power supply or plug is defective	Disconnect from mains supply check/replace plug fuse. Try an alternative power supply or call customer service.
	Defective on/off switch Worn carbon brushes Defective motor	Repair through customer service
	Impeller fan cover still open (micro-switch open)	Close impeller fan cover and screw it down properly
Device works with interruptions	Damaged power cable	Disconnect from mains electricity. Check cord; call service helpline
	Internal loose connection	Repair through customer service
	Defective on/off switch	
Low suction capacity or suction not present	Collection bag is full	Empty collection bag
	Collection bag is dirty	Clean collection bag
	Selector switch is in the wrong position	Set selector switch to the suction symbol
	Device clogged up or blocked by foreign bodies	Remove blockages (see chapter Cleaning and Maintenance)
Small or missing blowing power	Selector switch in in-correct position	Set selector switch to the blowing symbol
	Speed controller in wrong position	Rotate speed controller to high position
Device works with interruptions	Foreign body blocks impeller wheel	Remove blockage (see chapter Cleaning and Maintenance)

GUARANTEE

Dear Customer,

In the unlikely event that your device develops a fault, please contact our customer service department on the following telephone number shown below (01904 727508).

1. These guarantee terms cover additional guarantee rights and do not affect your statutory warranty rights.

Claims must be accompanied by Proof of Purchase. This must be in the form of a sales receipt or bank statement and must show that the product has been purchased within 1 years prior to the claim, from the retailer that it was originally sold to.

2. Our guarantee covers problems caused by material or manufacturing defects, and will result in the repair of these defects or replacement of the device with a like for like or similar article. Please note that our devices have not been designed for use in commercial, trade or industrial applications. Consequently, the guarantee is invalidated if the equipment is used in commercial, trade or industrial applications or for other equivalent activities.
3. The guarantee is valid for a period of 1 year starting from the purchase date of the device. Guarantee claims should be submitted before the end of the guarantee period within two weeks of the defect being noticed. No guarantee claims will be accepted after the end of the guarantee period. The original guarantee period remains applicable to the device even if repairs are carried out or parts are replaced. In such cases, the work performed or parts fitted will not result in an extension of the guarantee period, and no new guarantee will become active for the work performed or parts fitted. This also applies when an on-site Service is used.
4. Please keep your sales receipt in a safe place. If the defect is covered by our guarantee your device will either be repaired under the terms of guarantee or we will send you a replacement device. This device may be re-conditioned or Like for like replacement.