

GB

HAND SWEEPER

Original Instructions

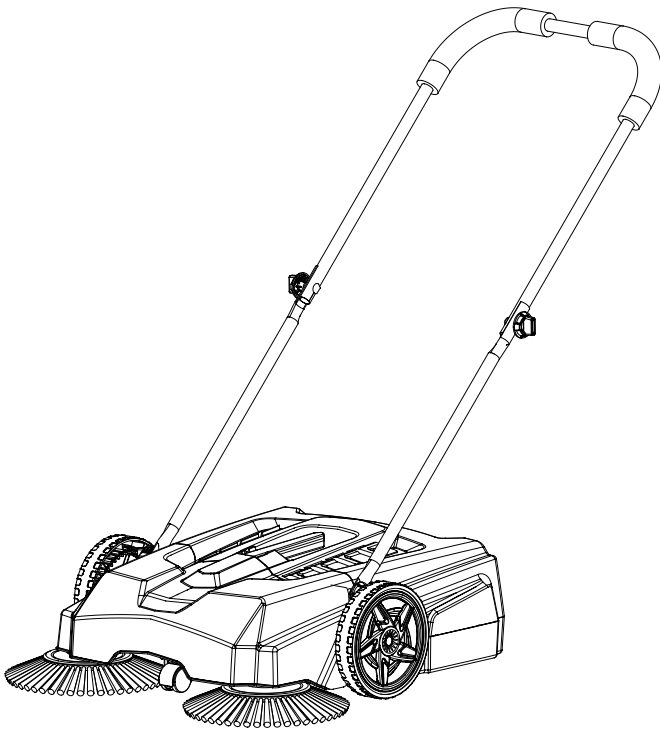

**READ & UNDERSTAND
INSTRUCTION MANUAL**

Save all warnings and instructions for future reference.

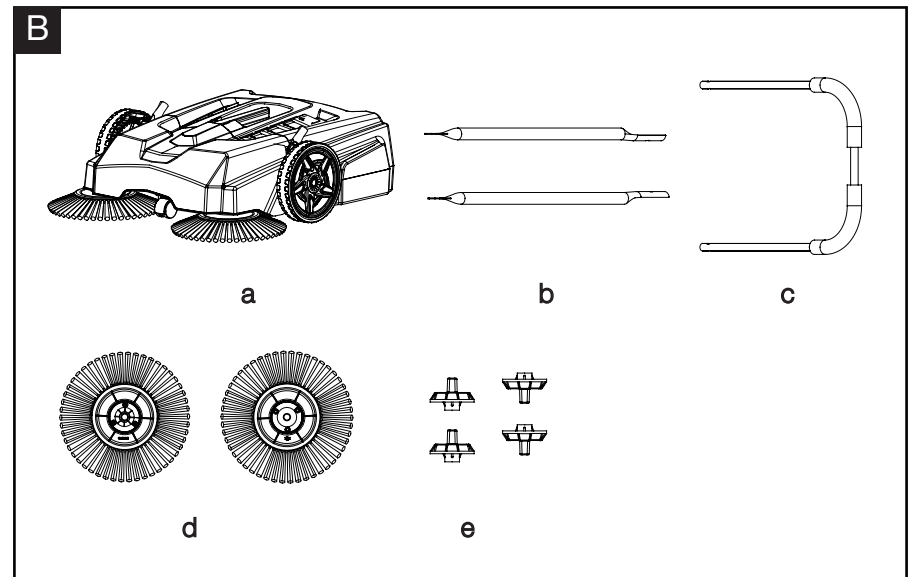
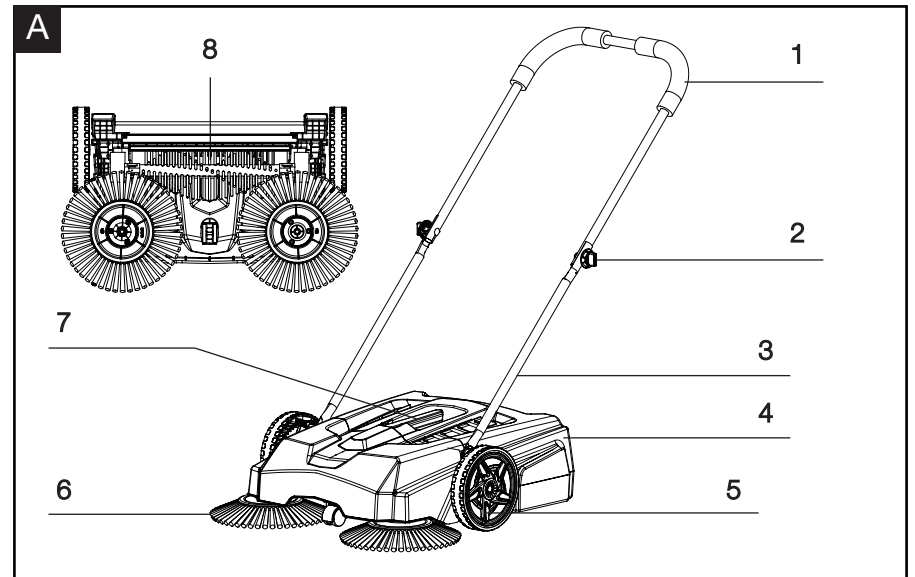

CONTENT

Intended use	05
General safety warnings	06
Symbols	07
Technical data	08
Description of product	09
Operation	10
Maintenance and storage	10

INTENDED USE

1. The machine is designed and built according to the state-of-the-art and the safety-related standards. Nevertheless, the use of the machine might involve risks such as personal injury, danger to life for the user or third parties, or damage to the machine and other material property.
2. The machine is to be used only in a technically flawless condition as well as in accordance with the manufacturer's instructions and in a safety and risk-conscious manner while adhering to the operating instructions! In particular, failures which may impair the safety must be resolved immediately (by you or an expert)!
3. Sweeping of flat and dry surfaces – e.g. entries, terraces, courtyards, etc.
4. The machine may be operated only with original parts and original accessories of the manufacturer.
5. Any other use above or beyond this is considered improper use. The manufacturer is not liable for damages resulting from this. The user shall bear this risk alone.
6. The safety, work and maintenance instructions of the manufacturer as well as the dimensions indicated in the Technical Data section must be adhered to.
7. The relevant accident prevention regulations and other generally recognised safety standards must be observed.
8. The machine may be used, maintained or repaired only by persons who are familiar with the machine and the risks involved. Unauthorised modifications on the machine exclude any liability of the manufacturer for resulting damages.

Please note that our equipment has not been de-signed for use in commercial, trade or industrial applications.

Our warranty will be voided if the equipment is used in commercial, trade or industrial businesses or for equivalent purposes.

We recommend:

Read through the complete text in the operating instructions before installing and commissioning the device. If you give the equipment to any other person, give them these operating instructions as well. The operating instructions are intended to help the user to become familiar with the machine and take advantage of its application possibilities in accordance with the recommendations. The operating instructions contain important information

GENERAL SAFETY WARNINGS

on how to operate the machine safely, professionally and eco-nomically, how to avoid danger, costly repairs, re-duce downtimes and how to increase reliability and service life of the machine. In addition to the safety regulations in the operating instructions, you have to meet the applicable regulations that apply for the operation of the machine in your country. Keep the operating instructions package with the machine at all times and store it in a plastic cover to protect it from dirt and moisture. Read the instruction manual each time before operating the machine and care-fully follow its information. The machine can only be operated by persons who were instructed concerning the operation of the machine and who are informed about the associated dangers. The minimum age re-quirement must be complied with.

Safety information

1. Take suitable measures to prevent children from accessing the appliance.
2. Immediately replace any faulty components.
3. We are not liable for any damage caused as a result of any unauthorised repair and unauthorised handling or use contrary to the use as designated.

Warning: Sweeping of any gel, liquid, combustible, explosive, hot and unhealthy substances prohibited.

Attention! If metal, glass or sharp objects have been swept, it is necessary to use firm working gloves when emptying the dirt collecting container.

SYMBOLS

Safety symbols

The purpose of safety symbols is to attract your attention to possible dangers. The safety symbols and the explanations with them require your careful attention and full understanding. The symbol warnings do not, by themselves, eliminate any danger. The instructions and warnings they give are no substitutes for proper accident prevention measures.



WARNING: Be sure to read and understand all safety instructions in this operator's manual, including all safety alert symbols such as "**DANGER**," "**WARNING**," and "**CAUTION**" before using this tool. Failure to follow all instructions listed below may result in electric shock, fire and/or serious personal injury.

SAFETY ALERT SYMBOL: Indicates **DANGER**, **WARNING**, or **CAUTION**. May be used in conjunction with other symbols or pictographs.

Symbol meaning

This page depicts and describes safety symbols that may appear on this product. Read, understand and follow all instructions on the machine before attempting to assemble and operate.

SYMBOLS



Read the instructions for use before use!



WEEE symbol. Waste electrical products should not be disposed of with household waste. Please recycle where facilities exist. Check with your Local Authority or local store for recycling advice.



The product complies with the applicable European directives and an evaluation method of conformity for these directives was done.

TECHNICAL DATA

Model		HW FS68
Drive function		Manual
Max. working width with side brushes (mm)		650
ca. Sweeping capacity (m ² /h)		2000
Container content (l)		22

DESCRIPTION OF PRODUCT

Parts description (Fig. A)

1. Top Handle
2. Mounting screws
3. Lower push bar
4. Dirt collecting container
5. Transport wheels
6. Feeder brushes
7. Sweeping brushes

Delivery contents (Fig. B)

Carefully unpack the appliance and check that it is complete. Dispose of the packaging material correctly.

- a. Sweeper
- b. Lower push bar
- c. Top Handle
- d. Brushes
- e. Mounting screw sliding handle



WARNING: If any parts are damaged or missing, do not operate this tool until these parts are replaced. Failure to heed this warning could result in serious personal injury.



NOTE: Always recycle the packaging in accordance with local recycling guidelines.

OPERATION

Attachment

About packaging used requires your machine is not completely assembled.

- Mount the feeder brushes to the intended axis and fasten it with 3 screws (b).

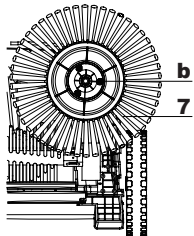

- Attach the lower part of the push handle to the designated assembly points with the clamping thumb-screw on both sides.

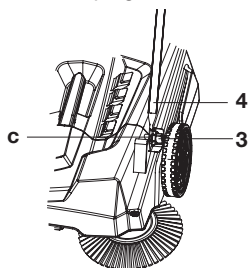

- Attach the upper part of the push handle (2) as shown in Figure 6.

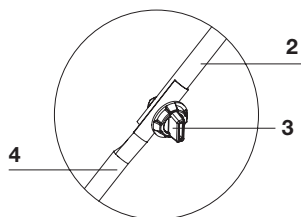

MAINTENANCE AND STORAGE

Operation

When the sweeper is moved, the feeder brushes (7) and sweeping brushes (9) start rotating, helped by the belt drive. Rotating feeder brushes (7) drive the dirt to the centre. It is then collected by sweeping brush and taken to the dirt collecting container (5).

Emptying the dirt collecting container

If you want to take out the dirt collecting container to empty it, take it by its handle and pull up.

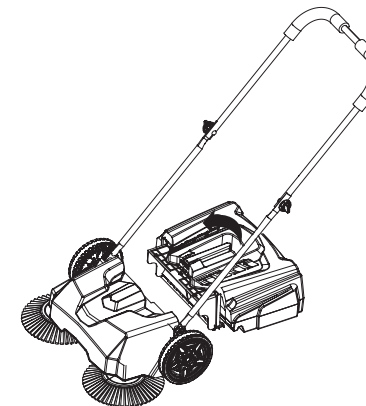

Maintenance

Use a wet cloth for plastic parts cleaning. Do not use any cleaning agents, solvents or sharp objects. After every use - Remove the appliance off dust and dirt.

If the brush is not rotating it can be that the storage of the brushes is dirty or the belt isn't good. Clean and lubricate the bearing of the brush or replace the belt.

Service information

Please note that the following parts of this product are subject to normal or natural wear and that the following parts are therefore also required for use as consumables.

Wear parts*: Brushes, drive belts, wheels

* Not necessarily included in the scope of delivery!

Storage

For any longer storage the appliance must be thoroughly cleaned and stored so as unauthorised persons could not access it.

- Empty the dirt collecting container
- Adjust the brushes to relieve them
- Store the appliance when it is dry

To save spaces, the sliding handle can be folded. Loosen the screws, pull the sliding handle out and fold forward.